

# BALI 4.2

Le 113\_X (2024)

Catamaran Bali 4.2 Le 113\_X, built in 2024 is anchored in the BVI, Tortola, Nanny Cay Marina, British Virgin Islands, British Virgin Islands. It has 4 + 1 cabins, can accommodate 8 + 1 + 1 people and has 4 + 1 toilets. Bed linen and kitchen equipment are included in the price.

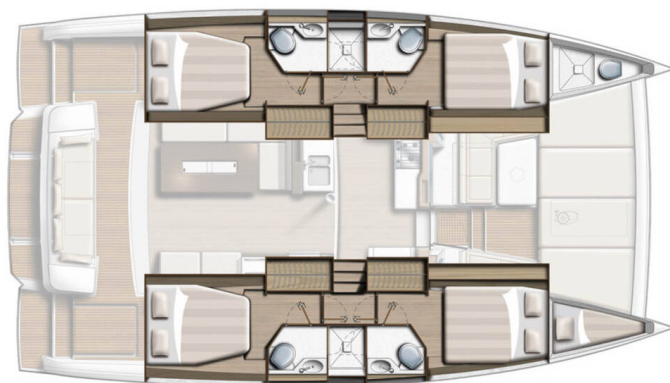

## YACHT SPECIFICATIONS

Yacht Base

**BVI, Tortola, Nanny Cay Marina,  
British Virgin Islands**

Yacht ID

**6105**

Brands

**Catana**

Yacht name

**Le 113\_X**

Production year

**2024**

Length

**42 ft**

Cabins

**4 + 1**

Berths

**8 + 1 + 1**

Max Persons

**10**

WC

**4 + 1**

Engine

**2 x 45 HP**

Fuel tank

**800 l**



**WEBSITE**

[www.plujeme.cz](http://www.plujeme.cz)



**PHONE**

+420 720 755 085



**MOBILE**

+420 777 170 276



**E-MAIL**

[info@plujeme.cz](mailto:info@plujeme.cz)



**PLUJEME RÁDI S.R.O.**

Dlouhá 730/35, 11000 Praha 1 – Staré Město, Czech Republic

## STANDARD YACHT EQUIPMENT

Comfort	<b>Deck cushions, Extra bedlinen and towels, Outside cushions, Sundeck cushions</b>
Deck	<b>Bimini top, Boat hook, Chain counter on helm station, Cockpit/stern, outside shower, Davit, Dinghy with outboard engine, Electric anchor windlass, Floating rope, Grill/Barbecue/Plancha, Jerry cans for fuel, Plastic bucket, Pulpit seat, Swimming ladder, Teak cockpit, Water hose</b>
Entertainment	<b>Hi-Fi system, Snorkeling equipment, Underwater lights</b>
Galley	<b>Freezer, Kitchen utensils (Galley equipment, cutlery), Refrigerator</b>
Interior	<b>Electric fans, Electric toilet</b>
Navigation	<b>AIS, Autopilot, Binoculars, Compass, GPS chart plotter, Radar reflector, Wind instrument/Anemometer</b>
Safety	<b>Buoyant smoke signal, Extra fuel tank, Extra water tank, Fire extinguisher, First aid kit, Flashlight, Fog horn, Horseshoe lifebuoy, Inflatable life raft, Life jacket (children), Life jackets, Smoke detector, Torch, VHF radio</b>
Sails	<b>Electric mainsail windlass, Electric winch</b>
Yacht electrics	<b>Air Conditioning, Generator, Inverter, Service batteries, Watermaker - desalinator</b>



**WEBSITE**

[www.plujeme.cz](http://www.plujeme.cz)



**PHONE**

+420 720 755 085



**MOBILE**

+420 777 170 276



**E-MAIL**

[info@plujeme.cz](mailto:info@plujeme.cz)



**PLUJEME RÁDI S.R.O.**

Dlouhá 730/35, 11000 Praha 1 – Staré Město, Czech Republic

## SERVICES

SELECTED SERVICES	OBLIGATORY	PAYMENT TYPE	PRICE
<b>BVI Cruising Tax</b> (Payable now) <b>Season: 2026 Exotic</b> . BVI: Cruising tax payable in advance: 4 USD per person / day (Price will be adjusted when the option is confirmed)	Yes	per guest/day	<b>3,48 €</b>
<b>Handling fees</b> (Payable now) <b>Season: 2026 Exotic</b> .	Yes	per booking	<b>35,00 €</b>
<b>Navigare Carefree</b> (Payable now) <b>Season: 2026 Exotic</b> . *** To be added upon client's price - OBLIGATORY - BVI- CAT up to 45 ft - Includes Damage waiver (covering damages) with reduced security deposit addressed specifically to blocked toilets, unpaid fuel, lost equipment, unpaid fees & fines, and returning the boat in an extremely dirty state. NEW!, welcome package, final cleaning, bed sheets & towels, dinghy, outboard engine & fuel, propane gas, full water tanks, snorkelling equipment, National parks permits. Beach towels are provided 1 per person for the charter. Yacht Fuel is not included - the fuel tank will be full when your charter starts and you are responsible for topping off the fuel tank at the end of your charter. ***** CRUISING TAX is NOT INCLUDED.	Yes	per booking	<b>770,00 €</b>
<b>Preparation fee</b> (Payable now) <b>Season: 2026 Exotic</b> . INCLUDED: Welcome pack // final cleaning // 1 set of bed sheets / cabin & 1 set of towels / pax, dinghy, outboard engine & initial supply of fuel, gas and water tanks // 1st & last night in the marina // NOT INCLUDED: refuelling, gas & water consumption at end of charter, taxes if any, handling fees & additional equipment deposit.	Yes	per booking	<b>415,00 €</b>
<b>Search &amp; Sea rescue</b> (Payable at the base) <b>Season: 2026 Exotic</b> . Extra paid at base for the local Search and Sea rescue association (VISAR). The proceeds are fully sent to the association. 5 US \$ per person / Payment in cash only.	Yes	per person	<b>4,55 €</b>
<b>Checkout Skipper</b> (Payable now) <b>Season: 2026 Exotic</b> . A check-out skipper (COS) is a professional captain that boards with you on Day 1, and is dropped off late afternoon the same day. A COS may be requested by you or may be required by Navigare after review of your sailing resume.	No	per booking	<b>370,00 €</b>
<b>Comfort Pack</b> (Payable now) <b>Season: 2026 Exotic</b> . TYM - BVI: final cleaning, bed sheets & towels up to max pax number, cooking gas, full water tanks	No	per booking	<b>0,00 €</b>

**Cook** (Payable now) No per day + food **270,00 €**

**Season: 2026 Exotic** . +provisioning ; Crew on board must have their own toilets/ showers. If either a skipper or a hostess/cook is on board, 1 double cabin will be required for him/her. If both a skipper and a hostess/cook are on board, 1 double cabin and 1 forepeak cabin will be required for them. Exceptions exists for specific layouts, Sales Agents will provide more details about the different boat models. A gratuity of 15-20% of the crew fee is customary for excellent service. Cooking breakfast, lunch, dinners, keeping the kitchen clean (not the rest of the boat, not the cabins). NOTE: Cook details will be available 3 days before the charter.

---

**Cook** (Payable now) No per day + food **270,00 €**

**Season: 2026 Exotic** . +provisioning ; Crew on board must have their own toilets/ showers. If either a skipper or a hostess/cook is on board, 1 double cabin will be required for him/her. If both a skipper and a hostess/cook are on board, 1 double cabin and 1 forepeak cabin will be required for them. Exceptions exists for specific layouts, Sales Agents will provide more details about the different boat models. A gratuity of 15-20% of the crew fee is customary for excellent service. Cooking breakfast, lunch, dinners, keeping the kitchen clean (not the rest of the boat, not the cabins). NOTE: Cook details will be available 3 days before the charter.

---

**Cook** (Payable now) No per day + food **295,00 €**

**Season: 2026 Exotic** . +provisioning ; Crew on board must have their own toilets/ showers. If either a skipper or a hostess/cook is on board, 1 double cabin will be required for him/her. If both a skipper and a hostess/cook are on board, 1 double cabin and 1 forepeak cabin will be required for them. Exceptions exists for specific layouts, Sales Agents will provide more details about the different boat models. A gratuity of 15-20% of the crew fee is customary for excellent service. Cooking breakfast, lunch, dinners, keeping the kitchen clean (not the rest of the boat, not the cabins). NOTE: Cook details will be available 3 days before the charter.

---

**Cook** (Payable now) No per day + food **270,00 €**

**Season: 2026 Exotic** . +provisioning ; Crew on board must have their own toilets/ showers. If either a skipper or a hostess/cook is on board, 1 double cabin will be required for him/her. If both a skipper and a hostess/cook are on board, 1 double cabin and 1 forepeak cabin will be required for them. Exceptions exists for specific layouts, Sales Agents will provide more details about the different boat models. A gratuity of 15-20% of the crew fee is customary for excellent service. Cooking breakfast, lunch, dinners, keeping the kitchen clean (not the rest of the boat, not the cabins). NOTE: Cook details will be available 3 days before the charter.

---

<b>Cook</b> (Payable now)	No	per day + food	<b>295,00 €</b>
<p><b>Season: 2026 Exotic</b> . +provisioning ; Crew on board must have their own toilets/ showers. If either a skipper or a hostess/cook is on board, 1 double cabin will be required for him/her. If both a skipper and a hostess/cook are on board, 1 double cabin and 1 forepeak cabin will be required for them. Exceptions exists for specific layouts, Sales Agents will provide more details about the different boat models. A gratuity of 15-20% of the crew fee is customary for excellent service. Cooking breakfast, lunch, dinners, keeping the kitchen clean (not the rest of the boat, not the cabins). NOTE: Cook details will be available 3 days before the charter.</p>			
<b>Crew change</b> (Payable now)	No	per booking	<b>250,00 €</b>
<p><b>Season: 2026 Exotic</b> . Any crew change during the charter is subject to € 250.- additional cost. The charge includes administration cost, change of bed linen and towels and one night at NY ponton (marina fee included only if the same base than start base). It doesn't include cleaning, nor new transit log where applicable.</p>			
<b>Damage waiver</b> (Payable now)	No	per night	<b>80,00 €</b>
<p><b>Season: 2026 Exotic</b> . Damage waiver limits your liability to the reduced Security Deposit . Mandatory when skipper is added. Price is per night of the charter ( minimum value of 7 nights &amp; a maximum value of 21 nights) Not applicable for 4+ weeks charters , nor Regattas/Races.</p>			
<b>Extra cleaning</b> (Payable now)	No	per booking	<b>310,00 €</b>
<p><b>Season: 2026 Exotic</b> . Optional Additional cleaning</p>			
<b>Extra set of linen (choose how many)</b> (Payable now)	No	per booking	<b>15,00 €</b>
<p><b>Season: 2026 Exotic</b> . Extra set of linen : 15 € 1 set of linen (2 sheets &amp; 2 pillow case) - to be updated manually</p>			
<b>Extra set of towels (choose how many)</b> (Payable now)	No	per booking	<b>10,00 €</b>
<p><b>Season: 2026 Exotic</b> . Extra set of towels: 10 € 1 set of towels (1 face &amp; 1 bath towel) - to be updated manually</p>			
<b>Full board 1-4 pax (number of guests to update manually)</b> (Payable now)	No	per guest/day	<b>75,00 €</b>
<p><b>Season: 2026 Exotic</b> . only available if cook is booked on board as the cook will do the provisioning based on client's preference. Includes breakfast, lunch &amp; dinner + the crew's food. Does not included alcoholic drinks</p>			
<b>Full board 5-12 pax (number of guests to update manually)</b> (Payable now)	No	per guest/day	<b>75,00 €</b>
<p><b>Season: 2026 Exotic</b> . only available if cook is booked on board as the cook will do the provisioning based on client's preference. Includes breakfast, lunch &amp; dinner + the crew's food. Does not included alcoholic drinks</p>			

<b>Gritchen cancellation insurance</b> (Payable now)	No	per booking	<b>0,00 €</b>
<b>Season: 2026 Exotic</b> . with Covid coverage (4% of client's Total price)- European clients Only			
<b>Half board 1-4 pax (number of guests to update manually)</b> (Payable now)	No	per guest/day	<b>60,00 €</b>
<b>Season: 2026 Exotic</b> . only available if cook is booked on board as the cook will do the provisioning based on client's preference. Includes breakfast & lunch OR dinner + the crew's food. Does not included alcoholic drinks			
<b>Half board 5-12 pax (number of guests to update manually)</b> (Payable now)	No	per guest/day	<b>55,00 €</b>
<b>Season: 2026 Exotic</b> . only available if cook is booked on board as the cook will do the provisioning based on client's preference. Includes breakfast & lunch OR dinner + the crew's food. Does not included alcoholic drinks			
<b>Sailing Instructor</b> (Payable at the base)	No	per day + food	<b>350,00 €</b>
<b>Season: 2026 Exotic</b> . Sailing instructor BVI			
<b>Skipper</b> (Payable now)	No	per day + food	<b>310,00 €</b>
<b>Season: 2026 Exotic</b> . +provisioning ; Crew on board must have their own toilets/ showers. If either a skipper or a hostess/cook is on board, 1 double cabin will be required for him/her. If both a skipper and a hostess/cook are on board, 1 double cabin and 1 forepeak cabin will be required for them. Exceptions exists for specific layouts, Sales Agents will provide more details about the different boat models. A gratuity of 15-20% of the crew fee is customary for excellent service ***NOTE: Skipper details will be available 3 days before the charter.			
<b>Skipper</b> (Payable now)	No	per day + food	<b>310,00 €</b>
<b>Season: 2026 Exotic</b> . +provisioning ; Crew on board must have their own toilets/ showers. If either a skipper or a hostess/cook is on board, 1 double cabin will be required for him/her. If both a skipper and a hostess/cook are on board, 1 double cabin and 1 forepeak cabin will be required for them. Exceptions exists for specific layouts, Sales Agents will provide more details about the different boat models. A gratuity of 15-20% of the crew fee is customary for excellent service ***NOTE: Skipper details will be available 3 days before the charter.			
<b>Skipper</b> (Payable now)	No	per day + food	<b>340,00 €</b>
<b>Season: 2026 Exotic</b> . +provisioning ; Crew on board must have their own toilets/ showers. If either a skipper or a hostess/cook is on board, 1 double cabin will be required for him/her. If both a skipper and a hostess/cook are on board, 1 double cabin and 1 forepeak cabin will be required for them. Exceptions exists for specific layouts, Sales Agents will provide more details about the different boat models. A gratuity of 15-20% of the crew fee is customary for excellent service ***NOTE: Skipper details will be available 3 days before the charter.			

**Skipper (Payable now)** No per day + food **310,00 €**

**Season: 2026 Exotic** . +provisioning ; Crew on board must have their own toilets/ showers. If either a skipper or a hostess/cook is on board, 1 double cabin will be required for him/her. If both a skipper and a hostess/cook are on board, 1 double cabin and 1 forepeak cabin will be required for them. Exceptions exists for specific layouts, Sales Agents will provide more details about the different boat models. A gratuity of 15-20% of the crew fee is customary for excellent service \*\*\*NOTE: Skipper details will be available 3 days before the charter.

**Skipper (Payable now)** No per day + food **340,00 €**

**Season: 2026 Exotic** . +provisioning ; Crew on board must have their own toilets/ showers. If either a skipper or a hostess/cook is on board, 1 double cabin will be required for him/her. If both a skipper and a hostess/cook are on board, 1 double cabin and 1 forepeak cabin will be required for them. Exceptions exists for specific layouts, Sales Agents will provide more details about the different boat models. A gratuity of 15-20% of the crew fee is customary for excellent service \*\*\*NOTE: Skipper details will be available 3 days before the charter.

**Sleep over before check in (Payable now)** No per booking **0,00 €**

**Season: 2026 Exotic** . Sleep over on a day before the check-in: Sleep over from 5PM on a day before the check-in date and time stated in the contract: 65% of the daily rate. (Price will be adjusted when the option is confirmed)

**WI-FI Internet connection on boat (Payable now)** No per night **15,00 €**

**Season: 2026 Exotic** . Unlimited GigaBytes included in the price



**WEBSITE**  
www.plujeme.cz



**PHONE**  
+420 720 755 085



**MOBILE**  
+420 777 170 276



**E-MAIL**  
info@plujeme.cz



**PLUJEME RÁDI S.R.O.**  
Dlouhá 730/35, 11000 Praha 1 – Staré Město, Czech Republic

## ADDITIONAL EXTRAS

EXTRA	OBLIGATORY	PAYMENT TYPE	PRICE
<b>Railing net (Safety net)</b> <i>(Payable now)</i> <b>Season: 2026 Exotic</b> . <i>Payable now</i>	No	per booking	<b>155,00 €</b>
<b>Stand up paddle (SUP)</b> <i>(Payable now)</i> <b>Season: 2026 Exotic</b> . <i>Price per day - Payable now</i>	No	per night	<b>15,00 €</b>



#### WEBSITE

[www.plujeme.cz](http://www.plujeme.cz)



#### E-MAIL

[info@plujeme.cz](mailto:info@plujeme.cz)



#### PHONE

+420 720 755 085



#### MOBILE

+420 777 170 276



#### PLUJEME RÁDI S.R.O.

Dlouhá 730/35, 11000 Praha 1 – Staré Město, Czech Republic

## PRICE AND AVAILABILITY

<b>25.04. - 08.05.2026</b> NOT AVAILABLE	<b>09.05. - 16.05.2026</b> NOT AVAILABLE	<b>17.05. - 24.05.2026</b> NOT AVAILABLE	<b>29.05. - 10.06.2026</b> NOT AVAILABLE
<b>12.06. - 21.06.2026</b> NOT AVAILABLE	<b>27.06. - 05.07.2026</b> NOT AVAILABLE	<b>11.07. - 17.07.2026</b> NOT AVAILABLE	<b>22.07. - 29.07.2026</b> NOT AVAILABLE
<b>04.08. - 09.10.2026</b> NOT AVAILABLE	<b>10.10. - 17.10.2026</b> <b>4.755 €</b>	<b>17.10. - 24.10.2026</b> <b>4.755 €</b>	<b>24.10. - 31.10.2026</b> <b>4.517 €</b> 4.755 €
<b>31.10. - 07.11.2026</b> <b>4.517 €</b> 4.755 €	<b>07.11. - 14.11.2026</b> <b>4.845 €</b> 5.100 €	<b>14.11. - 21.11.2026</b> <b>4.845 €</b> 5.100 €	<b>21.11. - 28.11.2026</b> <b>5.526 €</b> 6.140 €
<b>28.11. - 05.12.2026</b> NOT AVAILABLE			



### WEBSITE

[www.plujeme.cz](http://www.plujeme.cz)



### E-MAIL

[info@plujeme.cz](mailto:info@plujeme.cz)



### PHONE

+420 720 755 085



### MOBILE

+420 777 170 276



### PLUJEME RÁDI S.R.O.

Dlouhá 730/35, 11000 Praha 1 – Staré Město, Czech Republic

## PRICE AND AVAILABILITY

05.12. - 19.12.2026 NOT AVAILABLE	20.12. - 27.12.2026 NOT AVAILABLE	02.01. - 09.01.2027 6.375 € 6.710 €	09.01. - 16.01.2027 6.375 € 6.710 €
16.01. - 23.01.2027 6.693 € 7.045 €	23.01. - 30.01.2027 7.030 € 7.400 €	30.01. - 06.02.2027 7.377 € 7.765 €	06.02. - 13.02.2027 7.809 € 8.220 €
13.02. - 20.02.2027 7.809 € 8.220 €	20.02. - 27.02.2027 7.809 € 8.220 €	27.02. - 06.03.2027 7.809 € 8.220 €	06.03. - 13.03.2027 8.408 € 8.850 €
13.03. - 20.03.2027 8.408 € 8.850 €	20.03. - 27.03.2027 8.408 € 8.850 €	27.03. - 03.04.2027 7.795 € 8.205 €	03.04. - 10.04.2027 7.795 € 8.205 €
10.04. - 17.04.2027 7.410 € 7.800 €	17.04. - 24.04.2027 6.959 € 7.325 €	24.04. - 01.05.2027 6.474 € 6.815 €	01.05. - 08.05.2027 6.075 € 6.395 €
08.05. - 15.05.2027 6.075 € 6.395 €	15.05. - 22.05.2027 6.075 € 6.395 €	22.05. - 29.05.2027 6.075 € 6.395 €	29.05. - 05.06.2027 5.771 € 6.075 €
05.06. - 12.06.2027 5.482 € 5.770 €	12.06. - 19.06.2027 5.225 € 5.500 €	19.06. - 26.06.2027 5.225 € 5.500 €	26.06. - 03.07.2027 5.486 € 5.775 €
03.07. - 10.07.2027 5.225 € 5.500 €	10.07. - 17.07.2027 5.225 € 5.500 €	17.07. - 24.07.2027 5.225 € 5.500 €	24.07. - 31.07.2027 5.225 € 5.500 €
31.07. - 07.08.2027 4.978 € 5.240 €			



WEBSITE  
[www.plujeme.cz](http://www.plujeme.cz)



E-MAIL  
[info@plujeme.cz](mailto:info@plujeme.cz)



PHONE  
+420 720 755 085



MOBILE  
+420 777 170 276



PLUJEME RÁDI S.R.O.  
Dlouhá 730/35, 11000 Praha 1 – Staré Město, Czech Republic

## PRICE AND AVAILABILITY

07.08. - 14.08.2027 <b>4.517 €</b> 4.755 €	14.08. - 21.08.2027 <b>4.517 €</b> 4.755 €	21.08. - 28.08.2027 <b>4.517 €</b> 4.755 €	28.08. - 04.09.2027 <b>4.517 €</b> 4.755 €
04.09. - 11.09.2027 <b>4.517 €</b> 4.755 €	11.09. - 18.09.2027 <b>4.517 €</b> 4.755 €	18.09. - 25.09.2027 <b>4.517 €</b> 4.755 €	25.09. - 02.10.2027 <b>4.517 €</b> 4.755 €
02.10. - 09.10.2027 <b>4.517 €</b> 4.755 €	09.10. - 16.10.2027 <b>4.517 €</b> 4.755 €	16.10. - 23.10.2027 <b>4.517 €</b> 4.755 €	23.10. - 30.10.2027 <b>4.517 €</b> 4.755 €
30.10. - 06.11.2027 <b>4.517 €</b> 4.755 €	06.11. - 13.11.2027 <b>4.845 €</b> 5.100 €	13.11. - 20.11.2027 <b>4.845 €</b> 5.100 €	20.11. - 27.11.2027 <b>5.833 €</b> 6.140 €
27.11. - 04.12.2027 <b>4.603 €</b> 4.845 €	04.12. - 11.12.2027 <b>4.337 €</b> 4.565 €	11.12. - 18.12.2027 <b>4.337 €</b> 4.565 €	18.12. - 25.12.2027 <b>5.828 €</b> 6.135 €



### WEBSITE

[www.plujeme.cz](http://www.plujeme.cz)



### E-MAIL

[info@plujeme.cz](mailto:info@plujeme.cz)



### PHONE

+420 720 755 085



### MOBILE

+420 777 170 276



### PLUJEME RÁDI S.R.O.

Dlouhá 730/35, 11000 Praha 1 – Staré Město, Czech Republic