

# LAGOON 42

Luna (2023)

Catamaran Lagoon 42 Luna, built in 2023 is anchored in the Sukosan, D-Marin Dalmacija Marina, Zadar region, Croatia. It has 4 + 2 cabins, can accommodate 8 + 2 + 2 people and has 4 toilets. Bed linen and kitchen equipment are included in the price.

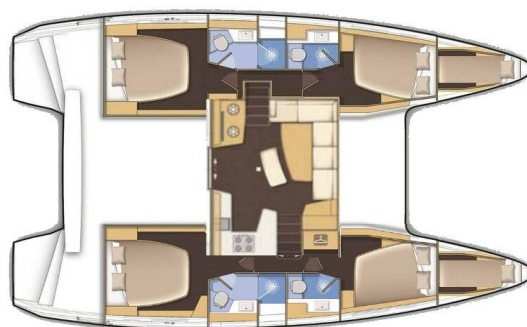

## YACHT SPECIFICATIONS

Yacht Base

**Sukosan, D-Marin Dalmacija Marina,  
Croatia**

Yacht ID

**5981**

Brands

**Lagoon**

Yacht name

**Luna**

Production year

**2023**

Length

**42 ft**

Cabins

**4 + 2**

Berths

**8 + 2 + 2**

WC

**4**

Engine

**2 x 57 HP**

Fuel tank

**600 l**



**WEBSITE**

[www.plujeme.cz](http://www.plujeme.cz)



**PHONE**

+420 720 755 085



**MOBILE**

+420 777 170 276



**E-MAIL**

[info@plujeme.cz](mailto:info@plujeme.cz)



**PLUJEME RÁDI S.R.O.**

Dlouhá 730/35, 11000 Praha 1 – Staré Město, Czech Republic

## STANDARD YACHT EQUIPMENT

Deck	<b>Bimini top, Cockpit table, Fenders</b>
Entertainment	<b>Fusion radio, Outdoor speakers, Wi-Fi Internet</b>
Interior	<b>Electric fans, Lowerable salon table</b>
Navigation	<b>GPS chart plotter - cockpit</b>
Yacht electrics	<b>Air Conditioning, Generator, USB sockets, Watermaker - desalinator</b>



**WEBSITE**

[www.plujeme.cz](http://www.plujeme.cz)



**E-MAIL**

[info@plujeme.cz](mailto:info@plujeme.cz)



**PHONE**

+420 720 755 085



**MOBILE**

+420 777 170 276



**PLUJEME RÁDI S.R.O.**

Dlouhá 730/35, 11000 Praha 1 – Staré Město, Czech Republic

## SERVICES

SELECTED SERVICES	OBLIGATORY	PAYMENT TYPE	PRICE
<b>Comfort pack</b> (Payable at the base) <b>Season: 2026.</b> final cleaning/bed linen/towels/WiFi/outboard	Yes	per booking	<b>500,00 €</b>
<b>Alternative deposit</b> (Payable at the base) <b>Season: 2026.</b> + fix deposit 500 EUR	No	per booking	<b>250,00 €</b>
<b>Extra cleaning</b> (Payable at the base) <b>Season: 2026.</b>	No	per week	<b>300,00 €</b>
<b>Hostess</b> (Payable at the base) <b>Season: 2026.</b> Availability only on request! Meals excluded. A separate cabin and toilet must be provided for accommodation unless located in the front peak)	No	per week + food	<b>1.540,00 €</b>
<b>Pet on board</b> (Payable at the base) <b>Season: 2026.</b>	No	per week	<b>100,00 €</b>
<b>Skipper</b> (Payable at the base) <b>Season: 2026.</b> Availability only on request! Meals excluded. A separate cabin and toilet must be provided for accommodation unless located in the front peak	No	per week	<b>1.680,00 €</b>

**WEBSITE**[www.plujeme.cz](http://www.plujeme.cz)**E-MAIL**[info@plujeme.cz](mailto:info@plujeme.cz)**PHONE**

+420 720 755 085

**MOBILE**

+420 777 170 276

**PLUJEME RÁDI S.R.O.**

Dlouhá 730/35, 11000 Praha 1 – Staré Město, Czech Republic

## ADDITIONAL EXTRAS

EXTRA	OBLIGATORY	PAYMENT TYPE	PRICE
<b>Beach towel</b> (Payable at the base) <b>Season: 2026.</b> Payable at the base	No	per piece	<b>10,00 €</b>
<b>Ice maker</b> (Payable at the base) <b>Season: 2026.</b> Limited availability - Payable at the base	No	per week	<b>50,00 €</b>
<b>NESPRESSO coffee machine</b> (Payable at the base) <b>Season: 2026.</b> Payable at the base	No	per week	<b>50,00 €</b>
<b>Railing net (Safety net)</b> (Payable at the base) <b>Season: 2026.</b> no installation - Payable at the base	No	per booking	<b>50,00 €</b>
<b>Railing net (Safety net)</b> (Payable at the base) <b>Season: 2026.</b> with installation, not compatible with priority boarding - Payable at the base	No	per booking	<b>150,00 €</b>
<b>Snorkeling equipment</b> (Payable at the base) <b>Season: 2026.</b> no fins - Payable at the base	No	per week/ person	<b>10,00 €</b>
<b>Stand up paddle (SUP)</b> (Payable at the base) <b>Season: 2026.</b> Payable at the base	No	per week	<b>150,00 €</b>



**WEBSITE**  
www.plujeme.cz



**E-MAIL**  
info@plujeme.cz



**PHONE**  
+420 720 755 085



**PLUJEME RÁDI S.R.O.**  
Dlouhá 730/35, 11000 Praha 1 – Staré Město, Czech Republic



**MOBILE**  
+420 777 170 276

## PRICE AND AVAILABILITY

<b>13.06. - 20.06.2026</b> NOT AVAILABLE	<b>20.06. - 27.06.2026</b> NOT AVAILABLE	<b>27.06. - 04.07.2026</b> NOT AVAILABLE	<b>04.07. - 11.07.2026</b> NOT AVAILABLE
<b>11.07. - 18.07.2026</b> NOT AVAILABLE	<b>18.07. - 25.07.2026</b> <b>7.760 €</b> 9.700 €	<b>25.07. - 01.08.2026</b> NOT AVAILABLE	<b>01.08. - 08.08.2026</b> <b>7.760 €</b> 9.700 €
<b>08.08. - 15.08.2026</b> <b>7.520 €</b> 9.400 €	<b>15.08. - 22.08.2026</b> NOT AVAILABLE	<b>22.08. - 29.08.2026</b> NOT AVAILABLE	<b>29.08. - 05.09.2026</b> NOT AVAILABLE
<b>05.09. - 12.09.2026</b> NOT AVAILABLE	<b>12.09. - 19.09.2026</b> NOT AVAILABLE	<b>19.09. - 26.09.2026</b> NOT AVAILABLE	<b>26.09. - 03.10.2026</b> NOT AVAILABLE
<b>03.10. - 10.10.2026</b> <b>2.392 €</b> 2.990 €	<b>10.10. - 17.10.2026</b> <b>2.392 €</b> 2.990 €	<b>17.10. - 24.10.2026</b> <b>2.392 €</b> 2.990 €	<b>24.10. - 31.10.2026</b> <b>2.392 €</b> 2.990 €
<b>31.10. - 07.11.2026</b> <b>2.392 €</b> 2.990 €	<b>07.11. - 31.12.2026</b> NOT AVAILABLE		



### WEBSITE

[www.plujeme.cz](http://www.plujeme.cz)



### E-MAIL

[info@plujeme.cz](mailto:info@plujeme.cz)



### PHONE

+420 720 755 085



### MOBILE

+420 777 170 276



### PLUJEME RÁDI S.R.O.

Dlouhá 730/35, 11000 Praha 1 – Staré Město, Czech Republic