

# OCEANIS 51.1

Aloha (2021)

Sailing yacht Oceanis 51.1 Aloha, built in 2021 is anchored in the Lefkas, D-Marin, Ionian Islands, Greece. It has 5 + 1 cabins, can accommodate 10 + 1 + 1 people and has 4 toilets. Bed linen and kitchen equipment are included in the price.

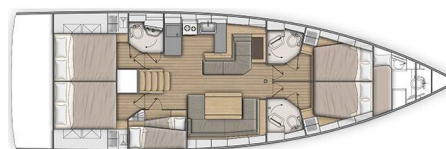

## YACHT SPECIFICATIONS

Yacht Base

**Lefkas, D-Marin, Greece**

Yacht ID

**5971**

Brands

**Beneteau**

Yacht name

**Aloha**

Production year

**2021**

Length

**52 ft**

Cabins

**5 + 1**

Berths

**10 + 1 + 1**

Max Persons

**12**

WC

**4**

Engine

**1 x 110 HP**

Fuel tank

**400 l**



**WEBSITE**

[www.plujeme.cz](http://www.plujeme.cz)



**PHONE**

+420 720 755 085



**MOBILE**

+420 777 170 276



**E-MAIL**

[info@plujeme.cz](mailto:info@plujeme.cz)



**PLUJEME RÁDI S.R.O.**

Dlouhá 730/35, 11000 Praha 1 – Staré Město, Czech Republic

## STANDARD YACHT EQUIPMENT

Comfort	Cockpit cushions, Mosquito nets
Deck	Anchor with chain, Bimini top, Black ball, Black conus, Boat hook, Bosun's chair (Safe seat) (boatswain's chair), Chain counter on helm station, Cockpit table, Deck brush, Dinghy, Electric anchor windlass, Fuel funnel, Gangway, Grill/Barbecue/Plancha, Jerry cans for diesel, Jerry cans for fuel, Mooring ropes, Plastic bucket, Repair box for dinghy, Reserve motor oil, Spare anchor (Reserve, Auxiliary anchor), Sprayhood, Swimming ladder, Teak cockpit, Water hose
Entertainment	FUSION sound system, Indoor speakers, Outdoor speakers, Snorkeling equipment
Galley	Coffee pot, Gas bottles, Kitchen utensils (Galley equipment, cutlery), Oven, Refrigerator, Stove, Wine glasses
Interior	Barometer, Electric fans, Electric fans in cabins, Hand water pump, Indirect lighting in cabins and salon
Navigation	AIS, Autopilot, Binoculars, Bow thruster, Composite steering wheels, Depthsounder, Divider, nautic chart, Hand bearing compass, Navigation (Nautical) charts and nautical guide, Navigation/position Lights, Parallel ruler, Pilot book, Radar reflector, Touch screen Plotter, Wind instrument/Anemometer
Safety	Buoyant smoke signal, Distress flare box, Engine spare parts, EPIRB-Distress radio beacons, Fire blanket, Fire extinguisher, First aid kit, Floating light, Fog horn, Horseshoe lifebuoy, Life belts (Safety harness), Life jacket (children), Liferaft, Search light, Set of tools, Signaling mirror, VHF radio, Wire (shroud) cutter
Sails	Bowsprit, Lazy bag
Yacht electrics	Batteries, Battery charger, Generator, Service batteries, Shore connection 220 V, Solar panels, Watermaker - desalinator



**WEBSITE**  
www.plujeme.cz



**PHONE**  
+420 720 755 085



**MOBILE**  
+420 777 170 276



**E-MAIL**  
info@plujeme.cz



**PLUJEME RÁDI S.R.O.**  
Dlouhá 730/35, 11000 Praha 1 – Staré Město, Czech Republic

## SERVICES

SELECTED SERVICES	OBLIGATORY	PAYMENT TYPE	PRICE
<b>Charter pack</b> (Payable at the base) <b>Season: 2026.</b> includes End Cleaning, Bed Linen & Towels, 1 Gas Bottle, batteries, Water	Yes	per booking	<b>300,00 €</b>
<b>Crew list change</b> (Payable at the base) <b>Season: 2026.</b> Crew change includes administration fee and new crew list to the port authority	No	per crew change	<b>50,00 €</b>
<b>Early boarding/check-in</b> (Payable at the base) <b>Season: 2026.</b> Check in until 13:00 - (must be reconfirmed and depends on if yacht needs repair from charter before)	No	per booking	<b>170,00 €</b>
<b>Hostess</b> (Payable at the base) <b>Season: 2026.</b> Paid on spot in cash. Food provided by clients or to be paid an extra 30€/day, Hostess must have his own cabin.	No	per day + food	<b>180,00 €</b>
<b>Late Check in</b> (Payable at the base) <b>Season: 2026.</b> On Sunday	No	per booking	<b>100,00 €</b>
<b>One way fee</b> (Payable at the base) <b>Season: 2026.</b> Corfu - Lefkas; Lefkas - Corfu	No	one-way	<b>500,00 €</b>
<b>Provisioning</b> (Payable at the base) <b>Season: 2026.</b> order form will be forwarded upon request. Please fill it in and email it back to us, at least 7 days before embarkation. Upon your arrival your food and drinks will be onboard	No	per service	<b>30,00 €</b>
<b>Skipper</b> (Payable at the base) <b>Season: 2026.</b> Paid on spot in cash. Food provided by clients or to be paid an extra 30€/day. Skipper must have his own cabin and access to one of the toilets. Damage waiver is obligatory on skippered charters.	No	per day + food	<b>190,00 €</b>
<b>Transfer</b> (Payable at the base) <b>Season: 2026.</b> upon request 7 days before the starting day	No	per booking	<b>0,00 €</b>
<b>WI-FI Internet connection on boat</b> (Payable at the base) <b>Season: 2026.</b> 5GB, up to 10 connections (deposit €100)	No	per week	<b>50,00 €</b>



**WEBSITE**  
www.plujeme.cz



**E-MAIL**  
info@plujeme.cz



**PHONE**  
+420 720 755 085



**MOBILE**  
+420 777 170 276



**PLUJEME RÁDI S.R.O.**  
Dlouhá 730/35, 11000 Praha 1 – Staré Město, Czech Republic

## ADDITIONAL EXTRAS

EXTRA	OBLIGATORY	PAYMENT TYPE	PRICE
<b>Blister</b> (Payable at the base) <b>Season: 2026.</b> + extra security deposit 500 EUR (refundable) - Payable at the base	No	per week	<b>250,00 €</b>
<b>Extra bedlinen</b> (Payable at the base) <b>Season: 2026.</b> Payable at the base	No	per set	<b>15,00 €</b>
<b>Outboard engine</b> (Payable at the base) <b>Season: 2026.</b> Payable at the base	No	per week	<b>100,00 €</b>
<b>Railing net (Safety net)</b> (Payable at the base) <b>Season: 2026.</b> installed - Payable at the base	No	per booking	<b>250,00 €</b>
<b>Stand up paddle (SUP)</b> (Payable at the base) <b>Season: 2026.</b> Payable at the base	No	per week	<b>130,00 €</b>

**WEBSITE**[www.plujeme.cz](http://www.plujeme.cz)**E-MAIL**[info@plujeme.cz](mailto:info@plujeme.cz)**PHONE**

+420 720 755 085

**MOBILE**

+420 777 170 276

**PLUJEME RÁDI S.R.O.**

Dlouhá 730/35, 11000 Praha 1 – Staré Město, Czech Republic

## PRICE AND AVAILABILITY

13.06. - 20.06.2026 NOT AVAILABLE	20.06. - 27.06.2026 NOT AVAILABLE	27.06. - 04.07.2026 4.819 € 6.670 €	04.07. - 11.07.2026 4.819 € 6.670 €
11.07. - 18.07.2026 4.819 € 6.670 €	18.07. - 25.07.2026 4.819 € 6.670 €	25.07. - 01.08.2026 NOT AVAILABLE	01.08. - 08.08.2026 NOT AVAILABLE
08.08. - 15.08.2026 NOT AVAILABLE	15.08. - 22.08.2026 NOT AVAILABLE	22.08. - 29.08.2026 NOT AVAILABLE	29.08. - 05.09.2026 NOT AVAILABLE
05.09. - 12.09.2026 NOT AVAILABLE	12.09. - 26.09.2026 NOT AVAILABLE	26.09. - 03.10.2026 NOT AVAILABLE	03.10. - 10.10.2026 NOT AVAILABLE
10.10. - 17.10.2026 3.069 € 3.610 €	17.10. - 24.10.2026 3.069 € 3.610 €	24.10. - 31.10.2026 3.069 € 3.610 €	31.10. - 07.11.2026 3.069 € 3.610 €
07.11. - 14.11.2026 3.069 € 3.610 €	14.11. - 21.11.2026 3.069 € 3.610 €	21.11. - 28.11.2026 3.069 € 3.610 €	28.11. - 05.12.2026 3.069 € 3.610 €
05.12. - 12.12.2026 3.610 €	12.12. - 19.12.2026 3.610 €	19.12. - 26.12.2026 3.610 €	



WEBSITE

[www.plujeme.cz](http://www.plujeme.cz)



E-MAIL

[info@plujeme.cz](mailto:info@plujeme.cz)



PHONE

+420 720 755 085



MOBILE

+420 777 170 276



PLUJEME RÁDI S.R.O.

Dlouhá 730/35, 11000 Praha 1 – Staré Město, Czech Republic