

BALI 4.4

Stenella (2022)

Catamaran Bali 4.4 Stenella, built in 2022 is anchored in the Sardinia, Punta Nuraghe, Sardinia, Italy. It has 4 + 1 cabins, can accommodate 8 + 1 people and has 4 toilets. Bed linen and kitchen equipment are included in the price.

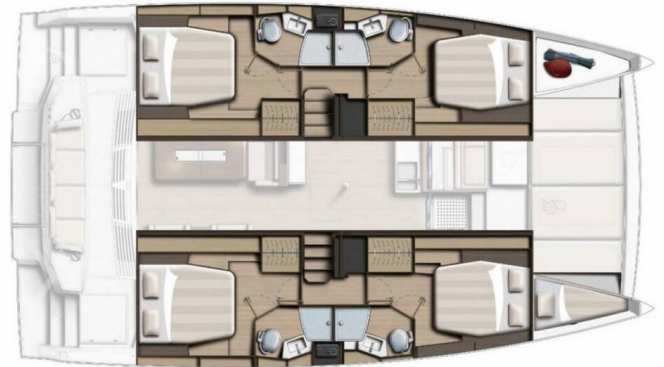

YACHT SPECIFICATIONS

Yacht Base

Sardinia, Punta Nuraghe, Italy

Yacht ID

5844

Brands

Catana

Yacht name

Stenella

Production year

2022

Length

44 ft

Cabins

4 + 1

Berths

8 + 1

WC

4

Engine

2 x 57 HP

Fuel tank

01



WEBSITE

www.plujeme.cz



PHONE

+420 720 755 085



MOBILE

+420 777 170 276



E-MAIL

info@plujeme.cz



PLUJEME RÁDI S.R.O.

Dlouhá 730/35, 11000 Praha 1 – Staré Město, Czech Republic

STANDARD YACHT EQUIPMENT

Comfort	Cockpit cushions, Mattresses
Deck	Anchor, Anchor with chain, Gangway, Grill/Barbecue/Plancha, Tender
Entertainment	Outdoor speakers, Radio, TV, Underwater lights
Galley	Freezer, Freshwater treatment plant, Microwave, Refrigerator, Sink
Interior	Electric toilet
Navigation	GPS chart plotter, GPS chart plotter - cockpit
Sails	Electric winch
Yacht electrics	Battery charger, Inverter, Service batteries, Solar panels



WEBSITE

www.plujeme.cz



E-MAIL

info@plujeme.cz



PHONE

+420 720 755 085



MOBILE

+420 777 170 276



PLUJEME RÁDI S.R.O.

Dlouhá 730/35, 11000 Praha 1 – Staré Město, Czech Republic

SERVICES

SELECTED SERVICES	OBLIGATORY	PAYMENT TYPE	PRICE
Starter pack (Payable at the base) Season: 2026. Starter pack Welcome kit, including eco-friendly products for your personal care; BBQ; water purifier; Bed linen for each cabin, Towel set (1 bath towel + 1 face towel + 1 beach towel for each crew member), 1 Gas Cylinder and Final cleaning.	Yes	per booking	875,00 €
Chef (Payable at the base) Season: 2026. Third-party service, includes 2 consecutive CVs	No	per week + food	1.500,00 €
Damage waiver (Payable at the base) Season: 2026. not refundable, deposit reduced to €1.000	No	per week	500,00 €
Early boarding /Check in from 13:00 (Payable at the base) Season: 2026. subject to availability	No	per service	500,00 €
Entry Fee (Payable at the base) Season: 2026. LA MADDALENA weekly pass: official Park quote upon request + 20% service fee	No	per week	0,00 €
Hostess (Payable at the base) Season: 2026. Third-party service, includes 2 consecutive CVs	No	per week + food	1.400,00 €
Late Check in (Payable at the base) Season: 2026. for boarding after 7pm	No	per service	125,00 €
Late check out (Payable at the base) Season: 2026. Charter contract ends on Saturday at 8am. Obligation to be back on Saturday morning no later than 7 am. Subject to availability!	No	per service	500,00 €
Luggage storage (Payable at the base) Season: 2026. per 1psc standard size luggage	No	per week	30,00 €
Made beds (Payable at the base) Season: 2026. Beds made in 1 cabin (guaranteed after 18:00)	No	per cabin	15,00 €
Pet on board (Payable at the base) Season: 2026. Max 2 of medium size dogs (max 10 kg) are welcome (not allowed below deck: cabins, dinette, kitchen): € 180 extra cleaning, € 500 additional deposit.	No	per booking	185,00 €

Provisioning (Payable at the base) Season: 2026. receipt + 20% extra charge for delivery service onboard	No	per service	0,00 €
Refuel service (Payable at the base) Season: 2026. + assumed fuel litres consumption; Except in August	No	per booking	100,00 €
Refuel service (Payable at the base) Season: 2026. + assumed fuel litres consumption; Except in August	No	per booking	100,00 €
Refuel service (Payable at the base) Season: 2026. + assumed fuel liters consumption; In August	No	per booking	200,00 €
Skipper (Payable at the base) Season: 2026. Third-party service, includes 2 consecutive CVs	No	per week + food	1.900,00 €
Taxi (Payable at the base) Season: 2026. Olbia/base and base/Olbia; by car 1-3 people/way; Minibus 5-8 people/way; Price upon request.	No	per service	0,00 €
WI-FI Internet connection on boat (Payable at the base) Season: 2026. unlimited; guaranteed throughout Italian territory	No	per week	100,00 €



WEBSITE

www.plujeme.cz



PHONE

+420 720 755 085



MOBILE

+420 777 170 276



E-MAIL

info@plujeme.cz



PLUJEME RÁDI S.R.O.

Dlouhá 730/35, 11000 Praha 1 – Staré Město, Czech Republic

ADDITIONAL EXTRAS

EXTRA	OBLIGATORY	PAYMENT TYPE	PRICE
Additional gas bottle (Payable at the base) Season: 2026. Payable at the base	No	per bottle	30,00 €
Air Conditioning (Payable at the base) Season: 2026. A/C DINETTE ONLY AND ON 220 - Payable at the base	No	per week	250,00 €
Canoe (Payable at the base) Season: 2026. Payable at the base	No	per week	200,00 €
Deck cushions (Payable at the base) Season: 2026. Deck sunbed cushions non-customized (2psc) - Payable at the base	No	per week	250,00 €
Deck cushions (Payable at the base) Season: 2026. Customized fly deck cushions - Payable at the base	No	per week	350,00 €
Deck cushions (Payable at the base) Season: 2026. Customized deck sunbed cushions 47'-56' - Payable at the base	No	per week	480,00 €
Hammock (Payable at the base) Season: 2026. Payable at the base	No	per week	38,00 €
Liferaft (Payable at the base) Season: 2026. for 6 pax - Payable at the base	No	per week	200,00 €
Liferaft (Payable at the base) Season: 2026. for 8 pax - Payable at the base	No	per week	250,00 €
Liferaft (Payable at the base) Season: 2026. for 10 pax - Payable at the base	No	per week	300,00 €
NESPRESSO coffee machine (Payable at the base) Season: 2026. Payable at the base	No	per week	50,00 €
Outboard engine (Payable at the base) Season: 2026. Payable at the base	No	per week	200,00 €
Railing net (Safety net) (Payable at the base) Season: 2026. Payable at the base	No	per booking	200,00 €

RIB (Payable at the base)	No	per week	1.550,00 €
Season: 2026. RIB NOVAMARINE RH 550: € 1.550/week (July-Aug) € 1.250/week (May-Jun-Sep) - Payable at the base			
Snorkeling equipment (Payable at the base)	No	per week	25,00 €
Season: 2026. 1x SNORKELING SET - Payable at the base			
Stand up paddle (SUP) (Payable at the base)	No	per week	135,00 €
Season: 2026. Payable at the base			
Watermaker - desalinator (Payable at the base)	No	per week	300,00 €
Season: 2026. Payable at the base			



WEBSITE

www.plujeme.cz



E-MAIL

info@plujeme.cz



PHONE

+420 720 755 085



MOBILE

+420 777 170 276



PLUJEME RÁDI S.R.O.

Dlouhá 730/35, 11000 Praha 1 - Staré Město, Czech Republic

PRICE AND AVAILABILITY

25.04. - 02.05.2026 3.010 € 5.680 €	02.05. - 09.05.2026 3.067 € 6.260 €	09.05. - 16.05.2026 3.425 € 6.850 €	16.05. - 23.05.2026 3.720 € 7.440 €
23.05. - 30.05.2026 4.331 € 8.020 €	30.05. - 06.06.2026 NOT AVAILABLE	06.06. - 13.06.2026 ON OPTION	13.06. - 20.06.2026 ON OPTION
20.06. - 27.06.2026 NOT AVAILABLE	27.06. - 04.07.2026 NOT AVAILABLE	04.07. - 11.07.2026 7.886 € 12.720 €	11.07. - 18.07.2026 NOT AVAILABLE
18.07. - 25.07.2026 NOT AVAILABLE	25.07. - 01.08.2026 7.634 € 14.680 €	01.08. - 08.08.2026 NOT AVAILABLE	08.08. - 15.08.2026 NOT AVAILABLE
15.08. - 22.08.2026 NOT AVAILABLE	22.08. - 29.08.2026 NOT AVAILABLE	29.08. - 05.09.2026 NOT AVAILABLE	05.09. - 12.09.2026 NOT AVAILABLE
12.09. - 19.09.2026 NOT AVAILABLE	19.09. - 26.09.2026 ON OPTION	26.09. - 03.10.2026 5.046 € 8.410 €	03.10. - 10.10.2026 NOT AVAILABLE
10.10. - 17.10.2026 3.230 € 6.460 €	17.10. - 24.10.2026 2.685 € 5.480 €	24.10. - 31.10.2026 2.587 € 5.280 €	31.10. - 07.11.2026 2.545 € 5.090 €
07.11. - 14.11.2026 2.885 € 4.890 €	14.11. - 21.11.2026 2.679 € 4.700 €	21.11. - 28.11.2026 2.610 € 4.500 €	28.11. - 05.12.2026 2.500 € 4.310 €



WEBSITE

www.plujeme.cz



E-MAIL

info@plujeme.cz



PHONE

+420 720 755 085



MOBILE

+420 777 170 276



PLUJEME RÁDI S.R.O.

Dlouhá 730/35, 11000 Praha 1 – Staré Město, Czech Republic

PRICE AND AVAILABILITY

05.12. - 12.12.2026

2.425 € 4.110 €

12.12. - 19.12.2026

2.307 € 3.910 €

19.12. - 26.12.2026

2.457 € 4.310 €



WEBSITE

www.plujeme.cz



E-MAIL

info@plujeme.cz



PHONE

+420 720 755 085



MOBILE

+420 777 170 276



PLUJEME RÁDI S.R.O.

Dlouhá 730/35, 11000 Praha 1 – Staré Město, Czech Republic