

# DUFOUR 56 EXCLUSIVE

Nakupenda (2019)

Sailing yacht Dufour 56 Exclusive Nakupenda, built in 2019 is anchored in the **Sardinia, Punta Nuraghe, Sardinia, Italy**. It has **5 + 1 cabins**, can accommodate **10 + 1 people** and has **3 + 1 toilets**. Bed linen and kitchen equipment are included in the price.

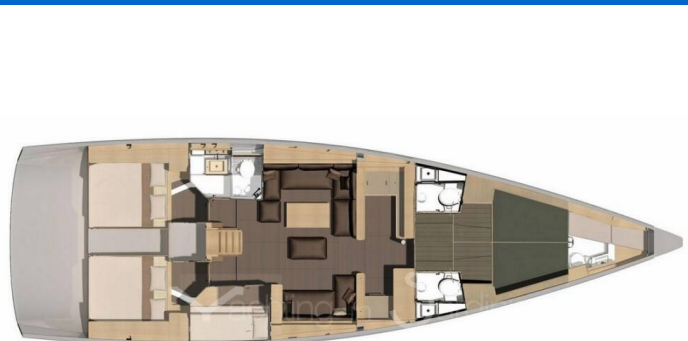

## YACHT SPECIFICATIONS

Yacht Base

**Sardinia, Punta Nuraghe, Italy**

Yacht ID

**5817**

Brands

**Dufour**

Yacht name

**Nakupenda**

Production year

**2019**

Length

**56 ft**

Cabins

**5 + 1**

Berths

**10 + 1**

WC

**3 + 1**

Engine

**1 x 150 HP**

Fuel tank

**01**



**WEBSITE**

[www.plujeme.cz](http://www.plujeme.cz)



**PHONE**

+420 720 755 085



**MOBILE**

+420 777 170 276



**E-MAIL**

[info@plujeme.cz](mailto:info@plujeme.cz)



**PLUJEME RÁDI S.R.O.**

Dlouhá 730/35, 11000 Praha 1 – Staré Město, Czech Republic

## STANDARD YACHT EQUIPMENT

|                 |   |
|-----------------|---|
| Comfort         | <b>Cockpit cushions, Mattresses</b>   |
| Deck            | <b>Anchor, Anchor with chain, Gangway, Grill/Barbecue/Plancha, Hydraulic lifting swimming platform, Teak deck, Tender</b> |
| Entertainment   | <b>Radio, TV, Underwater lights</b>   |
| Galley          | <b>Freezer, Freshwater treatment plant, Microwave, Refrigerator, Sink</b>   |
| Interior        | <b>Electric toilet</b>  |
| Navigation      | <b>GPS chart plotter - cockpit</b>  |
| Sails           | <b>Electric winch</b>   |
| Yacht electrics | <b>Battery charger, Inverter, Service batteries</b>   |



**WEBSITE**

[www.plujeme.cz](http://www.plujeme.cz)



**E-MAIL**

[info@plujeme.cz](mailto:info@plujeme.cz)



**PHONE**

+420 720 755 085



**MOBILE**

+420 777 170 276



**PLUJEME RÁDI S.R.O.**

Dlouhá 730/35, 11000 Praha 1 – Staré Město, Czech Republic

## SERVICES

| SELECTED SERVICES   | OBLIGATORY | PAYMENT TYPE    | PRICE             |
|---|------------|-----------------|-------------------|
| <b>Starter pack</b> (Payable at the base)<br><b>Season: 2026.</b> Starter pack Welcome kit, including eco-friendly products for your personal care; BBQ; water purifier; Bed linen for each cabin, Towel set (1 bath towel + 1 face towel + 1 beach towel for each crew member), 1 Gas Cylinder and Final cleaning. | Yes        | per booking     | <b>720,00 €</b>   |
| <b>Chef</b> (Payable at the base)<br><b>Season: 2026.</b> Third-party service, includes 2 consecutive CVs   | No         | per week + food | <b>1.500,00 €</b> |
| <b>Damage waiver</b> (Payable at the base)<br><b>Season: 2026.</b> not refundable, deposit reduced to €1.000  | No         | per week        | <b>500,00 €</b>   |
| <b>Early boarding /Check in from 13:00</b> (Payable at the base)<br><b>Season: 2026.</b> subject to availability  | No         | per service     | <b>375,00 €</b>   |
| <b>Entry Fee</b> (Payable at the base)<br><b>Season: 2026.</b> LA MADDALENA weekly pass: official Park quote upon request + 20% service fee   | No         | per week        | <b>0,00 €</b>     |
| <b>Hostess</b> (Payable at the base)<br><b>Season: 2026.</b> Third-party service, includes 2 consecutive CVs  | No         | per week + food | <b>1.400,00 €</b> |
| <b>Late Check in</b> (Payable at the base)<br><b>Season: 2026.</b> for boarding after 7pm   | No         | per service     | <b>125,00 €</b>   |
| <b>Late check out</b> (Payable at the base)<br><b>Season: 2026.</b> Charter contract ends on Saturday at 8am. Obligation to be back on Saturday morning no later than 7 am. Subject to availability!  | No         | per service     | <b>375,00 €</b>   |
| <b>Luggage storage</b> (Payable at the base)<br><b>Season: 2026.</b> per 1psc standard size luggage   | No         | per week        | <b>30,00 €</b>    |
| <b>Made beds</b> (Payable at the base)<br><b>Season: 2026.</b> Beds made in 1 cabin (guaranteed after 18:00)  | No         | per cabin       | <b>15,00 €</b>    |
| <b>Pet on board</b> (Payable at the base)<br><b>Season: 2026.</b> Max 2 of medium size dogs (max 10 kg) are welcome (not allowed below deck: cabins, dinette, kitchen): € 180 extra cleaning, € 500 additional deposit.   | No         | per booking     | <b>185,00 €</b>   |

|   |    |                 |                   |
|---|----|-----------------|-------------------|
| <b>Provisioning</b> (Payable at the base)<br><b>Season: 2026.</b> receipt + 20% extra charge for delivery service onboard                               | No | per service     | <b>0,00 €</b>     |
| <b>Refuel service</b> (Payable at the base)<br><b>Season: 2026.</b> + assumed fuel litres consumption; Except in August                                 | No | per booking     | <b>100,00 €</b>   |
| <b>Refuel service</b> (Payable at the base)<br><b>Season: 2026.</b> + assumed fuel litres consumption; Except in August                                 | No | per booking     | <b>100,00 €</b>   |
| <b>Refuel service</b> (Payable at the base)<br><b>Season: 2026.</b> + assumed fuel liters consumption; In August  | No | per booking     | <b>200,00 €</b>   |
| <b>Skipper</b> (Payable at the base)<br><b>Season: 2026.</b> Third-party service, includes 2 consecutive CVs  | No | per week + food | <b>1.900,00 €</b> |
| <b>Taxi</b> (Payable at the base)<br><b>Season: 2026.</b> Olbia/base and base/Olbia; by car 1-3 people/way; Minibus 5-8 people/way; Price upon request. | No | per service     | <b>0,00 €</b>     |
| <b>WI-FI Internet connection on boat</b> (Payable at the base)<br><b>Season: 2026.</b> unlimited; guaranteed throughout Italian territory               | No | per week        | <b>100,00 €</b>   |



**WEBSITE**

[www.plujeme.cz](http://www.plujeme.cz)



**E-MAIL**

[info@plujeme.cz](mailto:info@plujeme.cz)



**PHONE**

+420 720 755 085



**MOBILE**

+420 777 170 276



**PLUJEME RÁDI S.R.O.**

Dlouhá 730/35, 11000 Praha 1 – Staré Město, Czech Republic

## ADDITIONAL EXTRAS

| EXTRA   | OBLIGATORY | PAYMENT TYPE | PRICE           |
|---|------------|--------------|-----------------|
| <b>Additional gas bottle</b> (Payable at the base)<br><b>Season: 2026.</b> Payable at the base                                      | No         | per bottle   | <b>30,00 €</b>  |
| <b>Air Conditioning</b> (Payable at the base)<br><b>Season: 2026.</b> A/C DINETTE ONLY AND ON 220 - Payable at the base             | No         | per week     | <b>250,00 €</b> |
| <b>Bow thruster</b> (Payable at the base)<br><b>Season: 2026.</b> Payable at the base   | No         | per week     | <b>150,00 €</b> |
| <b>Canoe</b> (Payable at the base)<br><b>Season: 2026.</b> Payable at the base  | No         | per week     | <b>200,00 €</b> |
| <b>Deck cushions</b> (Payable at the base)<br><b>Season: 2026.</b> Deck sunbed cushions non-customized (2psc) - Payable at the base | No         | per week     | <b>250,00 €</b> |
| <b>Deck cushions</b> (Payable at the base)<br><b>Season: 2026.</b> Customized deck sunbed cushions 47'-56' - Payable at the base    | No         | per week     | <b>480,00 €</b> |
| <b>Gennaker</b> (Payable at the base)<br><b>Season: 2026.</b> Payable at the base   | No         | per week     | <b>350,00 €</b> |
| <b>Hammock</b> (Payable at the base)<br><b>Season: 2026.</b> Payable at the base  | No         | per week     | <b>38,00 €</b>  |
| <b>Liferaft</b> (Payable at the base)<br><b>Season: 2026.</b> for 6 pax - Payable at the base                                       | No         | per week     | <b>200,00 €</b> |
| <b>Liferaft</b> (Payable at the base)<br><b>Season: 2026.</b> for 8 pax - Payable at the base                                       | No         | per week     | <b>250,00 €</b> |
| <b>Liferaft</b> (Payable at the base)<br><b>Season: 2026.</b> for 10 pax - Payable at the base                                      | No         | per week     | <b>300,00 €</b> |
| <b>Outboard engine</b> (Payable at the base)<br><b>Season: 2026.</b> Payable at the base  | No         | per week     | <b>170,00 €</b> |
| <b>Railing net (Safety net)</b> (Payable at the base)<br><b>Season: 2026.</b> Payable at the base                                   | No         | per booking  | <b>250,00 €</b> |

|  |    |          |                   |
|--|----|----------|-------------------|
| <b>RIB</b> (Payable at the base)   | No | per week | <b>1.550,00 €</b> |
| <b>Season: 2026.</b> RIB NOVAMARINE RH 550: € 1.550/week (July-Aug) € 1.250/week (May-Jun-Sep) - Payable at the base |    |          |                   |
| <b>Snorkeling equipment</b> (Payable at the base)  | No | per week | <b>25,00 €</b>    |
| <b>Season: 2026.</b> 1x SNORKELING SET - Payable at the base   |    |          |                   |
| <b>Stand up paddle (SUP)</b> (Payable at the base)   | No | per week | <b>135,00 €</b>   |
| <b>Season: 2026.</b> Payable at the base   |    |          |                   |
| <b>Stern thruster</b> (Payable at the base)  | No | per week | <b>150,00 €</b>   |
| <b>Season: 2026.</b> Payable at the base   |    |          |                   |
| <b>Watermaker - desalinator</b> (Payable at the base)  | No | per week | <b>300,00 €</b>   |
| <b>Season: 2026.</b> Payable at the base   |    |          |                   |



**WEBSITE**

[www.plujeme.cz](http://www.plujeme.cz)



**E-MAIL**

[info@plujeme.cz](mailto:info@plujeme.cz)



**PHONE**

+420 720 755 085



**MOBILE**

+420 777 170 276



**PLUJEME RÁDI S.R.O.**

Dlouhá 730/35, 11000 Praha 1 - Staré Město, Czech Republic

## PRICE AND AVAILABILITY

|   |  |   |  |
|---|--|---|--|
| 25.04. - 02.05.2026<br><b>2.198 €</b> 4.580 € | 02.05. - 09.05.2026<br><b>2.204 €</b> 5.010 €  | 09.05. - 16.05.2026<br><b>2.385 €</b> 5.300 € | 16.05. - 23.05.2026<br><b>2.571 €</b> 5.590 €  |
| 23.05. - 30.05.2026<br><b>2.759 €</b> 5.870 € | 30.05. - 06.06.2026<br>NOT AVAILABLE           | 06.06. - 13.06.2026<br><b>3.097 €</b> 6.590 € | 13.06. - 20.06.2026<br>NOT AVAILABLE           |
| 20.06. - 27.06.2026<br><b>3.638 €</b> 7.740 € | 02.07. - 05.07.2026<br>NOT AVAILABLE           | 11.07. - 18.07.2026<br><b>3.846 €</b> 8.740 € | 18.07. - 25.07.2026<br><b>4.085 €</b> 8.880 €  |
| 25.07. - 01.08.2026<br>NOT AVAILABLE          | 01.08. - 08.08.2026<br><b>4.271 €</b> 10.170 € | 08.08. - 15.08.2026<br>NOT AVAILABLE          | 15.08. - 22.08.2026<br><b>4.664 €</b> 10.600 € |
| 22.08. - 29.08.2026<br><b>4.127 €</b> 9.170 € | 29.08. - 05.09.2026<br><b>4.386 €</b> 8.600 €  | 05.09. - 12.09.2026<br>NOT AVAILABLE          | 12.09. - 19.09.2026<br>NOT AVAILABLE           |
| 19.09. - 26.09.2026<br><b>3.089 €</b> 7.020 € | 26.09. - 03.10.2026<br><b>3.612 €</b> 6.450 €  | 03.10. - 10.10.2026<br><b>2.636 €</b> 5.730 € | 10.10. - 17.10.2026<br><b>2.104 €</b> 5.010 €  |
| 17.10. - 24.10.2026<br><b>1.849 €</b> 4.300 € | 24.10. - 31.10.2026<br><b>1.826 €</b> 4.150 €  | 31.10. - 07.11.2026<br><b>1.805 €</b> 4.010 € | 07.11. - 14.11.2026<br><b>2.167 €</b> 3.870 €  |
| 14.11. - 21.11.2026<br><b>1.940 €</b> 3.730 € | 21.11. - 28.11.2026<br><b>1.897 €</b> 3.580 €  | 28.11. - 05.12.2026<br><b>1.858 €</b> 3.440 € |  |



WEBSITE

[www.plujeme.cz](http://www.plujeme.cz)



E-MAIL

[info@plujeme.cz](mailto:info@plujeme.cz)



PHONE

+420 720 755 085



MOBILE

+420 777 170 276



PLUJEME RÁDI S.R.O.

Dlouhá 730/35, 11000 Praha 1 – Staré Město, Czech Republic

## PRICE AND AVAILABILITY

05.12. - 12.12.2026

**1.815 €** 3.300 €

12.12. - 19.12.2026

**1.764 €** 3.150 €

19.12. - 26.12.2026

**2.012 €** 3.870 €



**WEBSITE**

[www.plujeme.cz](http://www.plujeme.cz)



**E-MAIL**

[info@plujeme.cz](mailto:info@plujeme.cz)



**PHONE**

+420 720 755 085



**MOBILE**

+420 777 170 276



**PLUJEME RÁDI S.R.O.**

Dlouhá 730/35, 11000 Praha 1 – Staré Město, Czech Republic