

LEOPARD 45

Marina (2018)

Catamaran **Leopard 45 Marina**, built in **2018** is anchored in the **Athens, Alimos marina, Athens area/Saronic/Peloponese, Greece**. It has **4 cabins**, can accommodate **8 people** and has **4 toilets**. Bed linen and kitchen equipment are included in the price.

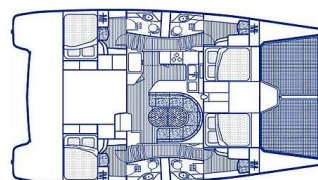

YACHT SPECIFICATIONS

Yacht Base

Athens, Alimos marina, Greece

Yacht ID

5740

Brands

Leopard

Yacht name

Marina

Production year

2018

Length

45 ft

Cabins

4

Berths

8

WC

4

Engine

2 x 45 HP

Fuel tank

700 l



WEBSITE

www.plujeme.cz



PHONE

+420 720 755 085



MOBILE

+420 777 170 276



E-MAIL

info@plujeme.cz



PLUJEME RÁDI S.R.O.

Dlouhá 730/35, 11000 Praha 1 – Staré Město, Czech Republic

STANDARD YACHT EQUIPMENT

Deck	Bimini top, Dinghy, Main Deck Compass, Sprayhood
Entertainment	Outdoor speakers, Radio CD player, TV
Galley	Hot water, Refrigerator
Interior	Electric toilet
Navigation	Autopilot, GPS chart plotter
Safety	Distress flare box, Fire extinguisher, First aid kit, Life jackets, Liferaft, Safety equipment
Sails	Lazy bag
Yacht electrics	Air Conditioning, Generator, Watermaker - desalinator



WEBSITE

www.plujeme.cz



E-MAIL

info@plujeme.cz



PHONE

+420 720 755 085



MOBILE

+420 777 170 276



PLUJEME RÁDI S.R.O.

Dlouhá 730/35, 11000 Praha 1 – Staré Město, Czech Republic

SERVICES

SELECTED SERVICES	OBLIGATORY	PAYMENT TYPE	PRICE
Final cleaning (Payable at the base) Season: 2026.	Yes	per booking	400,00 €
Skipper (Payable at the base) Season: 2026.	Yes	per day + food	190,00 €
Cabin conversion (Payable at the base) Season: 2026.	No	per booking	100,00 €
Family pack (Payable at the base) Season: 2026. railing net, junior life jackets	No	per week	350,00 €
Fast Track pack (Payable at the base) Season: 2026. embarkation by 14:00	No	per booking	150,00 €
Hostess (Payable at the base) Season: 2026.	No	per day + food	170,00 €
Internet pack (Payable at the base) Season: 2026. Unlimited	No	per booking	100,00 €
One way (Payable at the base) Season: 2026. Athens to Cyclades min. price € 1000	No	one-way	1.000,00 €
Service Pack (Payable at the base) Season: 2026. bed linen, blankets, pillow cases, face towel, body towel, beach towel, soap, shampoo, shower gel	No	per person	15,00 €
Skipper (Payable at the base) Season: 2026.	No	per day + food	190,00 €
Transfer (Payable at the base) Season: 2026. Price upon request, depending on location and number of people	No	per person	15,00 €
VIP Pack (Payable at the base) Season: 2026. airport/port welcome, transfer to the yacht, welcome pack with sparkling wine and fruits	No	per booking	320,00 €

Plujeme



WEBSITE

www.plujeme.cz



PHONE

+420 720 755 085



MOBILE

+420 777 170 276



E-MAIL

info@plujeme.cz



PLUJEME RÁDI S.R.O.

Dlouhá 730/35, 11000 Praha 1 – Staré Město, Czech Republic

ADDITIONAL EXTRAS

EXTRA	OBLIGATORY	PAYMENT TYPE	PRICE
Coffee machine (Payable at the base) Season: 2026. + 20 capsules - Payable at the base	No	per week	50,00 €
Fishing equipment (Payable at the base) Season: 2026. refundable deposit 200€ - Payable at the base	No	per week	50,00 €
Grill/Barbecue/Plancha (Payable at the base) Season: 2026. Payable at the base	No	per week	80,00 €
Kayak (Payable at the base) Season: 2026. or canoe; refundable deposit 400€ - Payable at the base	No	per week	110,00 €
Outboard engine (Payable at the base) Season: 2026. 2 - 2.5 hp - Payable at the base	No	per week	100,00 €
Stand up paddle (SUP) (Payable at the base) Season: 2026. refundable deposit 200€ - Payable at the base	No	per week	130,00 €
Underwater scooter (Payable at the base) Season: 2026. Payable at the base	No	per week	200,00 €



WEBSITE
www.plujeme.cz



E-MAIL
info@plujeme.cz



PHONE
+420 720 755 085



PLUJEME RÁDI S.R.O.
Dlouhá 730/35, 11000 Praha 1 – Staré Město, Czech Republic



MOBILE
+420 777 170 276

PRICE AND AVAILABILITY

25.04. - 02.05.2026 4.080 € 4.800 €	02.05. - 09.05.2026 4.080 € 4.800 €	09.05. - 16.05.2026 4.080 € 4.800 €	16.05. - 23.05.2026 5.797 € 6.820 €
23.05. - 30.05.2026 5.797 € 6.820 €	30.05. - 06.06.2026 5.797 € 6.820 €	06.06. - 13.06.2026 6.647 € 7.820 €	13.06. - 20.06.2026 7.319 € 8.610 €
20.06. - 27.06.2026 7.319 € 8.610 €	27.06. - 04.07.2026 7.319 € 8.610 €	04.07. - 11.07.2026 7.735 € 9.100 €	11.07. - 18.07.2026 7.319 € 8.610 €
18.07. - 25.07.2026 NOT AVAILABLE	25.07. - 01.08.2026 7.786 € 9.160 €	01.08. - 08.08.2026 8.058 € 9.480 €	08.08. - 15.08.2026 7.676 € 9.030 €
15.08. - 22.08.2026 7.531 € 8.860 €	22.08. - 29.08.2026 7.404 € 8.710 €	29.08. - 05.09.2026 7.336 € 8.630 €	05.09. - 12.09.2026 7.395 € 8.700 €
12.09. - 19.09.2026 7.310 € 8.600 €	19.09. - 26.09.2026 6.715 € 7.900 €	26.09. - 03.10.2026 5.525 € 6.500 €	03.10. - 10.10.2026 5.270 € 6.200 €
10.10. - 17.10.2026 4.590 € 5.400 €	17.10. - 24.10.2026 3.995 € 4.700 €	24.10. - 31.10.2026 3.825 € 4.500 €	31.10. - 07.11.2026 3.570 € 4.200 €
07.11. - 14.11.2026 3.570 € 4.200 €	14.11. - 21.11.2026 3.570 € 4.200 €	21.11. - 28.11.2026 3.570 € 4.200 €	28.11. - 05.12.2026 3.570 € 4.200 €



WEBSITE

www.plujeme.cz



E-MAIL

info@plujeme.cz



PHONE

+420 720 755 085



MOBILE

+420 777 170 276



PLUJEME RÁDI S.R.O.

Dlouhá 730/35, 11000 Praha 1 – Staré Město, Czech Republic

PRICE AND AVAILABILITY

05.12. - 12.12.2026

3.570 € 4.200 €

12.12. - 19.12.2026

4.378 € 5.150 €

19.12. - 26.12.2026

4.378 € 5.150 €



WEBSITE

www.plujeme.cz



E-MAIL

info@plujeme.cz



PHONE

+420 720 755 085



MOBILE

+420 777 170 276



PLUJEME RÁDI S.R.O.

Dlouhá 730/35, 11000 Praha 1 – Staré Město, Czech Republic