

OCEANIS 51.1

Bluescape II (2020)

Sailing yacht Oceanis 51.1 Bluescape II, built in 2020 is anchored in the **Lavrion, main port, Athens area/Saronic/Peloponese, Greece**. It has **6 cabins**, can accommodate **12 people** and has **4 toilets**. Bed linen and kitchen equipment are included in the price.

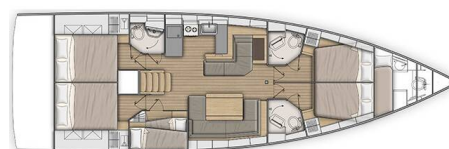

YACHT SPECIFICATIONS

Yacht Base

Lavrion, main port, Greece

Yacht ID

5724

Brands

Beneteau

Yacht name

Bluescape II

Production year

2020

Length

52 ft

Cabins

6

Berths

12

Max Persons

12

WC

4

Engine

1 x 110 HP

Fuel tank

200 l



WEBSITE

www.plujeme.cz



PHONE

+420 720 755 085



MOBILE

+420 777 170 276



E-MAIL

info@plujeme.cz



PLUJEME RÁDI S.R.O.

Dlouhá 730/35, 11000 Praha 1 – Staré Město, Czech Republic

STANDARD YACHT EQUIPMENT

Comfort	Bedlinen and towels, Blankets, Pillows
Deck	Bimini top, Cockpit table, Cockpit/stern, outside shower, Dinghy with outboard engine, Electric anchor windlass, Sprayhood, Teak cockpit
Entertainment	Outdoor speakers, Radio mp3 player, TV
Galley	Freezer, Gas bottles, Hot water, Microwave, Refrigerator
Interior	Convertible table in salon, Electric fans, Electric toilet
Navigation	Autopilot, Bow thruster, Echosounder/Depthsounder, GPS chart plotter - cockpit, Radar, Wind instrument/Anemometer, Windex
Yacht electrics	12V Socket, Battery charger, Heating, Inverter, Solar panels



WEBSITE

www.plujeme.cz



E-MAIL

info@plujeme.cz



PHONE

+420 720 755 085



MOBILE

+420 777 170 276



PLUJEME RÁDI S.R.O.

Dlouhá 730/35, 11000 Praha 1 – Staré Město, Czech Republic

SERVICES

SELECTED SERVICES	OBLIGATORY	PAYMENT TYPE	PRICE
Charter package (Payable at the base) Season: 2026. End cleaning, Bed linen & Towels (one set per person per week), first fill for outboard engine, outboard engine, 1 spare bottle of gas, full water tanks, snorkeling equipment	Yes	per booking	300,00 €
Cook (Payable at the base) Season: 2026. Crews' food - If compensation is agreed, it will be at least €30 per crew member per day	No	per day + food	215,00 €
Damage waiver (Payable at the base) Season: 2026. plus refundable deposit 700 euro by credit card. The security deposit reduction is mandatory in case of a skippered charter. Prices subject to change without notice.	No	per booking	420,00 €
Deckhand/ Marinero (Payable at the base) Season: 2026. Crews' food - If compensation is agreed, it will be at least €30 per crew member per day	No	per day + food	150,00 €
Early boarding/check-in (Payable at the base) Season: 2026. access to the yacht by 14:00	No	per booking	200,00 €
Hostess (Payable at the base) Season: 2026. (serving breakfast and one light meal daily)	No	per day + food	180,00 €
Pet on board (Payable at the base) Season: 2026.	No	per booking	100,00 €
Skipper (Payable at the base) Season: 2026. Damage waiver is mandatory in case of a skippered charter In case of skipper cancellation, there is a minimum charge of 50%	No	per day + food	215,00 €
Transfer (Payable at the base) Season: 2026. Athens Airport (ATH) - Lavrio port, Taxi	No	one-way	60,00 €
Transfer (Payable at the base) Season: 2026. Athens Airport (ATH) - Lavrio port, Minibus (up to 7 pax)	No	one-way	110,00 €
Transfer (Payable at the base) Season: 2026. Athens Airport (ATH) - Lavrio port, Minibus (8 - 15 pax)	No	one-way	140,00 €

WI-FI Internet connection on boat (Payable at the base)

No

per week

90,00 €

Season: 2026. (connects up to 8-10 devices) on GSM, unlimited



WEBSITE

www.plujeme.cz



E-MAIL

info@plujeme.cz



PHONE

+420 720 755 085



MOBILE

+420 777 170 276



PLUJEME RÁDI S.R.O.

Dlouhá 730/35, 11000 Praha 1 – Staré Město, Czech Republic

ADDITIONAL EXTRAS

EXTRA	OBLIGATORY	PAYMENT TYPE	PRICE
Beach towel (Payable at the base) Season: 2026. Payable at the base	No	per piece	10,00 €
Extra bedlinen and towels (Payable at the base) Season: 2026. Payable at the base	No	per set	10,00 €
Gennaker (Payable at the base) Season: 2026. + refundable deposit 500 Euro - Payable at the base	No	per week	250,00 €
Grill/Barbecue/Plancha (Payable at the base) Season: 2026. BBQ (eco-friendly, biodegradable single use grill - max use 1 hour) - Payable at the base	No	per piece	15,00 €
Inflatable lifejacket (Payable at the base) Season: 2026. Payable at the base	No	per week	15,00 €
Kayak (Payable at the base) Season: 2026. Payable at the base	No	per week	100,00 €
Railing net (Safety net) (Payable at the base) Season: 2026. Payable at the base	No	per booking	200,00 €
Stand up paddle (SUP) (Payable at the base) Season: 2026. Payable at the base	No	per week	100,00 €
Underwater scooter (Payable at the base) Season: 2026. + 300,00 Euro refundable deposit - Payable at the base	No	per week	200,00 €



WEBSITE
www.plujeme.cz



PHONE
+420 720 755 085



MOBILE
+420 777 170 276



E-MAIL
info@plujeme.cz



PLUJEME RÁDI S.R.O.
Dlouhá 730/35, 11000 Praha 1 – Staré Město, Czech Republic

PRICE AND AVAILABILITY

25.04. - 02.05.2026 NOT AVAILABLE	02.05. - 09.05.2026 NOT AVAILABLE	09.05. - 23.05.2026 NOT AVAILABLE	23.05. - 30.05.2026 NOT AVAILABLE
30.05. - 06.06.2026 NOT AVAILABLE	06.06. - 13.06.2026 NOT AVAILABLE	13.06. - 20.06.2026 4.891 € 6.700 €	20.06. - 27.06.2026 NOT AVAILABLE
27.06. - 04.07.2026 5.256 € 7.200 €	04.07. - 11.07.2026 NOT AVAILABLE	11.07. - 18.07.2026 5.976 € 7.200 €	18.07. - 25.07.2026 5.976 € 7.200 €
25.07. - 01.08.2026 5.976 € 7.200 €	01.08. - 08.08.2026 6.806 € 8.200 €	08.08. - 15.08.2026 6.806 € 8.200 €	15.08. - 22.08.2026 6.806 € 8.200 €
22.08. - 29.08.2026 6.225 € 7.500 €	29.08. - 05.09.2026 6.600 € 7.500 €	05.09. - 12.09.2026 NOT AVAILABLE	12.09. - 19.09.2026 NOT AVAILABLE
19.09. - 26.09.2026 6.600 € 7.500 €	26.09. - 10.10.2026 NOT AVAILABLE	10.10. - 17.10.2026 4.664 € 5.300 €	17.10. - 24.10.2026 3.520 € 4.000 €
24.10. - 31.10.2026 3.520 € 4.000 €	31.10. - 07.11.2026 3.520 € 4.000 €	07.11. - 14.11.2026 3.520 € 4.000 €	14.11. - 21.11.2026 3.520 € 4.000 €
21.11. - 28.11.2026 3.520 € 4.000 €	29.11. - 31.12.2026 NOT AVAILABLE		



WEBSITE

www.plujeme.cz



E-MAIL

info@plujeme.cz



PHONE

+420 720 755 085



MOBILE

+420 777 170 276



PLUJEME RÁDI S.R.O.

Dlouhá 730/35, 11000 Praha 1 – Staré Město, Czech Republic

PRICE AND AVAILABILITY

01.01. - 26.03.2027 NOT AVAILABLE	27.03. - 03.04.2027 2.250 € 2.500 €	03.04. - 10.04.2027 2.250 € 2.500 €	10.04. - 17.04.2027 2.250 € 2.500 €
17.04. - 24.04.2027 2.250 € 2.500 €	24.04. - 01.05.2027 3.330 € 3.700 €	01.05. - 08.05.2027 3.330 € 3.700 €	08.05. - 15.05.2027 3.870 € 4.300 €
15.05. - 22.05.2027 3.870 € 4.300 €	22.05. - 29.05.2027 5.490 € 6.100 €	29.05. - 05.06.2027 5.490 € 6.100 €	05.06. - 12.06.2027 6.030 € 6.700 €
12.06. - 19.06.2027 6.030 € 6.700 €	19.06. - 26.06.2027 6.480 € 7.200 €	26.06. - 03.07.2027 6.480 € 7.200 €	03.07. - 10.07.2027 6.480 € 7.200 €
10.07. - 17.07.2027 6.480 € 7.200 €	17.07. - 24.07.2027 6.480 € 7.200 €	24.07. - 31.07.2027 6.480 € 7.200 €	31.07. - 07.08.2027 7.380 € 8.200 €



WEBSITE
www.plujeme.cz



E-MAIL
info@plujeme.cz



PHONE
+420 720 755 085



PLUJEME RÁDI S.R.O.
Dlouhá 730/35, 11000 Praha 1 – Staré Město, Czech Republic



MOBILE
+420 777 170 276

PRICE AND AVAILABILITY

07.08. - 14.08.2027 7.380 € 8.200 €	14.08. - 21.08.2027 7.380 € 8.200 €	21.08. - 28.08.2027 6.750 € 7.500 €	28.08. - 04.09.2027 6.750 € 7.500 €
04.09. - 11.09.2027 6.750 € 7.500 €	11.09. - 18.09.2027 6.750 € 7.500 €	18.09. - 25.09.2027 6.750 € 7.500 €	25.09. - 02.10.2027 5.310 € 5.900 €
02.10. - 09.10.2027 4.770 € 5.300 €	09.10. - 16.10.2027 4.770 € 5.300 €	16.10. - 23.10.2027 3.600 € 4.000 €	23.10. - 30.10.2027 3.600 € 4.000 €
30.10. - 06.11.2027 3.600 € 4.000 €	06.11. - 13.11.2027 3.600 € 4.000 €	13.11. - 20.11.2027 3.600 € 4.000 €	20.11. - 27.11.2027 3.600 € 4.000 €
28.11. - 31.12.2027 NOT AVAILABLE			



WEBSITE

www.plujeme.cz



E-MAIL

info@plujeme.cz



PHONE

+420 720 755 085



MOBILE

+420 777 170 276



PLUJEME RÁDI S.R.O.

Dlouhá 730/35, 11000 Praha 1 – Staré Město, Czech Republic