

FOUNTAIN PAJOT ASTREA 42 MAESTRO

Wayfinder (2023)

Catamaran Fountaine Pajot Astrea 42 Maestro Wayfinder, built in 2023 is anchored in the **Bahamas, Abacos, Boat Harbour Marina, Abaco Islands, Bahamas**. It has **3 cabins**, can accommodate **6 people** and has **3 toilets**. Bed linen and kitchen equipment are included in the price.

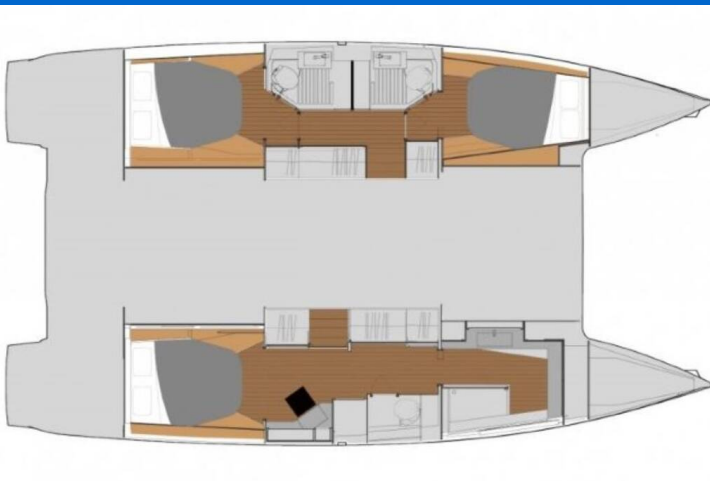

YACHT SPECIFICATIONS

Yacht Base

**Bahamas, Abacos, Boat Harbour
Marina, Bahamas**

Yacht ID

5679

Brands

Fountaine Pajot

Yacht name

Wayfinder

Production year

2023

Length

41 ft

Cabins

3

Berths

6

Max Persons

6

WC

3

Engine

2 x 50 HP

Fuel tank

470 l



WEBSITE

www.plujeme.cz



PHONE

+420 720 755 085



MOBILE

+420 777 170 276



E-MAIL

info@plujeme.cz



PLUJEME RÁDI S.R.O.

Dlouhá 730/35, 11000 Praha 1 – Staré Město, Czech Republic

STANDARD YACHT EQUIPMENT

Deck	Bathing platform, Bimini top, Cockpit table, Cockpit/stern, outside shower, Dinghy with outboard engine, Electric anchor windlass, Grill/Barbecue/Plancha
Entertainment	Fusion radio, Indoor speakers, Outdoor speakers
Galley	Freezer, Ice box, Kitchen utensils (Galley equipment, cutlery), Microwave, Refrigerator, Stove
Interior	Coolbox, Electric toilet
Navigation	Autopilot, GPS chart plotter - cockpit, Helm station, Wind/speed/depth instruments
Safety	Black Water Tank, VHF radio
Sails	Electric winch, Lazy bag, Lazy jacks
Yacht electrics	110V socket, Air Conditioning, Generator, Inverter, USB sockets



WEBSITE

www.plujeme.cz



E-MAIL

info@plujeme.cz



PHONE

+420 720 755 085



MOBILE

+420 777 170 276



PLUJEME RÁDI S.R.O.

Dlouhá 730/35, 11000 Praha 1 – Staré Město, Czech Republic

SERVICES

SELECTED SERVICES	OBLIGATORY	PAYMENT TYPE	PRICE
Bahamas foreign charter tax (Payable now) Season: 2026.	Yes	per booking	0,00 €
Bahamas Taxes (Payable now) Season: 2026.	Yes	per booking	0,00 €
DRA (Payable now) Season: 2026.	Yes	per day	50,00 €
ASA Processing Fee (Payable now) Season: 2026. Certificate 103	No	per person/per course	150,00 €
ASA Processing Fee (Payable now) Season: 2026. Certificate 101	No	per person/per course	150,00 €
ASA Processing Fee (Payable now) Season: 2026. Certificate 114	No	per person/per course	200,00 €
ASA Processing Fee (Payable now) Season: 2026. Certificate 104	No	per person/per course	200,00 €
ASA Processing Fee (Payable now) Season: 2026. Overnight Open Water. Available only on Flotilla Sails; Certificate 106	No	per person/per course	250,00 €
ASA Processing Fee (Payable now) Season: 2026. Certificate 101, 103 & 104	No	per person/per course	400,00 €
ASA Processing Fee (Payable now) Season: 2026. Overnight Open Water. Available only on Flotilla Sails; Certificate 105	No	per person/per course	400,00 €
ASA Processing Fee (Payable now) Season: 2026. Overnight Open Water. Available only on Flotilla Sails; Certificate 105 & 106	No	per person/per course	550,00 €
Captain By Day (Payable now) Season: 2026.	No	per day + food	350,00 €

Captain By Night (Payable now) Season: 2026.	No	per night	450,00 €
Chef (Payable now) Season: 2026. Overnight	No	per day + food	400,00 €
Credit card surcharge (Payable now) Season: 2026. A 3% convenience fee will be added to all credit card transactions	No	per booking	0,00 €
Daily trips (Payable now) Season: 2026. Trips north from Guana	No	per booking	400,00 €
Education (Payable at the base) Season: 2026. NauticEd skipper training hours	No	per person/per course	100,00 €
Education (Payable at the base) Season: 2026. NauticEd bareboat hours	No	per person/per course	200,00 €
Extra cleaning (Payable at the base) Season: 2026.	No	per service	400,00 €
Fuel charge (Payable now) Season: 2026. + 500,00\$ deposit; This is only for day trips	No	per booking	300,00 €
Gratuity (Payable now) Season: 2026. On Day Trips	No	per booking	220,00 €
Hostess/Cook (Payable now) Season: 2026.	No	per day + food	350,00 €
Participation fee (Payable at the base) Season: 2026. NauticEd sign up fee	No	per person/per course	175,00 €
Rescheduling (Payable now) Season: 2026. On Day Trips	No	per booking	350,00 €
Sleep over after check out (Payable now) Season: 2026.	No	per booking	700,00 €
Sleep over before check in (Payable now) Season: 2026. at 12:00 PM	No	per booking	700,00 €



WEBSITE
www.plujeme.cz



PHONE
+420 720 755 085



MOBILE
+420 777 170 276



E-MAIL
info@plujeme.cz



PLUJEME RÁDI S.R.O.
Dlouhá 730/35, 11000 Praha 1 – Staré Město, Czech Republic

ADDITIONAL EXTRAS

EXTRA	OBLIGATORY	PAYMENT TYPE	PRICE
Fins (Payable now) Season: 2026. Payable now	No	per week/ person	35,00 €
Fishing cane/rod (Payable now) Season: 2026. Payable now	No	per week	60,00 €
Inflatable swimming platform (Payable now) Season: 2026. POP-UP DOCK - Payable now	No	per week	250,00 €
Kayak (Payable now) Season: 2026. Tandem - Payable now	No	per week	250,00 €
Snorkeling equipment (Payable now) Season: 2026. Payable now	No	per week/ person	50,00 €
Stand up paddle (SUP) (Payable now) Season: 2026. Payable now	No	per week	250,00 €
Starlink (Payable now) Season: 2026. Payable now	No	per week	100,00 €



WEBSITE
www.plujeme.cz



E-MAIL
info@plujeme.cz



PHONE
+420 720 755 085



PLUJEME RÁDI S.R.O.
Dlouhá 730/35, 11000 Praha 1 – Staré Město, Czech Republic



MOBILE
+420 777 170 276

PRICE AND AVAILABILITY

09.05. - 25.05.2026 NOT AVAILABLE	30.05. - 06.06.2026 5.838 €	06.06. - 13.06.2026 5.838 €	17.06. - 29.06.2026 NOT AVAILABLE
04.07. - 11.07.2026 5.838 €	11.07. - 18.07.2026 5.838 €	18.07. - 25.07.2026 5.838 €	25.07. - 01.08.2026 7.099 €
01.08. - 04.11.2026 NOT AVAILABLE	07.11. - 14.11.2026 5.838 €	14.11. - 21.11.2026 5.838 €	21.11. - 28.11.2026 5.838 €
28.11. - 05.12.2026 5.838 €			



WEBSITE

www.plujeme.cz



E-MAIL

info@plujeme.cz



PHONE

+420 720 755 085



MOBILE

+420 777 170 276



PLUJEME RÁDI S.R.O.

Dlouhá 730/35, 11000 Praha 1 – Staré Město, Czech Republic

PRICE AND AVAILABILITY

05.12. - 12.12.2026 5.838 €	12.12. - 19.12.2026 5.838 €	19.12. - 26.12.2026 6.130 €	02.01. - 09.01.2027 5.875 €
09.01. - 16.01.2027 5.242 €	16.01. - 23.01.2027 5.242 €	23.01. - 30.01.2027 5.242 €	30.01. - 06.02.2027 5.242 €
06.02. - 13.02.2027 5.242 €	13.02. - 20.02.2027 5.242 €	20.02. - 27.02.2027 5.242 €	27.02. - 06.03.2027 5.558 €
06.03. - 13.03.2027 6.350 €	13.03. - 20.03.2027 6.350 €	20.03. - 27.03.2027 6.350 €	27.03. - 03.04.2027 6.350 €
03.04. - 10.04.2027 6.350 €	10.04. - 17.04.2027 6.376 €	17.04. - 25.04.2027 NOT AVAILABLE	01.05. - 08.05.2027 5.838 €
08.05. - 15.05.2027 5.838 €	15.05. - 22.05.2027 5.838 €	22.05. - 29.05.2027 5.838 €	29.05. - 05.06.2027 5.838 €
05.06. - 12.06.2027 5.838 €	19.06. - 25.06.2027 NOT AVAILABLE	26.06. - 03.07.2027 5.838 €	03.07. - 10.07.2027 5.838 €
10.07. - 17.07.2027 5.838 €	17.07. - 24.07.2027 5.838 €	24.07. - 31.07.2027 5.838 €	31.07. - 07.08.2027 5.838 €



WEBSITE

www.plujeme.cz



E-MAIL

info@plujeme.cz



PHONE

+420 720 755 085



MOBILE

+420 777 170 276



PLUJEME RÁDI S.R.O.

Dlouhá 730/35, 11000 Praha 1 – Staré Město, Czech Republic

PRICE AND AVAILABILITY

07.08. - 14.08.2027 5.838 €	14.08. - 21.08.2027 5.838 €	21.08. - 28.08.2027 5.838 €	28.08. - 04.09.2027 5.838 €
04.09. - 11.09.2027 5.838 €	11.09. - 18.09.2027 5.838 €	18.09. - 25.09.2027 5.838 €	25.09. - 02.10.2027 5.838 €
02.10. - 09.10.2027 5.838 €	09.10. - 16.10.2027 5.838 €	16.10. - 23.10.2027 5.838 €	23.10. - 30.10.2027 5.838 €
30.10. - 06.11.2027 5.838 €	06.11. - 13.11.2027 5.838 €	13.11. - 20.11.2027 5.838 €	20.11. - 27.11.2027 5.838 €
27.11. - 04.12.2027 5.838 €	04.12. - 11.12.2027 5.838 €	11.12. - 18.12.2027 5.838 €	18.12. - 25.12.2027 6.057 € 6.057 €



WEBSITE

www.plujeme.cz



E-MAIL

info@plujeme.cz



PHONE

+420 720 755 085



MOBILE

+420 777 170 276



PLUJEME RÁDI S.R.O.

Dlouhá 730/35, 11000 Praha 1 – Staré Město, Czech Republic