

OCEANIS 34.1

Rookie (2023)

Sailing yacht Oceanis 34.1 Rookie, built in 2023 is anchored in the ACI Marina Split, Split region, Croatia. It has 3 cabins, can accommodate 6 + 2 people and has 1 toilets. Bed linen and kitchen equipment are included in the price.

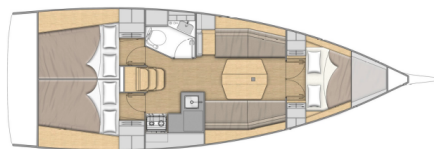

YACHT SPECIFICATIONS

Yacht Base

ACI Marina Split, Croatia

Yacht ID

5330

Brands

Beneteau

Yacht name

Rookie

Production year

2023

Length

35 ft

Cabins

3

Berths

6 + 2

WC

1

Engine

1 x 29 HP

Fuel tank

130 l



WEBSITE

www.plujeme.cz



PHONE

+420 720 755 085



MOBILE

+420 777 170 276



E-MAIL

info@plujeme.cz



PLUJEME RÁDI S.R.O.

Dlouhá 730/35, 11000 Praha 1 – Staré Město, Czech Republic

STANDARD YACHT EQUIPMENT

| | |
|-----------------|---|
| Comfort | Bed linen, Cockpit cushions, Towels |
| Deck | Anchor with chain, Bilge pump - Mechanic, Bimini top, Boat hook, Bosun's chair (Safe seat) (boatswain's chair), Cockpit table, Cockpit/stern, outside shower, Dinghy, Electric anchor windlass, Round/globular fender, Spare anchor (Reserve, Auxiliary anchor), Sprayhood, Teak cockpit |
| Entertainment | Outdoor speakers, Radio with USB, Wi-Fi Internet |
| Galley | Gas bottles, Hot water, Kitchen utensils (Galley equipment, cutlery), Oven, Refrigerator, Stove |
| Interior | Salon table |
| Navigation | Autopilot, Binoculars, Compass, GPS chart plotter - cockpit, Navigation (Nautical) charts and nautical guide, Pilot book, Wind instrument/Anemometer |
| Safety | Black Water Tank, Buoyant smoke signal, Distress signals, Fire axe, Fire extinguisher, First aid kit, Fog horn, Life belts (Safety harness), Life jackets, VHF radio |
| Sails | Lazy bag, Performance sails |
| Yacht electrics | Battery charger, Bilge pump - Electric, Heating, Shore connection 220 V, Solar panels |



WEBSITE

www.plujeme.cz



PHONE

+420 720 755 085



MOBILE

+420 777 170 276



E-MAIL

info@plujeme.cz



PLUJEME RÁDI S.R.O.

Dlouhá 730/35, 11000 Praha 1 - Staré Město, Czech Republic

SERVICES

| SELECTED SERVICES | OBLIGATORY | PAYMENT TYPE | PRICE |
|--|------------|-----------------|-------------------|
| Charter pack (Payable at the base) Season: 2026. Includes: bed linen, towels, kitchen utensils, 3 GB WiFi, snorkeling set, diver's inspection, end cleaning | Yes | per booking | 258,00 € |
| Tourist tax (Payable at the base) Season: 2026. cash or card | Yes | per guest/night | 1,33 € |
| APA (Advance Provisioning Allowance) (Payable at the base) Season: 2026. Obligatory with Hostess | No | per week | 3.000,00 € |
| Damage waiver (Payable now) Season: 2026. + 100 EUR refundable | No | per booking | 250,00 € |
| Hostess (Payable now) Season: 2026. Preparation of 2 meals daily; + obligatory APA 3000,00eur | No | per week + food | 1.575,00 € |
| Pet on board (Payable at the base) Season: 2026. | No | per booking | 150,00 € |
| Skipper (Payable now) Season: 2026. + cabin | No | per week + food | 1.660,00 € |
| Transfer (Payable at the base) Season: 2026. Transfer APT Split- ACI Split (4-8pax) | No | one-way | 80,00 € |
| Transfer (Payable at the base) Season: 2026. Transfer APT Split- ACI Split (1-3pax) | No | one-way | 75,00 € |
| WI-FI Internet connection on boat (Payable at the base) Season: 2026. 40GB | No | per booking | 30,00 € |



WEBSITE
www.plujeme.cz



PHONE
+420 720 755 085



MOBILE
+420 777 170 276



E-MAIL
info@plujeme.cz



PLUJEME RÁDI S.R.O.
Dlouhá 730/35, 11000 Praha 1 – Staré Město, Czech Republic

ADDITIONAL EXTRAS

| EXTRA | OBLIGATORY | PAYMENT TYPE | PRICE |
|---|------------|--------------|-----------------|
| Automatic Inflatable Life Jacket (Payable at the base) Season: 2026. Payable at the base | No | per week | 35,00 € |
| e-SUP (Payable at the base) Season: 2026. Sipaboard – Allrounder + additional deposit 500€ – Payable at the base | No | per week | 250,00 € |
| Electric outboard engine (Payable now) Season: 2026. limited, on request – Payable now | No | per week | 150,00 € |
| Gennaker (Payable at the base) Season: 2026. on request – Payable at the base | No | per week | 200,00 € |
| Ice maker (Payable now) Season: 2026. limited, on request – Payable now | No | per week | 40,00 € |
| Railing net (Safety net) (Payable at the base) Season: 2026. Payable at the base | No | per booking | 100,00 € |
| Snorkeling equipment (Payable at the base) Season: 2026. Payable at the base | No | per set | 12,00 € |
| Stand up paddle (SUP) (Payable at the base) Season: 2026. Payable at the base | No | per week | 120,00 € |



WEBSITE
www.plujeme.cz



E-MAIL
info@plujeme.cz



PHONE
+420 720 755 085



PLUJEME RÁDI S.R.O.
Dlouhá 730/35, 11000 Praha 1 – Staré Město, Czech Republic



MOBILE
+420 777 170 276

PRICE AND AVAILABILITY

| | | | |
|--|--|--|--|
| 25.04. - 02.05.2026 ON OPTION | 02.05. - 09.05.2026 NOT AVAILABLE | 09.05. - 16.05.2026 1.015 € 1.450 € | 16.05. - 23.05.2026 1.160 € 1.450 € |
| 23.05. - 30.05.2026 NOT AVAILABLE | 30.05. - 06.06.2026 NOT AVAILABLE | 06.06. - 20.06.2026 NOT AVAILABLE | 20.06. - 27.06.2026 NOT AVAILABLE |
| 27.06. - 04.07.2026 NOT AVAILABLE | 04.07. - 11.07.2026 NOT AVAILABLE | 11.07. - 18.07.2026 2.423 € 2.550 € | 18.07. - 01.08.2026 NOT AVAILABLE |
| 01.08. - 29.08.2026 NOT AVAILABLE | 29.08. - 05.09.2026 ON OPTION | 05.09. - 12.09.2026 NOT AVAILABLE | 12.09. - 19.09.2026 NOT AVAILABLE |
| 19.09. - 26.09.2026 NOT AVAILABLE | 26.09. - 03.10.2026 1.260 € 1.400 € | 03.10. - 10.10.2026 945 € 1.350 € | 10.10. - 17.10.2026 945 € 1.350 € |
| 17.10. - 24.10.2026 1.000 € 1.250 € | 24.10. - 31.10.2026 1.080 € 1.350 € | 01.11. - 31.12.2026 NOT AVAILABLE | |



WEBSITE

www.plujeme.cz



E-MAIL

info@plujeme.cz



PHONE

+420 720 755 085



MOBILE

+420 777 170 276



PLUJEME RÁDI S.R.O.

Dlouhá 730/35, 11000 Praha 1 – Staré Město, Czech Republic