

# SUN ODYSSEY 380

Simply The Best (2023)

Sailing yacht Sun Odyssey 380 Simply The Best, built in 2023 is anchored in the **Göcek, Aegean, Turkey**. It has **2 cabins**, can accommodate **4 people** and has **2 toilets**. Bed linen and kitchen equipment are included in the price.

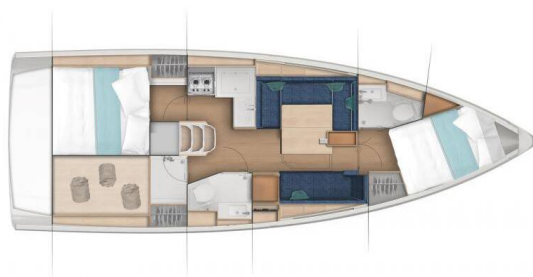

## YACHT SPECIFICATIONS

Yacht Base

**Göcek, Turkey**

Yacht ID

**5318**

Brands

**Jeanneau**

Yacht name

**Simply The Best**

Production year

**2023**

Length

**37 ft**

Cabins

**2**

Berths

**4**

WC

**2**

Engine

**1 x 40 HP**

Fuel tank

**130 l**



**WEBSITE**

[www.plujeme.cz](http://www.plujeme.cz)



**PHONE**

+420 720 755 085



**MOBILE**

+420 777 170 276



**E-MAIL**

[info@plujeme.cz](mailto:info@plujeme.cz)



**PLUJEME RÁDI S.R.O.**

Dlouhá 730/35, 11000 Praha 1 – Staré Město, Czech Republic

## STANDARD YACHT EQUIPMENT

Comfort	<b>Blankets, Cockpit cushions, Pillows, Welcome pack</b>
Deck	<b>Anchor with chain, Bathing platform, Bilge pump - Mechanic, Bimini top, Black ball, Boat hook, Bosun's chair (Safe seat) (boatswain's chair), Canister for water, Cockpit light, Cockpit table, Cockpit/stern, outside shower, Deck brush, Dinghy (byboat) pump, Electric anchor windlass, Fenders, Fuel funnel, Gangway, Impeller, V-belt, oilfilter, Jerry cans for diesel, Mooring ropes, Plastic bucket, Repair box for dinghy, Round/globular fender, Spare anchor (Reserve, Auxiliary anchor), Sponge, Sprayhood, Sun tent/cover, Swimming ladder, Teak cockpit, Water hose, Winch handles</b>
Entertainment	<b>Mask and snorkel, Outdoor speakers, Radio CD player, USB, AUX input</b>
Galley	<b>Dishwashing liquid, Gas bottles, Gas cookers, Hot water, Kitchen utensils (Galley equipment, cutlery), Oven, Pressurized water system, Refrigerator, Sink</b>
Interior	<b>Barometer, Clock, Convertible table in salon, Electric toilet</b>
Navigation	<b>Autopilot, Binoculars, Bow thruster, Compass, GPS chart plotter, GPS chart plotter - cockpit, Hand bearing compass, Log, Navigation (Nautical) charts and nautical guide, Navigation set, Pilot book, Radar reflector, Wind instrument/Anemometer, Windex</b>
Safety	<b>Black Water Tank, Distress signals, Emergency tiller, Fire blanket, Fire extinguisher, First aid kit, Fog horn, Life belts (Safety harness), Life buoy + Flashing light, Life jacket (children), Life jackets, Liferaft, Oars (Paddles), Repair kit, Search light, Set of tools, Signal flags, Sos Dan Buoy, Torch, VHF radio, Wire (shroud) cutter</b>
Sails	<b>Electric main sail winch</b>
Yacht electrics	<b>220V socket, Battery charger, Bilge pump - Electric, Heating, Inverter, Service batteries, Shore connection 220 V, Shore power cable, Solar panels, Start battery</b>



**WEBSITE**

[www.plujeme.cz](http://www.plujeme.cz)



**PHONE**

+420 720 755 085



**MOBILE**

+420 777 170 276



**E-MAIL**

[info@plujeme.cz](mailto:info@plujeme.cz)



**PLUJEME RÁDI S.R.O.**

Dlouhá 730/35, 11000 Praha 1 – Staré Město, Czech Republic

## SERVICES

SELECTED SERVICES	OBLIGATORY	PAYMENT TYPE	PRICE
<b>Standard package</b> (Payable at the base) <b>Season: 2026.</b> Includes : Transitlog, final cleaning, bed linen & towels, outboard engine & fuel, Turkish mobile phone for emergency calls to the base, other E.G.G. Yachts and bay restaurants / marinas. Only local calls, with the option to receive international calls.	Yes	per booking	<b>350,00 €</b>
<b>Cook</b> (Payable at the base) <b>Season: 2026.</b>	No	per day + food	<b>170,00 €</b>
<b>Damage waiver</b> (Payable at the base) <b>Season: 2026.</b> All damages are covered ( except any damage or loss of outboard & dinghy )	No	per booking	<b>300,00 €</b>
<b>Deckhand/ Marinero</b> (Payable at the base) <b>Season: 2026.</b>	No	per day + food	<b>170,00 €</b>
<b>Early Check in</b> (Payable at the base) <b>Season: 2026.</b> at 13.00 hr ( limited with 3 bookings / week)	No	per booking	<b>150,00 €</b>
<b>Exclusive package</b> (Payable at the base) <b>Season: 2026.</b> Includes : Standard package + Damage waiver (except total loss of outboard & dingy)+ 20 GB Wi-Fi internet on board	No	per booking	<b>600,00 €</b>
<b>Final cleaning</b> (Payable at the base) <b>Season: 2026.</b> for boats up to 41ft	No	per booking	<b>80,00 €</b>
<b>Hostess/Cook</b> (Payable at the base) <b>Season: 2026.</b>	No	per day + food	<b>170,00 €</b>
<b>Regatta</b> (Payable at the base) <b>Season: 2026.</b> + 2x Security Deposit; Race Preparations Fees	No	per booking	<b>150,00 €</b>
<b>Skipper</b> (Payable at the base) <b>Season: 2026.</b>	No	per day + food	<b>180,00 €</b>
<b>Transfer</b> (Payable at the base) <b>Season: 2026.</b> Transfer up to 3 pax, Dalaman Airport to Göcek Base/MUCEV or reverse.	No	one-way	<b>50,00 €</b>

<b>Transfer</b> (Payable at the base)	No	one-way	<b>70,00 €</b>
<b>Season: 2026.</b> Transfer up to 6 pax with Minibus, Dalaman Airport to Göcek Base/MUCEV or reverse			
<b>Transfer</b> (Payable at the base)	No	one-way	<b>90,00 €</b>
<b>Season: 2026.</b> Transfer up to 14 pax with Minibus, Dalaman Airport to Göcek Base/MUCEV or reverse			
<b>Wireless Internet Router</b> (Payable at the base)	No	per booking	<b>50,00 €</b>
<b>Season: 2026.</b> 20 GB			
<b>Wireless Internet Router</b> (Payable at the base)	No	per booking	<b>100,00 €</b>
<b>Season: 2026.</b> Limitless			



**WEBSITE**

[www.plujeme.cz](http://www.plujeme.cz)



**E-MAIL**

[info@plujeme.cz](mailto:info@plujeme.cz)



**PHONE**

+420 720 755 085



**MOBILE**

+420 777 170 276



**PLUJEME RÁDI S.R.O.**

Dlouhá 730/35, 11000 Praha 1 – Staré Město, Czech Republic

## ADDITIONAL EXTRAS

EXTRA	OBLIGATORY	PAYMENT TYPE	PRICE
<b>Bed linen</b> (Payable at the base) <b>Season: 2026.</b> Payable at the base	No	per set	<b>5,00 €</b>
<b>Comfort seats</b> (Payable at the base) <b>Season: 2026.</b> + deposit - Payable at the base	No	per week	<b>30,00 €</b>
<b>Comfort seats</b> (Payable at the base) <b>Season: 2026.</b> for pair / week & boat +deposit - Payable at the base	No	per week	<b>50,00 €</b>
<b>Outboard engine</b> (Payable at the base) <b>Season: 2026.</b> Payable at the base	No	per week	<b>75,00 €</b>
<b>Railing net (Safety net)</b> (Payable at the base) <b>Season: 2026.</b> mounting and dismounting - Payable at the base	No	per booking	<b>150,00 €</b>
<b>Spinnaker</b> (Payable at the base) <b>Season: 2026.</b> security deposit 1000 EUR - Payable at the base	No	per week	<b>400,00 €</b>
<b>Stand up paddle (SUP)</b> (Payable at the base) <b>Season: 2026.</b> + deposit 600 EUR - Payable at the base	No	per week	<b>150,00 €</b>
<b>Towels</b> (Payable at the base) <b>Season: 2026.</b> Payable at the base	No	per set	<b>5,00 €</b>



**WEBSITE**  
www.plujeme.cz



**PHONE**  
+420 720 755 085



**MOBILE**  
+420 777 170 276



**E-MAIL**  
info@plujeme.cz



**PLUJEME RÁDI S.R.O.**  
Dlouhá 730/35, 11000 Praha 1 – Staré Město, Czech Republic

## PRICE AND AVAILABILITY

16.06. - 19.06.2026 NOT AVAILABLE	21.06. - 26.06.2026 NOT AVAILABLE	27.06. - 18.07.2026 NOT AVAILABLE	18.07. - 25.07.2026 <b>2.550 €</b> 3.400 €
25.07. - 01.08.2026 <b>2.550 €</b> 3.400 €	01.08. - 08.08.2026 <b>2.550 €</b> 3.400 €	08.08. - 15.08.2026 <b>2.550 €</b> 3.400 €	17.08. - 28.08.2026 NOT AVAILABLE
29.08. - 05.09.2026 NOT AVAILABLE	05.09. - 12.09.2026 NOT AVAILABLE	12.09. - 19.09.2026 <b>3.600 €</b> 4.000 €	19.09. - 26.09.2026 NOT AVAILABLE
26.09. - 10.10.2026 NOT AVAILABLE	10.10. - 17.10.2026 NOT AVAILABLE	17.10. - 24.10.2026 <b>3.600 €</b> 4.000 €	24.10. - 31.10.2026 <b>3.060 €</b> 3.400 €
31.10. - 07.11.2026 <b>3.060 €</b> 3.400 €	07.11. - 14.11.2026 <b>2.070 €</b> 2.300 €	14.11. - 21.11.2026 NOT AVAILABLE	21.11. - 28.11.2026 <b>2.070 €</b> 2.300 €
28.11. - 05.12.2026 <b>2.070 €</b> 2.300 €	05.12. - 12.12.2026 <b>2.070 €</b> 2.300 €	12.12. - 19.12.2026 <b>2.070 €</b> 2.300 €	19.12. - 26.12.2026 <b>2.070 €</b> 2.300 €



### WEBSITE

[www.plujeme.cz](http://www.plujeme.cz)



### E-MAIL

[info@plujeme.cz](mailto:info@plujeme.cz)



### PHONE

+420 720 755 085



### MOBILE

+420 777 170 276



### PLUJEME RÁDI S.R.O.

Dlouhá 730/35, 11000 Praha 1 – Staré Město, Czech Republic