

HANSE 460

Rubi (2024)

Sailing yacht Hanse 460 Rubi, built in 2024 is anchored in the Marina Mandalina, Sibenik, Šibenik region, Croatia. It has 4 cabins, can accommodate 8 people and has 2 toilets. Bed linen and kitchen equipment are included in the price.

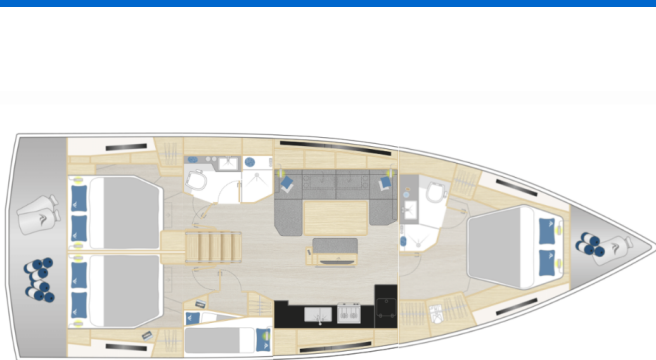

YACHT SPECIFICATIONS

Yacht Base

Marina Mandalina, Sibenik, Croatia

Yacht ID

5195

Brands

Hanse Yachts

Yacht name

Rubi

Production year

2024

Length

48 ft

Cabins

4

Berths

8

WC

2

Engine

1 x 57 HP

Fuel tank

210 l



WEBSITE

www.plujeme.cz



PHONE

+420 720 755 085



MOBILE

+420 777 170 276



E-MAIL

info@plujeme.cz



PLUJEME RÁDI S.R.O.

Dlouhá 730/35, 11000 Praha 1 – Staré Město, Czech Republic

STANDARD YACHT EQUIPMENT

Comfort	Sundeck beds
Deck	Bathing platform, Bimini top, Cockpit fridge, Cockpit light, Cockpit table, Cockpit/stern, outside shower, Dinghy, Electric anchor windlass, Grill/Barbecue/Plancha, Sink in cockpit, Sprayhood, Teak coach roof, Teak cockpit, Teak deck
Entertainment	FUSION sound system, Outdoor speakers, Radio, TV, Wet bar
Galley	Freezer, Hot water, Microwave, Oven, Refrigerator, Stove
Interior	Curtains, Indirect lighting in cabins and salon, LED ceiling lights, LED interior lights
Navigation	Autopilot, Bow thruster, Depthsounder, GPS chart plotter - cockpit, Speedometer (Speed log), Wind instrument/Anemometer, Wind/speed/depth instruments
Safety	Black Water Tank, VHF radio
Sails	Electric winch, Halyard winches, Lazy bag, Lazy jacks
Yacht electrics	12V Socket, 230 volt socket, Air Conditioning, Batteries, Generator, Heating, Inverter, Shore connection 220 V, Shore power cable, Water heater



WEBSITE

www.plujeme.cz



E-MAIL

info@plujeme.cz



PHONE

+420 720 755 085



MOBILE

+420 777 170 276



PLUJEME RÁDI S.R.O.

Dlouhá 730/35, 11000 Praha 1 – Staré Město, Czech Republic

SERVICES

SELECTED SERVICES	OBLIGATORY	PAYMENT TYPE	PRICE
Base fee (Payable at the base) Season: 2026. includes: Wi-Fi, dinghy, final cleaning of the boat, 2x gas bottles, 1 towel/person/week, 1 set of bed linen/person/week, garbage bags, sponge, kitchen towels, dish soap, toilet paper, VAT.	Yes	per booking	340,00 €
Comfort Pack (Payable at the base) Season: 2026. on request	No	per booking	0,00 €
Crew list - Fill/Update fee (Payable at the base) Season: 2026.	No	per booking	50,00 €
Deposit insurance (Payable at the base) Season: 2026. possible upon request	No	per booking	0,00 €
Divers inspection (Payable at the base) Season: 2026. Recording of the underwater part of the hull and vital parts of the ship (propeller, rudder, saildrive, bowthruster, keel) at the check-in before departure (with recording)	No	per booking	150,00 €
Hostess (Payable at the base) Season: 2026.	No	per day + food	200,00 €
One way (Payable at the base) Season: 2026. Šibenik - Dubrovnik; on request	No	one-way	0,00 €
Pet on board (Payable at the base) Season: 2026. subject to approval in advance	No	per booking	150,00 €
Priority check in (Payable at the base) Season: 2026. Check in from 13:00h -limited offer up to 3 yachts per Saturday	No	per booking	250,00 €
Provisioning (Payable at the base) Season: 2026. possible upon request	No	per booking	0,00 €
Regatta charge (Payable at the base) Season: 2026. 20% on price + double deposit	No	per booking	0,00 €
Skipper (Payable at the base) Season: 2026.	No	per day + food	205,00 €

Skipper training practice (Payable at the base)

No

per booking

250,00 €

Season: 2026. 1-Day Sail Refresher Program (Sunday 09-17 h)

Transfer (Payable at the base)

No

one-way

0,00 €

Season: 2026. Price and availability upon request



WEBSITE

www.plujeme.cz



E-MAIL

info@plujeme.cz



PHONE

+420 720 755 085



MOBILE

+420 777 170 276



PLUJEME RÁDI S.R.O.

Dlouhá 730/35, 11000 Praha 1 – Staré Město, Czech Republic

ADDITIONAL EXTRAS

EXTRA	OBLIGATORY	PAYMENT TYPE	PRICE
Gennaker (Payable at the base) Season: 2026. + deposit; weekly price for regatta is 500€ - Payable at the base	No	per week	250,00 €
Outboard engine (Payable at the base) Season: 2026. 2.5 hp - Payable at the base	No	per week	120,00 €
Railing net (Safety net) (Payable at the base) Season: 2026. Payable at the base	No	per booking	180,00 €
Sport water equipment (Payable at the base) Season: 2026. Upon request; - seabob, wakeboard, e-tron, water skiies, kayak, jet ski - Payable at the base	No	per booking	0,00 €
Stand up paddle (SUP) (Payable at the base) Season: 2026. Payable at the base	No	per week	140,00 €
Towels (Payable at the base) Season: 2026. per person - Payable at the base	No	per piece	5,00 €



WEBSITE

www.plujeme.cz



E-MAIL

info@plujeme.cz



PHONE

+420 720 755 085



MOBILE

+420 777 170 276



PLUJEME RÁDI S.R.O.

Dlouhá 730/35, 11000 Praha 1 – Staré Město, Czech Republic

PRICE AND AVAILABILITY

13.06. - 04.07.2026 NOT AVAILABLE	04.07. - 11.07.2026 NOT AVAILABLE	11.07. - 18.07.2026 NOT AVAILABLE	18.07. - 08.08.2026 NOT AVAILABLE
08.08. - 15.08.2026 4.470 € 7.095 €	15.08. - 29.08.2026 NOT AVAILABLE	29.08. - 12.09.2026 NOT AVAILABLE	12.09. - 19.09.2026 NOT AVAILABLE
19.09. - 26.09.2026 NOT AVAILABLE	26.09. - 03.10.2026 2.426 € 3.850 €	03.10. - 13.10.2026 NOT AVAILABLE	17.10. - 24.10.2026 1.836 € 2.915 €
24.10. - 31.10.2026 NOT AVAILABLE	31.10. - 07.11.2026 1.733 € 2.750 €	07.11. - 14.11.2026 1.733 € 2.750 €	14.11. - 21.11.2026 1.733 € 2.750 €
21.11. - 28.11.2026 1.733 € 2.750 €	28.11. - 05.12.2026 1.733 € 2.750 €	05.12. - 12.12.2026 2.750 €	12.12. - 19.12.2026 2.750 €
19.12. - 26.12.2026 2.750 €			



WEBSITE
www.plujeme.cz



E-MAIL
info@plujeme.cz



PHONE
+420 720 755 085



PLUJEME RÁDI S.R.O.
Dlouhá 730/35, 11000 Praha 1 – Staré Město, Czech Republic



MOBILE
+420 777 170 276