

LAGOON 450 S

Islette (2018)

Catamaran **Lagoon 450 S Islette**, built in **2018** is anchored in the **Seychelles, Mahe, Mahé, Seychelles**. It has **4 + 2 cabins**, can accommodate **8 + 2 people** and has **4 toilets**. Bed linen and kitchen equipment are included in the price.

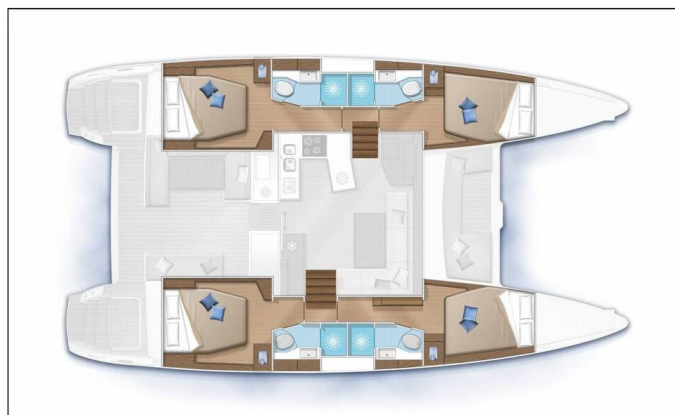

YACHT SPECIFICATIONS

Yacht Base

Seychelles, Mahe, Seychelles

Yacht ID

5138

Brands

Lagoon

Yacht name

Islette

Production year

2018

Length

46 ft

Cabins

4 + 2

Berths

8 + 2

WC

4

Engine

2 x 56 HP

Fuel tank

1000 l



WEBSITE

www.plujeme.cz



PHONE

+420 720 755 085



MOBILE

+420 777 170 276



E-MAIL

info@plujeme.cz



PLUJEME RÁDI S.R.O.

Dlouhá 730/35, 11000 Praha 1 – Staré Město, Czech Republic

STANDARD YACHT EQUIPMENT

Comfort	Bed linen, Cockpit cushions, Towels
Deck	Bimini top, Cockpit table, Cockpit/stern, outside shower, Davit, Dinghy, Electric anchor windlass, Fly sunbathing area, Grill/Barbecue/Plancha, Mooring ropes, Outboard engine, Swimming ladder, Teak cockpit
Entertainment	Fishing cane/rod, Outdoor speakers, Radio CD player, USB
Galley	Freezer, Hot water, Oven, Refrigerator, Stove
Interior	Convertible table in salon
Navigation	Autopilot, GPS chart plotter, Sonar, Speedometer (Speed log), Wind instrument/Anemometer
Safety	Black Water Tank, VHF radio
Sails	Lazy bag, Lazy jacks
Yacht electrics	Air Conditioning, Battery charger, Generator, Inverter, Shore connection 220 V, Solar panels, Watermaker - desalinator



WEBSITE

www.plujeme.cz



PHONE

+420 720 755 085



MOBILE

+420 777 170 276



E-MAIL

info@plujeme.cz



PLUJEME RÁDI S.R.O.

Dlouhá 730/35, 11000 Praha 1 – Staré Město, Czech Republic

SERVICES

SELECTED SERVICES	OBLIGATORY	PAYMENT TYPE	PRICE
Final cleaning (Payable now) Season: 2026.	Yes	per booking	220,00 €
Cook (Payable now) Season: 2026.	No	per day + food	135,00 €
Damage waiver (Payable now) Season: 2026. 1500 EUR refundable deposit	No	per booking	0,00 €
Early Check in (Payable at the base) Season: 2026. early check-in 9h	No	per booking	450,00 €
Full board (Payable now) Season: 2026. 5 - 10 pax	No	per guest/day	55,00 €
Full board (Payable now) Season: 2026. 1 - 4 pax	No	per guest/day	60,00 €
Full board (Payable now) Season: 2026. 11 - 14 pax	No	per guest/day	50,00 €
Late check out (Payable at the base) Season: 2026. late check-out 12h	No	per booking	450,00 €
Skipper (Payable now) Season: 2026.	No	per day + food	155,00 €
Skipper+Cook (Payable now) Season: 2026.	No	per day + food	205,00 €
Transfer (Payable now) Season: 2026. Airport/Base/Airport, 1 - 3 pax	No	per service	60,00 €
Transfer (Payable now) Season: 2026. Airport/Base/Airport, 4 - 6 pax	No	per service	100,00 €
Transfer (Payable now) Season: 2026. Airport/Base/Airport, 7 - 10 pax	No	per service	150,00 €

Transfer (Payable now)

Season: 2026. Airport/Base/Airport, 7 - 10 pax



WEBSITE

www.plujeme.cz



E-MAIL

info@plujeme.cz



No
PHONE

+420 720 755 085



PLUJEME RÁDI S.R.O.

Dlouhá 730/35, 11000 Praha 1 - Staré Město, Czech Republic



per service
MOBILE

+420 777 170 276

ADDITIONAL EXTRAS

EXTRA	OBLIGATORY	PAYMENT TYPE	PRICE
Fishing equipment (Payable now) <i>Season: 2026. Payable now</i>	No	per week	100,00 €
Railing net (Safety net) (Payable now) <i>Season: 2026. Payable now</i>	No	per week	150,00 €
Stand up paddle (SUP) (Payable now) <i>Season: 2026. Payable now</i>	No	per week	125,00 €

**WEBSITE**

www.plujeme.cz

**E-MAIL**

info@plujeme.cz

**PHONE**

+420 720 755 085

**MOBILE**

+420 777 170 276

**PLUJEME RÁDI S.R.O.**

Dlouhá 730/35, 11000 Praha 1 – Staré Město, Czech Republic

PRICE AND AVAILABILITY

10.06. - 20.06.2026 NOT AVAILABLE	20.06. - 27.06.2026 4.200 € 6.000 €	30.06. - 05.07.2026 NOT AVAILABLE	05.07. - 12.07.2026 NOT AVAILABLE
12.07. - 28.08.2026 NOT AVAILABLE	29.08. - 05.09.2026 5.743 € 6.000 €	05.09. - 12.09.2026 6.000 €	12.09. - 19.09.2026 6.000 €
19.09. - 26.09.2026 6.000 €	26.09. - 03.10.2026 6.000 €	03.10. - 10.10.2026 8.500 €	10.10. - 17.10.2026 8.500 €
18.10. - 25.10.2026 NOT AVAILABLE	31.10. - 10.11.2026 NOT AVAILABLE	14.11. - 21.11.2026 8.500 €	21.11. - 28.11.2026 ON OPTION
28.11. - 05.12.2026 8.500 €	05.12. - 12.12.2026 7.650 € 8.500 €	19.12. - 26.12.2026 10.170 € 11.300 €	02.01. - 09.01.2027 11.300 €
09.01. - 16.01.2027 8.500 €	16.01. - 23.01.2027 8.500 €	23.01. - 30.01.2027 8.500 €	30.01. - 06.02.2027 8.500 €



WEBSITE

www.plujeme.cz



E-MAIL

info@plujeme.cz



PHONE

+420 720 755 085



MOBILE

+420 777 170 276



PLUJEME RÁDI S.R.O.

Dlouhá 730/35, 11000 Praha 1 – Staré Město, Czech Republic

PRICE AND AVAILABILITY

06.02. - 13.02.2027 8.500 €	15.02. - 27.02.2027 NOT AVAILABLE	27.02. - 06.03.2027 8.500 €	06.03. - 13.03.2027 8.500 €
13.03. - 20.03.2027 8.500 €	20.03. - 27.03.2027 8.500 €	27.03. - 03.04.2027 8.500 €	03.04. - 10.04.2027 8.500 €
10.04. - 17.04.2027 8.500 €	17.04. - 24.04.2027 8.500 €	24.04. - 01.05.2027 8.500 €	01.05. - 08.05.2027 6.000 €
08.05. - 15.05.2027 6.000 €	15.05. - 22.05.2027 6.000 €	22.05. - 29.05.2027 6.000 €	29.05. - 05.06.2027 6.000 €
05.06. - 12.06.2027 6.000 €	12.06. - 19.06.2027 6.000 €	19.06. - 26.06.2027 6.000 €	26.06. - 03.07.2027 6.000 €
03.07. - 10.07.2027 6.000 €	10.07. - 17.07.2027 6.000 €	17.07. - 24.07.2027 6.000 €	24.07. - 31.07.2027 6.000 €
31.07. - 07.08.2027 6.000 €	07.08. - 14.08.2027 6.000 €	14.08. - 21.08.2027 6.000 €	21.08. - 28.08.2027 6.000 €
28.08. - 04.09.2027 6.000 €	04.09. - 11.09.2027 6.000 €	11.09. - 18.09.2027 6.000 €	18.09. - 25.09.2027 6.000 €
25.09. - 02.10.2027 6.000 €			



WEBSITE

www.plujeme.cz



E-MAIL

info@plujeme.cz



PHONE

+420 720 755 085



MOBILE

+420 777 170 276



PLUJEME RÁDI S.R.O.

Dlouhá 730/35, 11000 Praha 1 – Staré Město, Czech Republic

PRICE AND AVAILABILITY

02.10. - 09.10.2027 8.500 €	09.10. - 16.10.2027 8.500 €	16.10. - 23.10.2027 8.500 €	23.10. - 30.10.2027 8.500 €
30.10. - 06.11.2027 8.500 €	06.11. - 13.11.2027 8.500 €	13.11. - 20.11.2027 8.500 €	20.11. - 27.11.2027 8.500 €
27.11. - 04.12.2027 8.500 €	04.12. - 11.12.2027 8.500 €		



WEBSITE

www.plujeme.cz



E-MAIL

info@plujeme.cz



PHONE

+420 720 755 085



MOBILE

+420 777 170 276



PLUJEME RÁDI S.R.O.

Dlouhá 730/35, 11000 Praha 1 – Staré Město, Czech Republic