

# BAVARIA CRUISER 46 STYLE

Cala Mawa (2023)

Sailing yacht Bavaria Cruiser 46 Style Cala Mawa, built in 2023 is anchored in the Trogir, Marina Trogir (ex.SCT), Split region, Croatia. It has 4 cabins, can accommodate 8 + 1 people and has 3 toilets. Bed linen and kitchen equipment are included in the price.

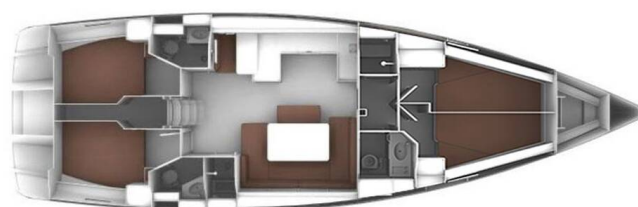

## YACHT SPECIFICATIONS

Yacht Base

**Trogir, Marina Trogir (ex.SCT),  
Croatia**

Yacht ID

**5039**

Brands

**Bavaria**

Yacht name

**Cala Mawa**

Production year

**2023**

Length

**47 ft**

Cabins

**4**

Berths

**8 + 1**

Max Persons

**9**

WC

**3**

Engine

**1 x 51 HP**

Fuel tank

**210 l**



**WEBSITE**

[www.plujeme.cz](http://www.plujeme.cz)



**PHONE**

+420 720 755 085



**MOBILE**

+420 777 170 276



**E-MAIL**

[info@plujeme.cz](mailto:info@plujeme.cz)



**PLUJEME RÁDI S.R.O.**

Dlouhá 730/35, 11000 Praha 1 – Staré Město, Czech Republic

## STANDARD YACHT EQUIPMENT

Comfort	<b>Cockpit cushions</b>
Deck	<b>Anchor line, Anchor swivel, Bimini top, Black ball, Black conus, Boat hook, Bosun's chair (Safe seat) (boatswain's chair), Canister for water, Cockpit table, Cockpit/stern, outside shower, Dinghy, Dinghy (byboat) pump, Electric anchor windlass, Fenders, Gangway, Hawser, Impeller, V-belt, oilfilter, Jerry cans for diesel, Main anchor, Mooring ropes, Plastic bucket, Repair box for dinghy, Round/globular fender, Spare anchor (Reserve, Auxiliary anchor), Spotlight / Headlights, Sprayhood, Spring line, Teak cockpit, Water hose</b>
Entertainment	<b>Outdoor speakers, Radio</b>
Galley	<b>Gas bottles, Hot water, Kitchen utensils (Galley equipment, cutlery), Refrigerator</b>
Interior	<b>Barometer, Clock</b>
Navigation	<b>3 blade folding propeller, Autopilot, Bow thruster, Bretonplotter, Composite steering wheels, GPS chart plotter - cockpit, Harbour guides, Logge/Lot/Speed/Wind, Navigation (Nautical) charts and nautical guide, Navigation set, Parallel ruler, Radar reflector, Spyglass with bearing compass, Windex</b>
Safety	<b>Distress signals, Fire extinguisher, First aid kit, Flashlight, Fog horn, Life belts (Safety harness), Life buoy + Flashing light, Life jackets, Liferaft, Set of tools, VHF radio, Wire (shroud) cutter</b>
Yacht electrics	<b>Batteries, Battery charger, Battery storage system, Heating, Inverter, Shore connection 220 V, Solar panels, USB sockets</b>



**WEBSITE**

[www.plujeme.cz](http://www.plujeme.cz)



**PHONE**

+420 720 755 085



**MOBILE**

+420 777 170 276



**E-MAIL**

[info@plujeme.cz](mailto:info@plujeme.cz)



**PLUJEME RÁDI S.R.O.**

Dlouhá 730/35, 11000 Praha 1 – Staré Město, Czech Republic

## SERVICES

SELECTED SERVICES	OBLIGATORY	PAYMENT TYPE	PRICE
<b>Charter package</b> (Payable at the base) <b>Season: 2026.</b> incl. Permit, outboard engine, Wi-Fi Internet (5 GB), bed linen (1 set/ person)	Yes	per booking	<b>375,00 €</b>
<b>Early afternoon boarding/check-in</b> (Payable at the base) <b>Season: 2026.</b> -> 2.00 pm – 4.00 pm, max. 5 yachts	No	per booking	<b>75,00 €</b>
<b>Early boarding/check-in</b> (Payable at the base) <b>Season: 2026.</b> -> 12.30 pm – 2.00 pm, max 5 yachts	No	per booking	<b>200,00 €</b>
<b>Extra cleaning</b> (Payable at the base) <b>Season: 2026.</b>	No	per booking	<b>200,00 €</b>
<b>Hostess</b> (Payable at the base) <b>Season: 2026.</b> + own cabin; external service provider, direct billing	No	per day + food	<b>200,00 €</b>
<b>Regatta charge</b> (Payable at the base) <b>Season: 2026.</b> ON REQUEST	No	per booking	<b>0,00 €</b>
<b>Skipper</b> (Payable at the base) <b>Season: 2026.</b> + own cabin; external service provider	No	per day + food	<b>200,00 €</b>
<b>WI-FI Internet connection on boat</b> (Payable at the base) <b>Season: 2026.</b> unlimited / depending on the network reception (5 GB are included in the Charter package)	No	per week	<b>30,00 €</b>



**WEBSITE**

[www.plujeme.cz](http://www.plujeme.cz)



**E-MAIL**

[info@plujeme.cz](mailto:info@plujeme.cz)



**PHONE**

+420 720 755 085



**MOBILE**

+420 777 170 276



**PLUJEME RÁDI S.R.O.**

Dlouhá 730/35, 11000 Praha 1 – Staré Město, Czech Republic

## ADDITIONAL EXTRAS

EXTRA	OBLIGATORY	PAYMENT TYPE	PRICE
<b>Extra bedlinen</b> (Payable at the base) <b>Season: 2026.</b> 1 set/ person is included in the charter package - Payable at the base	No	per set	<b>10,00 €</b>
<b>Flexible bulkhead system</b> (Payable at the base) <b>Season: 2026.</b> Payable at the base	No	per booking	<b>180,00 €</b>
<b>Glass bottom dinghy</b> (Payable at the base) <b>Season: 2026.</b> Formentera 270 PC + approx. 3 HP ePropulsion engine, max. 3 persons, in 8,5 h fully loaded with 12 V - Payable at the base	No	per week	<b>220,00 €</b>
<b>Grill/Barbecue/Plancha</b> (Payable at the base) <b>Season: 2026.</b> Payable at the base	No	per booking	<b>65,00 €</b>
<b>Ice box</b> (Payable at the base) <b>Season: 2026.</b> Mobile Cooler Box (no power connection): approx. 52L, limited availability, For drinks and ice only. Box must be returned clean and undamaged. Ice cubes are not included. Max. 3 yachts. - Payable at the base	No	per booking	<b>30,00 €</b>
<b>Ice maker</b> (Payable at the base) <b>Season: 2026.</b> operating with - shorepower or - Inverter min. 2.000 W or - Generator - Payable at the base	No	per booking	<b>45,00 €</b>
<b>NESPRESSO coffee machine</b> (Payable at the base) <b>Season: 2026.</b> operating with - shorepower or - Inverter min. 2000 W or - Generator - Payable at the base	No	per booking	<b>45,00 €</b>
<b>Railing net (Safety net)</b> (Payable at the base) <b>Season: 2026.</b> incl. mounting and unmounting - Payable at the base	No	per booking	<b>180,00 €</b>
<b>Railing net (Safety net)</b> (Payable at the base) <b>Season: 2026.</b> To be mounted / unmounted by the client (Net and mounting material must be returned by the crew after the charter) - Payable at the base	No	per booking	<b>35,00 €</b>
<b>Stand up paddle (SUP)</b> (Payable at the base) <b>Season: 2026.</b> Payable at the base	No	per week	<b>100,00 €</b>
<b>Towels</b> (Payable at the base) <b>Season: 2026.</b> Payable at the base	No	per set	<b>10,00 €</b>

 **WEBSITE**  
[www.plujeme.cz](http://www.plujeme.cz)

 **PHONE**  
 +420 720 755 085

 **MOBILE**  
 +420 777 170 276

 **E-MAIL**  
[info@plujeme.cz](mailto:info@plujeme.cz)

 **PLUJEME RÁDI S.R.O.**  
 Dlouhá 730/35, 11000 Praha 1 – Staré Město, Czech Republic

## PRICE AND AVAILABILITY

25.04. - 02.05.2026 1.428 € 2.040 €	02.05. - 09.05.2026 NOT AVAILABLE	09.05. - 16.05.2026 NOT AVAILABLE	16.05. - 23.05.2026 1.912 € 2.390 €
23.05. - 30.05.2026 NOT AVAILABLE	30.05. - 06.06.2026 NOT AVAILABLE	06.06. - 13.06.2026 NOT AVAILABLE	13.06. - 20.06.2026 NOT AVAILABLE
20.06. - 27.06.2026 NOT AVAILABLE	27.06. - 04.07.2026 NOT AVAILABLE	04.07. - 11.07.2026 3.512 € 4.390 €	11.07. - 18.07.2026 NOT AVAILABLE
18.07. - 25.07.2026 3.752 € 4.690 €	25.07. - 01.08.2026 NOT AVAILABLE	01.08. - 08.08.2026 3.560 € 4.450 €	08.08. - 19.08.2026 NOT AVAILABLE
19.08. - 26.08.2026 NOT AVAILABLE	29.08. - 05.09.2026 NOT AVAILABLE	05.09. - 09.09.2026 NOT AVAILABLE	09.09. - 19.09.2026 NOT AVAILABLE
19.09. - 26.09.2026 NOT AVAILABLE	26.09. - 03.10.2026 NOT AVAILABLE	03.10. - 10.10.2026 NOT AVAILABLE	10.10. - 17.10.2026 NOT AVAILABLE
17.10. - 24.10.2026 1.480 € 1.850 €	24.10. - 31.10.2026 NOT AVAILABLE	31.10. - 07.11.2026 1.480 € 1.850 €	07.11. - 14.11.2026 1.352 € 1.690 €
14.11. - 21.11.2026 1.352 € 1.690 €	22.11. - 31.12.2026 NOT AVAILABLE		



WEBSITE

[www.plujeme.cz](http://www.plujeme.cz)



E-MAIL

[info@plujeme.cz](mailto:info@plujeme.cz)



PHONE

+420 720 755 085



MOBILE

+420 777 170 276



PLUJEME RÁDI S.R.O.

Dlouhá 730/35, 11000 Praha 1 – Staré Město, Czech Republic