

FOUNTAINÉ PAJOT ISLA 40

Second Wind (2022)

Catamaran Fountaine Pajot Isla 40 Second Wind, built in 2022 is anchored in the **Annapolis, Chesapeake Bay, Chesapeake Bay, USA**. It has **3 cabins**, can accommodate **6 people** and has **2 toilets**. Bed linen and kitchen equipment are included in the price.

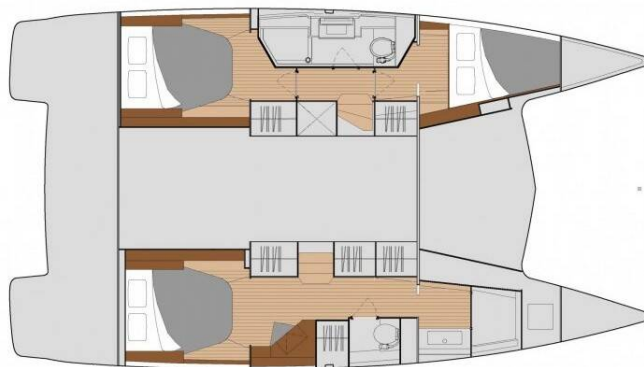

YACHT SPECIFICATIONS

Yacht Base

Annapolis, Chesapeake Bay, USA

Yacht ID

4895

Brands

Fountaine Pajot

Yacht name

Second Wind

Production year

2022

Length

39 ft

Cabins

3

Berths

6

Max Persons

6

WC

2

Engine

2 x 30 HP

Fuel tank

300 l



WEBSITE

www.plujeme.cz



PHONE

+420 720 755 085



MOBILE

+420 777 170 276



E-MAIL

info@plujeme.cz



PLUJEME RÁDI S.R.O.

Dlouhá 730/35, 11000 Praha 1 – Staré Město, Czech Republic

STANDARD YACHT EQUIPMENT

Deck	Cockpit table, Davit, Electric anchor windlass, Grill/Barbecue/Plancha, Sprayhood
Entertainment	Radio
Galley	Kitchen utensils (Galley equipment, cutlery), Stove
Interior	Convertible table in salon
Navigation	GPS chart plotter
Safety	Black Water Tank
Sails	Lazy jacks
Yacht electrics	Air Conditioning, Generator, Inverter



WEBSITE

www.plujeme.cz



E-MAIL

info@plujeme.cz



PHONE

+420 720 755 085



MOBILE

+420 777 170 276



PLUJEME RÁDI S.R.O.

Dlouhá 730/35, 11000 Praha 1 – Staré Město, Czech Republic

SERVICES

SELECTED SERVICES	OBLIGATORY	PAYMENT TYPE	PRICE
Cancellation insurance <i>(Payable now)</i> Season: 2026.	Yes	per booking	200,00 €
Dinghy <i>(Payable now)</i> Season: 2026.	Yes	per day	45,00 €
DRA <i>(Payable now)</i> Season: 2026.	Yes	per day	50,00 €
Express Service <i>(Payable now)</i> Season: 2026. Fuel cost	Yes	per day	55,00 €
Express Service <i>(Payable now)</i> Season: 2026. Labor cost	Yes	per booking	100,00 €
Final cleaning <i>(Payable now)</i> Season: 2026.	Yes	per booking	310,00 €
Maryland Amusement Tax 5% <i>(Payable now)</i> Season: 2026.	Yes	per booking	0,00 €
Maryland State Tax 6% <i>(Payable now)</i> Season: 2026.	Yes	per booking	0,00 €
Outboard fuel & Gas <i>(Payable now)</i> Season: 2026. Dinghy Fuel	Yes	per booking	40,00 €
ASA 90 Day Temp Membership <i>(Payable now)</i> Season: 2026.	No	per person/per course	39,00 €
ASA Logbook <i>(Payable now)</i> Season: 2026.	No	per piece	20,00 €
ASA Processing Fee <i>(Payable now)</i> Season: 2026. Other	No	per person/per course	50,00 €
ASA Processing Fee <i>(Payable now)</i> Season: 2026. Certificate 101	No	per person/per course	50,00 €

ASA Processing Fee (Payable now) Season: 2026. Certificate 104	No	per person/per course	50,00 €
ASA Processing Fee (Payable now) Season: 2026. Certificate 103	No	per person/per course	50,00 €
ASA Processing Fee (Payable now) Season: 2026. Certificate 114	No	per person/per course	50,00 €
ASA Textbook (Payable at the base) Season: 2026.	No	per piece	50,00 €
Captain (Payable at the base) Season: 2026. Daysail - from 9:00am - 5:00pm; The client's pay the Captain directly	No	per day + food	300,00 €
Captain (Payable at the base) Season: 2026. Multi-day - For overnight charters, this rate is charged per number of charter days. The client pays the Captain directly.	No	per day + food	350,00 €
Certification Skipper (ASA) (Payable at the base) Season: 2026. Per Day of instruction (includes overnights)	No	per day	400,00 €
Day Checkout Captain (Payable at the base) Season: 2026. Checkout Captain is typically a full day and is only for "testing" the charterers knowledge on the boat before they take it as a bareboat; The client's pay the Captain directly	No	per booking	300,00 €
Sleep over after check out (Payable now) Season: 2026. minimum 150\$	No	per person	75,00 €
Sleep over before check in (Payable now) Season: 2026. minimum 150\$; 4pm with briefing the following morning	No	per person	75,00 €
Wire Transfer Fee (Payable now) Season: 2026.	No	per booking	10,00 €



WEBSITE
www.plujeme.cz



PHONE
+420 720 755 085



MOBILE
+420 777 170 276



E-MAIL
info@plujeme.cz



PLUJEME RÁDI S.R.O.
Dlouhá 730/35, 11000 Praha 1 – Staré Město, Czech Republic

ADDITIONAL EXTRAS

EXTRA	OBLIGATORY	PAYMENT TYPE	PRICE
Net for children <i>(Payable at the base)</i> Season: 2026 <i>Payable at the base</i>	No	per booking	250,00 €



WEBSITE

www.plujeme.cz



E-MAIL

info@plujeme.cz



PHONE

+420 720 755 085



MOBILE

+420 777 170 276



PLUJEME RÁDI S.R.O.

Dlouhá 730/35, 11000 Praha 1 – Staré Město, Czech Republic

PRICE AND AVAILABILITY

24.05. - 25.05.2026 NOT AVAILABLE	30.05. - 06.06.2026 ON OPTION	06.06. - 13.06.2026 ON OPTION	13.06. - 14.06.2026 ON OPTION
20.06. - 26.06.2026 NOT AVAILABLE	27.06. - 28.06.2026 NOT AVAILABLE	04.07. - 11.07.2026 6.137 €	11.07. - 18.07.2026 6.137 €
18.07. - 25.07.2026 6.137 €	25.07. - 01.08.2026 6.137 €	01.08. - 08.08.2026 6.137 €	08.08. - 15.08.2026 6.137 €
15.08. - 22.08.2026 6.137 €	22.08. - 29.08.2026 6.137 €	04.09. - 09.09.2026 NOT AVAILABLE	12.09. - 19.09.2026 6.137 €
19.09. - 26.09.2026 6.137 €	26.09. - 03.10.2026 6.137 €	03.10. - 10.10.2026 6.137 €	10.10. - 17.10.2026 6.137 €
17.10. - 24.10.2026 6.137 €	24.10. - 31.10.2026 6.137 €	31.10. - 07.11.2026 6.137 €	07.11. - 14.11.2026 6.137 €
14.11. - 21.11.2026 6.137 €	21.11. - 28.11.2026 6.137 €	28.11. - 05.12.2026 6.137 €	



WEBSITE

www.plujeme.cz



E-MAIL

info@plujeme.cz



PHONE

+420 720 755 085



MOBILE

+420 777 170 276



PLUJEME RÁDI S.R.O.

Dlouhá 730/35, 11000 Praha 1 – Staré Město, Czech Republic

PRICE AND AVAILABILITY

05.12. - 12.12.2026 6.137 €	12.12. - 19.12.2026 6.137 €	19.12. - 26.12.2026 6.137 €	02.01. - 09.01.2027 6.137 €
09.01. - 16.01.2027 6.137 €	16.01. - 23.01.2027 6.137 €	23.01. - 30.01.2027 6.137 €	30.01. - 06.02.2027 6.137 €
06.02. - 13.02.2027 6.137 €	13.02. - 20.02.2027 6.137 €	20.02. - 27.02.2027 6.137 €	27.02. - 06.03.2027 6.137 €
06.03. - 13.03.2027 6.137 €	13.03. - 20.03.2027 6.137 €	20.03. - 27.03.2027 6.137 €	27.03. - 03.04.2027 6.137 €
03.04. - 10.04.2027 6.137 €	10.04. - 17.04.2027 6.137 €	17.04. - 24.04.2027 6.137 €	24.04. - 01.05.2027 6.137 €
01.05. - 08.05.2027 6.137 €	08.05. - 15.05.2027 6.137 €	15.05. - 22.05.2027 6.137 €	22.05. - 29.05.2027 6.137 €
29.05. - 05.06.2027 6.137 €	05.06. - 12.06.2027 6.137 €	12.06. - 19.06.2027 6.137 €	19.06. - 26.06.2027 6.137 €
26.06. - 03.07.2027 6.137 €	03.07. - 10.07.2027 6.137 €	10.07. - 17.07.2027 6.137 €	17.07. - 24.07.2027 6.137 €
24.07. - 31.07.2027 6.137 €	31.07. - 07.08.2027 6.137 €		



WEBSITE

www.plujeme.cz



E-MAIL

info@plujeme.cz



PHONE

+420 720 755 085



MOBILE

+420 777 170 276



PLUJEME RÁDI S.R.O.

Dlouhá 730/35, 11000 Praha 1 – Staré Město, Czech Republic

PRICE AND AVAILABILITY

07.08. - 14.08.2027 6.137 €	14.08. - 21.08.2027 6.137 €	21.08. - 28.08.2027 6.137 €	28.08. - 04.09.2027 6.137 €
04.09. - 11.09.2027 6.137 €	11.09. - 18.09.2027 6.137 €	18.09. - 25.09.2027 6.137 €	25.09. - 02.10.2027 6.137 €
02.10. - 09.10.2027 6.137 €	09.10. - 16.10.2027 6.137 €	16.10. - 23.10.2027 6.137 €	23.10. - 30.10.2027 6.137 €
30.10. - 06.11.2027 6.137 €	06.11. - 13.11.2027 6.137 €	13.11. - 20.11.2027 6.137 €	20.11. - 27.11.2027 6.137 €
27.11. - 04.12.2027 6.137 €	04.12. - 11.12.2027 6.137 €	11.12. - 18.12.2027 6.137 €	18.12. - 25.12.2027 6.137 €



WEBSITE

www.plujeme.cz



E-MAIL

info@plujeme.cz



PHONE

+420 720 755 085



MOBILE

+420 777 170 276



PLUJEME RÁDI S.R.O.

Dlouhá 730/35, 11000 Praha 1 – Staré Město, Czech Republic