

# OCEANIS 40.1

JULIANA (2023)

Sailing yacht Oceanis 40.1 JULIANA, built in 2023 is anchored in the **Kos, Kos Marina, Dodecanese, Greece**. It has **3 cabins**, can accommodate **6 + 2 people** and has **2 toilets**. Bed linen and kitchen equipment are included in the price.

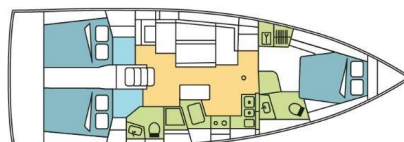

## YACHT SPECIFICATIONS

Yacht Base

**Kos, Kos Marina, Greece**

Yacht ID

**4868**

Brands

**Beneteau**

Yacht name

**JULIANA**

Production year

**2023**

Length

**42 ft**

Cabins

**3**

Berths

**6 + 2**

Max Persons

**8**

WC

**2**

Engine

**1 x 45 HP**

Fuel tank

**195 l**



**WEBSITE**

[www.plujeme.cz](http://www.plujeme.cz)



**PHONE**

+420 720 755 085



**MOBILE**

+420 777 170 276



**E-MAIL**

[info@plujeme.cz](mailto:info@plujeme.cz)



**PLUJEME RÁDI S.R.O.**

Dlouhá 730/35, 11000 Praha 1 – Staré Město, Czech Republic

## STANDARD YACHT EQUIPMENT

Comfort	<b>Mosquito nets</b>
Deck	<b>Bimini top, Cockpit light, Cockpit/stern, outside shower, Dinghy, Electric anchor windlass, Fenders, Outboard engine, Sprayhood</b>
Entertainment	<b>Hi-Fi system, Indoor speakers, Outdoor speakers</b>
Galley	<b>Oven, Water pump</b>
Interior	<b>Convertible table in salon, Electric fans in cabins, Electric toilet, LED lights, Upholstery</b>
Navigation	<b>AIS, Autopilot, Depthsounder, GPS chart plotter, Helm station, Speedometer (Speed log), Wind instrument/Anemometer</b>
Safety	<b>Extra water tank, VHF radio</b>
Sails	<b>Genoa sheet winches</b>
Yacht electrics	<b>230 volt socket, Batteries, Battery charger, Inverter, Service batteries</b>



**WEBSITE**

[www.plujeme.cz](http://www.plujeme.cz)



**E-MAIL**

[info@plujeme.cz](mailto:info@plujeme.cz)



**PHONE**

+420 720 755 085



**MOBILE**

+420 777 170 276



**PLUJEME RÁDI S.R.O.**

Dlouhá 730/35, 11000 Praha 1 – Staré Město, Czech Republic

## SERVICES

SELECTED SERVICES	OBLIGATORY	PAYMENT TYPE	PRICE
<b>Handling fees</b> (Payable now) <b>Season: 2026.</b>	Yes	per booking	<b>20,00 €</b>
<b>Preparation fee</b> (Payable now) <b>Season: 2026.</b> INCLUDED: starter pack – (1 gallon water or 4 bottles of 1.5L, 1 bottle of disinfectant, 1 small bottle of washing up liquid, 1 dish cloth, 1 sponge, garbage bags, 1 roll of paper towels, 1 box of matches, 1 roll of toilet paper in each head) // final cleaning // 1 set of bed sheets / cabin & 1 set of towels / pax, dinghy, outboard engine & initial supply of fuel, gas and water tanks // DYC assistance guarantee // 1st & last night in the marina // NOT INCLUDED: refuelling, gas & water consumption at end of charter, taxes if any, handling fees & additional equipment deposit.	Yes	per booking	<b>265,00 €</b>
<b>Crew change</b> (Payable now) <b>Season: 2026.</b> Any crew change during the charter is subject to € 250.- additional cost. The charge includes administration cost, change of bed linen and towels and one night at DYC ponton (marina fee included only if the same base than start base). It doesn't include cleaning, nor new transit log where applicable.	No	per booking	<b>250,00 €</b>
<b>Damage waiver</b> (Payable now) <b>Season: 2026.</b> Damage waiver limits your liability to the reduced Security Deposit . Mandatory when skipper is added. Price is per night of the charter ( minimum value of 7 nights & a maximum value of 21 nights). Not applicable for 4+ weeks charters , nor Regattas/Races.	No	per night	<b>40,00 €</b>
<b>Early boarding/check-in</b> (Payable now) <b>Season: 2026.</b> EB (boat only) - 13:00h, starting time of boat's delivery // limited number of early boardings on same departure day	No	per booking	<b>180,00 €</b>
<b>Early boarding/check-in</b> (Payable now) <b>Season: 2026.</b> EB + extra fee skipper - 13:00h, starting time of boat's delivery // limited number of early boardings on same departure day	No	per booking	<b>285,00 €</b>
<b>Early boarding/check-in</b> (Payable now) <b>Season: 2026.</b> EB + extra fee Skipper & Hostess - 13:00h, starting time of boat's delivery // limited number of early boardings on same departure day	No	per booking	<b>383,00 €</b>

<b>Electric &amp; Water consumption in the Marinas</b> (Payable at the base) <b>Season: 2026.</b> Electric & Water consumption based on 2 nights on our dock (base will confirm the amount to pay locally depending on nights spent on dock)	No	per booking	<b>16,00 €</b>
<b>Extra cleaning</b> (Payable now) <b>Season: 2026.</b> Optional Additional cleaning	No	per booking	<b>220,00 €</b>
<b>Extra set of linen (choose how many)</b> (Payable now) <b>Season: 2026.</b> Extra set of linen : 15 € 1 extra set of linen (2 sheets & 2 pillow case) - to be updated manually	No	per booking	<b>15,00 €</b>
<b>Extra set of towels (choose how many)</b> (Payable now) <b>Season: 2026.</b> Extra set of towels: 10 € 1 extra set of towels (1 face & 1 bath towel) - to be updated manually	No	per booking	<b>10,00 €</b>
<b>Full board 1-4 pax (number of guests to update manually)</b> (Payable now) <b>Season: 2026.</b> only available if cook is booked on board as the cook will do the provisioning based on client's preference. Includes breakfast, lunch & dinner + the crew's food. Does not included alcoholic drinks	No	per guest/day	<b>60,00 €</b>
<b>Full board 5-12 pax (number of guests to update manually)</b> (Payable now) <b>Season: 2026.</b> only available if cook is booked on board as the cook will do the provisioning based on client's preference. Includes breakfast, lunch & dinner + the crew's food. Does not included alcoholic drinks	No	per guest/day	<b>55,00 €</b>
<b>Half board 1-4 pax (number of guests to update manually)</b> (Payable now) <b>Season: 2026.</b> only available if cook is booked on board as the cook will do the provisioning based on client's preference. Includes breakfast & lunch OR dinner + the crew's food. Does not included alcoholic drinks	No	per guest/day	<b>50,00 €</b>
<b>Half board 5-12 pax (number of guests to update manually)</b> (Payable now) <b>Season: 2026.</b> only available if cook is booked on board as the cook will do the provisioning based on client's preference. Includes breakfast & lunch OR dinner + the crew's food. Does not included alcoholic drinks	No	per guest/day	<b>45,00 €</b>
<b>Hostess/Cook</b> (Payable now) <b>Season: 2026.</b> + provisioning, Crew on board must have their own toilets/showers. If either a skipper or a hostess/cook is on board, 1 double cabin will be required for him/her. If both a skipper and a hostess/cook are on board, 1 double cabin and 1 forepeak cabin will be required for them. Exceptions exists for specific layouts, Sales Agents will provide more details about the different boat models	No	per night	<b>195,00 €</b>

**Hostess/Cook (Payable now)** No per night **195,00 €**

**Season: 2026.** + provisioning, Crew on board must have their own toilets/showers. If either a skipper or a hostess/cook is on board, 1 double cabin will be required for him/her. If both a skipper and a hostess/cook are on board, 1 double cabin and 1 forepeak cabin will be required for them. Exceptions exists for specific layouts, Sales Agents will provide more details about the different boat models

**Hostess/Cook (Payable now)** No per night **215,00 €**

**Season: 2026.** + provisioning, Crew on board must have their own toilets/showers. If either a skipper or a hostess/cook is on board, 1 double cabin will be required for him/her. If both a skipper and a hostess/cook are on board, 1 double cabin and 1 forepeak cabin will be required for them. Exceptions exists for specific layouts, Sales Agents will provide more details about the different boat models

**Regatta surcharge (Payable now)** No per booking **0,00 €**

**Season: 2026.** A special race deposit need to be doubled manually once the regatta surcharge is added.

**Skipper (Payable now)** No per night **210,00 €**

**Season: 2026.** + provisioning, Crew on board must have their own toilets/showers. If either a skipper or a hostess/cook is on board, 1 double cabin will be required for him/her. If both a skipper and a hostess/cook are on board, 1 double cabin and 1 forepeak cabin will be required for them. Exceptions exists for specific layouts, Sales Agents will provide more details about the different boat models

**Skipper (Payable now)** No per night **210,00 €**

**Season: 2026.** + provisioning, Crew on board must have their own toilets/showers. If either a skipper or a hostess/cook is on board, 1 double cabin will be required for him/her. If both a skipper and a hostess/cook are on board, 1 double cabin and 1 forepeak cabin will be required for them. Exceptions exists for specific layouts, Sales Agents will provide more details about the different boat models

**Skipper (Payable now)** No per night **230,00 €**

**Season: 2026.** + provisioning, Crew on board must have their own toilets/showers. If either a skipper or a hostess/cook is on board, 1 double cabin will be required for him/her. If both a skipper and a hostess/cook are on board, 1 double cabin and 1 forepeak cabin will be required for them. Exceptions exists for specific layouts, Sales Agents will provide more details about the different boat models

**WI-FI Internet connection on board (Payable now)** No per week **50,00 €**

**Season: 2026.** unlimited data

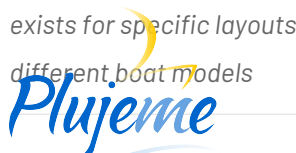

**WEBSITE**  
www.plujeme.cz



**PHONE**  
+420 720 755 085



**MOBILE**  
+420 777 170 276



**E-MAIL**  
info@plujeme.cz



**PLUJEME RÁDI S.R.O.**  
Dlouhá 730/35, 11000 Praha 1 – Staré Město, Czech Republic

## ADDITIONAL EXTRAS

EXTRA	OBLIGATORY	PAYMENT TYPE	PRICE
<b>Railing net (Safety net)</b> (Payable now) <i>Season: 2026. net is supplied but not installed - Payable now</i>	No	per booking	<b>220,00 €</b>
<b>Stand up paddle (SUP)</b> (Payable now) <i>Season: 2026. Price per day - Payable now</i>	No	per night	<b>15,00 €</b>

**WEBSITE**

[www.plujeme.cz](http://www.plujeme.cz)

**E-MAIL**

[info@plujeme.cz](mailto:info@plujeme.cz)

**PHONE**

+420 720 755 085

**MOBILE**

+420 777 170 276

**PLUJEME RÁDI S.R.O.**

Dlouhá 730/35, 11000 Praha 1 – Staré Město, Czech Republic

## PRICE AND AVAILABILITY

25.04. - 02.05.2026 NOT AVAILABLE	02.05. - 09.05.2026 NOT AVAILABLE	09.05. - 16.05.2026 1.550 € 2.725 €	16.05. - 23.05.2026 NOT AVAILABLE
23.05. - 30.05.2026 NOT AVAILABLE	30.05. - 13.06.2026 NOT AVAILABLE	13.06. - 20.06.2026 NOT AVAILABLE	20.06. - 27.06.2026 3.148 € 3.935 €
27.06. - 04.07.2026 3.312 € 4.140 €	04.07. - 11.07.2026 NOT AVAILABLE	11.07. - 25.07.2026 NOT AVAILABLE	25.07. - 01.08.2026 3.468 € 4.335 €
01.08. - 08.08.2026 3.889 € 4.575 €	08.08. - 15.08.2026 3.889 € 4.575 €	15.08. - 22.08.2026 3.689 € 4.340 €	22.08. - 29.08.2026 3.647 € 4.290 €
29.08. - 05.09.2026 5.215 €	05.09. - 12.09.2026 NOT AVAILABLE	12.09. - 19.09.2026 5.185 €	19.09. - 26.09.2026 NOT AVAILABLE
26.09. - 03.10.2026 5.175 €	03.10. - 10.10.2026 3.625 €	10.10. - 17.10.2026 NOT AVAILABLE	17.10. - 07.11.2026 NOT AVAILABLE
07.11. - 14.11.2026 1.350 € 1.500 €	20.11. - 12.03.2027 NOT AVAILABLE		



**WEBSITE**  
[www.plujeme.cz](http://www.plujeme.cz)



**E-MAIL**  
[info@plujeme.cz](mailto:info@plujeme.cz)



**PHONE**  
+420 720 755 085



**MOBILE**  
+420 777 170 276



**PLUJEME RÁDI S.R.O.**  
Dlouhá 730/35, 11000 Praha 1 – Staré Město, Czech Republic

## PRICE AND AVAILABILITY

13.03. - 20.03.2027 1.350 € 1.500 €	20.03. - 27.03.2027 1.350 € 1.500 €	27.03. - 03.04.2027 1.350 € 1.500 €	03.04. - 10.04.2027 1.350 € 1.500 €
10.04. - 17.04.2027 1.350 € 1.500 €	17.04. - 24.04.2027 1.598 € 1.775 €	24.04. - 01.05.2027 1.742 € 1.935 €	01.05. - 08.05.2027 1.931 € 2.145 €
08.05. - 15.05.2027 2.336 € 2.595 €	15.05. - 22.05.2027 2.498 € 2.775 €	22.05. - 29.05.2027 2.957 € 3.285 €	29.05. - 05.06.2027 3.231 € 3.590 €
05.06. - 12.06.2027 3.591 € 3.990 €	12.06. - 19.06.2027 3.591 € 3.990 €	19.06. - 26.06.2027 3.758 € 4.175 €	26.06. - 03.07.2027 3.758 € 4.175 €
03.07. - 10.07.2027 3.758 € 4.175 €	10.07. - 17.07.2027 3.758 € 4.175 €	17.07. - 24.07.2027 4.158 € 4.620 €	24.07. - 31.07.2027 4.590 € 5.100 €
31.07. - 07.08.2027 5.085 € 5.650 €			



**WEBSITE**  
www.plujeme.cz



**E-MAIL**  
info@plujeme.cz



**PHONE**  
+420 720 755 085



**MOBILE**  
+420 777 170 276



**PLUJEME RÁDI S.R.O.**  
Dlouhá 730/35, 11000 Praha 1 – Staré Město, Czech Republic

## PRICE AND AVAILABILITY

07.08. - 14.08.2027 <b>5.085 €</b> 5.650 €	14.08. - 21.08.2027 <b>4.820 €</b> 5.355 €	21.08. - 28.08.2027 <b>4.289 €</b> 4.765 €	28.08. - 04.09.2027 <b>4.289 €</b> 4.765 €
04.09. - 11.09.2027 <b>4.352 €</b> 4.835 €	11.09. - 18.09.2027 <b>4.235 €</b> 4.705 €	18.09. - 25.09.2027 <b>4.235 €</b> 4.705 €	25.09. - 02.10.2027 <b>4.275 €</b> 4.750 €
02.10. - 09.10.2027 <b>3.285 €</b> 3.650 €	09.10. - 16.10.2027 <b>2.552 €</b> 2.835 €	16.10. - 23.10.2027 <b>2.088 €</b> 2.320 €	23.10. - 30.10.2027 <b>1.809 €</b> 2.010 €
30.10. - 06.11.2027 <b>1.350 €</b> 1.500 €	06.11. - 13.11.2027 <b>1.350 €</b> 1.500 €	13.11. - 20.11.2027 <b>1.350 €</b> 1.500 €	20.11. - 27.11.2027 <b>1.350 €</b> 1.500 €
27.11. - 04.12.2027 <b>1.350 €</b> 1.500 €	04.12. - 11.12.2027 <b>1.350 €</b> 1.500 €	11.12. - 18.12.2027 <b>1.350 €</b> 1.500 €	18.12. - 25.12.2027 <b>1.350 €</b> 1.500 €



### WEBSITE

[www.plujeme.cz](http://www.plujeme.cz)



### E-MAIL

[info@plujeme.cz](mailto:info@plujeme.cz)



### PHONE

+420 720 755 085



### MOBILE

+420 777 170 276



### PLUJEME RÁDI S.R.O.

Dlouhá 730/35, 11000 Praha 1 – Staré Město, Czech Republic