

# FOUNTAIN PAJOT ELBA 45

No Agenda (2022)

Catamaran Fountaine Pajot Elba 45 No Agenda, built in 2022 is anchored in the **Bahamas, Abacos, Boat Harbour Marina, Abaco Islands, Bahamas**. It has **4 cabins**, can accommodate **8 people** and has **4 toilets**. Bed linen and kitchen equipment are included in the price.

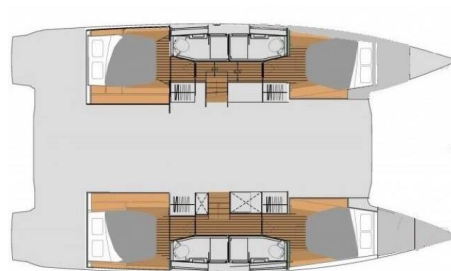

## YACHT SPECIFICATIONS

Yacht Base

**Bahamas, Abacos, Boat Harbour Marina, Bahamas**

Yacht ID

**4863**

Brands

**Fountaine Pajot**

Yacht name

**No Agenda**

Production year

**2022**

Length

**44 ft**

Cabins

**4**

Berths

**8**

WC

**4**

Engine

**2 x 60 HP**

Fuel tank

**470 l**



**WEBSITE**

[www.plujeme.cz](http://www.plujeme.cz)



**PHONE**

+420 720 755 085



**MOBILE**

+420 777 170 276



**E-MAIL**

[info@plujeme.cz](mailto:info@plujeme.cz)



**PLUJEME RÁDI S.R.O.**

Dlouhá 730/35, 11000 Praha 1 – Staré Město, Czech Republic

## STANDARD YACHT EQUIPMENT

Deck **Bimini top, Cockpit fridge, Cockpit table, Cockpit/stern, outside shower, Outboard engine, Sprayhood**

---

Entertainment **Fusion radio, TV, Underwater lights**

---

Galley **Freezer, Ice maker, Kitchen utensils (Galley equipment, cutlery), Oven, Refrigerator, Stove**

---

Navigation **Autopilot, GPS chart plotter - cockpit, Wind/speed/depth instruments**

---

Safety **Black Water Tank, VHF radio**

---

Sails **Electric winch, Lazy bag, Lazy jacks**

---

Yacht electrics **110V socket, Air Conditioning, Generator, Inverter, Solar panels, USB sockets, Watermaker - desalinator**



**WEBSITE**

[www.plujeme.cz](http://www.plujeme.cz)



**PHONE**

+420 720 755 085



**MOBILE**

+420 777 170 276



**E-MAIL**

[info@plujeme.cz](mailto:info@plujeme.cz)



**PLUJEME RÁDI S.R.O.**

Dlouhá 730/35, 11000 Praha 1 – Staré Město, Czech Republic

## SERVICES

SELECTED SERVICES	OBLIGATORY	PAYMENT TYPE	PRICE
<b>Bahamas foreign charter tax</b> (Payable now) <b>Season: 2026.</b>	Yes	per booking	<b>0,00 €</b>
<b>Bahamas Taxes</b> (Payable now) <b>Season: 2026.</b>	Yes	per booking	<b>0,00 €</b>
<b>DRA</b> (Payable now) <b>Season: 2026.</b>	Yes	per day	<b>50,00 €</b>
<b>ASA Processing Fee</b> (Payable now) <b>Season: 2026.</b> Certificate 103	No	per person/per course	<b>150,00 €</b>
<b>ASA Processing Fee</b> (Payable now) <b>Season: 2026.</b> Certificate 101	No	per person/per course	<b>150,00 €</b>
<b>ASA Processing Fee</b> (Payable now) <b>Season: 2026.</b> Certificate 114	No	per person/per course	<b>200,00 €</b>
<b>ASA Processing Fee</b> (Payable now) <b>Season: 2026.</b> Certificate 104	No	per person/per course	<b>200,00 €</b>
<b>ASA Processing Fee</b> (Payable now) <b>Season: 2026.</b> Overnight Open Water. Available only on Flotilla Sails; Certificate 106	No	per person/per course	<b>250,00 €</b>
<b>ASA Processing Fee</b> (Payable now) <b>Season: 2026.</b> Certificate 101, 103 & 104	No	per person/per course	<b>400,00 €</b>
<b>ASA Processing Fee</b> (Payable now) <b>Season: 2026.</b> Overnight Open Water. Available only on Flotilla Sails; Certificate 105	No	per person/per course	<b>400,00 €</b>
<b>ASA Processing Fee</b> (Payable now) <b>Season: 2026.</b> Overnight Open Water. Available only on Flotilla Sails; Certificate 105 & 106	No	per person/per course	<b>550,00 €</b>
<b>Captain By Day</b> (Payable now) <b>Season: 2026.</b>	No	per day + food	<b>350,00 €</b>

<b>Captain By Night</b> (Payable now) <b>Season: 2026.</b>	No	per night	<b>450,00 €</b>
<b>Chef</b> (Payable now) <b>Season: 2026.</b> Overnight	No	per day + food	<b>400,00 €</b>
<b>Credit card surcharge</b> (Payable now) <b>Season: 2026.</b> A 3% convenience fee will be added to all credit card transactions	No	per booking	<b>0,00 €</b>
<b>Daily trips</b> (Payable now) <b>Season: 2026.</b> Trips north from Guana	No	per booking	<b>400,00 €</b>
<b>Education</b> (Payable at the base) <b>Season: 2026.</b> NauticEd skipper training hours	No	per person/per course	<b>100,00 €</b>
<b>Education</b> (Payable at the base) <b>Season: 2026.</b> NauticEd bareboat hours	No	per person/per course	<b>200,00 €</b>
<b>Extra cleaning</b> (Payable at the base) <b>Season: 2026.</b>	No	per service	<b>400,00 €</b>
<b>Fuel charge</b> (Payable now) <b>Season: 2026.</b> + 500,00\$ deposit; This is only for day trips	No	per booking	<b>300,00 €</b>
<b>Gratuity</b> (Payable now) <b>Season: 2026.</b> On Day Trips	No	per booking	<b>220,00 €</b>
<b>Hostess/Cook</b> (Payable now) <b>Season: 2026.</b>	No	per day + food	<b>350,00 €</b>
<b>Participation fee</b> (Payable at the base) <b>Season: 2026.</b> NauticEd sign up fee	No	per person/per course	<b>175,00 €</b>
<b>Rescheduling</b> (Payable now) <b>Season: 2026.</b> On Day Trips	No	per booking	<b>350,00 €</b>
<b>Sleep over after check out</b> (Payable now) <b>Season: 2026.</b>	No	per booking	<b>700,00 €</b>
<b>Sleep over before check in</b> (Payable now) <b>Season: 2026.</b> at 12:00 PM	No	per booking	<b>700,00 €</b>



**WEBSITE**  
www.plujeme.cz



**PHONE**  
+420 720 755 085



**MOBILE**  
+420 777 170 276



**E-MAIL**  
info@plujeme.cz



**PLUJEME RÁDI S.R.O.**  
Dlouhá 730/35, 11000 Praha 1 – Staré Město, Czech Republic

## ADDITIONAL EXTRAS

EXTRA	OBLIGATORY	PAYMENT TYPE	PRICE
<b>Fins</b> (Payable now) <b>Season: 2026.</b> Payable now	No	per week/ person	<b>35,00 €</b>
<b>Fishing cane/rod</b> (Payable now) <b>Season: 2026.</b> Payable now	No	per week	<b>60,00 €</b>
<b>Inflatable swimming platform</b> (Payable now) <b>Season: 2026.</b> POP-UP DOCK - Payable now	No	per week	<b>250,00 €</b>
<b>Kayak</b> (Payable now) <b>Season: 2026.</b> Tandem - Payable now	No	per week	<b>250,00 €</b>
<b>Snorkeling equipment</b> (Payable now) <b>Season: 2026.</b> Payable now	No	per week/ person	<b>50,00 €</b>
<b>Stand up paddle (SUP)</b> (Payable now) <b>Season: 2026.</b> Payable now	No	per week	<b>250,00 €</b>
<b>Starlink</b> (Payable now) <b>Season: 2026.</b> Payable now	No	per week	<b>100,00 €</b>



**WEBSITE**  
www.plujeme.cz



**E-MAIL**  
info@plujeme.cz



**PHONE**  
+420 720 755 085



**PLUJEME RÁDI S.R.O.**  
Dlouhá 730/35, 11000 Praha 1 – Staré Město, Czech Republic



**MOBILE**  
+420 777 170 276

## PRICE AND AVAILABILITY

30.04. - 07.06.2026

NOT AVAILABLE

08.06. - 21.08.2098

NOT AVAILABLE



### WEBSITE

[www.plujeme.cz](http://www.plujeme.cz)



### E-MAIL

[info@plujeme.cz](mailto:info@plujeme.cz)



### PHONE

+420 720 755 085



### MOBILE

+420 777 170 276



### PLUJEME RÁDI S.R.O.

Dlouhá 730/35, 11000 Praha 1 – Staré Město, Czech Republic