

FOUNTAINÉ PAJOT LUCIA 40

Infinite Blue (2020)

Catamaran Fountaine Pajot Lucia 40 Infinite Blue, built in 2020 is anchored in the **St. Thomas, Frenchtown Marina, US-Virgin Islands, United States Virgin Islands**. It has **4 cabins**, can accommodate **8 people** and has **2 toilets**. Bed linen and kitchen equipment are included in the price.

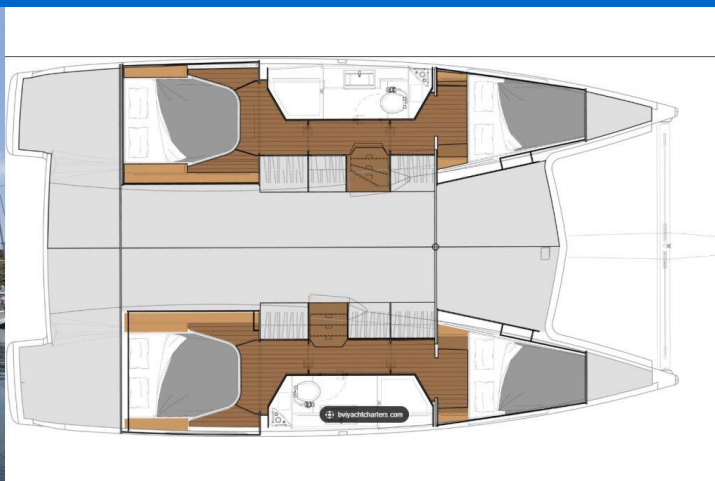

YACHT SPECIFICATIONS

Yacht Base

**St. Thomas, Frenchtown Marina,
United States Virgin Islands**

Yacht ID

4849

Brands

Fountaine Pajot

Yacht name

Infinite Blue

Production year

2020

Length

38 ft

Cabins

4

Berths

8

Max Persons

8

WC

2

Engine

2 x 40 HP

Fuel tank

300 l



WEBSITE

www.plujeme.cz



PHONE

+420 720 755 085



MOBILE

+420 777 170 276



E-MAIL

info@plujeme.cz



PLUJEME RÁDI S.R.O.

Dlouhá 730/35, 11000 Praha 1 – Staré Město, Czech Republic

STANDARD YACHT EQUIPMENT

Deck	Dinghy with outboard engine, Electric anchor windlass, Grill/Barbecue/Plancha
Entertainment	Radio, TV
Galley	Kitchen utensils (Galley equipment, cutlery), Microwave, Oven, Refrigerator, Stove
Interior	Electric toilet
Navigation	Autopilot, GPS chart plotter, Wind/speed/depth instruments
Safety	Black Water Tank, VHF radio
Sails	Electric winch, Lazy bag, Lazy jacks
Yacht electrics	Air Conditioning, Generator, Inverter, USB sockets, Watermaker - desalinator



WEBSITE

www.plujeme.cz



E-MAIL

info@plujeme.cz



PHONE

+420 720 755 085



MOBILE

+420 777 170 276



PLUJEME RÁDI S.R.O.

Dlouhá 730/35, 11000 Praha 1 – Staré Město, Czech Republic

SERVICES

SELECTED SERVICES	OBLIGATORY	PAYMENT TYPE	PRICE
Cancellation insurance (Payable now) Season: 2026.	Yes	per booking	200,00 €
DRA (Payable now) Season: 2026.	Yes	per day	50,00 €
Outboard fuel & Gas (Payable now) Season: 2026. Dinghy Fuel	Yes	per booking	50,00 €
Surcharge (Payable now) Season: 2026. BVI Surcharge	Yes	per booking	500,00 €
ASA Logbook (Payable now) Season: 2026.	No	per piece	20,00 €
ASA Processing Fee (Payable now) Season: 2026. Certificate 101	No	per person/per course	50,00 €
ASA Processing Fee (Payable now) Season: 2026. Certificate 104	No	per person/per course	50,00 €
ASA Processing Fee (Payable now) Season: 2026. Certificate 103	No	per person/per course	50,00 €
ASA Processing Fee (Payable now) Season: 2026. Certificate 114	No	per person/per course	50,00 €
ASA Textbook (Payable at the base) Season: 2026.	No	per piece	50,00 €
Captain (Payable at the base) Season: 2026. Paid directly to Captain	No	per day + food	300,00 €
Captain (Payable at the base) Season: 2026. Instructional; Paid directly to Captain	No	per day	450,00 €
Day Checkout Captain (Payable at the base) Season: 2026. 8 hour Captain. Paid directly to Captain; Sleepaboard is mandatory with the check-out Captain.	No	per booking	300,00 €

Express Service (Payable now) Season: 2026. Labor cost	No	per booking	250,00 €
Sleep over before check in (Payable now) Season: 2026. 50% of average daily charter price; 4pm with briefing the following morning	No	per booking	0,00 €
Surcharge (Payable now) Season: 2026. BVI Extended Surcharge	No	per booking	2.100,00 €
Wire Transfer Fee (Payable now) Season: 2026.	No	per booking	10,00 €



WEBSITE
www.plujeme.cz



E-MAIL
info@plujeme.cz



PHONE
+420 720 755 085



PLUJEME RÁDI S.R.O.
Dlouhá 730/35, 11000 Praha 1 – Staré Město, Czech Republic



MOBILE
+420 777 170 276

ADDITIONAL EXTRAS

EXTRA	OBLIGATORY	PAYMENT TYPE	PRICE
Fishing rod holder <i>(Payable now)</i> Season: 2026 <i>Payable now</i>	No	per piece	20,00 €

**WEBSITE**

www.plujeme.cz

**E-MAIL**

info@plujeme.cz

**PHONE**

+420 720 755 085

**MOBILE**

+420 777 170 276

**PLUJEME RÁDI S.R.O.**

Dlouhá 730/35, 11000 Praha 1 – Staré Město, Czech Republic