

# FOUNTAINÉ PAJOT ISLA 40

IIde (2022)

Catamaran Fountaine Pajot Isla 40 IIde, built in 2022 is anchored in the **Ibiza, Balearic Islands, Spain**. It has **3 + 1 cabins**, can accommodate **6 + 1 + 1 people** and has **3 toilets**. Bed linen and kitchen equipment are included in the price.

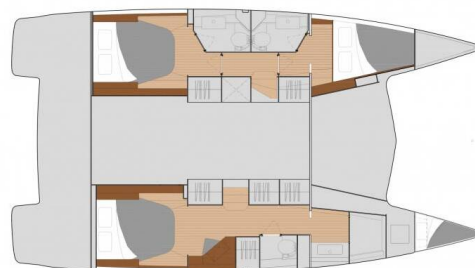

## YACHT SPECIFICATIONS

Yacht Base  
**Ibiza, Spain**

Yacht ID  
**4825**

Brands  
**Fountaine Pajot**

Yacht name  
**IIde**

Production year  
**2022**

Length  
**36 ft**

Cabins  
**3 + 1**

Berths  
**6 + 1 + 1**

Max Persons  
**8**

WC  
**3**

Engine  
**2 x 30 HP**

Fuel tank  
**01**



**WEBSITE**  
[www.plujeme.cz](http://www.plujeme.cz)



**PHONE**  
+420 720 755 085



**MOBILE**  
+420 777 170 276



**E-MAIL**  
[info@plujeme.cz](mailto:info@plujeme.cz)



**PLUJEME RÁDI S.R.O.**  
Dlouhá 730/35, 11000 Praha 1 – Staré Město, Czech Republic

## STANDARD YACHT EQUIPMENT

Comfort	<b>Sheets, Towels</b>
Deck	<b>Anchor, Bimini top, Boat hook, Cockpit/stern, outside shower, Dinghy with outboard engine, Electric anchor windlass, Fenders, Remote control for anchor winch with chain counter at helm</b>
Entertainment	<b>FUSION sound system</b>
Galley	<b>Kitchen utensils (Galley equipment, cutlery), Microwave, Oven, Refrigerator</b>
Interior	<b>Ambiental lighting, Convertible table in salon, Curtains, Electric fans, Electric toilet</b>
Navigation	<b>AIS, Autopilot, GPS chart plotter</b>
Safety	<b>EPIRB-Distress radio beacons, First aid kit, Life belts (Safety harness), Life jackets, Liferaft, Set of tools, Signal rockets and torches, VHF radio</b>
Sails	<b>Electric winch, Lazy bag, Lazy jacks</b>
Yacht electrics	<b>12V Socket, Air Conditioning, Bilge pump - Electric, Generator, Inverter, Start battery, Watermaker - desalinator</b>



**WEBSITE**

[www.plujeme.cz](http://www.plujeme.cz)



**PHONE**

+420 720 755 085



**MOBILE**

+420 777 170 276



**E-MAIL**

[info@plujeme.cz](mailto:info@plujeme.cz)



**PLUJEME RÁDI S.R.O.**

Dlouhá 730/35, 11000 Praha 1 – Staré Město, Czech Republic

## SERVICES

SELECTED SERVICES

OBLIGATORY

PAYMENT TYPE

PRICE



**WEBSITE**

[www.plujeme.cz](http://www.plujeme.cz)



**E-MAIL**

[info@plujeme.cz](mailto:info@plujeme.cz)



**PHONE**

+420 720 755 085



**MOBILE**

+420 777 170 276



**PLUJEME RÁDI S.R.O.**

Dlouhá 730/35, 11000 Praha 1 – Staré Město, Czech Republic

## ADDITIONAL EXTRAS

EXTRA	OBLIGATORY	PAYMENT TYPE	PRICE
-------	------------	--------------	-------

**WEBSITE**

[www.plujeme.cz](http://www.plujeme.cz)

**E-MAIL**

[info@plujeme.cz](mailto:info@plujeme.cz)

**PHONE**

+420 720 755 085

**MOBILE**

+420 777 170 276

**PLUJEME RÁDI S.R.O.**

Dlouhá 730/35, 11000 Praha 1 – Staré Město, Czech Republic