

# FOUNTAINÉ PAJOT ISLA 40

Barnacle (2023)

Catamaran Fountaine Pajot Isla 40 Barnacle, built in 2023 is anchored in the Seychelles, Eden Island Marina, Mahé, Seychelles. It has 4 + 1 cabins, can accommodate 8 + 1 people and has 2 toilets. Bed linen and kitchen equipment are included in the price.

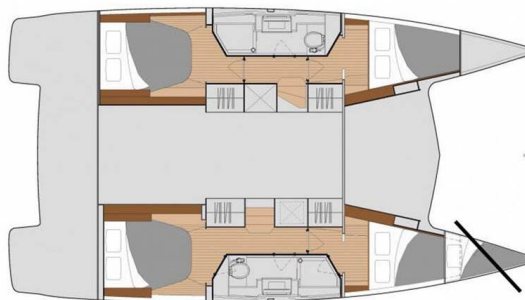

## YACHT SPECIFICATIONS

Yacht Base

**Seychelles, Eden Island Marina,  
Seychelles**

Yacht ID

**4777**

Brands

**Fountaine Pajot**

Yacht name

**Barnacle**

Production year

**2023**

Length

**39 ft**

Cabins

**4 + 1**

Berths

**8 + 1**

Max Persons

**9**

WC

**2**

Engine

**2 x 30 HP**

Fuel tank

**470 l**



**WEBSITE**

[www.plujeme.cz](http://www.plujeme.cz)



**PHONE**

+420 720 755 085



**MOBILE**

+420 777 170 276



**E-MAIL**

[info@plujeme.cz](mailto:info@plujeme.cz)



**PLUJEME RÁDI S.R.O.**

Dlouhá 730/35, 11000 Praha 1 – Staré Město, Czech Republic

## STANDARD YACHT EQUIPMENT

Comfort	<b>Cockpit cushions, Towels</b>
Deck	<b>Anchor with chain, Bimini top, Cockpit fridge, Cockpit table, Cockpit/stern, outside shower, Dinghy with outboard engine, Electric anchor windlass, Rail openings both sides, Spring cleats, Swimming ladder, Teak cockpit table with folding leaves</b>
Entertainment	<b>Indoor speakers, Outdoor speakers, Radio CD player, Underwater lights</b>
Galley	<b>Kitchen utensils (Galley equipment, cutlery), Oven, Refrigerator</b>
Interior	<b>Electric fans</b>
Navigation	<b>Autopilot, Compass, GPS chart plotter - cockpit, Tridata, Wind instrument/Anemometer</b>
Safety	<b>Black Water Tank, VHF radio</b>
Sails	<b>Electric winch, Lazy bag, Lazy jacks, Winch</b>
Yacht electrics	<b>Air Conditioning, Battery charger, DSC station, Generator, Inverter, Plug 220V, 12 V, Service batteries, Shore connection 220 V, Start battery, Water heater, Watermaker - desalinator</b>



**WEBSITE**

[www.plujeme.cz](http://www.plujeme.cz)



**PHONE**

+420 720 755 085



**MOBILE**

+420 777 170 276



**E-MAIL**

[info@plujeme.cz](mailto:info@plujeme.cz)



**PLUJEME RÁDI S.R.O.**

Dlouhá 730/35, 11000 Praha 1 - Staré Město, Czech Republic

## SERVICES

SELECTED SERVICES	OBLIGATORY	PAYMENT TYPE	PRICE
<b>Comfort Pack</b> (Payable now) <b>Season: 2026 Exotic</b> . To be added upon client's price - OBLIGATORY - SEY Welcome package, final cleaning, bed sheets & towels, dinghy, outboard engine & fuel, propane gas, full water tanks, snorkelling equipment, WIFI with unlimited use. However, if the limit of 20GB per day is crossed, the internet speed is reduced for the rest of that day. Yacht Fuel is not included - the fuel tank will be full when your charter starts and you are responsible for topping off the fuel tank at the end of your charter. Security deposit is obligatory and is paid on spot in the base.	Yes	per booking	<b>540,00 €</b>
<b>Handling fees</b> (Payable now) <b>Season: 2026 Exotic</b> .	Yes	per booking	<b>35,00 €</b>
<b>Preparation fee</b> (Payable now) <b>Season: 2026 Exotic</b> . LUDED: Welcome pack // final cleaning // 1 set of bed sheets / cabin & 1 set of towels / pax, dinghy, outboard engine & initial supply of fuel, gas and water tanks // 1st & last night in the marina // NOT INCLUDED: refuelling, gas & water consumption at end of charter, taxes if any, handling fees & additional equipment deposit.	Yes	per booking	<b>395,00 €</b>
<b>Tourist tax</b> (Payable at the base) <b>Season: 2026 Exotic</b> . According to S.I. 52 of 2023 ENVIRONMENT PROTECTION ACT (ext. of Act 18 of 2016), a Seychelles compulsory tourist tax of 100SCR per person/day (or equivalent Currency as per daily rate is applied), payable at base. NOT applicable to citizens and residents of Seychelles, children of 12 years and below (visitors), and Navigare Yacht crew. (Price will be adjusted according to the crew list)	Yes	per guest/day	<b>7,00 €</b>
<b>Cook</b> (Payable now) <b>Season: 2026 Exotic</b> . +provisioning ; Crew on board must have their own toilets/ showers. If either a skipper or a hostess/cook is on board, 1 double cabin will be required for him/her. If both a skipper and a hostess/cook are on board, 1 double cabin and 1 forepeak cabin will be required for them. Exceptions exists for specific layouts, Sales Agents will provide more details about the different boat models. Cooking breakfast, lunch, 5 dinners a week, supply, keeping the kitchen clean (not the rest of the boat, not the cabins).	No	per day + food	<b>145,00 €</b>

<p><b>Cook</b> (Payable now)</p> <p><b>Season: 2026 Exotic</b> . +provisioning ; Crew on board must have their own toilets/ showers. If either a skipper or a hostess/cook is on board, 1 double cabin will be required for him/her. If both a skipper and a hostess/cook are on board, 1 double cabin and 1 forepeak cabin will be required for them. Exceptions exists for specific layouts, Sales Agents will provide more details about the different boat models. Cooking breakfast, lunch, 5 dinners a week, supply, keeping the kitchen clean (not the rest of the boat, not the cabins).</p>	No	per day + food	<b>145,00 €</b>
<p><b>Cook</b> (Payable now)</p> <p><b>Season: 2026 Exotic</b> . +provisioning ; Crew on board must have their own toilets/ showers. If either a skipper or a hostess/cook is on board, 1 double cabin will be required for him/her. If both a skipper and a hostess/cook are on board, 1 double cabin and 1 forepeak cabin will be required for them. Exceptions exists for specific layouts, Sales Agents will provide more details about the different boat models. A gratuity of 15-20% of the crew fee is customary for excellent service. Cooking breakfast, lunch, dinners, keeping the kitchen clean (not the rest of the boat, not the cabins). NOTE: Cook details will be available 3 days before the charter.</p>	No	per day + food	<b>160,00 €</b>
<p><b>Damage waiver</b> (Payable now)</p> <p><b>Season: 2026 Exotic</b> . Damage waiver limits your liability to the reduced Security Deposit . Mandatory when skipper is added. Price is per night of the charter ( minimum value of 7 nights &amp; a maximum value of 21 nights) Not applicable for 4+ weeks charters , nor Regattas/Races.</p>	No	per night	<b>60,00 €</b>
<p><b>Extra cleaning</b> (Payable now)</p> <p><b>Season: 2026 Exotic</b> . Optional Additional cleaning</p>	No	per booking	<b>285,00 €</b>
<p><b>Extra set of linen (choose how many)</b> (Payable now)</p> <p><b>Season: 2026 Exotic</b> . Extra set of linen : 15 € 1 set of linen (2 sheets &amp; 2 pillow case)- to be updated manually</p>	No	per booking	<b>15,00 €</b>
<p><b>Extra set of towels (choose how many)</b> (Payable now)</p> <p><b>Season: 2026 Exotic</b> . Extra set of towels: 10 € 1 set of towels (1 face &amp; 1 bath towel)- to be updated manually</p>	No	per booking	<b>10,00 €</b>
<p><b>Full board 1-4 pax (number of guests to update manually)</b> (Payable now)</p> <p><b>Season: 2026 Exotic</b> . Only available if cook is booked on board as the cook will do the provisioning based on client's preference. Includes breakfast, lunch &amp; dinner + the crew's food. Does not include fuel, alcoholic drinks, moorings park or landing fees.</p>	No	per guest/day	<b>60,00 €</b>

<p><b>Full board 5-12 pax (number of guests to update manually)</b> (Payable now)</p> <p><b>Season: 2026 Exotic</b> . Only available if cook is booked on board as the cook will do the provisioning based on client's preference. Includes breakfast, lunch &amp; dinner + the crew's food. Does not include fuel, alcoholic drinks, moorings park or landing fees.</p>	No	per guest/day	<b>55,00 €</b>
<p><b>Gritchen cancellation insurance</b> (Payable now)</p> <p><b>Season: 2026 Exotic</b> . with Covid coverage (4% of client's Total price)- European clients Only</p>	No	per booking	<b>0,00 €</b>
<p><b>Half board 1-4 pax (number of guests to update manually)</b> (Payable now)</p> <p><b>Season: 2026 Exotic</b> . only available if cook is booked on board as the cook will do the provisioning based on client's preference. Includes breakfast &amp; lunch OR dinner + the crew's food. Does not included alcoholic drinks</p>	No	per guest/day	<b>50,00 €</b>
<p><b>Half board 5-12 pax (number of guests to update manually)</b> (Payable now)</p> <p><b>Season: 2026 Exotic</b> . only available if cook is booked on board as the cook will do the provisioning based on client's preference. Includes breakfast &amp; lunch OR dinner + the crew's food. Does not included alcoholic drinks</p>	No	per guest/day	<b>45,00 €</b>
<p><b>Skipper</b> (Payable now)</p> <p><b>Season: 2026 Exotic</b> . +provisioning ; Crew on board must have their own toilets/ showers. If either a skipper or a hostess/cook is on board, 1 double cabin will be required for him/her. If both a skipper and a hostess/cook are on board, 1 double cabin and 1 forepeak cabin will be required for them. Exceptions exists for specific layouts, Sales Agents will provide more details about the different boat models. ***NOTE: Skipper details will be available 3 days before the charter.</p>	No	per day + food	<b>170,00 €</b>
<p><b>Skipper</b> (Payable now)</p> <p><b>Season: 2026 Exotic</b> . +provisioning ; Crew on board must have their own toilets/ showers. If either a skipper or a hostess/cook is on board, 1 double cabin will be required for him/her. If both a skipper and a hostess/cook are on board, 1 double cabin and 1 forepeak cabin will be required for them. Exceptions exists for specific layouts, Sales Agents will provide more details about the different boat models. ***NOTE: Skipper details will be available 3 days before the charter.</p>	No	per day + food	<b>170,00 €</b>
<p><b>Skipper</b> (Payable now)</p> <p><b>Season: 2026 Exotic</b> . +provisioning ; Crew on board must have their own toilets/ showers. If either a skipper or a hostess/cook is on board, 1 double cabin will be required for him/her. If both a skipper and a hostess/cook are on board, 1 double cabin and 1 forepeak cabin will be required for them. Exceptions exists for specific layouts, Sales Agents will provide more details about the different boat models. ***NOTE: Skipper details will be available 3 days before the charter.</p>	No	per day + food	<b>190,00 €</b>

**Skipper+Cook** (Payable now)

No

per day + food

**220,00 €**

**Season: 2026 Exotic** . (for charters up to max 3 guests, one person works as a skipper and cook) + provisioning, Crew on board must have their own toilets/ showers. If either a skipper or a hostess/cook is on board, 1 double cabin will be required for him/her. If both a skipper and a hostess/cook are on board, 1 double cabin and 1 forepeak cabin will be required for them. Exceptions exists for specific layouts, Sales Agents will provide more details about the different boat models

**Skipper+Cook** (Payable now)

No

per day + food

**220,00 €**

**Season: 2026 Exotic** . (for charters up to max 3 guests, one person works as a skipper and cook) + provisioning, Crew on board must have their own toilets/ showers. If either a skipper or a hostess/cook is on board, 1 double cabin will be required for him/her. If both a skipper and a hostess/cook are on board, 1 double cabin and 1 forepeak cabin will be required for them. Exceptions exists for specific layouts, Sales Agents will provide more details about the different boat models

**Skipper+Cook** (Payable now)

No

per day + food

**245,00 €**

**Season: 2026 Exotic** . (for charters up to max 3 guests, one person works as a skipper and cook) + provisioning, Crew on board must have their own toilets/ showers. If either a skipper or a hostess/cook is on board, 1 double cabin will be required for him/her. If both a skipper and a hostess/cook are on board, 1 double cabin and 1 forepeak cabin will be required for them. Exceptions exists for specific layouts, Sales Agents will provide more details about the different boat models

**WI-FI Internet connection on boat** (Payable now)

No

per night

**12,00 €**

**Season: 2026 Exotic** . Unlimited GigaBytes included in the price

**WEBSITE**[www.plujeme.cz](http://www.plujeme.cz)**PHONE**

+420 720 755 085

**MOBILE**

+420 777 170 276

**E-MAIL**[info@plujeme.cz](mailto:info@plujeme.cz)**PLUJEME RÁDI S.R.O.**

Dlouhá 730/35, 11000 Praha 1 – Staré Město, Czech Republic

## ADDITIONAL EXTRAS

EXTRA	OBLIGATORY	PAYMENT TYPE	PRICE
<b>Extra bedlinen and towels</b> <i>(Payable now)</i> <b>Season: 2026 Exotic</b> . <i>Payable now</i>	No	per person	<b>20,00 €</b>
<b>Stand up paddle (SUP)</b> <i>(Payable now)</i> <b>Season: 2026 Exotic</b> . <i>Price per day - Payable now</i>	No	per night	<b>15,00 €</b>

**WEBSITE**

[www.plujeme.cz](http://www.plujeme.cz)

**E-MAIL**

[info@plujeme.cz](mailto:info@plujeme.cz)

**PHONE**

+420 720 755 085

**MOBILE**

+420 777 170 276

**PLUJEME RÁDI S.R.O.**

Dlouhá 730/35, 11000 Praha 1 – Staré Město, Czech Republic

## PRICE AND AVAILABILITY

25.04. - 02.05.2026 5.485 €	02.05. - 09.05.2026 5.915 €	09.05. - 16.05.2026 NOT AVAILABLE	16.05. - 13.06.2026 NOT AVAILABLE
13.06. - 20.06.2026 3.636 € 4.545 €	20.06. - 27.06.2026 3.636 € 4.545 €	27.06. - 04.07.2026 3.636 € 4.545 €	04.07. - 11.07.2026 3.612 € 4.515 €
11.07. - 18.07.2026 NOT AVAILABLE	20.07. - 27.07.2026 NOT AVAILABLE	05.08. - 19.08.2026 NOT AVAILABLE	24.08. - 31.08.2026 NOT AVAILABLE
05.09. - 26.09.2026 NOT AVAILABLE	26.09. - 03.10.2026 4.000 € 5.000 €	08.10. - 15.10.2026 NOT AVAILABLE	17.10. - 24.10.2026 7.290 €
24.10. - 31.10.2026 6.422 € 6.760 €	31.10. - 14.11.2026 NOT AVAILABLE	14.11. - 21.11.2026 7.125 € 7.500 €	21.11. - 28.11.2026 7.125 € 7.500 €
28.11. - 12.12.2026 NOT AVAILABLE			



**WEBSITE**  
[www.plujeme.cz](http://www.plujeme.cz)



**E-MAIL**  
[info@plujeme.cz](mailto:info@plujeme.cz)



**PHONE**  
+420 720 755 085



**PLUJEME RÁDI S.R.O.**  
Dlouhá 730/35, 11000 Praha 1 – Staré Město, Czech Republic



**MOBILE**  
+420 777 170 276

## PRICE AND AVAILABILITY

12.12. - 19.12.2026 <b>4.099 €</b> 4.315 €	19.12. - 26.12.2026 <b>5.710 €</b> 6.010 €	02.01. - 09.01.2027 <b>6.208 €</b> 6.535 €	09.01. - 16.01.2027 <b>5.201 €</b> 5.475 €
16.01. - 23.01.2027 <b>5.201 €</b> 5.475 €	23.01. - 30.01.2027 <b>5.201 €</b> 5.475 €	30.01. - 06.02.2027 <b>5.947 €</b> 6.260 €	06.02. - 13.02.2027 <b>6.693 €</b> 7.045 €
13.02. - 20.02.2027 <b>6.878 €</b> 7.240 €	20.02. - 27.02.2027 <b>7.063 €</b> 7.435 €	27.02. - 06.03.2027 <b>7.063 €</b> 7.435 €	06.03. - 13.03.2027 <b>7.429 €</b> 7.820 €
13.03. - 20.03.2027 <b>7.429 €</b> 7.820 €	20.03. - 27.03.2027 <b>7.429 €</b> 7.820 €	27.03. - 03.04.2027 <b>7.676 €</b> 8.080 €	03.04. - 10.04.2027 <b>7.676 €</b> 8.080 €
10.04. - 17.04.2027 <b>7.676 €</b> 8.080 €	17.04. - 24.04.2027 <b>7.676 €</b> 8.080 €	24.04. - 01.05.2027 <b>6.769 €</b> 7.125 €	01.05. - 08.05.2027 <b>5.472 €</b> 5.760 €
08.05. - 15.05.2027 <b>4.646 €</b> 4.890 €	15.05. - 22.05.2027 <b>4.646 €</b> 4.890 €	22.05. - 29.05.2027 <b>4.646 €</b> 4.890 €	29.05. - 05.06.2027 <b>4.403 €</b> 4.635 €
05.06. - 12.06.2027 <b>4.403 €</b> 4.635 €	12.06. - 19.06.2027 <b>4.403 €</b> 4.635 €	19.06. - 26.06.2027 <b>4.403 €</b> 4.635 €	26.06. - 03.07.2027 <b>4.403 €</b> 4.635 €
03.07. - 10.07.2027 <b>4.660 €</b> 4.905 €	10.07. - 17.07.2027 <b>4.660 €</b> 4.905 €	17.07. - 24.07.2027 <b>4.660 €</b> 4.905 €	24.07. - 31.07.2027 <b>4.660 €</b> 4.905 €
31.07. - 07.08.2027 <b>4.992 €</b> 5.255 €			



WEBSITE

[www.plujeme.cz](http://www.plujeme.cz)



E-MAIL

[info@plujeme.cz](mailto:info@plujeme.cz)



PHONE

+420 720 755 085



MOBILE

+420 777 170 276



PLUJEME RÁDI S.R.O.

Dlouhá 730/35, 11000 Praha 1 – Staré Město, Czech Republic

## PRICE AND AVAILABILITY

07.08. - 14.08.2027 <b>4.992 €</b> 5.255 €	14.08. - 21.08.2027 <b>4.660 €</b> 4.905 €	21.08. - 28.08.2027 <b>4.308 €</b> 4.535 €	28.08. - 04.09.2027 <b>4.308 €</b> 4.535 €
04.09. - 11.09.2027 <b>4.308 €</b> 4.535 €	11.09. - 18.09.2027 <b>4.308 €</b> 4.535 €	18.09. - 25.09.2027 <b>4.527 €</b> 4.765 €	25.09. - 02.10.2027 <b>4.750 €</b> 5.000 €
02.10. - 09.10.2027 <b>5.035 €</b> 5.300 €	09.10. - 16.10.2027 <b>5.339 €</b> 5.620 €	16.10. - 23.10.2027 <b>5.710 €</b> 6.010 €	23.10. - 30.10.2027 <b>6.156 €</b> 6.480 €
30.10. - 06.11.2027 <b>6.156 €</b> 6.480 €	06.11. - 13.11.2027 <b>6.156 €</b> 6.480 €	13.11. - 20.11.2027 <b>6.156 €</b> 6.480 €	20.11. - 27.11.2027 <b>6.156 €</b> 6.480 €
27.11. - 04.12.2027 <b>6.156 €</b> 6.480 €	04.12. - 11.12.2027 <b>4.304 €</b> 4.530 €	11.12. - 18.12.2027 <b>4.099 €</b> 4.315 €	18.12. - 25.12.2027 <b>5.710 €</b> 6.010 €



### WEBSITE

[www.plujeme.cz](http://www.plujeme.cz)



### E-MAIL

[info@plujeme.cz](mailto:info@plujeme.cz)



### PHONE

+420 720 755 085



### MOBILE

+420 777 170 276



### PLUJEME RÁDI S.R.O.

Dlouhá 730/35, 11000 Praha 1 – Staré Město, Czech Republic