

BALI 4.8

Esther (2023)

Catamaran Bali 4.8 Esther, built in 2023 is anchored in the Seychelles, Eden Island Marina, Mahé, Seychelles. It has 5 + 1 cabins, can accommodate 10 + 1 people and has 5 toilets. Bed linen and kitchen equipment are included in the price.

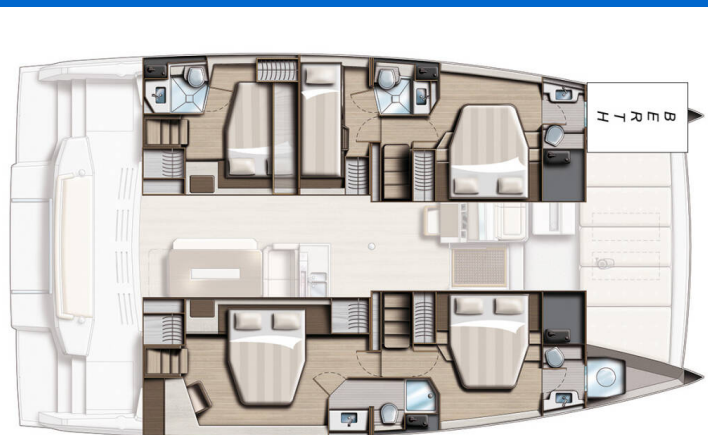

YACHT SPECIFICATIONS

Yacht Base

**Seychelles, Eden Island Marina,
Seychelles**

Yacht ID

4734

Brands

Catana

Yacht name

Esther

Production year

2023

Length

49 ft

Cabins

5 + 1

Berths

10 + 1

Max Persons

11

WC

5

Engine

2 x 57 HP

Fuel tank

1000 l



WEBSITE

www.plujeme.cz



PHONE

+420 720 755 085



MOBILE

+420 777 170 276



E-MAIL

info@plujeme.cz



PLUJEME RÁDI S.R.O.

Dlouhá 730/35, 11000 Praha 1 – Staré Město, Czech Republic

STANDARD YACHT EQUIPMENT

Comfort	Cockpit seat cushions with backrest
Deck	Bimini top, Cockpit fridge, Dinghy with outboard engine, Teak cockpit
Entertainment	Hi-Fi system, Indoor speakers, Outdoor speakers, Snorkeling equipment
Galley	Kitchen utensils (Galley equipment, cutlery), Oven, Refrigerator
Interior	Electric fans in cabins, Electric toilet, Indirect lighting in cabins and salon, Upholstery
Navigation	AIS, Autopilot, Binoculars, GPS chart plotter, Navigation set
Safety	VHF radio
Sails	Dacron square top main sail, Electric winch, Lazy bag, Lazy jacks
Yacht electrics	Air Conditioning, Batteries, Battery charger, Generator, Inverter, Service batteries, USB sockets, Watermaker - desalinator



WEBSITE

www.plujeme.cz



PHONE

+420 720 755 085



MOBILE

+420 777 170 276



E-MAIL

info@plujeme.cz



PLUJEME RÁDI S.R.O.

Dlouhá 730/35, 11000 Praha 1 – Staré Město, Czech Republic

SERVICES

SELECTED SERVICES	OBLIGATORY	PAYMENT TYPE	PRICE
Comfort Pack (Payable now) Season: 2026 Exotic . To be added upon client's price - OBLIGATORY - SEY Welcome package, final cleaning, bed sheets & towels, dinghy, outboard engine & fuel, propane gas, full water tanks, snorkelling equipment,WIFI with unlimited use. However, if the limit of 20GB per day is crossed, the internet speed is reduced for the rest of that day. Yacht Fuel is not included - the fuel tank will be full when your charter starts and you are responsible for topping off the fuel tank at the end of your charter. Security deposit is obligatory and is paid on spot in the base.	Yes	per booking	615,00 €
Handling fees (Payable now) Season: 2026 Exotic .	Yes	per booking	35,00 €
Preparation fee (Payable now) Season: 2026 Exotic . INCLUDED: Welcome pack // final cleaning // 1 set of bed sheets / cabin & 1 set of towels / pax, dinghy, outboard engine & initial supply of fuel, gas and water tanks // 1st & last night in the marina // NOT INCLUDED: refuelling, gas & water consumption at end of charter, taxes if any, handling fees & additional equipment deposit.	Yes	per booking	470,00 €
Tourist tax (Payable at the base) Season: 2026 Exotic . According to S.I. 52 of 2023 ENVIRONMENT PROTECTION ACT (ext. of Act 18 of 2016), a Seychelles compulsory tourist tax of 100SCR per person/day (or equivalent Currency as per daily rate is applied), payable at base. NOT applicable to citizens and residents of Seychelles, children of 12 years and below (visitors), and Navigare Yacht crew. (Price will be adjusted according to the crew list)	Yes	per guest/day	7,00 €
Cook (Payable now) Season: 2026 Exotic . +provisioning ; Crew on board must have their own toilets/ showers. If either a skipper or a hostess/cook is on board, 1 double cabin will be required for him/her. If both a skipper and a hostess/cook are on board, 1 double cabin and 1 forepeak cabin will be required for them. Exceptions exists for specific layouts, Sales Agents will provide more details about the different boat models. Cooking breakfast, lunch, 5 dinners a week, supply, keeping the kitchen clean (not the rest of the boat, not the cabins).	No	per day + food	185,00 €

<p>Cook (Payable now)</p> <p>Season: 2026 Exotic . +provisioning ; Crew on board must have their own toilets/ showers. If either a skipper or a hostess/cook is on board, 1 double cabin will be required for him/her. If both a skipper and a hostess/cook are on board, 1 double cabin and 1 forepeak cabin will be required for them. Exceptions exists for specific layouts, Sales Agents will provide more details about the different boat models. Cooking breakfast, lunch, 5 dinners a week, supply, keeping the kitchen clean (not the rest of the boat, not the cabins).</p>	No	per day + food	185,00 €
<p>Cook (Payable now)</p> <p>Season: 2026 Exotic . +provisioning ; Crew on board must have their own toilets/ showers. If either a skipper or a hostess/cook is on board, 1 double cabin will be required for him/her. If both a skipper and a hostess/cook are on board, 1 double cabin and 1 forepeak cabin will be required for them. Exceptions exists for specific layouts, Sales Agents will provide more details about the different boat models. Cooking breakfast, lunch, 5 dinners a week, supply, keeping the kitchen clean (not the rest of the boat, not the cabins).</p>	No	per day + food	205,00 €
<p>Damage waiver (Payable now)</p> <p>Season: 2026 Exotic . Damage waiver limits your liability to the reduced Security Deposit . Mandatory when skipper is added. Price is per night of the charter (minimum value of 7 nights & a maximum value of 21 nights) Not applicable for 4+ weeks charters , nor Regattas/Races.</p>	No	per night	80,00 €
<p>Extra cleaning (Payable now)</p> <p>Season: 2026 Exotic . Optional Additional cleaning</p>	No	per booking	340,00 €
<p>Extra set of linen (choose how many) (Payable now)</p> <p>Season: 2026 Exotic . Extra set of linen : 15 € 1 set of linen (2 sheets & 2 pillow case) - to be updated manually</p>	No	per booking	15,00 €
<p>Extra set of towels (choose how many) (Payable now)</p> <p>Season: 2026 Exotic . Extra set of towels: 10 € 1 set of towels (1 face & 1 bath towel) - to be updated manually</p>	No	per booking	10,00 €
<p>Full board 1-4 pax (number of guests to update manually) (Payable now)</p> <p>Season: 2026 Exotic . Only available if cook is booked on board as the cook will do the provisioning based on client's preference. Includes breakfast, lunch & dinner + the crew's food. Does not include fuel, alcoholic drinks, moorings park or landing fees.</p>	No	per guest/day	60,00 €

Full board 5-12 pax (number of guests to update manually) (Payable now) Season: 2026 Exotic . Only available if cook is booked on board as the cook will do the provisioning based on client's preference. Includes breakfast, lunch & dinner + the crew's food. Does not include fuel, alcoholic drinks, moorings park or landing fees.	No	per guest/day	55,00 €
Gritchen cancellation insurance (Payable now) Season: 2026 Exotic . with Covid coverage (4% of client's Total price)- European clients Only	No	per booking	0,00 €
Half board 1-4 pax (number of guests to update manually) (Payable now) Season: 2026 Exotic . only available if cook is booked on board as the cook will do the provisioning based on client's preference. Includes breakfast & lunch OR dinner + the crew's food. Does not included alcoholic drinks	No	per guest/day	50,00 €
Half board 5-12 pax (number of guests to update manually) (Payable now) Season: 2026 Exotic . only available if cook is booked on board as the cook will do the provisioning based on client's preference. Includes breakfast & lunch OR dinner + the crew's food. Does not included alcoholic drinks	No	per guest/day	45,00 €
Skipper (Payable now) Season: 2026 Exotic . +provisioning ; Crew on board must have their own toilets/ showers. If either a skipper or a hostess/cook is on board, 1 double cabin will be required for him/her. If both a skipper and a hostess/cook are on board, 1 double cabin and 1 forepeak cabin will be required for them. Exceptions exists for specific layouts, Sales Agents will provide more details about the different boat models. ***NOTE: Skipper details will be available 3 days before the charter.	No	per day + food	210,00 €
Skipper (Payable now) Season: 2026 Exotic . +provisioning ; Crew on board must have their own toilets/ showers. If either a skipper or a hostess/cook is on board, 1 double cabin will be required for him/her. If both a skipper and a hostess/cook are on board, 1 double cabin and 1 forepeak cabin will be required for them. Exceptions exists for specific layouts, Sales Agents will provide more details about the different boat models. ***NOTE: Skipper details will be available 3 days before the charter.	No	per day + food	210,00 €
Skipper (Payable now) Season: 2026 Exotic . +provisioning ; Crew on board must have their own toilets/ showers. If either a skipper or a hostess/cook is on board, 1 double cabin will be required for him/her. If both a skipper and a hostess/cook are on board, 1 double cabin and 1 forepeak cabin will be required for them. Exceptions exists for specific layouts, Sales Agents will provide more details about the different boat models. ***NOTE: Skipper details will be available 3 days before the charter.	No	per day + food	230,00 €

WI-FI Internet connection on boat (Payable now)

No

per night

12,00 €

Season: 2026 Exotic . Unlimited GigaBytes included in the price



WEBSITE

www.plujeme.cz



E-MAIL

info@plujeme.cz



PHONE

+420 720 755 085



MOBILE

+420 777 170 276



PLUJEME RÁDI S.R.O.

Dlouhá 730/35, 11000 Praha 1 – Staré Město, Czech Republic

ADDITIONAL EXTRAS

EXTRA	OBLIGATORY	PAYMENT TYPE	PRICE
Extra bedlinen and towels <i>(Payable now)</i> Season: 2026 Exotic . <i>Payable now</i>	No	per person	20,00 €
Stand up paddle (SUP) <i>(Payable now)</i> Season: 2026 Exotic . <i>Price per day - Payable now</i>	No	per night	15,00 €

**WEBSITE**

www.plujeme.cz

**E-MAIL**

info@plujeme.cz

**PHONE**

+420 720 755 085

**MOBILE**

+420 777 170 276

**PLUJEME RÁDI S.R.O.**

Dlouhá 730/35, 11000 Praha 1 – Staré Město, Czech Republic

PRICE AND AVAILABILITY

02.05. - 09.05.2026 11.805 €	09.05. - 16.05.2026 6.952 € 8.690 €	16.05. - 23.05.2026 7.640 € 9.550 €	24.05. - 29.05.2026 NOT AVAILABLE
01.06. - 08.06.2026 NOT AVAILABLE	11.06. - 21.06.2026 NOT AVAILABLE	24.06. - 28.06.2026 NOT AVAILABLE	03.07. - 17.07.2026 NOT AVAILABLE
18.07. - 25.07.2026 NOT AVAILABLE	25.07. - 01.08.2026 7.672 € 9.590 €	01.08. - 08.08.2026 8.208 € 10.260 €	08.08. - 15.08.2026 6.948 € 8.685 €
15.08. - 22.08.2026 7.060 € 8.825 €	22.08. - 29.08.2026 NOT AVAILABLE	29.08. - 05.09.2026 7.092 € 8.865 €	05.09. - 12.09.2026 NOT AVAILABLE
12.09. - 19.09.2026 NOT AVAILABLE	19.09. - 26.09.2026 NOT AVAILABLE	26.09. - 03.10.2026 NOT AVAILABLE	07.10. - 17.10.2026 NOT AVAILABLE
17.10. - 24.10.2026 11.740 €	24.10. - 31.10.2026 NOT AVAILABLE	31.10. - 07.11.2026 NOT AVAILABLE	07.11. - 14.11.2026 NOT AVAILABLE
14.11. - 21.11.2026 NOT AVAILABLE	21.11. - 28.11.2026 12.027 € 12.660 €	28.11. - 05.12.2026 10.825 € 11.395 €	



WEBSITE

www.plujeme.cz



E-MAIL

info@plujeme.cz



PHONE

+420 720 755 085



MOBILE

+420 777 170 276



PLUJEME RÁDI S.R.O.

Dlouhá 730/35, 11000 Praha 1 – Staré Město, Czech Republic

PRICE AND AVAILABILITY

05.12. - 12.12.2026 8.379 € 8.820 €	12.12. - 19.12.2026 7.595 € 7.995 €	19.12. - 26.12.2026 11.148 € 11.735 €	02.01. - 09.01.2027 12.117 € 12.755 €
09.01. - 16.01.2027 10.151 € 10.685 €	16.01. - 23.01.2027 10.151 € 10.685 €	23.01. - 30.01.2027 10.151 € 10.685 €	30.01. - 06.02.2027 ON OPTION
06.02. - 13.02.2027 13.072 € 13.760 €	13.02. - 20.02.2027 13.433 € 14.140 €	20.02. - 27.02.2027 13.799 € 14.525 €	05.03. - 15.03.2027 NOT AVAILABLE
20.03. - 27.03.2027 14.507 € 15.270 €	27.03. - 03.04.2027 14.986 € 15.775 €	03.04. - 10.04.2027 14.986 € 15.775 €	10.04. - 17.04.2027 14.986 € 15.775 €
17.04. - 24.04.2027 14.986 € 15.775 €	24.04. - 01.05.2027 13.210 € 13.905 €	01.05. - 08.05.2027 10.683 € 11.245 €	08.05. - 15.05.2027 9.073 € 9.550 €
15.05. - 22.05.2027 9.073 € 9.550 €	22.05. - 29.05.2027 9.073 € 9.550 €	29.05. - 05.06.2027 8.607 € 9.060 €	05.06. - 12.06.2027 8.607 € 9.060 €
12.06. - 19.06.2027 8.607 € 9.060 €	19.06. - 26.06.2027 8.607 € 9.060 €	26.06. - 03.07.2027 8.607 € 9.060 €	03.07. - 10.07.2027 9.111 € 9.590 €
10.07. - 17.07.2027 9.111 € 9.590 €	17.07. - 24.07.2027 9.111 € 9.590 €	24.07. - 31.07.2027 9.111 € 9.590 €	31.07. - 07.08.2027 9.747 € 10.260 €



WEBSITE

www.plujeme.cz



E-MAIL

info@plujeme.cz



PHONE

+420 720 755 085



MOBILE

+420 777 170 276



PLUJEME RÁDI S.R.O.

Dlouhá 730/35, 11000 Praha 1 – Staré Město, Czech Republic

PRICE AND AVAILABILITY

07.08. - 14.08.2027 9.747 € 10.260 €	14.08. - 21.08.2027 9.111 € 9.590 €	21.08. - 28.08.2027 8.422 € 8.865 €	28.08. - 04.09.2027 8.422 € 8.865 €
04.09. - 11.09.2027 8.422 € 8.865 €	11.09. - 18.09.2027 8.422 € 8.865 €	18.09. - 25.09.2027 8.835 € 9.300 €	25.09. - 02.10.2027 9.277 € 9.765 €
02.10. - 09.10.2027 9.837 € 10.355 €	09.10. - 16.10.2027 10.426 € 10.975 €	16.10. - 23.10.2027 11.153 € 11.740 €	23.10. - 04.11.2027 NOT AVAILABLE
06.11. - 13.11.2027 12.027 € 12.660 €	13.11. - 20.11.2027 12.027 € 12.660 €	20.11. - 27.11.2027 12.027 € 12.660 €	27.11. - 04.12.2027 12.027 € 12.660 €
04.12. - 11.12.2027 7.980 € 8.400 €	11.12. - 18.12.2027 7.595 € 7.995 €	18.12. - 25.12.2027 11.148 € 11.735 €	



WEBSITE

www.plujeme.cz



E-MAIL

info@plujeme.cz



PHONE

+420 720 755 085



MOBILE

+420 777 170 276



PLUJEME RÁDI S.R.O.

Dlouhá 730/35, 11000 Praha 1 – Staré Město, Czech Republic