

FONTAINE PAJOT ASTREA 42

Nostos (2021)

Catamaran **Fountaine Pajot Astrea 42 Nostos**, built in **2021** is anchored in the **Lefkas main port, Ionian Islands, Greece**. It has **4 + 2 cabins**, can accommodate **8 + 2 people** and has **4 + 1 toilets**. Bed linen and kitchen equipment are included in the price.

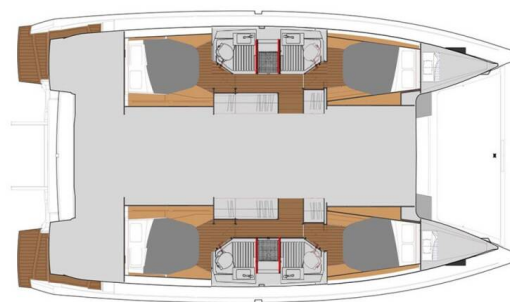

YACHT SPECIFICATIONS

Yacht Base

Lefkas main port, Greece

Yacht ID

4721

Brands

Fountaine Pajot

Yacht name

Nostos

Production year

2021

Length

41 ft

Cabins

4 + 2

Berths

8 + 2

Max Persons

12

WC

4 + 1

Engine

2 x 50 HP

Fuel tank

470 l



WEBSITE

www.plujeme.cz



PHONE

+420 720 755 085



MOBILE

+420 777 170 276



E-MAIL

info@plujeme.cz



PLUJEME RÁDI S.R.O.

Dlouhá 730/35, 11000 Praha 1 – Staré Město, Czech Republic

STANDARD YACHT EQUIPMENT

Comfort	Cockpit cushions
Deck	Bilge pump - Mechanic, Bimini top, Black ball, Boat hook, Bosun's chair (Safe seat) (boatswain's chair), Cockpit table, Cockpit/stern, outside shower, Deck brush, Dinghy, Dinghy (byboat) pump, Electric anchor windlass, Fenders, Fuel funnel, Impeller, V-belt, oilfilter, Jerry cans for diesel, Mooring ropes, Plastic bucket, Repair box for dinghy, Spare anchor (Reserve, Auxiliary anchor), Sprayhood, Swimming ladder, Teak cockpit, Winch handles
Entertainment	Outdoor speakers, Radio CD player, Underwater lights
Galley	Gas bottles, Kitchen utensils (Galley equipment, cutlery), Oven, Stove
Interior	Bilge pump handle, Clock, Convertible table in salon, Electric fans
Navigation	Autopilot, Binoculars, Compass, Divider, nautic chart, GPS chart plotter, GPS chart plotter - cockpit, Hand bearing compass, Nautical charts, Parallel ruler, Pilot book, Radar reflector, Speedometer (Speed log), Wind instrument/Anemometer
Safety	Distress flare box, Emergency tiller, EPIRB-Distress radio beacons, Fire extinguisher, First aid kit, Fog horn, Horseshoe lifebuoy, Life belts (Safety harness), Life jackets, Liferaft, Oars (Paddles), Set of tools, Torch
Sails	Lazy bag, Lazy jacks
Yacht electrics	Air Conditioning, Generator, Pump, Solar panels, Watermaker - desalinator



WEBSITE

www.plujeme.cz



PHONE

+420 720 755 085



MOBILE

+420 777 170 276



E-MAIL

info@plujeme.cz



PLUJEME RÁDI S.R.O.

Dlouhá 730/35, 11000 Praha 1 – Staré Město, Czech Republic

SERVICES

SELECTED SERVICES	OBLIGATORY	PAYMENT TYPE	PRICE
Charter package (Payable at the base) Season: 2026. End Cleaning, Outboard Engine, Dinghy, 1x set of Bed Linen & Bath Towels/person, 1x bottle of local wine, sparkling water, 1 bottle of Gas, local Greek nuts & marmalade, bathroom amenities, rubbish bags, welcome card.	Yes	per booking	400,00 €
Cook (Payable at the base) Season: 2026. Paid on spot in cash. Food provided by clients or to be paid an extra 30€/day. Cook must have his own cabin and access to one of the toilets.	No	per day + food	210,00 €
Crew change (Payable at the base) Season: 2026. Crew change includes administration fee, change of bed linen & towels and one night at Ionian Catamarans' pontoon. It doesn't include end cleaning.	No	per crew change	100,00 €
Damage waiver (Payable at the base) Season: 2026. non refundable; + 750,00EUR refundable; Damage waiver is obligatory on Skippered charters. Payable on spot in cash. Minimum charge is 7 days.	No	per week	490,00 €
Early Check in (Payable at the base) Season: 2026. embarkation starting by 2PM	No	per booking	180,00 €
Hostess (Payable at the base) Season: 2026. Food provided by clients or to be paid an extra 30€/day. Hostess Duties: Taking care of deck works, skipper assistance, cleaning of common areas, i.e. saloon, galley, prepare breakfast and a light lunch daily; Paid on spot in cash + food provisioning on client's burden. Hostess must have her own cabin and access to one of the toilets.	No	per day + food	190,00 €
Provisioning (Payable at the base) Season: 2026. order form will be forwarded upon request. Please fill it in and email it back to us, at least 3 days before embarkation. Upon your arrival your food and drinks will be onboard	No	per booking	0,00 €
Skipper (Payable at the base) Season: 2026. Paid on spot in cash. Food provided by clients or to be paid an extra 30€/day. Skipper must have his own cabin and access to one of the toilets. Damage waiver is obligatory on skippered charters.	No	per day + food	210,00 €

Starter pack (Payable at the base)

No

per booking

70,00 €

Season: 2026. dishwash liquid, sponge, rubbish bags, matches, toilet & kitchen rolls, fruit plate, water, orange juice, wine, packet of biscuits, individual sachets of tea, coffee, sugar, milk.

WI-FI Internet connection on boat (Payable at the base)

No

per week

70,00 €

Season: 2026. 10GB, on request



WEBSITE

www.plujeme.cz



PHONE

+420 720 755 085



MOBILE

+420 777 170 276



E-MAIL

info@plujeme.cz



PLUJEME RÁDI S.R.O.

Dlouhá 730/35, 11000 Praha 1 – Staré Město, Czech Republic

ADDITIONAL EXTRAS

EXTRA	OBLIGATORY	PAYMENT TYPE	PRICE
Extra bedlinen (Payable at the base) Season: 2026. Payable at the base	No	per set	15,00 €
Extra towels (Payable at the base) Season: 2026. Payable at the base	No	per piece	10,00 €
Fishing cane/rod (Payable at the base) Season: 2026. Payable at the base	No	per week	80,00 €
Grill/Barbecue/Plancha (Payable at the base) Season: 2026. electric - Payable at the base	No	per week	80,00 €
Grill/Barbecue/Plancha (Payable at the base) Season: 2026. small - Payable at the base	No	per week	100,00 €
Grill/Barbecue/Plancha (Payable at the base) Season: 2026. big - Payable at the base	No	per week	120,00 €
Kayak (Payable at the base) Season: 2026. Payable at the base	No	per week	100,00 €
Railing net (Safety net) (Payable at the base) Season: 2026. just provided, not installed! - Payable at the base	No	per booking	240,00 €
Sea Scooter (Payable at the base) Season: 2026. + extra security deposit Euro 750 (refundable) - Payable at the base	No	per week	320,00 €
Stand up paddle (SUP) (Payable at the base) Season: 2026. Payable at the base	No	per week	120,00 €



WEBSITE
www.plujeme.cz



PHONE
+420 720 755 085



MOBILE
+420 777 170 276



E-MAIL
info@plujeme.cz



PLUJEME RÁDI S.R.O.
Dlouhá 730/35, 11000 Praha 1 - Staré Město, Czech Republic

PRICE AND AVAILABILITY

25.04. - 02.05.2026 2.563 € 4.100 €	02.05. - 09.05.2026 2.563 € 4.100 €	09.05. - 16.05.2026 2.563 € 4.100 €	16.05. - 23.05.2026 2.563 € 4.100 €
23.05. - 30.05.2026 4.000 € 6.400 €	30.05. - 06.06.2026 NOT AVAILABLE	06.06. - 13.06.2026 NOT AVAILABLE	13.06. - 20.06.2026 NOT AVAILABLE
20.06. - 27.06.2026 NOT AVAILABLE	27.06. - 04.07.2026 NOT AVAILABLE	04.07. - 11.07.2026 NOT AVAILABLE	11.07. - 18.07.2026 NOT AVAILABLE
18.07. - 25.07.2026 ON OPTION	25.07. - 01.08.2026 NOT AVAILABLE	01.08. - 08.08.2026 NOT AVAILABLE	08.08. - 15.08.2026 NOT AVAILABLE
15.08. - 22.08.2026 NOT AVAILABLE	22.08. - 29.08.2026 NOT AVAILABLE	29.08. - 19.09.2026 NOT AVAILABLE	19.09. - 26.09.2026 NOT AVAILABLE
26.09. - 03.10.2026 NOT AVAILABLE	03.10. - 10.10.2026 NOT AVAILABLE	10.10. - 17.10.2026 3.840 € 4.800 €	17.10. - 24.10.2026 3.200 € 4.000 €
24.10. - 31.10.2026 3.200 € 4.000 €	31.10. - 07.11.2026 3.200 € 4.000 €	07.11. - 14.11.2026 3.200 € 4.000 €	14.11. - 21.11.2026 3.200 € 4.000 €
21.11. - 28.11.2026 3.200 € 4.000 €	28.11. - 05.12.2026 3.200 € 4.000 €		



WEBSITE

www.plujeme.cz



E-MAIL

info@plujeme.cz



PHONE

+420 720 755 085



MOBILE

+420 777 170 276



PLUJEME RÁDI S.R.O.

Dlouhá 730/35, 11000 Praha 1 – Staré Město, Czech Republic

PRICE AND AVAILABILITY

05.12. - 12.12.2026

3.200 € 4.000 €

12.12. - 19.12.2026

3.200 € 4.000 €

19.12. - 26.12.2026

3.200 € 4.000 €



WEBSITE

www.plujeme.cz



E-MAIL

info@plujeme.cz



PHONE

+420 720 755 085



MOBILE

+420 777 170 276



PLUJEME RÁDI S.R.O.

Dlouhá 730/35, 11000 Praha 1 – Staré Město, Czech Republic