

BALI CATSPACE OW

KATITUDE (2023)

Catamaran Bali Catspace OW KATITUDE, built in 2023 is anchored in the **BVI, Hodge's Creek Marina, British Virgin Islands, British Virgin Islands**. It has **3 cabins**, can accommodate **6 + 1 people** and has **3 toilets**. Bed linen and kitchen equipment are included in the price.

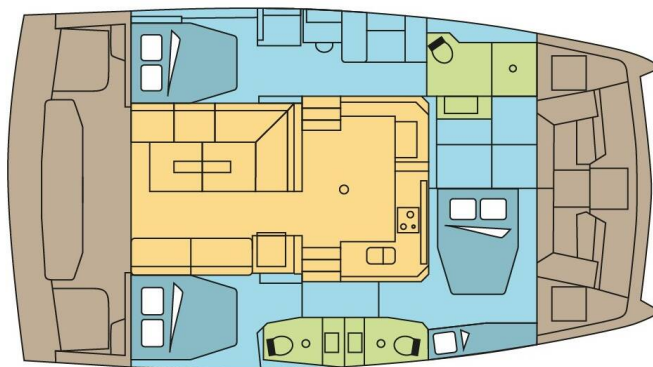

YACHT SPECIFICATIONS

Yacht Base

BVI, Hodge's Creek Marina, British Virgin Islands

Yacht ID

4718

Brands

Catana

Yacht name

KATITUDE

Production year

2023

Length

40 ft

Cabins

3

Berths

6 + 1

Max Persons

7

WC

3

Engine

2 x 40 HP

Fuel tank

400 l



WEBSITE

www.plujeme.cz



PHONE

+420 720 755 085



MOBILE

+420 777 170 276



E-MAIL

info@plujeme.cz



PLUJEME RÁDI S.R.O.

Dlouhá 730/35, 11000 Praha 1 – Staré Město, Czech Republic

STANDARD YACHT EQUIPMENT

Comfort	Cockpit cushions, Deck cushions, Mosquito nets
Deck	Bimini top, Cockpit table, Cockpit/stern, outside shower, Davit, Dinghy, Electric anchor windlass, Flybridge, Grill/Barbecue/Plancha, Outboard engine, Remote control for anchor winch with chain counter at helm, Spring cleats, Swimming ladder
Entertainment	Fusion radio
Galley	Freezer, Oven, Water pump
Interior	Curtains, Electric fans in cabins, Electric toilet
Navigation	AIS, Autopilot, Depthsounder, GPS chart plotter, Wind instrument/Anemometer
Safety	Extra water tank, Safety equipment, VHF radio
Sails	Electric winch, Lazy bag, Lazy jacks
Yacht electrics	Air Conditioning, Battery charger, Generator, Inverter, Salon portside electrical opening window, Service batteries, Solar panels, Watermaker - desalinator



WEBSITE

www.plujeme.cz



PHONE

+420 720 755 085



MOBILE

+420 777 170 276



E-MAIL

info@plujeme.cz



PLUJEME RÁDI S.R.O.

Dlouhá 730/35, 11000 Praha 1 – Staré Město, Czech Republic

SERVICES

SELECTED SERVICES	OBLIGATORY	PAYMENT TYPE	PRICE
BVI Cruising Tax (Payable at the base) Season: 2026 Exotic. Payment in cash only	Yes	per guest/day	3,64 €
Essentials pack (Payable now) Season: 2026 Exotic. INCLUDED: Damage waiver (covering damages) with reduced security deposit addressed specifically to blocked toilets, unpaid fuel, lost equipment, unpaid fees & fines, and returning the boat in an extremely dirty state. // starter pack – (1 gallon water or 4 bottles of 1.5L, 1 bottle of disinfectant, 1 small bottle of washing up liquid, 1 dish cloth, 1 sponge, garbage bags, 1 roll of paper towels, 1 box of matches, 1 roll of toilet paper in each head) // final cleaning // 1 set of bed sheets & towels, dinghy, outboard engine & initial supply of fuel, gas and water tanks // DYC assistance guarantee // 1st & last night in the marina /// NOT INCLUDED: refuelling, gas & water consumption at end of charter, taxes if any, handling fees & additional equipment deposit.	Yes	per booking	810,00 €
Handling fees (Payable now) Season: 2026 Exotic.	Yes	per booking	35,00 €
National parks permit (Payable at the base) Season: 2026 Exotic. US \$ 25.-/boat/week/up to 4 persons US \$ 35.- /boat/week/up to 6 persons US \$ 45.-/boat/week/up to 8 persons US \$ 55.- /boat/week/up to 10 persons US \$ 5.-/week for any additional person Payment in cash only / Foreign based boats pay twice those amounts All above taxes and fees are payable on spot and subject to change without notice	Yes	per week	0,00 €
Preparation fee (Payable now) Season: 2026 Exotic. INCLUDED: starter pack – (1 gallon water or 4 bottles of 1.5L, 1 bottle of disinfectant, 1 small bottle of washing up liquid, 1 dish cloth, 1 sponge, garbage bags, 1 roll of paper towels, 1 box of matches, 1 roll of toilet paper in each head) // final cleaning // 1 set of bed sheets / cabin & 1 set of towels / pax, dinghy, outboard engine & initial supply of fuel, gas and water tanks // DYC assistance guarantee // 1st & last night in the marina // NOT INCLUDED: refuelling, gas & water consumption at end of charter, taxes if any, handling fees & additional equipment deposit.	Yes	per booking	415,00 €
Search & Sea rescue (Payable at the base) Season: 2026 Exotic. 5 US \$ per person / Payment in cash only	Yes	per person	4,55 €

Charge for last minute change (Payable at the base)	No	per booking	80,00 €
Season: 2026 Exotic. Any last minute change 3 days or less of passenger information will be charged: 80 € per booking			
Crew change (Payable now)	No	per booking	250,00 €
Season: 2026 Exotic. Any crew change during the charter is subject to € 250.- additional cost. The charge includes administration cost, change of bed linen and towels and one night at DYC ponton (marina fee included only if the same base than start base). It doesn't include cleaning, nor new transit log where applicable.			
Damage waiver (Payable now)	No	per night	70,00 €
Season: 2026 Exotic. Damage waiver limits your liability to the reduced Security Deposit . Mandatory when skipper is added. Price is per night of the charter (minimum value of 7 nights & a maximum value of 21 nights) Not applicable for 4+ weeks charters , nor Regattas/Races.			
Early boarding/check-in (Payable now)	No	per booking	520,00 €
Season: 2026 Exotic. EB (boat only) - 14:00 h / 2 PM starting time of boat's delivery // limited number of early boardings on same departure day			
Early boarding/check-in (Payable now)	No	per booking	790,00 €
Season: 2026 Exotic. EB boat + extra fee skipper - 14:00 h / 2 PM starting time of boat's delivery // limited number of early boardings on same departure day			
Early boarding/check-in (Payable now)	No	per booking	1.020,00 €
Season: 2026 Exotic. EB + extra fee Skipper & Hostes - 14:00 h / 2 PM starting time of boat's delivery // limited number of early boardings on same departure day			
Electric & Water consumption in the Marinas (Payable at the base)	No	per booking	28,00 €
Season: 2026 Exotic. Electric & Water consumption based on 2 nights on our dock (base will confirm the amount to pay locally depending on nights spent on dock)			
Extra cleaning (Payable now)	No	per booking	285,00 €
Season: 2026 Exotic. Optional Additional cleaning			
Extra set of linen (choose how many) (Payable now)	No	per booking	15,00 €
Season: 2026 Exotic. Extra set of linen : 15 € 1 set of linen (2 sheets & 2 pillow case) - to be updated manually			
Extra set of towels (choose how many) (Payable now)	No	per booking	10,00 €
Season: 2026 Exotic. Extra set of towels: 10 € 1 set of towels (1 face & 1 bath towel) - to be updated manually			

Final cleaning (Payable now) Season: 2026 Exotic. <i>included in Essentials pack</i>	No	per booking	285,00 €
Final cleaning (Payable now) Season: 2026 Exotic. <i>included in Essentials pack</i>	No	per booking	285,00 €
Full board 1-4 pax (number of guests to update manually) (Payable now) Season: 2026 Exotic. <i>only available if cook is booked on board as the cook will do the provisioning based on client's preference. Includes breakfast, lunch & dinner + the crew's food. Does not included alcoholic drinks</i>	No	per guest/day	75,00 €
Full board 5-12 pax (number of guests to update manually) (Payable now) Season: 2026 Exotic. <i>only available if cook is booked on board as the cook will do the provisioning based on client's preference. Includes breakfast, lunch & dinner + the crew's food. Does not included alcoholic drinks</i>	No	per guest/day	70,00 €
Half board 1-4 pax (number of guests to update manually) (Payable now) Season: 2026 Exotic. <i>only available if cook is booked on board as the cook will do the provisioning based on client's preference. Includes breakfast & lunch OR dinner + the crew's food. Does not included alcoholic drinks</i>	No	per guest/day	60,00 €
Half board 5-12 pax (number of guests to update manually) (Payable now) Season: 2026 Exotic. <i>only available if cook is booked on board as the cook will do the provisioning based on client's preference. Includes breakfast & lunch OR dinner + the crew's food. Does not included alcoholic drinks</i>	No	per guest/day	55,00 €
Hostess/Cook (Payable now) Season: 2026 Exotic. <i>+ provisioning, Crew on board must have their own toilets/ showers. If either a skipper or a hostess/cook is on board, 1 double cabin will be required for him/her. If both a skipper and a hostess/cook are on board, 1 double cabin and 1 forepeak cabin will be required for them. Exceptions exists for specific layouts, Sales Agents will provide more details about the different boat models</i>	No	per night	230,00 €
Hostess/Cook (Payable now) Season: 2026 Exotic. <i>+ provisioning, Crew on board must have their own toilets/ showers. If either a skipper or a hostess/cook is on board, 1 double cabin will be required for him/her. If both a skipper and a hostess/cook are on board, 1 double cabin and 1 forepeak cabin will be required for them. Exceptions exists for specific layouts, Sales Agents will provide more details about the different boat models</i>	No	per night	230,00 €

<p>Hostess/Cook (Payable now)</p> <p>Season: 2026 Exotic. + provisioning, Crew on board must have their own toilets/ showers. If either a skipper or a hostess/cook is on board, 1 double cabin will be required for him/her. If both a skipper and a hostess/cook are on board, 1 double cabin and 1 forepeak cabin will be required for them. Exceptions exists for specific layouts, Sales Agents will provide more details about the different boat models</p>	No	per night	255,00 €
<p>Hostess/Cook (Payable now)</p> <p>Season: 2026 Exotic. + provisioning, Crew on board must have their own toilets/ showers. If either a skipper or a hostess/cook is on board, 1 double cabin will be required for him/her. If both a skipper and a hostess/cook are on board, 1 double cabin and 1 forepeak cabin will be required for them. Exceptions exists for specific layouts, Sales Agents will provide more details about the different boat models</p>	No	per night	230,00 €
<p>Hostess/Cook (Payable now)</p> <p>Season: 2026 Exotic. + provisioning, Crew on board must have their own toilets/ showers. If either a skipper or a hostess/cook is on board, 1 double cabin will be required for him/her. If both a skipper and a hostess/cook are on board, 1 double cabin and 1 forepeak cabin will be required for them. Exceptions exists for specific layouts, Sales Agents will provide more details about the different boat models</p>	No	per night	255,00 €
<p>Race pack (Payable now)</p> <p>Season: 2026 Exotic. BVI Spring Regatta, Briefing before the race, preparation and gauging of sails, registration of th eyacht (not of the passengers), technical assistance during the race *** technical assistance during the race not valid for RORC Caribbean 600 // A special race deposit need to be doubled manually once the race fee is added.</p>	No	per booking	1.320,00 €
<p>Race pack (Payable now)</p> <p>Season: 2026 Exotic. Antigua, Briefing before the race, preparation and gauging of sails, registration of th eyacht (not of the passengers), technical assistance during the race *** technical assistance during the race not valid for RORC Caribbean 600 // A special race deposit need to be doubled manually once the race fee is added.</p>	No	per booking	1.650,00 €
<p>Race pack (Payable now)</p> <p>Season: 2026 Exotic. RORC caribbean 600, Briefing before the race, preparation and gauging of sails, registration of th eyacht (not of the passengers), technical assistance during the race *** technical assistance during the race not valid for RORC Caribbean 600 // A special race deposit need to be doubled manually once the race fee is added.</p>	No	per booking	1.650,00 €

Regatta surcharge (Payable now)	No	per booking	1.850,00 €
Season: 2026 Exotic. valid for ASW regatta only // A special race deposit need to be doubled manually once the regatta surcharge is added.			
Regatta surcharge (Payable now)	No	per booking	0,00 €
Season: 2026 Exotic. all the regattas apart of ASW (different regatta surcharge for ASW) // A special race deposit need to be doubled manually once the regatta surcharge is added.			
Same day briefing (Payable now)	No	per booking	150,00 €
Season: 2026 Exotic. Same day briefing starting between 5 & 5.30pm (departure following morning)			
Skipper (Payable now)	No	per night	270,00 €
Season: 2026 Exotic. + provisioning, Crew on board must have their own toilets/ showers. If either a skipper or a hostess/cook is on board, 1 double cabin will be required for him/her. If both a skipper and a hostess/cook are on board, 1 double cabin and 1 forepeak cabin will be required for them. Exceptions exists for specific layouts, Sales Agents will provide more details about the different boat models			
Skipper (Payable now)	No	per night	270,00 €
Season: 2026 Exotic. + provisioning, Crew on board must have their own toilets/ showers. If either a skipper or a hostess/cook is on board, 1 double cabin will be required for him/her. If both a skipper and a hostess/cook are on board, 1 double cabin and 1 forepeak cabin will be required for them. Exceptions exists for specific layouts, Sales Agents will provide more details about the different boat models			
Skipper (Payable now)	No	per night	295,00 €
Season: 2026 Exotic. + provisioning, Crew on board must have their own toilets/ showers. If either a skipper or a hostess/cook is on board, 1 double cabin will be required for him/her. If both a skipper and a hostess/cook are on board, 1 double cabin and 1 forepeak cabin will be required for them. Exceptions exists for specific layouts, Sales Agents will provide more details about the different boat models			
Skipper (Payable now)	No	per night	270,00 €
Season: 2026 Exotic. + provisioning, Crew on board must have their own toilets/ showers. If either a skipper or a hostess/cook is on board, 1 double cabin will be required for him/her. If both a skipper and a hostess/cook are on board, 1 double cabin and 1 forepeak cabin will be required for them. Exceptions exists for specific layouts, Sales Agents will provide more details about the different boat models			

Skipper (Payable now)	No	per night	295,00 €
Season: 2026 Exotic. + provisioning, Crew on board must have their own toilets/ showers. If either a skipper or a hostess/cook is on board, 1 double cabin will be required for him/her. If both a skipper and a hostess/cook are on board, 1 double cabin and 1 forepeak cabin will be required for them. Exceptions exists for specific layouts, Sales Agents will provide more details about the different boat models			
Starter pack (Payable now)	No	per booking	50,00 €
Season: 2026 Exotic. included in Essentials pack (The pack includes: 1 gallon water (or 4 bottles of 1.5L), 1 bottle of disinfectant, 1 small bottle of washing up liquid, 1 dish cloth, 1 sponge, garbage bags, 1 roll of paper towels, 1 box of matches, 1 roll of toilet paper in each head			
Transfer (Payable now)	No	one-way	14,55 €
Season: 2026 Exotic. OW - each additional pax from Road Town ferry or Tortola airport			
Transfer (Payable now)	No	round trip	29,09 €
Season: 2026 Exotic. RT - each additional pax from Road Town ferry or Tortola airport			
Transfer (Payable now)	No	one-way	29,09 €
Season: 2026 Exotic. OW - 1-2pax from Road Town ferry or Tortola airport.			
Transfer (Payable now)	No	round trip	58,18 €
Season: 2026 Exotic. RT - 1-2pax from Road Town ferry or Tortola airport.			



WEBSITE
www.plujeme.cz



PHONE
+420 720 755 085



MOBILE
+420 777 170 276



E-MAIL
info@plujeme.cz



PLUJEME RÁDI S.R.O.
Dlouhá 730/35, 11000 Praha 1 – Staré Město, Czech Republic

ADDITIONAL EXTRAS

EXTRA	OBLIGATORY	PAYMENT TYPE	PRICE
Kayak single (Payable now) Season: 2026 Exotic. price per day - Payable now	No	per night	15,00 €
Kayak tandem (Payable now) Season: 2026 Exotic. price per day - Payable now	No	per night	15,00 €
Outboard engine 8 & 9,8 HP (Payable now) Season: 2026 Exotic. Dinghy not suitable in any case for waterski or wakeboard. Additional security deposit of 500 € on outboard engines. - Payable now	No	per day	35,00 €
Railing net (Safety net) (Payable now) Season: 2026 Exotic. net is supplied but not installed - Payable now	No	per booking	250,00 €
Stand up paddle (SUP) (Payable now) Season: 2026 Exotic. Price per day - Payable now	No	per night	15,00 €

**WEBSITE**www.plujeme.cz**E-MAIL**info@plujeme.cz**PHONE**

+420 720 755 085

**MOBILE**

+420 777 170 276

**PLUJEME RÁDI S.R.O.**

Dlouhá 730/35, 11000 Praha 1 – Staré Město, Czech Republic

PRICE AND AVAILABILITY

24.04. - 02.05.2026 NOT AVAILABLE	02.05. - 09.05.2026 3.864 € 4.830 €	09.05. - 16.05.2026 NOT AVAILABLE	18.05. - 05.06.2026 NOT AVAILABLE
06.06. - 13.06.2026 3.712 € 4.640 €	13.06. - 20.06.2026 ON OPTION	20.06. - 27.06.2026 3.460 € 4.325 €	27.06. - 04.07.2026 3.440 € 4.300 €
04.07. - 11.07.2026 3.348 € 4.185 €	12.07. - 19.07.2026 NOT AVAILABLE	25.07. - 01.08.2026 3.557 € 4.185 €	04.08. - 09.10.2026 NOT AVAILABLE
10.10. - 17.10.2026 4.025 €	17.10. - 24.10.2026 4.025 €	24.10. - 31.10.2026 3.824 € 4.025 €	31.10. - 07.11.2026 3.824 € 4.025 €
07.11. - 14.11.2026 4.099 € 4.315 €	14.11. - 21.11.2026 4.099 € 4.315 €	21.11. - 28.11.2026 4.926 € 5.185 €	30.11. - 12.12.2026 NOT AVAILABLE



WEBSITE

www.plujeme.cz



E-MAIL

info@plujeme.cz



PHONE

+420 720 755 085



MOBILE

+420 777 170 276



PLUJEME RÁDI S.R.O.

Dlouhá 730/35, 11000 Praha 1 – Staré Město, Czech Republic

PRICE AND AVAILABILITY

12.12. - 19.12.2026 3.662 € 3.855 €	19.12. - 26.12.2026 4.926 € 5.185 €	02.01. - 09.01.2027 5.387 € 5.670 €	09.01. - 16.01.2027 5.387 € 5.670 €
19.01. - 29.01.2027 NOT AVAILABLE	30.01. - 06.02.2027 6.237 € 6.565 €	06.02. - 13.02.2027 6.603 € 6.950 €	13.02. - 20.02.2027 NOT AVAILABLE
20.02. - 27.02.2027 6.603 € 6.950 €	27.02. - 06.03.2027 6.603 € 6.950 €	06.03. - 13.03.2027 7.106 € 7.480 €	13.03. - 20.03.2027 7.106 € 7.480 €
20.03. - 27.03.2027 7.106 € 7.480 €	27.03. - 03.04.2027 6.588 € 6.935 €	03.04. - 10.04.2027 6.588 € 6.935 €	10.04. - 17.04.2027 6.265 € 6.595 €
17.04. - 24.04.2027 5.885 € 6.195 €	24.04. - 01.05.2027 5.482 € 5.770 €	01.05. - 08.05.2027 5.135 € 5.405 €	08.05. - 15.05.2027 5.135 € 5.405 €
15.05. - 22.05.2027 5.135 € 5.405 €	26.05. - 09.06.2027 NOT AVAILABLE	12.06. - 19.06.2027 4.418 € 4.650 €	19.06. - 26.06.2027 4.418 € 4.650 €
26.06. - 03.07.2027 4.641 € 4.885 €	03.07. - 10.07.2027 4.418 € 4.650 €	10.07. - 17.07.2027 4.418 € 4.650 €	17.07. - 24.07.2027 4.418 € 4.650 €
24.07. - 31.07.2027 4.418 € 4.650 €	31.07. - 07.08.2027 4.204 € 4.425 €		



WEBSITE

www.plujeme.cz



E-MAIL

info@plujeme.cz



PHONE

+420 720 755 085



MOBILE

+420 777 170 276



PLUJEME RÁDI S.R.O.

Dlouhá 730/35, 11000 Praha 1 – Staré Město, Czech Republic

PRICE AND AVAILABILITY

07.08. - 14.08.2027 3.824 € 4.025 €	14.08. - 21.08.2027 3.824 € 4.025 €	21.08. - 28.08.2027 3.824 € 4.025 €	28.08. - 04.09.2027 3.824 € 4.025 €
04.09. - 11.09.2027 3.824 € 4.025 €	11.09. - 18.09.2027 3.824 € 4.025 €	18.09. - 25.09.2027 3.824 € 4.025 €	25.09. - 02.10.2027 3.824 € 4.025 €
02.10. - 09.10.2027 3.824 € 4.025 €	09.10. - 16.10.2027 3.824 € 4.025 €	16.10. - 23.10.2027 3.824 € 4.025 €	23.10. - 30.10.2027 3.824 € 4.025 €
30.10. - 06.11.2027 3.824 € 4.025 €	06.11. - 13.11.2027 4.099 € 4.315 €	13.11. - 20.11.2027 4.099 € 4.315 €	20.11. - 27.11.2027 4.926 € 5.185 €
27.11. - 04.12.2027 3.895 € 4.100 €	04.12. - 11.12.2027 3.662 € 3.855 €	11.12. - 18.12.2027 3.662 € 3.855 €	18.12. - 25.12.2027 4.926 € 5.185 €



WEBSITE

www.plujeme.cz



E-MAIL

info@plujeme.cz



PHONE

+420 720 755 085



MOBILE

+420 777 170 276



PLUJEME RÁDI S.R.O.

Dlouhá 730/35, 11000 Praha 1 – Staré Město, Czech Republic