

# LAGOON 50

Silhouette (2022)

Catamaran Lagoon 50 Silhouette, built in 2022 is anchored in the Athens, Alimos marina, Athens area/Saronic/Peloponese, Greece. It has 6 + 2 cabins, can accommodate 12 people and has 4 + 2 toilets. Bed linen and kitchen equipment are included in the price.

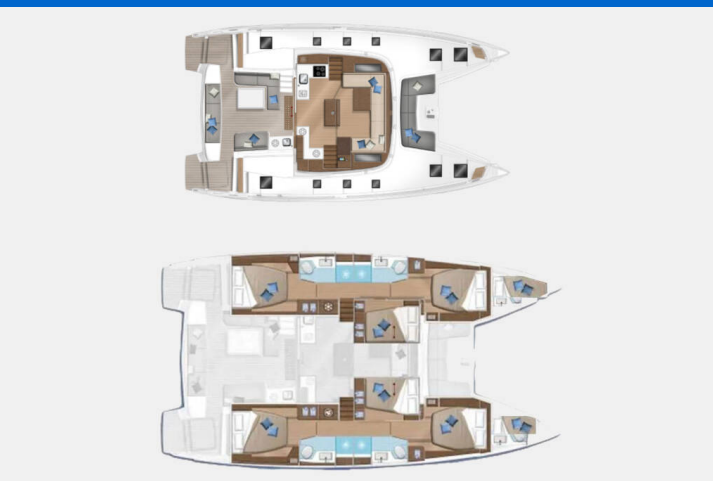

## YACHT SPECIFICATIONS

Yacht Base

**Athens, Alimos marina, Greece**

Yacht ID

**4540**

Brands

**Lagoon**

Yacht name

**Silhouette**

Production year

**2022**

Length

**48 ft**

Cabins

**6 + 2**

Berths

**12**

Max Persons

**12**

WC

**4 + 2**

Engine

**2 x 80 HP**

Fuel tank

**1040 l**



**WEBSITE**

[www.plujeme.cz](http://www.plujeme.cz)



**PHONE**

+420 720 755 085



**MOBILE**

+420 777 170 276



**E-MAIL**

[info@plujeme.cz](mailto:info@plujeme.cz)



**PLUJEME RÁDI S.R.O.**

Dlouhá 730/35, 11000 Praha 1 – Staré Město, Czech Republic

## STANDARD YACHT EQUIPMENT

Comfort	<b>Blankets, Pillows</b>
Deck	<b>Bimini top, Electric anchor windlass, Hydraulic gangway, Main anchor, Outboard engine, Sprayhood, Teak deck</b>
Entertainment	<b>Bluetooth player, Outdoor speakers, Radio CD player, TV</b>
Galley	<b>Hot water, Ice maker, Microwave, Oven, Refrigerator</b>
Interior	<b>Electric toilet</b>
Navigation	<b>Autopilot, GPS, GPS chart plotter, Navigation (Nautical) charts and nautical guide, Speedometer (Speed log)</b>
Safety	<b>First aid kit, VHF radio</b>
Sails	<b>Electric halyard winch, Lazy jacks</b>
Yacht electrics	<b>Air Conditioning, Batteries, Generator, Inverter, Solar panels, USB sockets, Watermaker - desalinator</b>



**WEBSITE**

[www.plujeme.cz](http://www.plujeme.cz)



**E-MAIL**

[info@plujeme.cz](mailto:info@plujeme.cz)



**PHONE**

+420 720 755 085



**MOBILE**

+420 777 170 276



**PLUJEME RÁDI S.R.O.**

Dlouhá 730/35, 11000 Praha 1 – Staré Město, Czech Republic

## SERVICES

SELECTED SERVICES	OBLIGATORY	PAYMENT TYPE	PRICE
<b>Generator</b> (Payable at the base) <b>Season: 2026.</b> Option 1 - Free of charge 8 hours per day, any additional hour comes with a cost of 10 euros per hour. Option 2 - Unlimited use for 200 euros per week. Payable on the spot with cash.	Yes	per hour	<b>0,00 €</b>
<b>Skipper</b> (Payable at the base) <b>Season: 2026.</b> (Crew require their own cabin); Payable on the spot with cash Crew Cancellation Policy A Down payment of 25% is required upon confirmation, and the rest are payable on the spot with cash. Crew cancelled 4 weeks prior to embarkation will have 25% of total crew fee applicable. Crew cancelled less than 14 days prior to embarkation will have 100% of the total crew fee applicable. Damage waiver is obligatory for skippered charters.	Yes	per day + food	<b>210,00 €</b>
<b>Starter pack</b> (Payable at the base) <b>Season: 2026.</b> End cleaning, 1x Cooking gas, Water, Linen 1 set (2 sheets, 1 pillow case, 1 bath towel, 1 face towel) per person, Harbour fees for the first & last night. * If there is pet on board, then double cleaning will be applied.; Payable on the spot with cash 🎁 bag with Greek Local Products is offered to all of our charters as a welcome gift.	Yes	per booking	<b>500,00 €</b>
<b>Cook</b> (Payable at the base) <b>Season: 2026.</b> (Crew require their own cabin); Only responsible for daily cooking / provisioning and cleaning relevant to kitchen area; Payable on the spot with cash; Crew Cancellation Policy A Down payment of 25% is required upon confirmation, and the rest are payable on the spot with cash. Crew cancelled 4 weeks prior to embarkation will have 25% of total crew fee applicable. Crew cancelled less than 14 days prior to embarkation will have 100% of the total crew fee applicable.	No	per day + food	<b>200,00 €</b>
<b>Crew change</b> (Payable at the base) <b>Season: 2026.</b> Payable on the spot with cash Applicable only at one of our bases: Included : Formalities (contract, crew list, etc.) and one day of mooring fees. Not included: Yachts cleaning and laundry.	No	per booking	<b>150,00 €</b>
<b>Early boarding/check-in</b> (Payable at the base) <b>Season: 2026.</b> Access to the yacht by 14:00 In the event of delay beyond our control refunds will be made.; Payable on the spot with cash	No	per booking	<b>200,00 €</b>

<b>Hostess</b> (Payable at the base)	No	per day + food	<b>190,00 €</b>
<b>Season: 2026.</b> *crew require their own cabin; Payable on the spot with cash Crew Cancellation Policy A Down payment of 25% is required upon confirmation, and the rest are payable on the spot with cash. Crew cancelled 4 weeks prior to embarkation will have 25% of total crew fee applicable. Crew cancelled less than 14 days prior to embarkation will have 100% of the total crew fee applicable.			
<b>Internet pack</b> (Payable at the base)	No	per booking	<b>70,00 €</b>
<b>Season: 2026.</b> +20 € per week after the 1st (WiFi hotspot for up to 5 devices and unlimited usage of internet); Payable on the spot with cash			
<b>Linen Pack</b> (Payable at the base)	No	per set	<b>10,00 €</b>
<b>Season: 2026.</b> 1 Extra set of linen (2 sheets, 1 pillow case, 1 bath towel, 1 face towel); Payable on the spot with cash			
<b>Non refundable deposit/ insurance</b> (Payable at the base)	No	per booking	<b>400,00 €</b>
<b>Season: 2026.</b> + refundable deposit 1000 EUR; non refundable payable on spot in cash and refundable payable by credit card on spot * Non-Refundable Deposit is mandatory on all skippered charters.			
<b>Welcome package</b> (Payable at the base)	No	per booking	<b>70,00 €</b>
<b>Season: 2026.</b> Toilet and Kitchen rolls, matches, Plastic bags for rubbish, 1 Dish Sponge, 1 Dish, Soap, Sugar, Salt and Pepper, Coffee, 6 bottles of Water, 1 bottle of wine, 6 cans of Coke, 6 cans of Beer, Milk, Orange Juice; Payable on the spot with cash			



**WEBSITE**

[www.plujeme.cz](http://www.plujeme.cz)



**PHONE**

+420 720 755 085



**MOBILE**

+420 777 170 276



**E-MAIL**

[info@plujeme.cz](mailto:info@plujeme.cz)



**PLUJEME RÁDI S.R.O.**

Dlouhá 730/35, 11000 Praha 1 – Staré Město, Czech Republic

## ADDITIONAL EXTRAS

EXTRA	OBLIGATORY	PAYMENT TYPE	PRICE
<b>Automatic Inflatable Life Jacket</b> (Payable at the base) <b>Season: 2026.</b> Payable on the spot with cash - Payable at the base	No	per piece	<b>30,00 €</b>
<b>Beach towel</b> (Payable at the base) <b>Season: 2026.</b> Payable on the spot with cash - Payable at the base	No	per piece	<b>5,00 €</b>
<b>Bed linen</b> (Payable at the base) <b>Season: 2026.</b> Payable on the spot with cash - Payable at the base	No	per set	<b>10,00 €</b>
<b>Blister</b> (Payable at the base) <b>Season: 2026.</b> + additional security deposit 500EUR; Payable on the spot with cash - Payable at the base	No	per week	<b>200,00 €</b>
<b>Electric outboard engine</b> (Payable at the base) <b>Season: 2026.</b> 3 HP; Subject to availability, payable on the spot with cash - Payable at the base	No	per week	<b>110,00 €</b>
<b>Grill/Barbecue/Plancha</b> (Payable at the base) <b>Season: 2026.</b> Gas - Payable at the base	No	per week	<b>100,00 €</b>
<b>Kayak</b> (Payable at the base) <b>Season: 2026.</b> Payable on the spot with cash - Payable at the base	No	per week	<b>130,00 €</b>
<b>Life jacket (children)</b> (Payable at the base) <b>Season: 2026.</b> for children under 25 kg, one included in every yacht free of charge; Payable on the spot with cash - Payable at the base	No	per week/ person	<b>20,00 €</b>
<b>Railing net (Safety net)</b> (Payable at the base) <b>Season: 2026.</b> 200 € for yachts up to 46 ft., 300 € per week for yachts above 46ft & catamarans (Half price if the railing net is supplied uninstalled). Payable on the spot with cash - Payable at the base	No	per week	<b>300,00 €</b>
<b>SEA-D00 underwater scooter</b> (Payable at the base) <b>Season: 2026.</b> Payable on the spot with cash - Payable at the base	No	per week	<b>150,00 €</b>
<b>Snorkeling equipment</b> (Payable at the base) <b>Season: 2026.</b> The set contains mask, inhalator and flippers; Payable on the spot with cash - Payable at the base	No	per week/ person	<b>10,00 €</b>

**Stand up paddle (SUP)** (Payable at the base)

No

per week

**130,00 €**

**Season: 2026.** Payable on the spot with cash - Payable at the base



**WEBSITE**

[www.plujeme.cz](http://www.plujeme.cz)



**E-MAIL**

[info@plujeme.cz](mailto:info@plujeme.cz)



**PHONE**

+420 720 755 085



**MOBILE**

+420 777 170 276



**PLUJEME RÁDI S.R.O.**

Dlouhá 730/35, 11000 Praha 1 – Staré Město, Czech Republic

## PRICE AND AVAILABILITY

25.04. - 02.05.2026 8.900 € 11.100 €	02.05. - 09.05.2026 NOT AVAILABLE	09.05. - 16.05.2026 8.900 € 11.100 €	16.05. - 23.05.2026 8.900 € 14.200 €
23.05. - 30.05.2026 NOT AVAILABLE	30.05. - 06.06.2026 11.500 € 14.200 €	06.06. - 13.06.2026 NOT AVAILABLE	13.06. - 20.06.2026 11.500 € 15.900 €
20.06. - 27.06.2026 13.000 € 15.900 €	27.06. - 04.07.2026 NOT AVAILABLE	04.07. - 11.07.2026 13.000 € 15.900 €	11.07. - 18.07.2026 NOT AVAILABLE
18.07. - 25.07.2026 NOT AVAILABLE	25.07. - 08.08.2026 NOT AVAILABLE	08.08. - 15.08.2026 NOT AVAILABLE	15.08. - 22.08.2026 13.000 € 15.900 €
22.08. - 29.08.2026 NOT AVAILABLE	29.08. - 05.09.2026 NOT AVAILABLE	05.09. - 12.09.2026 NOT AVAILABLE	12.09. - 19.09.2026 11.400 € 14.200 €
19.09. - 26.09.2026 11.400 € 14.200 €	26.09. - 03.10.2026 NOT AVAILABLE	03.10. - 10.10.2026 8.900 € 9.500 €	10.10. - 17.10.2026 6.400 € 9.500 €
17.10. - 24.10.2026 6.400 € 9.500 €	24.10. - 31.10.2026 NOT AVAILABLE	31.10. - 07.11.2026 6.400 € 9.500 €	07.11. - 14.11.2026 6.400 € 9.500 €
14.11. - 21.11.2026 9.500 €	21.11. - 28.11.2026 9.500 €	28.11. - 03.04.2027 NOT AVAILABLE	



WEBSITE

[www.plujeme.cz](http://www.plujeme.cz)



E-MAIL

[info@plujeme.cz](mailto:info@plujeme.cz)



PHONE

+420 720 755 085



MOBILE

+420 777 170 276



PLUJEME RÁDI S.R.O.

Dlouhá 730/35, 11000 Praha 1 – Staré Město, Czech Republic

## PRICE AND AVAILABILITY

03.04. - 10.04.2027 9.500 €	10.04. - 17.04.2027 9.500 €	17.04. - 24.04.2027 11.100 €	24.04. - 01.05.2027 11.100 €
01.05. - 08.05.2027 11.100 €	08.05. - 15.05.2027 11.100 €	15.05. - 22.05.2027 14.200 €	22.05. - 29.05.2027 14.200 €
29.05. - 05.06.2027 14.200 €	05.06. - 12.06.2027 14.200 €	12.06. - 19.06.2027 15.900 €	19.06. - 26.06.2027 15.900 €
26.06. - 03.07.2027 15.900 €	03.07. - 10.07.2027 15.900 €	10.07. - 17.07.2027 15.900 €	17.07. - 24.07.2027 15.900 €
24.07. - 31.07.2027 18.000 €	31.07. - 07.08.2027 18.000 €		



### WEBSITE

[www.plujeme.cz](http://www.plujeme.cz)



### E-MAIL

[info@plujeme.cz](mailto:info@plujeme.cz)



### PHONE

+420 720 755 085



### MOBILE

+420 777 170 276



### PLUJEME RÁDI S.R.O.

Dlouhá 730/35, 11000 Praha 1 – Staré Město, Czech Republic

## PRICE AND AVAILABILITY

07.08. - 14.08.2027 18.000 €	14.08. - 21.08.2027 15.900 €	21.08. - 28.08.2027 15.900 €	28.08. - 04.09.2027 15.900 €
04.09. - 11.09.2027 15.900 €	11.09. - 18.09.2027 14.200 €	18.09. - 25.09.2027 14.200 €	25.09. - 02.10.2027 11.100 €
02.10. - 09.10.2027 9.500 €	09.10. - 16.10.2027 9.500 €	16.10. - 23.10.2027 9.500 €	23.10. - 30.10.2027 9.500 €
30.10. - 06.11.2027 9.500 €	06.11. - 13.11.2027 9.500 €	13.11. - 20.11.2027 9.500 €	20.11. - 27.11.2027 9.500 €
27.11. - 04.12.2027 9.500 €	04.12. - 11.12.2027 9.500 €	11.12. - 18.12.2027 9.500 €	18.12. - 25.12.2027 9.500 €



### WEBSITE

[www.plujeme.cz](http://www.plujeme.cz)



### E-MAIL

[info@plujeme.cz](mailto:info@plujeme.cz)



### PHONE

+420 720 755 085



### MOBILE

+420 777 170 276



### PLUJEME RÁDI S.R.O.

Dlouhá 730/35, 11000 Praha 1 – Staré Město, Czech Republic