

LAGOON 40

Didoo (2022)

Catamaran Lagoon 40 Didoo, built in 2022 is anchored in the Corfu, Gouvia Marina, Ionian Islands, Greece. It has 4 + 2 cabins, can accommodate 8 + 2 people and has 4 toilets. Bed linen and kitchen equipment are included in the price.

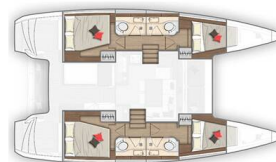

YACHT SPECIFICATIONS

Yacht Base

Corfu, Gouvia Marina, Greece

Yacht ID

4457

Brands

Lagoon

Yacht name

Didoo

Production year

2022

Length

39 ft

Cabins

4 + 2

Berths

8 + 2

Max Persons

10

WC

4

Engine

2 x 45 HP

Fuel tank

400 l



WEBSITE

www.plujeme.cz



PHONE

+420 720 755 085



MOBILE

+420 777 170 276



E-MAIL

info@plujeme.cz



PLUJEME RÁDI S.R.O.

Dlouhá 730/35, 11000 Praha 1 – Staré Město, Czech Republic

STANDARD YACHT EQUIPMENT

Comfort	Cockpit cushions
Deck	Anchor, Bimini top, Cockpit/stern, outside shower, Deck brush, Dinghy, Electric anchor windlass, Fenders, Plastic bucket, Sprayhood
Entertainment	Fusion radio, Outdoor speakers, USB
Galley	Freezer, Hot water, Kitchen utensils (Galley equipment, cutlery), Oven, Refrigerator, Stove
Interior	Inside shower
Navigation	Autopilot, Compass, GPS, GPS chart plotter, Logge/Lot/Speed, Nautical charts, Navigation set, Wind instrument/Anemometer
Safety	Black Water Tank, Fire extinguisher, First aid kit, Flashlight, Safety equipment, Set of tools, VHF radio
Sails	Lazy bag, Lazy jacks
Yacht electrics	Solar panels



WEBSITE

www.plujeme.cz



PHONE

+420 720 755 085



MOBILE

+420 777 170 276



E-MAIL

info@plujeme.cz



PLUJEME RÁDI S.R.O.

Dlouhá 730/35, 11000 Praha 1 – Staré Město, Czech Republic

SERVICES

SELECTED SERVICES	OBLIGATORY	PAYMENT TYPE	PRICE
Damage waiver (Payable at the base) Season: 2026. + Refundable Security Deposit: 1000,00eur About your Damage Waiver: If you're sailing with us for more than a week, the extra waiver cost for each additional week is 50% of the standard rate. The damage waiver is excluded from racing activities. Therefore, the full security deposit is required for these bookings. For Skipped charters the Damage waiver is 350,00eur If the yacht is returned in perfect condition, we'll give you a reward credit voucher for your next charter! - Reward Bonus: 150,00eur - This is just for you (non-transferable). - It's valid until the end of the year (31/12) and can be used for a trip this year or the next.	Yes	per booking	380,00 €
Service Pack (Payable at the base) Season: 2026. includes: final cleaning, water / 1x cooking gas bottle at the departure, batteries, linen equipment (towels included) for each crew member	Yes	per booking	335,00 €
Cook (Payable at the base) Season: 2026. Cook's meals are not included and are covered by the customer. 25% charge applicable if cook service is cancelled less than 4 weeks before departure.	No	per day + food	210,00 €
Drinks pack (Payable at the base) Season: 2026. Drinks Upgrade Pack: Gin (small bottle),Rum (small bottle),Mixers: tonic water, cola, soda water, lemon-lime soft drink ,Freshlemons/limes for garnish,Ice (on request / for first night only)	No	per booking	60,00 €
Early Check in (Payable at the base) Season: 2026. Embarkation at 13:00h option is subject to the condition that the yacht returns without damages from the previous charter	No	per booking	300,00 €
Harbour and marine fee (Payable at the base) Season: 2026. for the first and the last charter-night	No	per booking	0,00 €
Hostess (Payable at the base) Season: 2026. Hostess' meals are not included and are covered by the customer. Crew Cancellations: If canceled less than 30 days prior to departure: 50% of crew services fee is due.	No	per day + food	180,00 €

Kids fun pack (Payable at the base) Season: 2026. Chocolate spread, Fruit juice boxes, Small bottled water, Breakfast cereal (cornflakes or choco pops), Cookies or cereal bars, Fresh fruit (bananas, apples, grapes), Small pack of cheese sticks or babybel-type cheese	No	per booking	35,00 €
Ready to go Pack (Payable at the base) Season: 2026. Toilet paper, Kitchen rolls, Garbage bags (pack), Dish-washing liquid, Sponge, Matches, Sugar, Coffee, Tea, Orange juice, Milk, Cookies, Wine (1 bottle), Water, Fresh fruit, Bread, Butter, Jam, Honey, Beers, Cold cuts, Cheese selection, Yogurt, Fresh vegetables, Eggs, Chips, Crackers, Nuts, Sparkling water, Soft drinks, Extra wine, Breakfast cereal or muesli, Salt & Pepper, Olive oil, Pasta & canned tomato sauce, Small bottle of local ouzo/tsipouro	No	per booking	100,00 €
Skipper (Payable at the base) Season: 2026. Skipper's meals are not included and are covered by the customer. 25% charge applicable if skipper service is cancelled less than 4 weeks before departure.	No	per day	210,00 €
Sunday Check-in (Payable at the base) Season: 2026. additional fee of 150 euros will apply for check-in or check-out on Sundays at our Corfu base.	No	per booking	150,00 €
Sunday Check-out (Payable at the base) Season: 2026. additional fee of 150 euros will apply for check-in or check-out on Sundays at our Corfu base.	No	per booking	150,00 €
Welcome package (Payable at the base) Season: 2026. Toilet paper (per WC), Kitchen rolls (1), Garbage bags (per bin), Dishwashing liquid, Sponge, Sugar, Coffee, Tea, Orange juice, Milk, Cookies, Wine (1 bottle), Water (2-4 bottles)	No	per booking	60,00 €
WI-FI Internet connection on boat (Payable at the base) Season: 2026. unlimited	No	per week	80,00 €



WEBSITE
www.plujeme.cz



PHONE
+420 720 755 085



MOBILE
+420 777 170 276



E-MAIL
info@plujeme.cz



PLUJEME RÁDI S.R.O.
Dlouhá 730/35, 11000 Praha 1 – Staré Město, Czech Republic

ADDITIONAL EXTRAS

EXTRA	OBLIGATORY	PAYMENT TYPE	PRICE
Extra bedlinen (Payable at the base) Season: 2026. Payable at the base	No	per person	15,00 €
Outboard engine (Payable at the base) Season: 2026. Payable at the base	No	per week	100,00 €
Railing net (Safety net) (Payable at the base) Season: 2026. upon availability - Payable at the base	No	per booking	150,00 €
Spinnaker (Payable at the base) Season: 2026. asymmetrical; on request, not available for all yachts & bases. Not available in: Mykonos, Skiathos, Volos, Avdira, Paros. - Payable at the base	No	per week	200,00 €
Stand up paddle (SUP) (Payable at the base) Season: 2026. + 300 EUR security deposit inflatable SUP - Payable at the base	No	per week	130,00 €



WEBSITE

www.plujeme.cz



E-MAIL

info@plujeme.cz



PHONE

+420 720 755 085



MOBILE

+420 777 170 276



PLUJEME RÁDI S.R.O.

Dlouhá 730/35, 11000 Praha 1 – Staré Město, Czech Republic

PRICE AND AVAILABILITY

25.04. - 02.05.2026 4.134 € 5.512 €	02.05. - 09.05.2026 4.134 € 5.512 €	09.05. - 16.05.2026 4.685 € 5.512 €	16.05. - 23.05.2026 4.685 € 5.512 €
23.05. - 30.05.2026 6.002 € 7.061 €	30.05. - 06.06.2026 6.002 € 7.061 €	06.06. - 13.06.2026 6.002 € 7.061 €	13.06. - 20.06.2026 6.676 € 7.854 €
20.06. - 27.06.2026 ON OPTION	27.06. - 04.07.2026 ON OPTION	04.07. - 11.07.2026 NOT AVAILABLE	16.07. - 23.07.2026 NOT AVAILABLE
25.07. - 01.08.2026 NOT AVAILABLE	01.08. - 08.08.2026 NOT AVAILABLE	08.08. - 22.08.2026 NOT AVAILABLE	22.08. - 29.08.2026 ON OPTION
29.08. - 05.09.2026 ON OPTION	05.09. - 12.09.2026 ON OPTION	12.09. - 19.09.2026 NOT AVAILABLE	19.09. - 26.09.2026 6.355 € 7.061 €
26.09. - 03.10.2026 NOT AVAILABLE	03.10. - 10.10.2026 4.588 € 5.098 €	10.10. - 17.10.2026 4.588 € 5.098 €	17.10. - 24.10.2026 4.588 € 5.098 €
24.10. - 31.10.2026 4.588 € 5.098 €	31.10. - 07.11.2026 4.333 € 5.098 €	07.11. - 14.11.2026 4.333 € 5.098 €	14.11. - 21.11.2026 4.333 € 5.098 €
21.11. - 28.11.2026 4.333 € 5.098 €	30.11. - 30.12.2026 NOT AVAILABLE		



WEBSITE
www.plujeme.cz



E-MAIL
info@plujeme.cz



PHONE
+420 720 755 085



MOBILE
+420 777 170 276



PLUJEME RÁDI S.R.O.
Dlouhá 730/35, 11000 Praha 1 – Staré Město, Czech Republic