

NAUTITECH 40 OPEN

Rosa (2015)

Catamaran Nautitech 40 Open Rosa, built in 2015 is anchored in the Trogir, Marina Trogir (ex.SCT), Split region, Croatia. It has 4 + 2 cabins, can accommodate 8 + 2 people and has 2 toilets. Bed linen and kitchen equipment are included in the price.



original picture

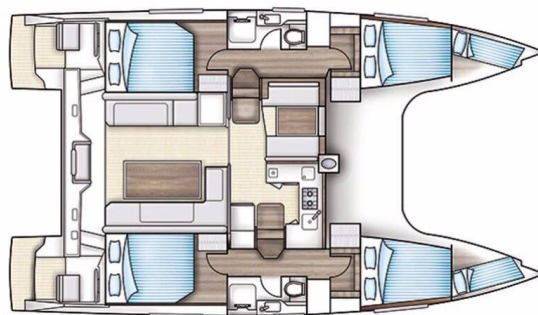

YACHT SPECIFICATIONS

Yacht Base

**Trogir, Marina Trogir (ex.SCT),
Croatia**

Yacht ID

436

Brands

Nautitech

Yacht name

Rosa

Production year

2015

Length

39 ft

Cabins

4 + 2

Berths

8 + 2

Max Persons

10

WC

2

Engine

2 x 30 HP

Fuel tank

430 l



WEBSITE

www.plujeme.cz



PHONE

+420 720 755 085



MOBILE

+420 777 170 276



E-MAIL

info@plujeme.cz



PLUJEME RÁDI S.R.O.

Dlouhá 730/35, 11000 Praha 1 – Staré Město, Czech Republic

STANDARD YACHT EQUIPMENT

Comfort	Bed linen, Cockpit cushions
Deck	Anchor line, Anchor swivel, Bimini top, Black ball, Black conus, Boat hook, Bosun's chair (Safe seat) (boatswain's chair), Canister for water, Chairs, Cockpit full tent, Cockpit table with light, Cockpit/stern, outside shower, Dinghy, Dinghy (byboat) pump, Electric anchor windlass, Fenders, Gangway, Hawser, Impeller, V-belt, oilfilter, Jerry cans for diesel, Main anchor, Mooring ropes, Plastic bucket, Repair box for dinghy, Round/globular fender, Spare anchor (Reserve, Auxiliary anchor), Spotlight / Headlights, Spring line, Teak cockpit, Water hose
Entertainment	Outdoor speakers, Radio
Galley	Gas bottles, Hot water, Kitchen utensils (Galley equipment, cutlery), Refrigerator
Interior	Barometer, Clock, Electric fans in cabins, Inside shower
Navigation	3 blade folding propeller, AIS, Autopilot, Binoculars, Bretonplotter, Composite steering wheels, GPS chart plotter - cockpit, Hand bearing compass, Harbour guides, Logge/Lot/Speed/Wind, Navigation (Nautical) charts and nautical guide, Navigation set, Parallel ruler, Radar, Radar reflector, Spyglass with bearing compass, Tridata
Safety	Distress signals, Fire extinguisher, First aid kit, Flashlight, Fog horn, Life belts (Safety harness), Life buoy + Flashing light, Liferaft, Self inflating life vest, Set of tools, VHF radio, Wire (shroud) cutter
Sails	Electric genoa winch, Electric halyard winch, Electric winch, Gennaker-device, Lazy bag, Lazy jacks
Yacht electrics	Batteries, Battery charger, Battery storage system, Generator, Heating, Inverter, Shore connection 220 V, Solar panels



WEBSITE

www.plujeme.cz



PHONE

+420 720 755 085



MOBILE

+420 777 170 276



E-MAIL

info@plujeme.cz



PLUJEME RÁDI S.R.O.

Dlouhá 730/35, 11000 Praha 1 – Staré Město, Czech Republic

SERVICES

SELECTED SERVICES	OBLIGATORY	PAYMENT TYPE	PRICE
Charter package (Payable at the base) Season: 2026. incl. Permit, outboard engine, Wi-Fi Internet (5 GB), bed linen (1 set/ person)	Yes	per booking	490,00 €
Early afternoon boarding/check-in (Payable at the base) Season: 2026. -> 2.00 pm – 4.00 pm, max. 5 yachts	No	per booking	75,00 €
Early boarding/check-in (Payable at the base) Season: 2026. -> 12.30 pm – 2.00 pm, max 5 yachts	No	per booking	200,00 €
Extra cleaning (Payable at the base) Season: 2026.	No	per booking	200,00 €
Hostess (Payable at the base) Season: 2026. + own cabin; external service provider, direct billing	No	per day + food	200,00 €
Pet on board (Payable at the base) Season: 2026.	No	per pet	200,00 €
Regatta charge (Payable at the base) Season: 2026. ON REQUEST	No	per booking	0,00 €
Skipper (Payable at the base) Season: 2026. + own cabin; external service provider	No	per day + food	200,00 €
WI-FI Internet connection on boat (Payable at the base) Season: 2026. unlimited / depending on the network reception (5 GB are included in the Charter package)	No	per week	30,00 €

**WEBSITE**www.plujeme.cz**E-MAIL**info@plujeme.cz**PHONE**

+420 720 755 085

**MOBILE**

+420 777 170 276

**PLUJEME RÁDÍ S.R.O.**

Dlouhá 730/35, 11000 Praha 1 – Staré Město, Czech Republic

ADDITIONAL EXTRAS

EXTRA	OBLIGATORY	PAYMENT TYPE	PRICE
<p>Dinghy with outboard engine (Payable at the base)</p> <p>Season: 2026. Highfield 340 CL + 15 PS outboard engine + € 1.300 deposit - Payable at the base</p>	No	per week	500,00 €
<p>Extra bedlinen (Payable at the base)</p> <p>Season: 2026. 1 set/ person is included in the charter package - Payable at the base</p>	No	per set	10,00 €
<p>Glass bottom dinghy (Payable at the base)</p> <p>Season: 2026. Formentera 270 PC + approx. 3 HP ePropulsion engine, max. 3 persons, in 8,5 h fully loaded with 12 V - Payable at the base</p>	No	per week	220,00 €
<p>Grill/Barbecue/Plancha (Payable at the base)</p> <p>Season: 2026. Payable at the base</p>	No	per booking	65,00 €
<p>Ice box (Payable at the base)</p> <p>Season: 2026. Mobile Cooler Box (no power connection): approx. 52L, limited availability, For drinks and ice only. Box must be returned clean and undamaged. Ice cubes are not included. Max. 3 yachts. - Payable at the base</p>	No	per booking	30,00 €
<p>Ice maker (Payable at the base)</p> <p>Season: 2026. operating with - shorepower or - Inverter min. 2.000 W or - Generator - Payable at the base</p>	No	per booking	45,00 €
<p>NESPRESSO coffee machine (Payable at the base)</p> <p>Season: 2026. operating with - shorepower or - Inverter min. 2000 W or - Generator - Payable at the base</p>	No	per booking	45,00 €
<p>Railing net (Safety net) (Payable at the base)</p> <p>Season: 2026. incl. mounting and unmounting - Payable at the base</p>	No	per booking	180,00 €
<p>Railing net (Safety net) (Payable at the base)</p> <p>Season: 2026. To be mounted / unmounted by the client (Net and mounting material must be returned by the crew after the charter) - Payable at the base</p>	No	per booking	35,00 €
<p>Stand up paddle (SUP) (Payable at the base)</p> <p>Season: 2026. Payable at the base</p>	No	per week	100,00 €

Towels (Payable at the base)

No

per set

10,00 €

Season: 2026. Payable at the base



WEBSITE

www.plujeme.cz



E-MAIL

info@plujeme.cz



PHONE

+420 720 755 085



MOBILE

+420 777 170 276



PLUJEME RÁDI S.R.O.

Dlouhá 730/35, 11000 Praha 1 – Staré Město, Czech Republic

PRICE AND AVAILABILITY

13.06. - 20.06.2026 NOT AVAILABLE	20.06. - 27.06.2026 NOT AVAILABLE	27.06. - 04.07.2026 NOT AVAILABLE	04.07. - 11.07.2026 NOT AVAILABLE
11.07. - 18.07.2026 NOT AVAILABLE	18.07. - 25.07.2026 NOT AVAILABLE	25.07. - 01.08.2026 NOT AVAILABLE	01.08. - 08.08.2026 NOT AVAILABLE
08.08. - 15.08.2026 NOT AVAILABLE	15.08. - 22.08.2026 NOT AVAILABLE	22.08. - 29.08.2026 NOT AVAILABLE	29.08. - 05.09.2026 NOT AVAILABLE
05.09. - 12.09.2026 NOT AVAILABLE	12.09. - 19.09.2026 3.816 € 4.770 €	19.09. - 26.09.2026 NOT AVAILABLE	26.09. - 03.10.2026 2.520 € 3.150 €
03.10. - 10.10.2026 2.152 € 2.690 €	10.10. - 17.10.2026 2.120 € 2.650 €	17.10. - 24.10.2026 2.072 € 2.590 €	24.10. - 31.10.2026 2.072 € 2.590 €
31.10. - 07.11.2026 2.072 € 2.590 €	07.11. - 14.11.2026 2.072 € 2.590 €	14.11. - 21.11.2026 2.072 € 2.590 €	22.11. - 31.12.2026 NOT AVAILABLE
01.01. - 19.03.2027 NOT AVAILABLE			



WEBSITE

www.plujeme.cz



E-MAIL

info@plujeme.cz



PHONE

+420 720 755 085



MOBILE

+420 777 170 276



PLUJEME RÁDI S.R.O.

Dlouhá 730/35, 11000 Praha 1 – Staré Město, Czech Republic