

# LAGOON 42

Anemi (2021)

Catamaran Lagoon 42 Anemi, built in 2021 is anchored in the Athens, Attica, Nea Peramos Marina, Athens area/Saronic/Peloponese, Greece. It has 4 + 2 cabins, can accommodate 8 + 2 people and has 4 + 1 toilets. Bed linen and kitchen equipment are included in the price.

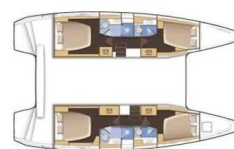
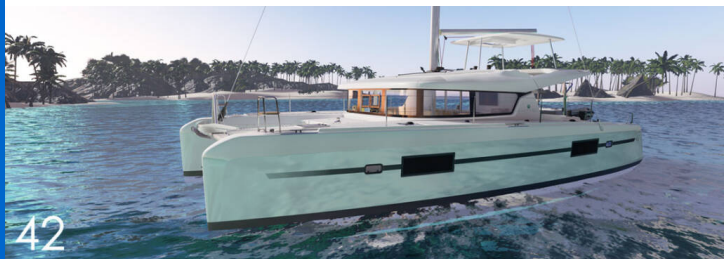

## YACHT SPECIFICATIONS

Yacht Base

**Athens, Attica, Nea Peramos Marina,  
Greece**

Yacht ID

**4183**

Brands

**Lagoon**

Yacht name

**Anemi**

Production year

**2021**

Length

**42 ft**

Cabins

**4 + 2**

Berths

**8 + 2**

Max Persons

**12**

WC

**4 + 1**

Engine

**2 x 57 HP**

Fuel tank

**300 l**



**WEBSITE**

[www.plujeme.cz](http://www.plujeme.cz)



**PHONE**

+420 720 755 085



**MOBILE**

+420 777 170 276



**E-MAIL**

[info@plujeme.cz](mailto:info@plujeme.cz)



**PLUJEME RÁDI S.R.O.**

Dlouhá 730/35, 11000 Praha 1 – Staré Město, Czech Republic

## STANDARD YACHT EQUIPMENT

Comfort	<b>Cockpit cushions</b>
Deck	<b>Bimini top, Cockpit table, Cockpit/stern, outside shower, Dinghy, Electric anchor windlass, Outboard engine, Swimming ladder, Tender</b>
Entertainment	<b>Snorkeling equipment</b>
Galley	<b>Coffee machine, Hot water, Oven, Refrigerator, Stove</b>
Interior	<b>Convertible table in salon, Electric fans, Electric toilet</b>
Navigation	<b>Autopilot, Echosounder/Depthsounder, GPS chart plotter, Navigation (Nautical) charts and nautical guide, Pilot book, Speedometer (Speed log), Wind instrument/Anemometer</b>
Safety	<b>First aid kit, Horseshoe lifebuoy, Life belts (Safety harness), Life jackets, Liferaft, VHF radio</b>
Sails	<b>Electric winch, Lazy bag, Lazy jacks</b>
Yacht electrics	<b>Air Conditioning, Battery charger, Generator, Shore power cable, Shore power connection, Solar panels, USB sockets, Watermaker - desalinator</b>



#### WEBSITE

[www.plujeme.cz](http://www.plujeme.cz)



#### E-MAIL

[info@plujeme.cz](mailto:info@plujeme.cz)



#### PHONE

+420 720 755 085



#### MOBILE

+420 777 170 276



#### PLUJEME RÁDI S.R.O.

Dlouhá 730/35, 11000 Praha 1 – Staré Město, Czech Republic

## SERVICES

SELECTED SERVICES	OBLIGATORY	PAYMENT TYPE	PRICE
<p><b>Charter pack</b> (Payable at the base)</p> <p><b>Season: 2026.</b> Included: End Cleaning, 2 bottles of water, soap and head paper (1 x per head); Bed Linen (per double cabin/week): 2 top sheets, 1 bottom sheet, 2 pillowcases, 2 quilts; Towels (per person/per week): 1 face towel, 1 bath towel; 2 Gas Bottles (one in full); Mooring fees (first and last day at Athenian's Pier); Snorkeling equipment (one set per cabin); Electricity consumption at the base, water refilling, outboard gasoline</p>	Yes	per booking	<b>370,00 €</b>
<p><b>Damage waiver</b> (Payable at the base)</p> <p><b>Season: 2026.</b> + Refundable Security Deposit 1000 €/per charter. DAMAGE WAIVER plus REFUNDABLE SECURITY DEPOSIT (must be paid on the spot) up to 2 weeks' charter. The Damage Waiver reduces your financial liability in the event of damage to the yacht, loss or damage to ancillary equipment, or damage caused by a third party during your charter. Non-refundable: The Damage Waiver is not refundable under any circumstances. The refundable deposit covers any damage or loss over the damage waiver amount, and the customer's total financial liability will not exceed the amount of the damage waiver and the refundable deposit. Coverage: It covers any loss or accident involving the yacht, its equipment, or a third party, including all risks of damage or theft, whether due to negligence or malicious intent by the skipper or clients. Indemnification: It indemnifies all parties involved in all cases. Additional Weeks: For any additional week of the charter, an extra Damage Waiver charge will apply, amounting to half of the standard Damage Waiver cost. The payment of either the Refundable Security Deposit or the Damage Waiver applies solely to one major incident at a time. Suppose there is a loss or damage to high-value equipment (such as an outboard engine or dinghy, sails, mast). In that case, the Charterer has the right to a replacement or repair, on the condition that a new Refundable Security Deposit is paid promptly upon receiving the replacement or completion of the repair.</p>	Yes	per booking	<b>500,00 €</b>

<p><b>Cook</b> (Payable at the base)</p> <p><b>Season: 2026.</b> Require their own cabin/head &amp; payable on the spot; Provisions for crew must include an allowance of up to €30/day/crew for meals. If the crew joins guests for meals ashore, the allowance does not apply The Charterer may cancel the crew service up to 31 days before embarkation without incurring any penalty. Athenian Yachts solely provides facilitation services to help the Charterer directly hire local freelance crew, without any additional fees or charges. The Company does not act as a crew agency or employer and assumes no responsibility for the performance of the crew's services. No warranties or representations are made regarding the quality or reliability of the crew's services, and Athenian Yachts shall not be liable for any act, omission, or negligence of the crew members.</p>	No	per day + food	<b>230,00 €</b>
<p><b>Crew change</b> (Payable at the base)</p> <p><b>Season: 2026.</b> Crew Change (only on our bases) is allowed up to 75% during the charter. If it is over 75%, it is considered a new charter; The skipper remains the same; Includes: water, electricity, and marina fees/services; Charter Pack, for crew changes as per our Price List.</p>	No	per crew change	<b>120,00 €</b>
<p><b>Early boarding/check-in</b> (Payable at the base)</p> <p><b>Season: 2026.</b> at 14:00hrs; upon request &amp; subject to no damages from the previous charterer</p>	No	per booking	<b>200,00 €</b>
<p><b>Hostess</b> (Payable at the base)</p> <p><b>Season: 2026.</b> Require their own cabin/head &amp; payable on the spot; Provisions for crew must include an allowance of up to €30/day/crew for meals. If the crew joins guests for meals ashore, the allowance does not apply The Charterer may cancel the crew service up to 31 days before embarkation without incurring any penalty. Athenian Yachts solely provides facilitation services to help the Charterer directly hire local freelance crew, without any additional fees or charges. The Company does not act as a crew agency or employer and assumes no responsibility for the performance of the crew's services. No warranties or representations are made regarding the quality or reliability of the crew's services, and Athenian Yachts shall not be liable for any act, omission, or negligence of the crew members.</p>	No	per day + food	<b>190,00 €</b>
<p><b>Internet pack</b> (Payable at the base)</p> <p><b>Season: 2026.</b> Wi-Fi router, unlimited</p>	No	per week	<b>90,00 €</b>
<p><b>Pet on board</b> (Payable at the base)</p> <p><b>Season: 2026.</b> Pets allowed (up to 7 kg)</p>	No	per booking	<b>200,00 €</b>
<p><b>Provisioning</b> (Payable at the base)</p> <p><b>Season: 2026.</b> Provisioning service</p>	No	per booking	<b>20,00 €</b>

**Skipper** (Payable at the base)

No

per day + food

**210,00 €**

**Season: 2026.** Damage Waiver is compulsory with skippered charter; Require their own cabin/head & payable on the spot; Provisions for crew must include an allowance of up to €30/day/crew for meals. If the crew joins guests for meals ashore, the allowance does not apply The Charterer may cancel the crew service up to 31 days before embarkation without incurring any penalty. Athenian Yachts solely provides facilitation services to help the Charterer directly hire local freelance crew, without any additional fees or charges. The Company does not act as a crew agency or employer and assumes no responsibility for the performance of the crew's services. No warranties or representations are made regarding the quality or reliability of the crew's services, and Athenian Yachts shall not be liable for any act, omission, or negligence of the crew members.

**Transfer** (Payable at the base)

No

one-way

**0,00 €**

**Season: 2026.** Free one way transfer, upon request

**Transfer** (Payable at the base)

No

per booking

**0,00 €**

**Season: 2026.** Kindly contact charter company for the transfer cost.

Transfer service upon request (can only be arranged the latest 7 days before embarkation)

**WEBSITE**[www.plujeme.cz](http://www.plujeme.cz)**PHONE**

+420 720 755 085

**MOBILE**

+420 777 170 276

**E-MAIL**[info@plujeme.cz](mailto:info@plujeme.cz)**PLUJEME RÁDI S.R.O.**

Dlouhá 730/35, 11000 Praha 1 – Staré Město, Czech Republic

## ADDITIONAL EXTRAS

EXTRA	OBLIGATORY	PAYMENT TYPE	PRICE
<b>Automatic Inflatable Life Jacket</b> (Payable at the base) <b>Season: 2026.</b> subject to availability - Payable at the base	No	per week/ person	<b>30,00 €</b>
<b>Beach towel</b> (Payable at the base) <b>Season: 2026.</b> yours to keep - Payable at the base	No	per piece	<b>13,00 €</b>
<b>Extra bedlinen and towels</b> (Payable at the base) <b>Season: 2026.</b> 1 set = 2 sheets, 1 pillow case, 1 face towel, 1 bath towel - Payable at the base	No	per set	<b>12,00 €</b>
<b>Grill/Barbecue/Plancha</b> (Payable at the base) <b>Season: 2026.</b> BBQ Instant Grill - Payable at the base	No	per piece	<b>13,00 €</b>
<b>Railing net (Safety net)</b> (Payable at the base) <b>Season: 2026.</b> Payable at the base	No	per booking	<b>200,00 €</b>
<b>Stand up paddle (SUP)</b> (Payable at the base) <b>Season: 2026.</b> + €300 refundable security deposit (by credit card) - subject to availability - Payable at the base	No	per week	<b>100,00 €</b>



**WEBSITE**

[www.plujeme.cz](http://www.plujeme.cz)



**E-MAIL**

[info@plujeme.cz](mailto:info@plujeme.cz)



**PHONE**

+420 720 755 085



**MOBILE**

+420 777 170 276



**PLUJEME RÁDI S.R.O.**

Dlouhá 730/35, 11000 Praha 1 – Staré Město, Czech Republic

## PRICE AND AVAILABILITY

13.06. - 20.06.2026 NOT AVAILABLE	20.06. - 27.06.2026 NOT AVAILABLE	27.06. - 04.07.2026 7.140 € 8.400 €	04.07. - 11.07.2026 7.140 € 8.400 €
11.07. - 18.07.2026 NOT AVAILABLE	18.07. - 25.07.2026 7.140 € 8.400 €	25.07. - 01.08.2026 NOT AVAILABLE	01.08. - 08.08.2026 NOT AVAILABLE
08.08. - 15.08.2026 NOT AVAILABLE	15.08. - 29.08.2026 NOT AVAILABLE	29.08. - 05.09.2026 7.140 € 8.400 €	05.09. - 12.09.2026 7.140 € 8.400 €
12.09. - 19.09.2026 NOT AVAILABLE	19.09. - 26.09.2026 NOT AVAILABLE	26.09. - 03.10.2026 NOT AVAILABLE	03.10. - 10.10.2026 4.854 € 5.710 €
10.10. - 17.10.2026 3.570 € 4.200 €	17.10. - 24.10.2026 3.570 € 4.200 €	24.10. - 31.10.2026 3.570 € 4.200 €	31.10. - 07.11.2026 3.570 € 4.200 €
07.11. - 14.11.2026 3.570 € 4.200 €	14.11. - 21.11.2026 3.570 € 4.200 €	21.11. - 28.11.2026 3.570 € 4.200 €	28.11. - 05.12.2026 3.570 € 4.200 €
05.12. - 12.12.2026 3.570 € 4.200 €	12.12. - 19.12.2026 3.570 € 4.200 €	19.12. - 26.12.2026 3.570 € 4.200 €	



### WEBSITE

[www.plujeme.cz](http://www.plujeme.cz)



### E-MAIL

[info@plujeme.cz](mailto:info@plujeme.cz)



### PHONE

+420 720 755 085



### MOBILE

+420 777 170 276



### PLUJEME RÁDI S.R.O.

Dlouhá 730/35, 11000 Praha 1 – Staré Město, Czech Republic