

OCEANIS 51.1

Anna (2020)

Sailing yacht Oceanis 51.1 Anna, built in 2020 is anchored in the Sukosan, D-Marin Dalmacija Marina, Zadar region, Croatia . It has 5 + 1 cabins, can accommodate 10 + 2 people and has 4 toilets. Bed linen and kitchen equipment are included in the price.

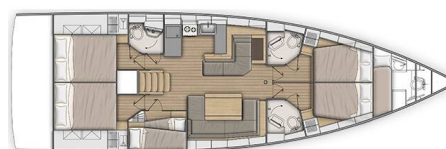

YACHT SPECIFICATIONS

Yacht Base

**Sukosan, D-Marin Dalmacija Marina,
Croatia**

Yacht ID

4159

Brands

Beneteau

Yacht name

Anna

Production year

2020

Length

52 ft

Cabins

5 + 1

Berths

10 + 2

WC

4

Engine

1 x 110 HP

Fuel tank

200 l



WEBSITE

www.plujeme.cz



PHONE

+420 720 755 085



MOBILE

+420 777 170 276



E-MAIL

info@plujeme.cz



PLUJEME RÁDI S.R.O.

Dlouhá 730/35, 11000 Praha 1 – Staré Město, Czech Republic

STANDARD YACHT EQUIPMENT

Deck	Bimini top, Cockpit fridge, Cockpit/stern, outside shower, Hydraulic gangway, Sprayhood, Teak cockpit
Entertainment	Hi-Fi system
Galley	Dishwasher, Freezer, Ice maker, NESPRESSO coffee machine, Refrigerator
Interior	Convertible table in salon, Electric toilet, LED lights
Navigation	AIS, Autopilot, Bow thruster, GPS, GPS chart plotter, GPS chart plotter - cockpit, Wind instrument/Anemometer
Safety	Black Water Tank, Self inflating life vest, VHF radio
Sails	Electric winch
Yacht electrics	Air Conditioning, Battery charger, Generator, Heating



WEBSITE

www.plujeme.cz



E-MAIL

info@plujeme.cz



PHONE

+420 720 755 085



MOBILE

+420 777 170 276



PLUJEME RÁDI S.R.O.

Dlouhá 730/35, 11000 Praha 1 – Staré Město, Czech Republic

SERVICES

SELECTED SERVICES	OBLIGATORY	PAYMENT TYPE	PRICE
Comfort Pack (Payable at the base) Season: 2026. Transit Log, Gas, diver inspection Friday, Outboard engine & dinghy, Wi-Fi unlimited, 1x Bed linen & towel set, Cockpit cushions, Hygiene Pack (MULTIPLE WEEKS: + EUR 50,- per week for the extra set of bed linen)	Yes	per booking	350,00 €
Hostess (Payable at the base) Season: 2026. Half board- breakfast and little lunch in the afternoon	No	per day + food	180,00 €
Pet on board (Payable at the base) Season: 2026.	No	per booking	200,00 €
Skipper (Payable at the base) Season: 2026.	No	per day + food	210,00 €
Transfer (Payable at the base) Season: 2026. On Request; Airport Zadar – Split; Prices depending on the transfer routes, executed by external partner; Payable only in cash	No	one-way	0,00 €

**WEBSITE**www.plujeme.cz**E-MAIL**info@plujeme.cz**PHONE**

+420 720 755 085

**MOBILE**

+420 777 170 276

**PLUJEME RÁDI S.R.O.**

Dlouhá 730/35, 11000 Praha 1 – Staré Město, Czech Republic

ADDITIONAL EXTRAS

EXTRA	OBLIGATORY	PAYMENT TYPE	PRICE
Beach towel (Payable at the base) Season: 2026. Payable at the base	No	per week	5,00 €
Code Zero (Payable at the base) Season: 2026. + EUR 800 - refundable extra deposit - Payable at the base	No	per week	450,00 €
Extra bedlinen (Payable at the base) Season: 2026. Payable at the base	No	per person	6,00 €
Extra towels (Payable at the base) Season: 2026. Payable at the base	No	per person	6,00 €
Gennaker (Payable at the base) Season: 2026. A3 Gennaker (+ EUR 800 - refundable extra deposit) - Payable at the base	No	per week	450,00 €
Railing net (Safety net) (Payable at the base) Season: 2026. Payable at the base	No	per booking	100,00 €
Snorkeling equipment (Payable at the base) Season: 2026. one pair of diving goggles & fins: free of charge (on request!) - Payable at the base	No	per booking	0,00 €
Stand up paddle (SUP) (Payable at the base) Season: 2026. Payable at the base	No	per week	120,00 €
Surf board (Payable at the base) Season: 2026. Lampuga Boost Electric Surf Board - Payable at the base	No	per week	990,00 €



WEBSITE
www.plujeme.cz



PHONE
+420 720 755 085



MOBILE
+420 777 170 276



E-MAIL
info@plujeme.cz



PLUJEME RÁDI S.R.O.
Dlouhá 730/35, 11000 Praha 1 - Staré Město, Czech Republic

PRICE AND AVAILABILITY

25.04. - 02.05.2026 2.325 € 3.100 €	02.05. - 09.05.2026 2.475 € 3.300 €	09.05. - 16.05.2026 2.625 € 3.500 €	16.05. - 23.05.2026 NOT AVAILABLE
23.05. - 30.05.2026 3.900 € 5.200 €	30.05. - 06.06.2026 NOT AVAILABLE	06.06. - 13.06.2026 NOT AVAILABLE	13.06. - 20.06.2026 4.800 € 6.000 €
20.06. - 27.06.2026 NOT AVAILABLE	27.06. - 04.07.2026 5.586 € 6.982 €	04.07. - 11.07.2026 5.292 € 7.350 €	11.07. - 18.07.2026 5.443 € 7.560 €
18.07. - 25.07.2026 5.594 € 7.770 €	25.07. - 01.08.2026 5.746 € 7.980 €	01.08. - 08.08.2026 NOT AVAILABLE	08.08. - 15.08.2026 5.796 € 7.245 €
15.08. - 22.08.2026 NOT AVAILABLE	22.08. - 29.08.2026 5.292 € 6.615 €	29.08. - 05.09.2026 NOT AVAILABLE	05.09. - 12.09.2026 4.400 € 5.500 €
12.09. - 19.09.2026 NOT AVAILABLE	19.09. - 26.09.2026 NOT AVAILABLE	26.09. - 03.10.2026 NOT AVAILABLE	03.10. - 10.10.2026 2.738 € 3.650 €
10.10. - 21.10.2026 NOT AVAILABLE	24.10. - 31.10.2026 2.400 € 3.200 €	31.10. - 07.11.2026 2.400 € 3.200 €	07.11. - 14.11.2026 2.560 € 3.200 €
14.11. - 21.11.2026 2.560 € 3.200 €	21.11. - 28.11.2026 2.560 € 3.200 €	28.11. - 05.12.2026 2.560 € 3.200 €	



WEBSITE
www.plujeme.cz



E-MAIL
info@plujeme.cz



PHONE
+420 720 755 085



MOBILE
+420 777 170 276



PLUJEME RÁDI S.R.O.
Dlouhá 730/35, 11000 Praha 1 – Staré Město, Czech Republic

PRICE AND AVAILABILITY

05.12. - 12.12.2026

2.560 € 3.200 €

12.12. - 19.12.2026

2.560 € 3.200 €

19.12. - 26.12.2026

2.560 € 3.200 €



WEBSITE

www.plujeme.cz



E-MAIL

info@plujeme.cz



PHONE

+420 720 755 085



MOBILE

+420 777 170 276



PLUJEME RÁDI S.R.O.

Dlouhá 730/35, 11000 Praha 1 – Staré Město, Czech Republic