

OCEANIS 51.1

Reboot (2022)

Sailing yacht Oceanis 51.1 Reboot, built in 2022 is anchored in the Athens, Alimos marina, Athens area/Saronic/Peloponese, Greece. It has 5 + 1 cabins, can accommodate 10 + 2 + 1 people and has 3 + 1 toilets. Bed linen and kitchen equipment are included in the price.

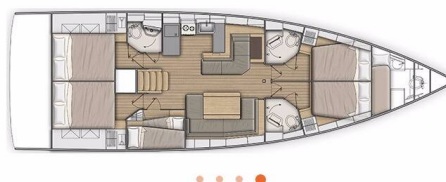

YACHT SPECIFICATIONS

Yacht Base

Athens, Alimos marina, Greece

Yacht ID

4074

Brands

Beneteau

Yacht name

Reboot

Production year

2022

Length

52 ft

Cabins

5 + 1

Berths

10 + 2 + 1

Max Persons

12

WC

3 + 1

Engine

1 x 80 HP

Fuel tank

400 l



WEBSITE

www.plujeme.cz



PHONE

+420 720 755 085



MOBILE

+420 777 170 276



E-MAIL

info@plujeme.cz



PLUJEME RÁDI S.R.O.

Dlouhá 730/35, 11000 Praha 1 – Staré Město, Czech Republic

STANDARD YACHT EQUIPMENT

Comfort	Bed linen, Cockpit cushions, Towels
Deck	Bathing platform, Bimini top, Cockpit table, Cockpit/stern, outside shower, Davit, Dinghy, Electric anchor windlass, Gangway, Inox Boarding Ladder, Outboard engine, Sprayhood, Swimming ladder
Entertainment	Snorkeling equipment
Galley	Coffee machine, Hot water, Kitchen utensils (Galley equipment, cutlery), Microwave, Refrigerator
Interior	Convertible table
Navigation	Autopilot, Bow thruster, GPS chart plotter - cockpit, Radar reflector, Wind/speed/depth instruments
Safety	Life belts (Safety harness), Liferaft, VHF radio
Sails	Electric winch
Yacht electrics	Air Conditioning, Battery charger, Generator, Inverter, Shore connection 220 V



WEBSITE
www.plujeme.cz



PHONE
+420 720 755 085



MOBILE
+420 777 170 276



E-MAIL
info@plujeme.cz



PLUJEME RÁDI S.R.O.
Dlouhá 730/35, 11000 Praha 1 – Staré Město, Czech Republic

SERVICES

SELECTED SERVICES	OBLIGATORY	PAYMENT TYPE	PRICE
Damage waiver (Payable at the base) Season: 2026. +500EUR refundable deposit	Yes	per day	60,00 €
Service Pack (Payable at the base) Season: 2026. Final Cleaning, Bed linen, towels, blankets, one set /cabin/week, Dinghy with outboard engine, mooring fees for the first and last night in port	Yes	per booking	400,00 €
Cook (Payable at the base) Season: 2026. require their own cabin	No	per day + food	230,00 €
Crew change (Payable at the base) Season: 2026. Crew change fees (only in one of our bases. Included: Formalities (contract, crew list etc), 1 day mooring fees). Not included: Cleaning of the yacht and laundry)	No	per booking	200,00 €
Damage waiver (Payable at the base) Season: 2026. Applies only when skipper is choosen	No	per booking	350,00 €
Early Check in (Payable at the base) Season: 2026.	No	per booking	150,00 €
Hostess (Payable at the base) Season: 2026. require their own cabin	No	per day + food	190,00 €
Mooring fee (Payable at the base) Season: 2026. except for the first and last night in home port	No	per booking	0,00 €
Pet on board (Payable at the base) Season: 2026. Extra cleaning fee	No	per booking	0,00 €
Provisioning (Payable at the base) Season: 2026. can be pre-ordered without any extra service fee *Please request for our provisioning list form	No	per booking	0,00 €
Skipper (Payable at the base) Season: 2026. require their own cabin	No	per day + food	210,00 €
Transfer (Payable at the base) Season: 2026. can be arranged upon request	No	one-way	0,00 €

WI-FI Internet connection on boat (Payable at the base)

No

per week

100,00 €

Season: 2026. UNLIMITED/ week up to 10 users



WEBSITE

www.plujeme.cz



E-MAIL

info@plujeme.cz



PHONE

+420 720 755 085



MOBILE

+420 777 170 276



PLUJEME RÁDI S.R.O.

Dlouhá 730/35, 11000 Praha 1 – Staré Město, Czech Republic

ADDITIONAL EXTRAS

EXTRA	OBLIGATORY	PAYMENT TYPE	PRICE
Extra bedlinen <i>(Payable at the base)</i> Season: 2026. <i>Payable at the base</i>	No	per person	10,00 €
Fishing equipment <i>(Payable at the base)</i> Season: 2026. <i>Payable at the base</i>	No	per week	150,00 €
Paddle board <i>(Payable at the base)</i> Season: 2026. <i>Payable at the base</i>	No	per week	150,00 €
Railing net (Safety net) <i>(Payable at the base)</i> Season: 2026. <i>Installed - Payable at the base</i>	No	per booking	250,00 €

**WEBSITE**www.plujeme.cz**E-MAIL**info@plujeme.cz**PHONE**

+420 720 755 085

**MOBILE**

+420 777 170 276

**PLUJEME RÁDI S.R.O.**

Dlouhá 730/35, 11000 Praha 1 – Staré Město, Czech Republic

PRICE AND AVAILABILITY

09.05. - 16.05.2026 NOT AVAILABLE	16.05. - 23.05.2026 NOT AVAILABLE	23.05. - 30.05.2026 NOT AVAILABLE	30.05. - 06.06.2026 NOT AVAILABLE
06.06. - 13.06.2026 NOT AVAILABLE	13.06. - 20.06.2026 NOT AVAILABLE	20.06. - 27.06.2026 NOT AVAILABLE	27.06. - 04.07.2026 5.568 € 6.550 €
04.07. - 18.07.2026 NOT AVAILABLE	18.07. - 25.07.2026 5.568 € 6.550 €	25.07. - 01.08.2026 5.568 € 6.550 €	01.08. - 08.08.2026 6.503 € 7.650 €
08.08. - 15.08.2026 6.503 € 7.650 €	15.08. - 22.08.2026 NOT AVAILABLE	22.08. - 29.08.2026 5.440 € 6.400 €	29.08. - 05.09.2026 5.440 € 6.400 €
05.09. - 19.09.2026 NOT AVAILABLE	19.09. - 26.09.2026 NOT AVAILABLE	26.09. - 03.10.2026 NOT AVAILABLE	03.10. - 10.10.2026 4.675 € 5.500 €
10.10. - 17.10.2026 4.675 € 5.500 €	17.10. - 24.10.2026 3.485 € 4.100 €	24.10. - 31.10.2026 3.485 € 4.100 €	31.10. - 07.11.2026 3.485 € 4.100 €
08.11. - 31.12.2026 NOT AVAILABLE			



WEBSITE

www.plujeme.cz



E-MAIL

info@plujeme.cz



PHONE

+420 720 755 085



MOBILE

+420 777 170 276



PLUJEME RÁDI S.R.O.

Dlouhá 730/35, 11000 Praha 1 – Staré Město, Czech Republic