

LAGOON 46

Voyager (2022)

Catamaran **Lagoon 46 Voyager**, built in **2022** is anchored in the **Mallorca, Can Pastilla, Balearic Islands, Spain**. It has **4 + 2 cabins**, can accommodate **8 + 2 + 2 people** and has **4 toilets**. Bed linen and kitchen equipment are included in the price.

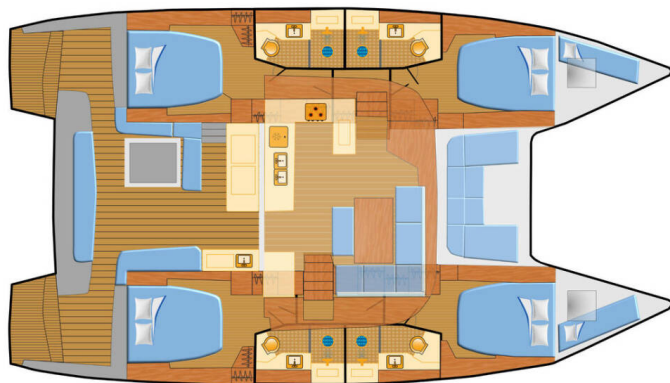
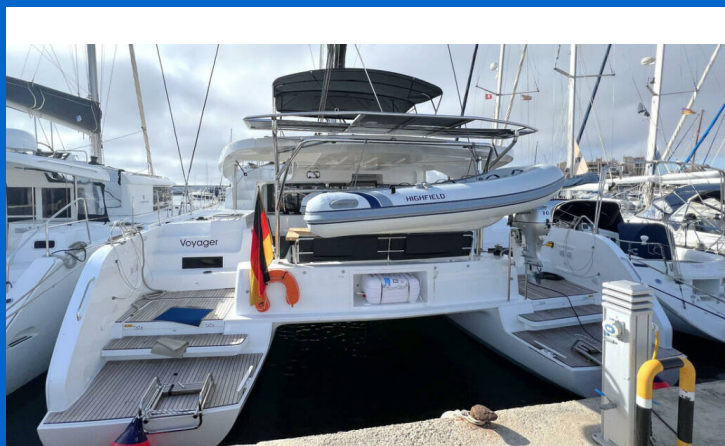

YACHT SPECIFICATIONS

Yacht Base

Mallorca, Can Pastilla, Spain

Yacht ID

4072

Brands

Lagoon

Yacht name

Voyager

Production year

2022

Length

46 ft

Cabins

4 + 2

Berths

8 + 2 + 2

Max Persons

12

WC

4

Engine

2 x 57 HP

Fuel tank

1040 l



WEBSITE

www.plujeme.cz



PHONE

+420 720 755 085



MOBILE

+420 777 170 276



E-MAIL

info@plujeme.cz



PLUJEME RÁDI S.R.O.

Dlouhá 730/35, 11000 Praha 1 – Staré Město, Czech Republic

STANDARD YACHT EQUIPMENT

Additional	Flag
Comfort	Bed linen, Cockpit cushions, Sundeck cushions
Deck	Anchor light, Anchor with chain, Bathing platform, Bimini top, Boat hook, Bosun's chair (Safe seat) (boatswain's chair), Cockpit fridge, Cockpit table, Cockpit/stern, outside shower, Deck brush, Electric anchor windlass, Fenders, Gangway, Mooring ropes, Plastic bucket, Pulpit seat, Remote control for anchor winch with chain counter at helm, Spare anchor (Reserve, Auxiliary anchor), Sprayhood, Spring line, Swimming ladder, Teak cockpit, Teak cockpit table with folding leaves
Entertainment	Fusion radio, Indoor speakers, Outdoor speakers, Wi-Fi Internet
Galley	Coffee machine, Freezer, Gas cookers, Hot water, Kitchen utensils (Galley equipment, cutlery), Microwave, Oven, Pressurized water system, Refrigerator
Interior	Clock, Coolbox, Electric fans in cabins, Lowerable salon table, Safe
Navigation	AIS, Autopilot, Binoculars, Compass, Echosounder/Depthsonder, GPS chart plotter, Hand bearing compass, Harbour guides, Navigation (Nautical) charts and nautical guide, Navigation set, Navigation/position Lights, Speedometer (Speed log), Triangles, Wind instrument/Anemometer
Safety	Automatic Inflatable Life Jacket, EPIRB-Distress radio beacons, Fire extinguisher, First aid kit, Flashlight, Fog horn, Gas detector, Guard rail, Horseshoe lifebuoy, Life belts (Safety harness), Liferaft, Set of tools, Signal rockets and torches, VHF radio, Wire (shroud) cutter
Sails	Electric winch, Lazy bag, Lazy jacks, Winch
Yacht electrics	220V socket, Air Conditioning, Battery charger, Converter 220V/12V, Generator, Heating, Inverter, Shore connection 220 V, Solar panels, USB sockets



WEBSITE

www.plujeme.cz



PHONE

+420 720 755 085



MOBILE

+420 777 170 276



E-MAIL

info@plujeme.cz



PLUJEME RÁDI S.R.O.

Dlouhá 730/35, 11000 Praha 1 – Staré Město, Czech Republic

SERVICES

SELECTED SERVICES	OBLIGATORY	PAYMENT TYPE	PRICE
Base package (Payable at the base) Season: 2026. Cleaning, bed linen, towel set (1x small, 1x large), flushing set, WiFi, gas, dinghy & outboard engine	Yes	per booking	500,00 €
Damage waiver (Payable at the base) Season: 2026. The damage waiver costs 300,00 €. The customers still have to deposit 500,00 €. If there is no damage, they get the 500,00 € back. Can be finalized by the customer on the base. We do not need any information in advance.	No	per booking	300,00 €
Early Check in (Payable at the base) Season: 2026. at 12:00h (only on request); Payable in cash at the base	No	per booking	150,00 €
Hostess (Payable at the base) Season: 2026. Free food, own cabin	No	per week	1.750,00 €
Pet on board (Payable at the base) Season: 2026. on request only; Payable in cash at the base	No	per booking	140,00 €
Skipper (Payable at the base) Season: 2026. Free food, own skipper cabin	No	per week	2.100,00 €



WEBSITE

www.plujeme.cz



E-MAIL

info@plujeme.cz



PHONE

+420 720 755 085



MOBILE

+420 777 170 276



PLUJEME RÁDI S.R.O.

Dlouhá 730/35, 11000 Praha 1 – Staré Město, Czech Republic

ADDITIONAL EXTRAS

EXTRA	OBLIGATORY	PAYMENT TYPE	PRICE
Beach towel (Payable at the base) Season: 2026. Payable at the base	No	per person	20,00 €
Grill/Barbecue/Plancha (Payable at the base) Season: 2026. Danish Cobb Gas Grill (BBQ Grill), Payable in cash at base 50% second week] - Payable at the base	No	per week	100,00 €
Snorkeling equipment (Payable at the base) Season: 2026. diving mask and snorkel - Payable at the base	No	per set	35,00 €
Stand up paddle (SUP) (Payable at the base) Season: 2026. Payable in cash at the base 50% second week - Payable at the base	No	per week	100,00 €

**WEBSITE**www.plujeme.cz**E-MAIL**info@plujeme.cz**PHONE**

+420 720 755 085

**MOBILE**

+420 777 170 276

**PLUJEME RÁDI S.R.O.**

Dlouhá 730/35, 11000 Praha 1 – Staré Město, Czech Republic

PRICE AND AVAILABILITY

25.04. - 02.05.2026 NOT AVAILABLE	02.05. - 09.05.2026 NOT AVAILABLE	09.05. - 16.05.2026 6.525 € 8.700 €	16.05. - 23.05.2026 6.525 € 8.700 €
23.05. - 30.05.2026 NOT AVAILABLE	30.05. - 06.06.2026 NOT AVAILABLE	06.06. - 13.06.2026 NOT AVAILABLE	13.06. - 20.06.2026 NOT AVAILABLE
20.06. - 27.06.2026 NOT AVAILABLE	27.06. - 04.07.2026 NOT AVAILABLE	04.07. - 11.07.2026 NOT AVAILABLE	11.07. - 18.07.2026 NOT AVAILABLE
18.07. - 25.07.2026 NOT AVAILABLE	25.07. - 01.08.2026 11.050 € 13.000 €	01.08. - 08.08.2026 NOT AVAILABLE	08.08. - 15.08.2026 NOT AVAILABLE
15.08. - 22.08.2026 NOT AVAILABLE	22.08. - 29.08.2026 11.050 € 13.000 €	29.08. - 05.09.2026 11.050 € 13.000 €	05.09. - 12.09.2026 9.733 € 11.450 €
12.09. - 19.09.2026 NOT AVAILABLE	19.09. - 26.09.2026 8.883 € 10.450 €	26.09. - 03.10.2026 8.245 € 9.700 €	03.10. - 10.10.2026 7.395 € 8.700 €
10.10. - 17.10.2026 7.395 € 8.700 €	17.10. - 24.10.2026 4.463 € 5.250 €	24.10. - 31.10.2026 4.463 € 5.250 €	31.10. - 07.11.2026 4.463 € 5.250 €
07.11. - 14.11.2026 4.463 € 5.250 €	14.11. - 21.11.2026 4.463 € 5.250 €	21.11. - 28.11.2026 4.463 € 5.250 €	28.11. - 05.12.2026 5.250 €



WEBSITE

www.plujeme.cz



E-MAIL

info@plujeme.cz



PHONE

+420 720 755 085



MOBILE

+420 777 170 276



PLUJEME RÁDI S.R.O.

Dlouhá 730/35, 11000 Praha 1 – Staré Město, Czech Republic

PRICE AND AVAILABILITY

05.12. - 12.12.2026 5.250 €	12.12. - 19.12.2026 5.250 €	19.12. - 26.12.2026 5.250 €	01.01. - 26.03.2027 NOT AVAILABLE
27.03. - 03.04.2027 4.463 € 5.250 €	03.04. - 10.04.2027 4.463 € 5.250 €	10.04. - 17.04.2027 4.463 € 5.250 €	17.04. - 24.04.2027 4.463 € 5.250 €
24.04. - 01.05.2027 4.463 € 5.250 €	01.05. - 08.05.2027 4.463 € 5.250 €	08.05. - 15.05.2027 7.395 € 8.700 €	15.05. - 22.05.2027 7.395 € 8.700 €
22.05. - 29.05.2027 8.245 € 9.700 €	29.05. - 05.06.2027 8.883 € 10.450 €	05.06. - 12.06.2027 8.883 € 10.450 €	12.06. - 19.06.2027 ON OPTION
19.06. - 26.06.2027 8.883 € 10.450 €	26.06. - 03.07.2027 8.883 € 10.450 €	03.07. - 10.07.2027 11.050 € 13.000 €	10.07. - 17.07.2027 11.050 € 13.000 €
17.07. - 24.07.2027 11.050 € 13.000 €	24.07. - 31.07.2027 11.050 € 13.000 €	31.07. - 07.08.2027 11.050 € 13.000 €	



WEBSITE

www.plujeme.cz



E-MAIL

info@plujeme.cz



PHONE

+420 720 755 085



MOBILE

+420 777 170 276



PLUJEME RÁDI S.R.O.

Dlouhá 730/35, 11000 Praha 1 – Staré Město, Czech Republic

PRICE AND AVAILABILITY

07.08. - 14.08.2027 11.050 € 13.000 €	14.08. - 21.08.2027 11.050 € 13.000 €	21.08. - 28.08.2027 11.050 € 13.000 €	28.08. - 04.09.2027 11.050 € 13.000 €
04.09. - 11.09.2027 9.733 € 11.450 €	11.09. - 18.09.2027 9.733 € 11.450 €	18.09. - 25.09.2027 8.883 € 10.450 €	25.09. - 02.10.2027 8.245 € 9.700 €
02.10. - 09.10.2027 7.395 € 8.700 €	09.10. - 16.10.2027 7.395 € 8.700 €	16.10. - 23.10.2027 4.463 € 5.250 €	23.10. - 30.10.2027 4.463 € 5.250 €
30.10. - 06.11.2027 4.463 € 5.250 €	07.11. - 24.03.2028 NOT AVAILABLE		



WEBSITE

www.plujeme.cz



E-MAIL

info@plujeme.cz



PHONE

+420 720 755 085



MOBILE

+420 777 170 276



PLUJEME RÁDI S.R.O.

Dlouhá 730/35, 11000 Praha 1 – Staré Město, Czech Republic