

SUN ODYSSEY 490

Funsea (2022)

Sailing yacht Sun Odyssey 490 Funsea, built in 2022 is anchored in the **Corfu, Gouvia Marina, Ionian Islands, Greece**. It has **4 + 1 cabins**, can accommodate **8 + 2 + 1 people** and has **4 + 1 toilets**. Bed linen and kitchen equipment are included in the price.

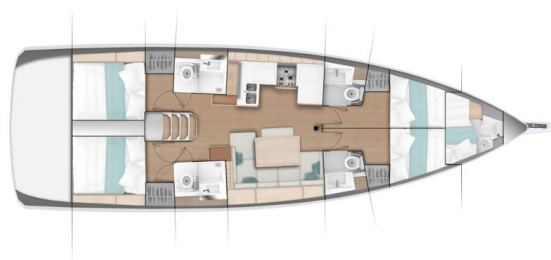

YACHT SPECIFICATIONS

Yacht Base

Corfu, Gouvia Marina, Greece

Yacht ID

4062

Brands

Jeanneau

Yacht name

Funsea

Production year

2022

Length

47 ft

Cabins

4 + 1

Berths

8 + 2 + 1

WC

4 + 1

Engine

1 x 80 HP

Fuel tank

240 l



WEBSITE

www.plujeme.cz



PHONE

+420 720 755 085



MOBILE

+420 777 170 276



E-MAIL

info@plujeme.cz



PLUJEME RÁDI S.R.O.

Dlouhá 730/35, 11000 Praha 1 – Staré Město, Czech Republic

STANDARD YACHT EQUIPMENT

| | |
|-----------------|--|
| Comfort | Sundeck cushions |
| Deck | Anchor with chain, Bathing platform, Bilge pump - Mechanic, Bimini top, Bow shower, Cockpit table, Cockpit/stern, outside shower, Dinghy with outboard engine, Electric anchor windlass, Fenders, Gangway, Grill/Barbecue/Plancha, Spare anchor (Reserve, Auxiliary anchor), Sprayhood, Swimming ladder |
| Entertainment | Outdoor speakers, Radio mp3 player, Wireless Internet Router |
| Galley | Coffee machine, Dishes, Freezer, Hot water, Oven, Pressurized water system, Refrigerator, Sink |
| Interior | Barometer, Electric fans, Electric fans in cabins, Electric toilet |
| Navigation | Autopilot, Binoculars, Bow thruster, Compass, Echosounder/Depthsounder, GPS chart plotter - cockpit, Harbour guides, Nautical charts, Navigation/position Lights, Wind instrument/Anemometer |
| Safety | Bilge alarm, Black Water Tank, Distress signals, Emergency tiller, EPIRB-Distress radio beacons, Fire blanket, Fire extinguisher, First aid kit, Fog horn, Gas detector, Guard rail, Life belts (Safety harness), Life jackets, Liferaft, Search light, Set of tools, Signal flags, VHF radio |
| Sails | Electric winch, Lazy bag, Lazy jacks |
| Yacht electrics | 220V socket, Batteries, Battery charger, Bilge pump - Electric, Shore connection 220 V, Solar panels |



WEBSITE

www.plujeme.cz



PHONE

+420 720 755 085



MOBILE

+420 777 170 276



E-MAIL

info@plujeme.cz



PLUJEME RÁDI S.R.O.

Dlouhá 730/35, 11000 Praha 1 – Staré Město, Czech Republic

SERVICES

| SELECTED SERVICES | OBLIGATORY | PAYMENT TYPE | PRICE |
|---|------------|----------------|-----------------|
| Security Deposit Waiver (Payable at the base) Season: 2026. 200 EUR credit voucher for the next charter in case of no damage/loss upon redelivery. No cash refund. | Yes | per booking | 450,00 € |
| Standard Charter Pack (Payable at the base) Season: 2026. Welcome kit | Yes | per booking | 280,00 € |
| Beach towel (Payable at the base) Season: 2026. | No | per booking | 10,00 € |
| Berth cost (Payable at the base) Season: 2026. Berthing fees for first & last night at the marina/port | No | per booking | 0,00 € |
| Cabin conversion (Payable at the base) Season: 2026. If possible on yacht. Contact fleet operator for more information. | No | per booking | 150,00 € |
| Cook (Payable at the base) Season: 2026. Crew provisioning to be provided by Charterer in arrangement with crew. If monetary compensation shall be agreed, then it shall be of no less than €30 per crew member per day. Charterer shall provide crew with sleeping cabin/berth and shower/toilet use to be designated to them onboard. | No | per day + food | 215,00 € |
| Family pack (Payable at the base) Season: 2026. Safety net, SUP, junior life jackets, normal foam type | No | per booking | 350,00 € |
| Fast Track pack (Payable at the base) Season: 2026. Access to the yacht by 14:00h on embarkation day, only IF feasible | No | per booking | 200,00 € |
| Hostess (Payable at the base) Season: 2026. Crew provisioning to be provided by Charterer in arrangement with crew. If monetary compensation shall be agreed, then it shall be of no less than €30 per crew member per day. Charterer shall provide crew with sleeping cabin/berth and shower/toilet use to be designated to them onboard. | No | per day + food | 180,00 € |

| | | | |
|---|----|----------------|-------------------|
| Internet pack (Payable at the base) Season: 2026. Wi-Fi router for Internet aboard (subject to GSM coverage up to 10GB/week) | No | per week | 50,00 € |
| One way fee (Payable at the base) Season: 2026. Volos-Skiathos | No | per booking | 300,00 € |
| One way fee (Payable at the base) Season: 2026. Preveza-Lefkas | No | per booking | 300,00 € |
| One way fee (Payable at the base) Season: 2026. Athens-Lavrion | No | per booking | 500,00 € |
| One way fee (Payable at the base) Season: 2026. Athens-Cyclades/Sporades | No | per booking | 1.000,00 € |
| One way fee (Payable at the base) Season: 2026. Athens-Dodecanese | No | per booking | 1.200,00 € |
| One way fee (Payable at the base) Season: 2026. Kos-Rhodos | No | per booking | 600,00 € |
| One way fee (Payable at the base) Season: 2026. Lefkas/Preveza-Corfu | No | per booking | 600,00 € |
| One way fee (Payable at the base) Season: 2026. Athens-Lefkas-Preveza | No | per booking | 1.200,00 € |
| One way fee (Payable at the base) Season: 2026. Athens-Corfu | No | per booking | 1.400,00 € |
| Overnight on board (Payable at the base) Season: 2026. Embarkation on yacht & overnight stay the day before charter starts, check-in by 13:00h on charter start day. Subject to last minute availability of yacht on previous day. | No | per booking | 180,00 € |
| Pet on board (Payable at the base) Season: 2026. up to 7 kg | No | per booking | 200,00 € |
| Skipper (Payable at the base) Season: 2026. Crew provisioning to be provided by Charterer in arrangement with crew. If monetary compensation shall be agreed, then it shall be of no less than €30 per crew member per day. Charterer shall provide crew with sleeping cabin/berth and shower/toilet use to be designated to them onboard. Skippered charters come obligatorily with: Security deposit waiver, non refundable, EUR 400 | No | per day + food | 215,00 € |

Stand up paddle (SUP) (Payable at the base)

No

per week

100,00 €

Season: 2026.

VIP Pack (Payable at the base)

No

per booking

300,00 €

Season: 2026. Airport/Local Base welcome & pickup, transfer to the yacht, welcome pack with sparkling wine & fruits, departure transfer to the local airport



WEBSITE

www.plujeme.cz



PHONE

+420 720 755 085



MOBILE

+420 777 170 276



E-MAIL

info@plujeme.cz



PLUJEME RÁDI S.R.O.

Dlouhá 730/35, 11000 Praha 1 – Staré Město, Czech Republic

ADDITIONAL EXTRAS

| EXTRA | OBLIGATORY | PAYMENT TYPE | PRICE |
|---|------------|------------------|-----------------|
| Automatic Inflatable Life Jacket <i>(Payable at the base)</i> Season: 2026. <i>Payable at the base</i> | No | per week/ person | 20,00 € |
| Beach towel <i>(Payable at the base)</i> Season: 2026. <i>Payable at the base</i> | No | per piece | 10,00 € |
| Extra bedlinen <i>(Payable at the base)</i> Season: 2026. <i>Payable at the base</i> | No | per set | 10,00 € |
| Grill/Barbecue/Plancha <i>(Payable at the base)</i> Season: 2026. <i>portable, 1 x gas bottle included - Payable at the base</i> | No | per week | 80,00 € |
| Kayak <i>(Payable at the base)</i> Season: 2026. <i>Payable at the base</i> | No | per week | 100,00 € |
| Railing net (Safety net) <i>(Payable at the base)</i> Season: 2026. <i>installed - Payable at the base</i> | No | per booking | 200,00 € |
| Stand up paddle (SUP) <i>(Payable at the base)</i> Season: 2026. <i>Payable at the base</i> | No | per week | 100,00 € |



WEBSITE

www.plujeme.cz



E-MAIL

info@plujeme.cz



PHONE

+420 720 755 085



MOBILE

+420 777 170 276



PLUJEME RÁDI S.R.O.

Dlouhá 730/35, 11000 Praha 1 – Staré Město, Czech Republic

PRICE AND AVAILABILITY

| | | | |
|--|--|--|--|
| 20.06. - 27.06.2026 NOT AVAILABLE | 27.06. - 04.07.2026 NOT AVAILABLE | 04.07. - 11.07.2026 4.200 € 6.000 € | 11.07. - 18.07.2026 NOT AVAILABLE |
| 18.07. - 25.07.2026 5.100 € 6.000 € | 25.07. - 01.08.2026 NOT AVAILABLE | 01.08. - 08.08.2026 6.120 € 7.200 € | 08.08. - 15.08.2026 NOT AVAILABLE |
| 15.08. - 29.08.2026 NOT AVAILABLE | 29.08. - 05.09.2026 NOT AVAILABLE | 05.09. - 12.09.2026 NOT AVAILABLE | 12.09. - 19.09.2026 NOT AVAILABLE |
| 19.09. - 26.09.2026 NOT AVAILABLE | 26.09. - 03.10.2026 NOT AVAILABLE | 03.10. - 10.10.2026 NOT AVAILABLE | 10.10. - 17.10.2026 4.320 € 4.800 € |
| 17.10. - 24.10.2026 3.330 € 3.700 € | 24.10. - 31.10.2026 3.330 € 3.700 € | 31.10. - 07.11.2026 3.330 € 3.700 € | 07.11. - 14.11.2026 3.330 € 3.700 € |
| 14.11. - 21.11.2026 3.330 € 3.700 € | 21.11. - 31.12.2026 NOT AVAILABLE | 02.01. - 09.01.2027 2.250 € 2.500 € | 09.01. - 16.01.2027 2.250 € 2.500 € |
| 16.01. - 23.01.2027 2.250 € 2.500 € | 23.01. - 30.01.2027 2.250 € 2.500 € | 30.01. - 06.02.2027 2.250 € 2.500 € | |



WEBSITE

www.plujeme.cz



E-MAIL

info@plujeme.cz



PHONE

+420 720 755 085



MOBILE

+420 777 170 276



PLUJEME RÁDI S.R.O.

Dlouhá 730/35, 11000 Praha 1 – Staré Město, Czech Republic

PRICE AND AVAILABILITY

| | | | |
|--|--|--|--|
| 06.02. - 13.02.2027 2.250 € 2.500 € | 13.02. - 20.02.2027 2.250 € 2.500 € | 20.02. - 27.02.2027 2.250 € 2.500 € | 27.02. - 06.03.2027 2.250 € 2.500 € |
| 06.03. - 13.03.2027 2.250 € 2.500 € | 13.03. - 20.03.2027 2.250 € 2.500 € | 20.03. - 27.03.2027 2.250 € 2.500 € | 27.03. - 03.04.2027 2.250 € 2.500 € |
| 03.04. - 10.04.2027 2.250 € 2.500 € | 10.04. - 17.04.2027 2.250 € 2.500 € | 17.04. - 24.04.2027 2.250 € 2.500 € | 24.04. - 01.05.2027 3.060 € 3.400 € |
| 01.05. - 08.05.2027 3.060 € 3.400 € | 08.05. - 15.05.2027 3.690 € 4.100 € | 15.05. - 22.05.2027 3.690 € 4.100 € | 22.05. - 29.05.2027 4.680 € 5.200 € |
| 29.05. - 12.06.2027 NOT AVAILABLE | 12.06. - 19.06.2027 4.680 € 5.200 € | 19.06. - 26.06.2027 5.400 € 6.000 € | 26.06. - 03.07.2027 5.400 € 6.000 € |
| 03.07. - 10.07.2027 5.400 € 6.000 € | 10.07. - 17.07.2027 5.400 € 6.000 € | 17.07. - 24.07.2027 5.400 € 6.000 € | 24.07. - 31.07.2027 5.400 € 6.000 € |
| 31.07. - 07.08.2027 6.480 € 7.200 € | 07.08. - 14.08.2027 6.480 € 7.200 € | 14.08. - 21.08.2027 6.480 € 7.200 € | 21.08. - 28.08.2027 6.030 € 6.700 € |
| 28.08. - 04.09.2027 6.030 € 6.700 € | 04.09. - 11.09.2027 6.030 € 6.700 € | 11.09. - 18.09.2027 5.850 € 6.500 € | 18.09. - 25.09.2027 5.850 € 6.500 € |
| 25.09. - 02.10.2027 4.770 € 5.300 € | | | |



WEBSITE
www.plujeme.cz



E-MAIL
info@plujeme.cz



PHONE
+420 720 755 085



PLUJEME RÁDI S.R.O.
Dlouhá 730/35, 11000 Praha 1 – Staré Město, Czech Republic



MOBILE
+420 777 170 276

PRICE AND AVAILABILITY

| | | | |
|--|--|--|--|
| 02.10. - 09.10.2027 4.590 € 5.100 € | 09.10. - 16.10.2027 4.320 € 4.800 € | 16.10. - 23.10.2027 3.330 € 3.700 € | 23.10. - 30.10.2027 3.330 € 3.700 € |
| 30.10. - 06.11.2027 3.330 € 3.700 € | 06.11. - 13.11.2027 3.330 € 3.700 € | 13.11. - 20.11.2027 3.330 € 3.700 € | 20.11. - 27.11.2027 3.330 € 3.700 € |
| 27.11. - 04.12.2027 3.330 € 3.700 € | 04.12. - 11.12.2027 3.330 € 3.700 € | 11.12. - 18.12.2027 3.330 € 3.700 € | 18.12. - 25.12.2027 3.330 € 3.700 € |



WEBSITE

www.plujeme.cz



E-MAIL

info@plujeme.cz



PHONE

+420 720 755 085



MOBILE

+420 777 170 276



PLUJEME RÁDI S.R.O.

Dlouhá 730/35, 11000 Praha 1 – Staré Město, Czech Republic