

OCEANIS 51.1

Tsuki (2020)

Sailing yacht Oceanis 51.1 Tsuki, built in 2020 is anchored in the Lavrion - Olympic Marine, Athens area/Saronic/Peloponese, Greece. It has 5 + 1 cabins, can accommodate 10 + 2 people and has 3 + 1 toilets. Bed linen and kitchen equipment are included in the price.

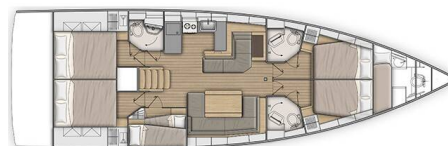

YACHT SPECIFICATIONS

Yacht Base

Lavrion - Olympic Marine, Greece

Yacht ID

4013

Brands

Beneteau

Yacht name

Tsuki

Production year

2020

Length

52 ft

Cabins

5 + 1

Berths

10 + 2

Max Persons

12

WC

3 + 1

Engine

1 x 110 HP

Fuel tank

200l



WEBSITE

www.plujeme.cz



PHONE

+420 720 755 085



MOBILE

+420 777 170 276



E-MAIL

info@plujeme.cz



PLUJEME RÁDI S.R.O.

Dlouhá 730/35, 11000 Praha 1 - Staré Město, Czech Republic

STANDARD YACHT EQUIPMENT

| | |
|-----------------|---|
| Deck | Bimini top, Black ball, Black conus, Boat hook, Cockpit table, Cockpit/stern, outside shower, Dinghy, Dinghy (byboat) pump, Electric anchor windlass, Fenders, Hydraulic lifting swimming platform, Jerry cans for diesel, Main anchor, Mooring ropes, Plastic bucket, Repair box for dinghy, Spare anchor (Reserve, Auxiliary anchor), Sprayhood, Swimming ladder, Water hose |
| Entertainment | Fusion radio, Outdoor speakers |
| Galley | Gas bottles, Hot water, Kitchen utensils (Galley equipment, cutlery), Oven, Refrigerator, Stove |
| Interior | Convertible table in salon, Electric fans in cabins |
| Navigation | Autopilot, Bow thruster, Depthsounder, GPS chart plotter, Speedometer (Speed log), Wind instrument/Anemometer |
| Safety | Distress flare box, Emergency tiller, EPIRB-Distress radio beacons, Fire extinguisher, First aid kit, Flags QNC, Flashlight, Floating light, GMDSS - Global Maritime Distress and Safety System, Life belts (Safety harness), Liferaft, Self inflating life vest, Set of tools, Spare parts, VHF radio, Wire (shroud) cutter |
| Sails | Lazy bag, Lazy jacks |
| Yacht electrics | Air Conditioning, Generator, Inverter |



WEBSITE

www.plujeme.cz



PHONE

+420 720 755 085



MOBILE

+420 777 170 276



E-MAIL

info@plujeme.cz



PLUJEME RÁDI S.R.O.

Dlouhá 730/35, 11000 Praha 1 – Staré Město, Czech Republic

SERVICES

| SELECTED SERVICES | OBLIGATORY | PAYMENT TYPE | PRICE |
|--|------------|--------------------|-------------------|
| Charter package (Payable at the base) Season: 2026. Includes: End Cleaning, Bed linen & towels (one set of bed linen, one pillow case and two towels/person), Extra gas bottle, First and Last night Marina fees | Yes | per booking | 310,00 € |
| Non refundable deposit/ insurance (Payable at the base) Season: 2026. mandatory security deposit insurance (not refundable) to be paid in cash in base + refundable security deposit with MASTER/VISA card or cash + 700 EUR refundable | Yes | per booking | 350,00 € |
| Outboard engine (Payable at the base) Season: 2026. | Yes | per booking | 0,00 € |
| Cook (Payable now) Season: 2026. + own cabin; preparing breakfast & 2 meals/day | No | per week + food | 1.400,00 € |
| Crew change (Payable at the base) Season: 2026. Includes formalities, electricity and water in home base)- does not include cleaning and bed linen/towels | No | per booking / crew | 100,00 € |
| Early boarding/check-in (Payable at the base) Season: 2026. til 14:00h Final confirmation on Embarkation day | No | per booking | 150,00 € |
| Hostess (Payable at the base) Season: 2026. + own cabin; preparing breakfast & one light meal/day | No | per week + food | 1.330,00 € |
| One way fee (Payable at the base) Season: 2026. Prices and terms subject to availability and destination | No | one-way | 0,00 € |
| Safety charter pack (Payable at the base) Season: 2026. includes Safety net and kids' life jacket | No | per booking | 200,00 € |
| Skipper (Payable at the base) Season: 2026. + own bed & food; Payable in cash in base | No | per week + food | 1.470,00 € |
| Sunday Check-in (Payable at the base) Season: 2026. | No | per booking | 70,00 € |
| Transfer (Payable at the base) Season: 2026. Price according to destination | No | one-way | 0,00 € |

WI-FI Internet connection on boat (Payable at the base)

No

per service

80,00 €

Season: 2026. 30 GB Internet connection with router



WEBSITE

www.plujeme.cz



E-MAIL

info@plujeme.cz



PHONE

+420 720 755 085



MOBILE

+420 777 170 276



PLUJEME RÁDI S.R.O.

Dlouhá 730/35, 11000 Praha 1 – Staré Město, Czech Republic

ADDITIONAL EXTRAS

| EXTRA | OBLIGATORY | PAYMENT TYPE | PRICE |
|---|------------|--------------|-----------------|
| Beach towel (Payable at the base) Season: 2026. Payable at the base | No | per piece | 5,00 € |
| Canoe (Payable at the base) Season: 2026. Payable at the base | No | per week | 100,00 € |
| Extra bedlinen and towels (Payable at the base) Season: 2026. 2 bed sheets, pillowcases & 2 towels - Payable at the base | No | per set | 20,00 € |
| Gennaker (Payable at the base) Season: 2026. + 400 EUR extra security deposit; if available - Payable at the base | No | per day | 35,00 € |
| Grill/Barbecue/Plancha (Payable at the base) Season: 2026. gas operated - Payable at the base | No | per week | 60,00 € |
| Snorkeling equipment (Payable at the base) Season: 2026. Payable at the base | No | per set | 10,00 € |
| Stand up paddle (SUP) (Payable at the base) Season: 2026. +200 EUR Extra security deposit - Payable at the base | No | per week | 110,00 € |



WEBSITE

www.plujeme.cz



PHONE

+420 720 755 085



MOBILE

+420 777 170 276



E-MAIL

info@plujeme.cz



PLUJEME RÁDI S.R.O.

Dlouhá 730/35, 11000 Praha 1 – Staré Město, Czech Republic

PRICE AND AVAILABILITY

| | | | |
|--|--|--|--|
| 13.06. - 20.06.2026 NOT AVAILABLE | 20.06. - 27.06.2026 NOT AVAILABLE | 27.06. - 04.07.2026 NOT AVAILABLE | 04.07. - 11.07.2026 4.650 € 6.200 € |
| 11.07. - 18.07.2026 NOT AVAILABLE | 18.07. - 25.07.2026 NOT AVAILABLE | 25.07. - 01.08.2026 4.875 € 6.500 € | 01.08. - 15.08.2026 NOT AVAILABLE |
| 15.08. - 22.08.2026 4.875 € 6.500 € | 22.08. - 29.08.2026 NOT AVAILABLE | 29.08. - 05.09.2026 4.452 € 6.360 € | 05.09. - 12.09.2026 NOT AVAILABLE |
| 12.09. - 19.09.2026 NOT AVAILABLE | 19.09. - 26.09.2026 NOT AVAILABLE | 26.09. - 03.10.2026 NOT AVAILABLE | 03.10. - 10.10.2026 NOT AVAILABLE |
| 10.10. - 14.10.2026 NOT AVAILABLE | 17.10. - 24.10.2026 2.850 € 3.800 € | 24.10. - 31.10.2026 2.850 € 3.800 € | 31.10. - 07.11.2026 2.850 € 3.800 € |
| 08.11. - 31.12.2026 NOT AVAILABLE | | | |



WEBSITE

www.plujeme.cz



E-MAIL

info@plujeme.cz



PHONE

+420 720 755 085



MOBILE

+420 777 170 276



PLUJEME RÁDI S.R.O.

Dlouhá 730/35, 11000 Praha 1 – Staré Město, Czech Republic