

OCEANIS 46.1

Joanna (2022)

Sailing yacht Oceanis 46.1 Joanna, built in 2022 is anchored in the **Volos, Skiathos/Sporades, Volos, Greece**. It has **4 cabins**, can accommodate **8 people** and has **4 toilets**. Bed linen and kitchen equipment are included in the price.

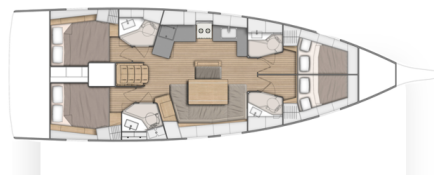

YACHT SPECIFICATIONS

Yacht Base

Volos, Greece

Yacht ID

4010

Brands

Beneteau

Yacht name

Joanna

Production year

2022

Length

48 ft

Cabins

4

Berths

8

WC

4

Engine

1 x 80 HP

Fuel tank

200 l



WEBSITE

www.plujeme.cz



PHONE

+420 720 755 085



MOBILE

+420 777 170 276



E-MAIL

info@plujeme.cz



PLUJEME RÁDI S.R.O.

Dlouhá 730/35, 11000 Praha 1 – Staré Město, Czech Republic

STANDARD YACHT EQUIPMENT

| | |
|-----------------|---|
| Comfort | Cockpit cushions |
| Deck | Bimini top, Black ball, Cockpit table, Fenders, Sprayhood |
| Entertainment | Indoor speakers, Radio CD mp3 player + USB |
| Galley | Stove |
| Interior | Electric fans in cabins, Electric toilet |
| Navigation | Autopilot, Bow thruster, Echosounder/Depthsounder, Electronic sea charts, GPS, GPS chart plotter, Nautical charts, Pilot book, Speedometer (Speed log), Wind instrument/Anemometer |
| Safety | Distress flare box, Emergency tiller, EPIRB-Distress radio beacons, Fire blanket, First aid kit, Flags QNC, Floating light, Fog horn, Life belts (Safety harness), Life jackets, Liferaft, VHF radio, Wire (shroud) cutter |
| Sails | Electric winch |
| Yacht electrics | 220V socket, Battery charger, Solar panels, USB charger for mobile phone and laptop |



WEBSITE

www.plujeme.cz



E-MAIL

info@plujeme.cz



PHONE

+420 720 755 085



MOBILE

+420 777 170 276



PLUJEME RÁDI S.R.O.

Dlouhá 730/35, 11000 Praha 1 – Staré Město, Czech Republic

SERVICES

| SELECTED SERVICES | OBLIGATORY | PAYMENT TYPE | PRICE |
|---|------------|----------------|-----------------|
| Security Deposit Waiver (Payable at the base) Season: 2026. 200 EUR credit voucher for the next charter in case of no damage/loss upon redelivery. No cash refund. | Yes | per booking | 400,00 € |
| Standard Charter Pack (Payable at the base) Season: 2026. Welcome kit | Yes | per booking | 230,00 € |
| Beach towel (Payable at the base) Season: 2026. | No | per booking | 10,00 € |
| Berth cost (Payable at the base) Season: 2026. Berthing fees for first & last night at the marina/port | No | per booking | 0,00 € |
| Cabin conversion (Payable at the base) Season: 2026. If possible on yacht. Contact fleet operator for more information. | No | per booking | 150,00 € |
| Cook (Payable at the base) Season: 2026. Crew provisioning to be provided by Charterer in arrangement with crew. If monetary compensation shall be agreed, then it shall be of no less than €30 per crew member per day. Charterer shall provide crew with sleeping cabin/berth and shower/toilet use to be designated to them onboard. | No | per day + food | 215,00 € |
| Family pack (Payable at the base) Season: 2026. Safety net, SUP, junior life jackets, normal foam type | No | per booking | 350,00 € |
| Fast Track pack (Payable at the base) Season: 2026. Access to the yacht by 14:00h on embarkation day, only IF feasible | No | per booking | 200,00 € |
| Hostess (Payable at the base) Season: 2026. Crew provisioning to be provided by Charterer in arrangement with crew. If monetary compensation shall be agreed, then it shall be of no less than €30 per crew member per day. Charterer shall provide crew with sleeping cabin/berth and shower/toilet use to be designated to them onboard. | No | per day + food | 180,00 € |

| | | | |
|---|----|----------------|-------------------|
| Internet pack (Payable at the base) Season: 2026. Wi-Fi router for Internet aboard (subject to GSM coverage up to 10GB/week) | No | per week | 50,00 € |
| One way fee (Payable at the base) Season: 2026. Volos-Skiathos | No | per booking | 300,00 € |
| One way fee (Payable at the base) Season: 2026. Preveza-Lefkas | No | per booking | 300,00 € |
| One way fee (Payable at the base) Season: 2026. Athens-Lavrion | No | per booking | 500,00 € |
| One way fee (Payable at the base) Season: 2026. Athens-Cyclades/Sporades | No | per booking | 1.000,00 € |
| One way fee (Payable at the base) Season: 2026. Athens-Dodecanese | No | per booking | 1.200,00 € |
| One way fee (Payable at the base) Season: 2026. Kos-Rhodos | No | per booking | 600,00 € |
| One way fee (Payable at the base) Season: 2026. Lefkas/Preveza-Corfu | No | per booking | 600,00 € |
| One way fee (Payable at the base) Season: 2026. Athens-Lefkas-Preveza | No | per booking | 1.200,00 € |
| One way fee (Payable at the base) Season: 2026. Athens-Corfu | No | per booking | 1.400,00 € |
| Overnight on board (Payable at the base) Season: 2026. Embarkation on yacht & overnight stay the day before charter starts, check-in by 13:00h on charter start day. Subject to last minute availability of yacht on previous day. | No | per booking | 180,00 € |
| Pet on board (Payable at the base) Season: 2026. up to 7 kg | No | per booking | 200,00 € |
| Skipper (Payable at the base) Season: 2026. Crew provisioning to be provided by Charterer in arrangement with crew. If monetary compensation shall be agreed, then it shall be of no less than €30 per crew member per day. Charterer shall provide crew with sleeping cabin/berth and shower/toilet use to be designated to them onboard. Skippered charters come obligatorily with: Security deposit waiver, non refundable, EUR 400 | No | per day + food | 215,00 € |

Stand up paddle (SUP) (Payable at the base)

No

per week

100,00 €

Season: 2026.

VIP Pack (Payable at the base)

No

per booking

300,00 €

Season: 2026. Airport/Local Base welcome & pickup, transfer to the yacht, welcome pack with sparkling wine & fruits, departure transfer to the local airport



WEBSITE

www.plujeme.cz



PHONE

+420 720 755 085



MOBILE

+420 777 170 276



E-MAIL

info@plujeme.cz



PLUJEME RÁDI S.R.O.

Dlouhá 730/35, 11000 Praha 1 – Staré Město, Czech Republic

ADDITIONAL EXTRAS

| EXTRA | OBLIGATORY | PAYMENT TYPE | PRICE |
|--|------------|------------------|-----------------|
| Automatic Inflatable Life Jacket (Payable at the base) <i>Season: 2026. Payable at the base</i> | No | per week/ person | 20,00 € |
| Beach towel (Payable at the base) <i>Season: 2026. Payable at the base</i> | No | per piece | 10,00 € |
| Blister (Payable at the base) <i>Season: 2026. + extra security deposit 500 EUR (refundable) - Payable at the base</i> | No | per week | 250,00 € |
| Extra bedlinen (Payable at the base) <i>Season: 2026. Payable at the base</i> | No | per set | 10,00 € |
| Gennaker (Payable at the base) <i>Season: 2026. + extra security deposit 500 EUR (refundable) - Payable at the base</i> | No | per week | 200,00 € |
| Grill/Barbecue/Plancha (Payable at the base) <i>Season: 2026. portable, 1x gas bottle included - Payable at the base</i> | No | per week | 80,00 € |
| Kayak (Payable at the base) <i>Season: 2026. Payable at the base</i> | No | per week | 100,00 € |
| Railing net (Safety net) (Payable at the base) <i>Season: 2026. installed - Payable at the base</i> | No | per booking | 200,00 € |
| Stand up paddle (SUP) (Payable at the base) <i>Season: 2026. Payable at the base</i> | No | per week | 100,00 € |



WEBSITE
www.plujeme.cz



E-MAIL
info@plujeme.cz



PHONE
+420 720 755 085



PLUJEME RÁDI S.R.O.
Dlouhá 730/35, 11000 Praha 1 – Staré Město, Czech Republic



MOBILE
+420 777 170 276

PRICE AND AVAILABILITY

| | | | |
|---|---|---|---|
| 25.04. - 02.05.2026 2.325 € 3.100 € | 02.05. - 09.05.2026 2.325 € 3.100 € | 09.05. - 16.05.2026 NOT AVAILABLE | 16.05. - 23.05.2026 NOT AVAILABLE |
| 23.05. - 30.05.2026 NOT AVAILABLE | 30.05. - 06.06.2026 3.995 € 4.700 € | 06.06. - 13.06.2026 4.463 € 5.250 € | 13.06. - 20.06.2026 NOT AVAILABLE |
| 20.06. - 27.06.2026 5.058 € 5.950 € | 27.06. - 04.07.2026 5.058 € 5.950 € | 04.07. - 11.07.2026 5.058 € 5.950 € | 11.07. - 18.07.2026 5.058 € 5.950 € |
| 18.07. - 25.07.2026 NOT AVAILABLE | 25.07. - 01.08.2026 5.058 € 5.950 € | 01.08. - 08.08.2026 5.695 € 6.700 € | 08.08. - 15.08.2026 5.695 € 6.700 € |
| 15.08. - 22.08.2026 5.695 € 6.700 € | 22.08. - 05.09.2026 NOT AVAILABLE | 05.09. - 12.09.2026 NOT AVAILABLE | 12.09. - 19.09.2026 5.490 € 6.100 € |
| 19.09. - 26.09.2026 5.220 € 5.800 € | 26.09. - 03.10.2026 NOT AVAILABLE | 03.10. - 10.10.2026 3.960 € 4.400 € | 10.10. - 17.10.2026 3.690 € 4.100 € |
| 17.10. - 24.10.2026 3.150 € 3.500 € | 24.10. - 31.10.2026 NOT AVAILABLE | 31.10. - 07.11.2026 3.150 € 3.500 € | 07.11. - 14.11.2026 3.150 € 3.500 € |
| 14.11. - 21.11.2026 3.150 € 3.500 € | 21.11. - 31.12.2026 NOT AVAILABLE | | |



WEBSITE

www.plujeme.cz



E-MAIL

info@plujeme.cz



PHONE

+420 720 755 085



MOBILE

+420 777 170 276



PLUJEME RÁDI S.R.O.

Dlouhá 730/35, 11000 Praha 1 – Staré Město, Czech Republic

PRICE AND AVAILABILITY

| | | | |
|--|--|--|--|
| 02.01. - 09.01.2027 2.070 € 2.300 € | 09.01. - 16.01.2027 2.070 € 2.300 € | 16.01. - 23.01.2027 2.070 € 2.300 € | 23.01. - 30.01.2027 2.070 € 2.300 € |
| 30.01. - 06.02.2027 2.070 € 2.300 € | 06.02. - 13.02.2027 2.070 € 2.300 € | 13.02. - 20.02.2027 2.070 € 2.300 € | 20.02. - 27.02.2027 2.070 € 2.300 € |
| 27.02. - 06.03.2027 2.070 € 2.300 € | 06.03. - 13.03.2027 2.070 € 2.300 € | 13.03. - 20.03.2027 2.070 € 2.300 € | 20.03. - 27.03.2027 2.070 € 2.300 € |
| 27.03. - 03.04.2027 2.070 € 2.300 € | 03.04. - 10.04.2027 2.070 € 2.300 € | 10.04. - 17.04.2027 2.070 € 2.300 € | 17.04. - 24.04.2027 2.070 € 2.300 € |
| 24.04. - 01.05.2027 2.790 € 3.100 € | 01.05. - 08.05.2027 2.790 € 3.100 € | 08.05. - 15.05.2027 3.420 € 3.800 € | 15.05. - 22.05.2027 3.420 € 3.800 € |
| 22.05. - 29.05.2027 4.230 € 4.700 € | 29.05. - 05.06.2027 4.230 € 4.700 € | 05.06. - 12.06.2027 4.725 € 5.250 € | 12.06. - 19.06.2027 4.725 € 5.250 € |
| 19.06. - 26.06.2027 5.355 € 5.950 € | 26.06. - 03.07.2027 5.355 € 5.950 € | 03.07. - 10.07.2027 5.355 € 5.950 € | 10.07. - 17.07.2027 5.355 € 5.950 € |
| 17.07. - 24.07.2027 5.355 € 5.950 € | 24.07. - 31.07.2027 5.355 € 5.950 € | 31.07. - 07.08.2027 6.030 € 6.700 € | |



WEBSITE

www.plujeme.cz



E-MAIL

info@plujeme.cz



PHONE

+420 720 755 085



MOBILE

+420 777 170 276



PLUJEME RÁDI S.R.O.

Dlouhá 730/35, 11000 Praha 1 – Staré Město, Czech Republic

PRICE AND AVAILABILITY

| | | | |
|---|---|---|---|
| 07.08. - 14.08.2027 6.030 € 6.700 € | 14.08. - 21.08.2027 6.030 € 6.700 € | 21.08. - 28.08.2027 5.490 € 6.100 € | 28.08. - 04.09.2027 5.490 € 6.100 € |
| 04.09. - 11.09.2027 5.490 € 6.100 € | 11.09. - 18.09.2027 5.490 € 6.100 € | 18.09. - 25.09.2027 5.220 € 5.800 € | 25.09. - 02.10.2027 4.230 € 4.700 € |
| 02.10. - 09.10.2027 3.960 € 4.400 € | 09.10. - 16.10.2027 3.690 € 4.100 € | 16.10. - 23.10.2027 3.150 € 3.500 € | 23.10. - 30.10.2027 3.150 € 3.500 € |
| 30.10. - 06.11.2027 3.150 € 3.500 € | 06.11. - 13.11.2027 3.150 € 3.500 € | 13.11. - 20.11.2027 3.150 € 3.500 € | 20.11. - 27.11.2027 3.150 € 3.500 € |
| 27.11. - 04.12.2027 3.150 € 3.500 € | 04.12. - 11.12.2027 3.150 € 3.500 € | 11.12. - 18.12.2027 3.150 € 3.500 € | 18.12. - 25.12.2027 3.150 € 3.500 € |



WEBSITE

www.plujeme.cz



E-MAIL

info@plujeme.cz



PHONE

+420 720 755 085



MOBILE

+420 777 170 276



PLUJEME RÁDI S.R.O.

Dlouhá 730/35, 11000 Praha 1 – Staré Město, Czech Republic