

# FOUNTAIN PAJOT ASTREA 42

Reina (2022)

Catamaran Fountaine Pajot Astrea 42 Reina, built in 2022 is anchored in the **Fethiye, Yacht Classic Hotel Marina, Aegean, Turkey**. It has **4 + 2 cabins**, can accommodate **8 + 2 people** and has **4 toilets**. Bed linen and kitchen equipment are included in the price.

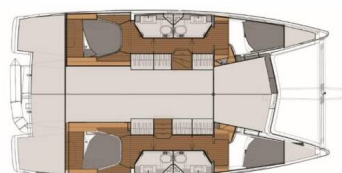

## YACHT SPECIFICATIONS

Yacht Base

**Fethiye, Yacht Classic Hotel Marina,  
Turkey**

Yacht ID

**3948**

Brands

**Fountaine Pajot**

Yacht name

**Reina**

Production year

**2022**

Length

**41 ft**

Cabins

**4 + 2**

Berths

**8 + 2**

Max Persons

**10**

WC

**4**

Engine

**2 x 30 HP**

Fuel tank

**470 l**



**WEBSITE**

[www.plujeme.cz](http://www.plujeme.cz)



**PHONE**

+420 720 755 085



**MOBILE**

+420 777 170 276



**E-MAIL**

[info@plujeme.cz](mailto:info@plujeme.cz)



**PLUJEME RÁDI S.R.O.**

Dlouhá 730/35, 11000 Praha 1 – Staré Město, Czech Republic

## STANDARD YACHT EQUIPMENT

Comfort	<b>Cockpit cushions</b>
Deck	<b>Anchor swivel, Anchor with chain, Dinghy, Gangway, Outboard engine</b>
Entertainment	<b>Portable Bluetooth speaker</b>
Galley	<b>Freezer, Hot water, Oven, Refrigerator</b>
Interior	<b>Barometer, Thermometer</b>
Navigation	<b>Autopilot, GPS chart plotter, Navigation (Nautical) charts and nautical guide, Pilot book, Wind/speed/depth instruments</b>
Safety	<b>Automatic Inflatable Life Jacket, Life jacket (children), Liferaft, VHF radio</b>
Yacht electrics	<b>Air Conditioning, Battery charger, Generator, Heating, Inverter, Solar panels, Watermaker - desalinator</b>



#### WEBSITE

[www.plujeme.cz](http://www.plujeme.cz)



#### E-MAIL

[info@plujeme.cz](mailto:info@plujeme.cz)



#### PHONE

+420 720 755 085



#### MOBILE

+420 777 170 276



#### PLUJEME RÁDI S.R.O.

Dlouhá 730/35, 11000 Praha 1 – Staré Město, Czech Republic

## SERVICES

SELECTED SERVICES	OBLIGATORY	PAYMENT TYPE	PRICE
<b>Charter package</b> (Payable at the base) <b>Season: 2026.</b> Includes: Transit log, Cleaning, LPG Gas Bottle, Inverter, Bed linen, Blanket, Towels, Salt, Black Paper, Thyme, Chili Paper, Liquid Hand Soap, Dish soap, WC Paper;	Yes	per booking	<b>450,00 €</b>
<b>Early Check in</b> (Payable at the base) <b>Season: 2026.</b>	No	per booking	<b>150,00 €</b>
<b>Extra cleaning</b> (Payable at the base) <b>Season: 2026.</b>	No	per booking	<b>70,00 €</b>
<b>Hostess/Cook</b> (Payable at the base) <b>Season: 2026.</b> + cabin	No	per day + food	<b>180,00 €</b>
<b>Provisioning</b> (Payable at the base) <b>Season: 2026.</b> On Request	No	per booking	<b>0,00 €</b>
<b>Refuel service</b> (Payable at the base) <b>Season: 2026.</b> + cost of diesel	No	per service	<b>50,00 €</b>
<b>Skipper</b> (Payable at the base) <b>Season: 2026.</b> + cabin	No	per day + food	<b>200,00 €</b>
<b>Smaller safety deposit</b> (Payable at the base) <b>Season: 2026.</b> Security deposit can be reduced to 20% (of it's original value) with a non-refundable payment of 10% of deposit. Does not cover: dinghy, outboard, anchor, chain and sails.	No	per booking	<b>0,00 €</b>
<b>Transfer</b> (Payable at the base) <b>Season: 2026.</b> DALAMAN-GÖÇEK (1-6 pax)	No	one-way	<b>70,00 €</b>
<b>Transfer</b> (Payable at the base) <b>Season: 2026.</b> DALAMAN-FETHİYE (1-6 pax)	No	one-way	<b>75,00 €</b>
<b>Transfer</b> (Payable at the base) <b>Season: 2026.</b> DALAMAN-ÖLÜDENİZ (1-6 pax)	No	one-way	<b>85,00 €</b>
<b>Transfer</b> (Payable at the base) <b>Season: 2026.</b> DALAMAN-MARMARİS (1-6 pax)	No	one-way	<b>95,00 €</b>

<b>Transfer</b> (Payable at the base) <b>Season: 2026.</b> DALAMAN-GÖÇEK (7-13 pax)	No	one-way	<b>100,00 €</b>
<b>Transfer</b> (Payable at the base) <b>Season: 2026.</b> DALAMAN-FETHİYE (7-13 pax)	No	one-way	<b>120,00 €</b>
<b>Transfer</b> (Payable at the base) <b>Season: 2026.</b> DALAMAN-ÖLÜDENİZ (7-13 pax)	No	one-way	<b>120,00 €</b>
<b>Transfer</b> (Payable at the base) <b>Season: 2026.</b> DALAMAN-MARMARİS (7-13 pax)	No	one-way	<b>150,00 €</b>
<b>Transfer</b> (Payable at the base) <b>Season: 2026.</b> FETHİYE - MARMARİS (1-6 pax)	No	one-way	<b>180,00 €</b>
<b>Transfer</b> (Payable at the base) <b>Season: 2026.</b> DALAMAN - KAŞ (1-6 pax)	No	one-way	<b>180,00 €</b>
<b>Transfer</b> (Payable at the base) <b>Season: 2026.</b> DALAMAN - D MARİS (1-6 pax)	No	one-way	<b>200,00 €</b>
<b>Transfer</b> (Payable at the base) <b>Season: 2026.</b> ANTALYA-FETHİYE (1-6 pax)	No	one-way	<b>230,00 €</b>
<b>Transfer</b> (Payable at the base) <b>Season: 2026.</b> DALAMAN - KEKOVA (1-6 pax)	No	one-way	<b>230,00 €</b>
<b>Transfer</b> (Payable at the base) <b>Season: 2026.</b> FETHİYE - MARMARİS (7-13 pax)	No	one-way	<b>230,00 €</b>
<b>Transfer</b> (Payable at the base) <b>Season: 2026.</b> DALAMAN - BOZBURUN (1-6 pax)	No	one-way	<b>240,00 €</b>
<b>Transfer</b> (Payable at the base) <b>Season: 2026.</b> BODRUM Airport - FETHİYE (1-6 pax)	No	one-way	<b>240,00 €</b>
<b>Transfer</b> (Payable at the base) <b>Season: 2026.</b> DALAMAN - KAŞ (7-13 pax)	No	one-way	<b>270,00 €</b>
<b>Transfer</b> (Payable at the base) <b>Season: 2026.</b> DALAMAN - D MARİS (7-13 pax)	No	one-way	<b>280,00 €</b>
<b>Transfer</b> (Payable at the base) <b>Season: 2026.</b> BODRUM Center - FETHİYE (1-6 pax)	No	one-way	<b>290,00 €</b>

<b>Transfer</b> (Payable at the base) <b>Season: 2026.</b> DALAMAN - KEKOVA (7-13 pax)	No	one-way	<b>300,00 €</b>
<b>Transfer</b> (Payable at the base) <b>Season: 2026.</b> FETHİYE - SİDE/KEMER (1-6 pax)	No	one-way	<b>300,00 €</b>
<b>Transfer</b> (Payable at the base) <b>Season: 2026.</b> FETHİYE - PAMUKKALE (1-6 pax)	No	one-way	<b>300,00 €</b>
<b>Transfer</b> (Payable at the base) <b>Season: 2026.</b> DALAMAN - BOZBURUN (7-13 pax)	No	one-way	<b>300,00 €</b>
<b>Transfer</b> (Payable at the base) <b>Season: 2026.</b> İZMİR Airport - FETHİYE (1-6 pax)	No	one-way	<b>350,00 €</b>
<b>Transfer</b> (Payable at the base) <b>Season: 2026.</b> ANTALYA-FETHİYE (7-13 pax)	No	one-way	<b>350,00 €</b>
<b>Transfer</b> (Payable at the base) <b>Season: 2026.</b> BODRUM Airport - FETHİYE (7-13 pax)	No	one-way	<b>350,00 €</b>
<b>Transfer</b> (Payable at the base) <b>Season: 2026.</b> FETHİYE - PAMUKKALE (7-13 pax)	No	one-way	<b>390,00 €</b>
<b>Transfer</b> (Payable at the base) <b>Season: 2026.</b> İZMİR Airport - FETHİYE (7-13 pax)	No	one-way	<b>400,00 €</b>
<b>Transfer</b> (Payable at the base) <b>Season: 2026.</b> FETHİYE - SİDE/KEMER (7-13 pax)	No	one-way	<b>400,00 €</b>
<b>Transfer</b> (Payable at the base) <b>Season: 2026.</b> BODRUM Center - FETHİYE (7-13 pax)	No	one-way	<b>400,00 €</b>
<b>Transitlog to Greece</b> (Payable at the base) <b>Season: 2026.</b>	No	per booking	<b>300,00 €</b>
<b>WI-FI Internet connection on boat</b> (Payable at the base) <b>Season: 2026.</b> 50Gb	No	per service	<b>50,00 €</b>
<b>WI-FI Internet connection on boat</b> (Payable at the base) <b>Season: 2026.</b> unlimited	No	per week	<b>100,00 €</b>



**WEBSITE**  
www.plujeme.cz



**PHONE**  
+420 720 755 085



**MOBILE**  
+420 777 170 276



**E-MAIL**  
info@plujeme.cz



**PLUJEME RÁDI S.R.O.**  
Dlouhá 730/35, 11000 Praha 1 - Staré Město, Czech Republic

## ADDITIONAL EXTRAS

EXTRA	OBLIGATORY	PAYMENT TYPE	PRICE
<b>Additional gas bottle</b> (Payable at the base) <b>Season: 2026.</b> Payable at the base	No	per bottle	<b>10,00 €</b>
<b>Coffee capsules</b> (Payable at the base) <b>Season: 2026.</b> Ask for yacht compatibility. - Payable at the base	No	per booking	<b>60,00 €</b>
<b>Electrical filter coffee maker</b> (Payable at the base) <b>Season: 2026.</b> Ask for yacht compatibility. - Payable at the base	No	per booking	<b>30,00 €</b>
<b>Extra bedlinen</b> (Payable at the base) <b>Season: 2026.</b> Payable at the base	No	per set	<b>10,00 €</b>
<b>Extra towels</b> (Payable at the base) <b>Season: 2026.</b> Payable at the base	No	per set	<b>5,00 €</b>
<b>Ice maker</b> (Payable at the base) <b>Season: 2026.</b> Payable at the base	No	per week	<b>60,00 €</b>
<b>Railing net (Safety net)</b> (Payable at the base) <b>Season: 2026.</b> Payable at the base	No	per booking	<b>100,00 €</b>
<b>Sea Scooter</b> (Payable at the base) <b>Season: 2026.</b> Payable at the base	No	per week	<b>150,00 €</b>
<b>Stand up paddle (SUP)</b> (Payable at the base) <b>Season: 2026.</b> Payable at the base	No	per week	<b>100,00 €</b>



**WEBSITE**  
www.plujeme.cz



**PHONE**  
+420 720 755 085



**MOBILE**  
+420 777 170 276



**E-MAIL**  
info@plujeme.cz



**PLUJEME RÁDI S.R.O.**  
Dlouhá 730/35, 11000 Praha 1 – Staré Město, Czech Republic

## PRICE AND AVAILABILITY

06.06. - 13.06.2026 NOT AVAILABLE	13.06. - 20.06.2026 5.990 € 8.090 €	20.06. - 04.07.2026 NOT AVAILABLE	04.07. - 11.07.2026 6.390 € 8.090 €
11.07. - 18.07.2026 NOT AVAILABLE	18.07. - 25.07.2026 6.390 € 8.090 €	25.07. - 01.08.2026 6.389 € 8.090 €	01.08. - 08.08.2026 6.472 € 8.090 €
08.08. - 22.08.2026 NOT AVAILABLE	22.08. - 29.08.2026 6.632 € 8.290 €	29.08. - 05.09.2026 6.632 € 8.290 €	05.09. - 12.09.2026 6.632 € 8.290 €
12.09. - 19.09.2026 6.490 € 8.290 €	19.09. - 26.09.2026 NOT AVAILABLE	26.09. - 03.10.2026 6.632 € 8.290 €	03.10. - 10.10.2026 6.489 € 8.290 €
10.10. - 17.10.2026 6.290 € 8.290 €	17.10. - 24.10.2026 6.290 € 8.290 €	24.10. - 31.10.2026 5.791 € 8.290 €	31.10. - 07.11.2026 4.790 € 6.490 €
07.11. - 14.11.2026 4.290 € 6.490 €	14.11. - 21.11.2026 3.990 € 6.490 €	21.11. - 28.11.2026 3.990 € 6.490 €	28.11. - 05.12.2026 3.990 € 6.490 €
05.12. - 12.12.2026 3.990 € 6.490 €	12.12. - 19.12.2026 3.990 € 6.490 €	19.12. - 26.12.2026 3.990 € 6.490 €	



WEBSITE

[www.plujeme.cz](http://www.plujeme.cz)



E-MAIL

[info@plujeme.cz](mailto:info@plujeme.cz)



PHONE

+420 720 755 085



MOBILE

+420 777 170 276



PLUJEME RÁDI S.R.O.

Dlouhá 730/35, 11000 Praha 1 – Staré Město, Czech Republic