

# OCEANIS 38.1

Dancefloor (2023)

Sailing yacht **Oceanis 38.1 Dancefloor**, built in **2023** is anchored in the **Fethiye, Ece Saray Marina Resort, Aegean, Turkey**. It has **3 cabins**, can accommodate **6 people** and has **2 toilets**. Bed linen and kitchen equipment are included in the price.

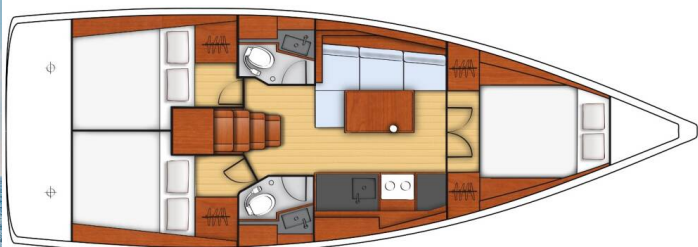

## YACHT SPECIFICATIONS

Yacht Base

**Fethiye, Ece Saray Marina Resort,  
Turkey**

Yacht ID

**3895**

Brands

**Beneteau**

Yacht name

**Dancefloor**

Production year

**2023**

Length

**38 ft**

Cabins

**3**

Berths

**6**

Max Persons

**6**

WC

**2**

Engine

**1 x 40 HP**

Fuel tank

**130 l**



**WEBSITE**

[www.plujeme.cz](http://www.plujeme.cz)



**PHONE**

+420 720 755 085



**MOBILE**

+420 777 170 276



**E-MAIL**

[info@plujeme.cz](mailto:info@plujeme.cz)



**PLUJEME RÁDI S.R.O.**

Dlouhá 730/35, 11000 Praha 1 – Staré Město, Czech Republic

## STANDARD YACHT EQUIPMENT

Comfort	<b>Bed linen, Towels</b>
Deck	<b>Bimini top, Boat hook, Cockpit/stern, outside shower, Dinghy, Electric anchor windlass, Fenders, Sprayhood</b>
Entertainment	<b>Radio CD mp3 player</b>
Galley	<b>Gas cookers, Hot water, Kitchen utensils (Galley equipment, cutlery), Oven, Refrigerator</b>
Interior	<b>Inside shower</b>
Navigation	<b>Autopilot, Compass, GPS, GPS chart plotter, Log, Speed, Depth- echo sounder, Navigation (Nautical) charts and nautical guide, Radar reflector, Wind instrument/Anemometer</b>
Safety	<b>Distress signals, Emergency tiller, Fire extinguisher, First aid kit, Life jackets, Lifelines, Liferaft, VHF radio</b>
Sails	<b>Rodkick</b>
Yacht electrics	<b>Batteries, Bilge pump - Electric, DSC station, Heating, Inverter, Solar panels</b>



**WEBSITE**  
[www.plujeme.cz](http://www.plujeme.cz)



**E-MAIL**  
[info@plujeme.cz](mailto:info@plujeme.cz)



**PHONE**  
+420 720 755 085



**PLUJEME RÁDI S.R.O.**  
Dlouhá 730/35, 11000 Praha 1 – Staré Město, Czech Republic



**MOBILE**  
+420 777 170 276

## SERVICES

SELECTED SERVICES	OBLIGATORY	PAYMENT TYPE	PRICE
<b>Service Pack</b> (Payable at the base) <b>Season: 2026.</b> Transit Log - Cleaning - Two Gas Bottles - Bed Linen - Bath, Face and Beach towels	Yes	per booking	<b>350,00 €</b>
<b>Cook</b> (Payable at the base) <b>Season: 2026.</b> + own cabin	No	per day + food	<b>180,00 €</b>
<b>Deckhand/ Marinero</b> (Payable at the base) <b>Season: 2026.</b> + own cabin	No	per day + food	<b>125,00 €</b>
<b>Early Check in</b> (Payable at the base) <b>Season: 2026.</b> By 13:00h	No	per booking	<b>150,00 €</b>
<b>Fun Pack</b> (Payable at the base) <b>Season: 2026.</b> Price evaluation will be made based on group or person. Daily diving session private or in small group, all necessary diving clothes and equipment are included	No	per booking	<b>0,00 €</b>
<b>Hostess</b> (Payable at the base) <b>Season: 2026.</b> + own cabin	No	per day + food	<b>120,00 €</b>
<b>Overnight on board</b> (Payable at the base) <b>Season: 2026.</b> Embarkation on yacht & overnight stay the day before charter starts, Check-in by 11:00 hrs on charter start day Subject to last minute availability of yacht on previous day	No	per booking	<b>200,00 €</b>
<b>Pet on board</b> (Payable at the base) <b>Season: 2026.</b> up to 7kg	No	per booking	<b>150,00 €</b>
<b>Provisioning</b> (Payable at the base) <b>Season: 2026.</b>	No	per week	<b>200,00 €</b>
<b>Skipper</b> (Payable at the base) <b>Season: 2026.</b> + own cabin	No	per day + food	<b>200,00 €</b>
<b>Transfer</b> (Payable at the base) <b>Season: 2026.</b> Transfer Dalaman – Fethiye 1-4 person	No	one-way	<b>45,00 €</b>
<b>Transfer</b> (Payable at the base) <b>Season: 2026.</b> Transfer Dalaman – Fethiye 5-9 persons	No	one-way	<b>80,00 €</b>

<b>Transfer</b> (Payable at the base) <b>Season: 2026.</b> Transfer Damalan – Orhaniye 1-5 persons	No	one-way	<b>120,00 €</b>
<b>Transfer</b> (Payable at the base) <b>Season: 2026.</b> Transfer Damalan – Orhaniye 6-11 persons	No	one-way	<b>160,00 €</b>
<b>WI-FI Internet connection on boat</b> (Payable at the base) <b>Season: 2026.</b> Superbox Unlimited	No	per week	<b>100,00 €</b>



**WEBSITE**  
www.plujeme.cz



**E-MAIL**  
info@plujeme.cz



**PHONE**  
+420 720 755 085



**MOBILE**  
+420 777 170 276



**PLUJEME RÁDI S.R.O.**  
Dlouhá 730/35, 11000 Praha 1 – Staré Město, Czech Republic

## ADDITIONAL EXTRAS

EXTRA	OBLIGATORY	PAYMENT TYPE	PRICE
<b>eFoil</b> (Payable at the base) <b>Season: 2026.</b> Deposit 1500 EUR, availability to be confirmed at the base - Payable at the base	No	per week	<b>1.500,00 €</b>
<b>Extra bedlinen</b> (Payable at the base) <b>Season: 2026.</b> includes: one linen, 2 pillowcases, 1 bedcover - Payable at the base	No	per set	<b>20,00 €</b>
<b>Extra towels</b> (Payable at the base) <b>Season: 2026.</b> Payable at the base	No	per set	<b>5,00 €</b>
<b>Fishing trolling package</b> (Payable at the base) <b>Season: 2026.</b> availability to be confirmed at the base - Payable at the base	No	per week	<b>100,00 €</b>
<b>Ice maker</b> (Payable at the base) <b>Season: 2026.</b> availability to be confirmed at the base - Payable at the base	No	per week	<b>100,00 €</b>
<b>Karaoke</b> (Payable at the base) <b>Season: 2026.</b> availability to be confirmed at the base - Payable at the base	No	per week	<b>200,00 €</b>
<b>Outboard engine</b> (Payable at the base) <b>Season: 2026.</b> 3 L of fuel - Payable at the base	No	per week	<b>100,00 €</b>
<b>Projector</b> (Payable at the base) <b>Season: 2026.</b> +screen, availability to be confirmed at the base - Payable at the base	No	per week	<b>100,00 €</b>
<b>Railing net (Safety net)</b> (Payable at the base) <b>Season: 2026.</b> Payable at the base	No	per booking	<b>100,00 €</b>
<b>Seabob</b> (Payable at the base) <b>Season: 2026.</b> Deposit 1300 EUR, availability to be confirmed at the base - Payable at the base	No	per week	<b>1.300,00 €</b>
<b>Stand up paddle (SUP)</b> (Payable at the base) <b>Season: 2026.</b> Payable at the base	No	per week	<b>100,00 €</b>
<b>Underwater scooter</b> (Payable at the base) <b>Season: 2026.</b> Newbow underwater scooter, availability to be confirmed at the base - Payable at the base	No	per week	<b>250,00 €</b>



**WEBSITE**  
www.plujeme.cz



**PHONE**  
+420 720 755 089



**MOBILE**  
+420 771 70 276



**E-MAIL**  
info@plujeme.cz



**PLUJEME RÁDI S.R.O.**  
Dlouhá 730/35, 11000 Praha 1 – Staré Město, Czech Republic



## PRICE AND AVAILABILITY

25.04. - 02.05.2026 NOT AVAILABLE	02.05. - 09.05.2026 NOT AVAILABLE	09.05. - 16.05.2026 NOT AVAILABLE	16.05. - 23.05.2026 NOT AVAILABLE
23.05. - 30.05.2026 NOT AVAILABLE	30.05. - 06.06.2026 NOT AVAILABLE	06.06. - 13.06.2026 2.800 €	13.06. - 20.06.2026 2.800 €
20.06. - 27.06.2026 NOT AVAILABLE	27.06. - 04.07.2026 NOT AVAILABLE	04.07. - 11.07.2026 2.800 €	11.07. - 18.07.2026 2.800 €
18.07. - 25.07.2026 2.800 €	25.07. - 01.08.2026 2.800 €	01.08. - 08.08.2026 3.250 €	08.08. - 15.08.2026 3.250 €
15.08. - 22.08.2026 3.250 €	22.08. - 29.08.2026 3.250 €	29.08. - 05.09.2026 3.600 €	05.09. - 12.09.2026 3.600 €
12.09. - 19.09.2026 NOT AVAILABLE	19.09. - 26.09.2026 3.600 €	26.09. - 03.10.2026 3.600 €	03.10. - 10.10.2026 3.600 €
10.10. - 17.10.2026 3.600 €	17.10. - 24.10.2026 3.600 €	24.10. - 31.10.2026 3.250 €	31.10. - 07.11.2026 2.800 €
07.11. - 14.11.2026 2.350 €	14.11. - 21.11.2026 2.350 €	21.11. - 28.11.2026 1.800 €	28.11. - 05.12.2026 1.800 €



**WEBSITE**  
[www.plujeme.cz](http://www.plujeme.cz)



**E-MAIL**  
[info@plujeme.cz](mailto:info@plujeme.cz)



**PHONE**  
+420 720 755 085



**PLUJEME RÁDI S.R.O.**  
Dlouhá 730/35, 11000 Praha 1 – Staré Město, Czech Republic



**MOBILE**  
+420 777 170 276

## PRICE AND AVAILABILITY

05.12. - 12.12.2026

1.800 €

12.12. - 19.12.2026

1.800 €

19.12. - 26.12.2026

1.800 €



### WEBSITE

[www.plujeme.cz](http://www.plujeme.cz)



### E-MAIL

[info@plujeme.cz](mailto:info@plujeme.cz)



### PHONE

+420 720 755 085



### MOBILE

+420 777 170 276



### PLUJEME RÁDI S.R.O.

Dlouhá 730/35, 11000 Praha 1 – Staré Město, Czech Republic