

# HANSE 460

Dioscuri - OW (2022)

Sailing yacht Hanse 460 Dioscuri - OW, built in 2022 is anchored in the **Marina Kastela, Split region, Croatia**. It has **4 cabins**, can accommodate **8 + 2 people** and has **2 toilets**. Bed linen and kitchen equipment are included in the price.

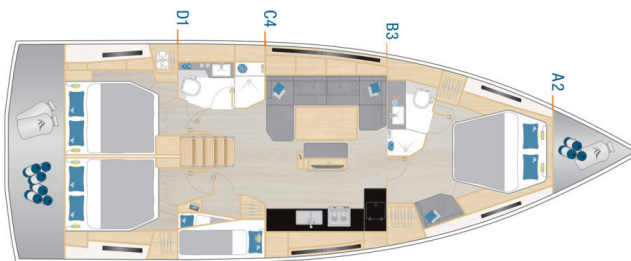

## YACHT SPECIFICATIONS

Yacht Base

**Marina Kastela, Croatia**

Yacht ID

**3823**

Brands

**Hanse Yachts**

Yacht name

**Dioscuri - OW**

Production year

**2022**

Length

**48 ft**

Cabins

**4**

Berths

**8 + 2**

Max Persons

**10**

WC

**2**

Engine

**1 x 80 HP**

Fuel tank

**210 l**



**WEBSITE**

[www.plujeme.cz](http://www.plujeme.cz)



**PHONE**

+420 720 755 085



**MOBILE**

+420 777 170 276



**E-MAIL**

[info@plujeme.cz](mailto:info@plujeme.cz)



**PLUJEME RÁDI S.R.O.**

Dlouhá 730/35, 11000 Praha 1 – Staré Město, Czech Republic

## STANDARD YACHT EQUIPMENT

Comfort	<b>Bed linen, Cockpit cushions</b>
Deck	<b>Bathing platform, Bimini top, Cockpit fridge, Cockpit table, Cockpit/stern, outside shower, Davit, Dinghy, Electric anchor windlass, Sprayhood, Teak cockpit</b>
Entertainment	<b>Outdoor speakers, Radio CD player</b>
Galley	<b>Gas cookers, Hot water, Kitchen utensils (Galley equipment, cutlery), Oven, Refrigerator</b>
Navigation	<b>Autopilot, Bow thruster, GPS chart plotter - cockpit, Navigation (Nautical) charts and nautical guide, Pilot book, Tridata</b>
Safety	<b>Set of tools, VHF radio</b>
Yacht electrics	<b>Air Conditioning, Battery charger, Generator, Heating, Inverter</b>



#### WEBSITE

[www.plujeme.cz](http://www.plujeme.cz)



#### E-MAIL

[info@plujeme.cz](mailto:info@plujeme.cz)



#### PHONE

+420 720 755 085



#### MOBILE

+420 777 170 276



#### PLUJEME RÁDI S.R.O.

Dlouhá 730/35, 11000 Praha 1 – Staré Město, Czech Republic

## SERVICES

SELECTED SERVICES	OBLIGATORY	PAYMENT TYPE	PRICE
<b>Charter pack</b> (Payable at the base) <b>Season: 2026.</b> includes final cleaning, bedlinen, towels - 1 set/person, cooking gas	Yes	per booking	<b>330,00 €</b>
<b>Outboard engine</b> (Payable at the base) <b>Season: 2026.</b> Free of charge for bookings in May	Yes	per booking	<b>0,00 €</b>
<b>Comfort Pack</b> (Payable at the base) <b>Season: 2026.</b> includes outboard 2,5 HP, WiFi routers	No	per week	<b>105,00 €</b>
<b>Deposit insurance</b> (Payable at the base) <b>Season: 2026.</b> + 370 EUR refundable deposit	No	per booking	<b>260,00 €</b>
<b>Early Check in</b> (Payable at the base) <b>Season: 2026.</b> Saturdays between 13hr - 14hr. Early check in can be confirmed only on embarkation day in the charter base.	No	per booking	<b>200,00 €</b>
<b>Flexible booking</b> (Payable now) <b>Season: 2026.</b> allows you to cancel or rebook your charter up to 30 days before the embarkation for no specific reason. You can reschedule your holiday at no cost for unlimited number of times or use a credit note if you are uncertain of new charter dates. With our FLEX PLAN your rebooking costs are completely eliminated while cancellation costs with refund option are reduced to a minimum (15% of the charter fee, min 350 EUR). Extra bonus: free cancellation and FULL REFUND granted in case of closed state borders within 7 days before the embarkation. Notes: FLEX PLAN costs 7% of the final charter price, can be added to booking up to 72hr after booking confirmation and is not available for bookings confirmed within 30 days before the embarkation.	No	per booking	<b>0,00 €</b>
<b>Hostess</b> (Payable now) <b>Season: 2026.</b> + own cabin 50% cancellation fee in case of cancellation up to 15 days prior to embarkation 100% cancellation fee in case of cancellation within 14 days prior to embarkation	No	per day + food	<b>220,00 €</b>
<b>Late check out</b> (Payable at the base) <b>Season: 2026.</b> Saturdays till 10hr Late check-out can be confirmed only on Friday before the embarkation day.	No	per booking	<b>300,00 €</b>

<b>One way fee</b> (Payable at the base)	No	per booking	<b>410,00 €</b>
<b>Season: 2026.</b> Kas - Bio / Bio - Kas On request only. One-way conditions: one way fee + skipper service obligatory for the whole booking period + mooring fee in port of disembarkation/embarkation; check-out on Friday until 12:00 in Biograd			
<b>One way fee</b> (Payable at the base)	No	per booking	<b>480,00 €</b>
<b>Season: 2026.</b> Kas - Du / Du - Kas On request only. One-way conditions: one way fee + skipper service obligatory for the whole booking period + mooring fee in port of disembarkation/embarkation; check-out on Friday until 09:00hr in Dubrovnik			
<b>Pet on board</b> (Payable at the base)	No	per booking	<b>150,00 €</b>
<b>Season: 2026.</b> Small or medium pet, up to 25 kg			
<b>Provisioning</b> (Payable now)	No	per booking	<b>0,00 €</b>
<b>Season: 2026.</b> upon request + price of groceries, to be done online			
<b>Skipper</b> (Payable now)	No	per day + food	<b>220,00 €</b>
<b>Season: 2026.</b> + own cabin 50% cancellation fee in case of cancellation up to 15 days prior to embarkation 100% cancellation fee in case of cancellation within 14 days prior to embarkation			



**WEBSITE**

[www.plujeme.cz](http://www.plujeme.cz)



**E-MAIL**

[info@plujeme.cz](mailto:info@plujeme.cz)



**PHONE**

+420 720 755 085



**MOBILE**

+420 777 170 276



**PLUJEME RÁDI S.R.O.**

Dlouhá 730/35, 11000 Praha 1 – Staré Město, Czech Republic

## ADDITIONAL EXTRAS

EXTRA	OBLIGATORY	PAYMENT TYPE	PRICE
<b>Beach towel</b> (Payable at the base) <b>Season: 2026.</b> Payable at the base	No	per piece	<b>8,00 €</b>
<b>Donut</b> (Payable at the base) <b>Season: 2026.</b> Payable at the base	No	per week	<b>50,00 €</b>
<b>eFoil</b> (Payable now) <b>Season: 2026.</b> Loft Foil / Awake Vinga Security deposit: 1000 EUR Cancellation policy: 50% cancellation fee in case of cancellation within 2 weeks prior to embarkation. Delivery fee – free of charge – Payable now	No	per week	<b>2.000,00 €</b>
<b>Electric scooter</b> (Payable at the base) <b>Season: 2026.</b> Xiaomi Electric Scooter 4 Lite (2nd Gen) – Payable at the base	No	per week	<b>120,00 €</b>
<b>Extra bedlinen</b> (Payable at the base) <b>Season: 2026.</b> Payable at the base	No	per set	<b>15,00 €</b>
<b>Floating Water Hammock</b> (Payable at the base) <b>Season: 2026.</b> Partyzone – Payable at the base	No	per week	<b>220,00 €</b>
<b>Gennaker</b> (Payable at the base) <b>Season: 2026.</b> deposit raise + 750 EUR – Payable at the base	No	per week	<b>280,00 €</b>
<b>Grill/Barbecue/Plancha</b> (Payable at the base) <b>Season: 2026.</b> portable grill – Payable at the base	No	per week	<b>180,00 €</b>
<b>JetBoard</b> (Payable now) <b>Season: 2026.</b> Awake Security deposit: 1000 EUR Cancellation policy: 50% cancellation fee in case of cancellation within 2 weeks prior to embarkation. Delivery fee – free of charge – Payable now	No	per week	<b>2.200,00 €</b>
<b>Kayak</b> (Payable at the base) <b>Season: 2026.</b> 2 pax – Payable at the base	No	per week	<b>150,00 €</b>
<b>Outboard engine 2,5 HP</b> (Payable at the base) <b>Season: 2026.</b> Payable at the base	No	per week	<b>100,00 €</b>
<b>Outboard engine 5 HP</b> (Payable at the base) <b>Season: 2026.</b> on request – Payable at the base	No	per week	<b>150,00 €</b>

<b>Railing net (Safety net)</b> (Payable at the base)	No	per booking	<b>20,00 €</b>
<b>Season: 2026.</b> Rental without mounting - Payable at the base			
<b>RIB 3,8 with console + 20 HP</b> (Payable at the base)	No	per week	<b>790,00 €</b>
<b>Season: 2026.</b> Deposit increase € 500 Cancellation policy: 50% cancellation fee in case of cancellation within 2 weeks prior to embarkation. RIB has to be towed. - Payable at the base			
<b>RIB 3m + 15 HP outboard</b> (Payable at the base)	No	per week	<b>390,00 €</b>
<b>Season: 2026.</b> Deposit increase € 400 Cancellation policy: 50% cancellation fee in case of cancellation within 2 weeks prior to embarkation. RIB has to be towed. - Payable at the base			
<b>RIB 4,6m with console + 60 HP outboard</b> (Payable at the base)	No	per week	<b>1.290,00 €</b>
<b>Season: 2026.</b> Deposit increase € 800 Cancellation policy: 50% cancellation fee in case of cancellation within 2 weeks prior to embarkation. RIB has to be towed. - Payable at the base			
<b>Seabob</b> (Payable now)	No	per week	<b>1.000,00 €</b>
<b>Season: 2026.</b> Seabob F5 Security deposit: 500 EUR Cancellation policy: 50% cancellation fee in case of cancellation within 2 weeks prior to embarkation. Delivery fee - free of charge - Payable now			
<b>Seabob</b> (Payable now)	No	per week	<b>1.200,00 €</b>
<b>Season: 2026.</b> Seabob F5S Security deposit: 500 EUR Cancellation policy: 50% cancellation fee in case of cancellation within 2 weeks prior to embarkation. Delivery fee - free of charge - Payable now			
<b>Seabob</b> (Payable now)	No	per week	<b>1.300,00 €</b>
<b>Season: 2026.</b> Seabob F9 Security deposit: 500 EUR Cancellation policy: 50% cancellation fee in case of cancellation within 2 weeks prior to embarkation. Delivery fee - free of charge - Payable now			
<b>Seabob</b> (Payable now)	No	per week	<b>1.500,00 €</b>
<b>Season: 2026.</b> Seabob F9S Security deposit: 500 EUR Cancellation policy: 50% cancellation fee in case of cancellation within 2 weeks prior to embarkation. Delivery fee - free of charge - Payable now			
<b>Seabob</b> (Payable now)	No	per week	<b>1.500,00 €</b>
<b>Season: 2026.</b> Seabob F5SR Security deposit: 500 EUR Cancellation policy: 50% cancellation fee in case of cancellation within 2 weeks prior to embarkation. Delivery fee - free of charge - Payable now			
<b>Snorkeling equipment</b> (Payable at the base)	No	per week	<b>10,00 €</b>
<b>Season: 2026.</b> Payable at the base			

<b>Stand up paddle (SUP)</b> (Payable at the base) <b>Season: 2026.</b> Payable at the base	No	per week	<b>120,00 €</b>
<b>Subwing</b> (Payable at the base) <b>Season: 2026.</b> Payable at the base	No	per week	<b>50,00 €</b>
<b>Sundeck cushions</b> (Payable at the base) <b>Season: 2026.</b> Payable at the base	No	per week	<b>90,00 €</b>
<b>Towels</b> (Payable at the base) <b>Season: 2026.</b> 2 psc/set (1 x 50x100cm + 1 x 70x140cm) - Payable at the base	No	per set	<b>8,00 €</b>
<b>Wakeboard</b> (Payable at the base) <b>Season: 2026.</b> Payable at the base	No	per week	<b>50,00 €</b>
<b>Wi-Fi Internet</b> (Payable at the base) <b>Season: 2026.</b> Payable at the base	No	per week	<b>25,00 €</b>



**WEBSITE**

[www.plujeme.cz](http://www.plujeme.cz)



**E-MAIL**

[info@plujeme.cz](mailto:info@plujeme.cz)



**PHONE**

+420 720 755 085



**MOBILE**

+420 777 170 276



**PLUJEME RÁDI S.R.O.**

Dlouhá 730/35, 11000 Praha 1 – Staré Město, Czech Republic

## PRICE AND AVAILABILITY

25.04. - 02.05.2026 1.824 € 2.280 €	02.05. - 09.05.2026 1.824 € 2.280 €	09.05. - 16.05.2026 2.272 € 2.840 €	16.05. - 23.05.2026 2.416 € 3.020 €
23.05. - 30.05.2026 2.944 € 3.680 €	30.05. - 06.06.2026 3.328 € 4.160 €	06.06. - 13.06.2026 NOT AVAILABLE	13.06. - 20.06.2026 3.936 € 4.920 €
20.06. - 27.06.2026 NOT AVAILABLE	27.06. - 04.07.2026 NOT AVAILABLE	04.07. - 18.07.2026 NOT AVAILABLE	18.07. - 25.07.2026 NOT AVAILABLE
25.07. - 01.08.2026 4.736 € 5.920 €	01.08. - 08.08.2026 NOT AVAILABLE	08.08. - 22.08.2026 NOT AVAILABLE	22.08. - 29.08.2026 4.176 € 5.220 €
29.08. - 05.09.2026 NOT AVAILABLE	05.09. - 12.09.2026 4.048 € 5.060 €	12.09. - 19.09.2026 NOT AVAILABLE	19.09. - 26.09.2026 3.744 € 4.680 €
26.09. - 03.10.2026 2.784 € 3.480 €	03.10. - 10.10.2026 2.176 € 2.720 €	10.10. - 17.10.2026 1.856 € 2.320 €	17.10. - 24.10.2026 1.856 € 2.320 €
24.10. - 31.10.2026 2.224 € 2.780 €	31.10. - 07.11.2026 2.224 € 2.780 €	07.11. - 14.11.2026 2.224 € 2.780 €	14.11. - 21.11.2026 2.224 € 2.780 €
21.11. - 28.11.2026 2.224 € 2.780 €	28.11. - 05.12.2026 2.224 € 2.780 €		



WEBSITE

[www.plujeme.cz](http://www.plujeme.cz)



E-MAIL

[info@plujeme.cz](mailto:info@plujeme.cz)



PHONE

+420 720 755 085



MOBILE

+420 777 170 276



PLUJEME RÁDI S.R.O.

Dlouhá 730/35, 11000 Praha 1 – Staré Město, Czech Republic

## PRICE AND AVAILABILITY

05.12. - 12.12.2026

**2.224 €** 2.780 €

12.12. - 19.12.2026

**2.224 €** 2.780 €

19.12. - 26.12.2026

**2.224 €** 2.780 €



### WEBSITE

[www.plujeme.cz](http://www.plujeme.cz)



### E-MAIL

[info@plujeme.cz](mailto:info@plujeme.cz)



### PHONE

+420 720 755 085



### MOBILE

+420 777 170 276



### PLUJEME RÁDI S.R.O.

Dlouhá 730/35, 11000 Praha 1 – Staré Město, Czech Republic