

DUFOUR 390

Elena (2022)

Sailing yacht Dufour 390 Elena, built in 2022 is anchored in the Marina Tehnomont Veruda, Pula, Istra, Croatia. It has 3 cabins, can accommodate 6 + 2 people and has 3 toilets. Bed linen and kitchen equipment are included in the price.

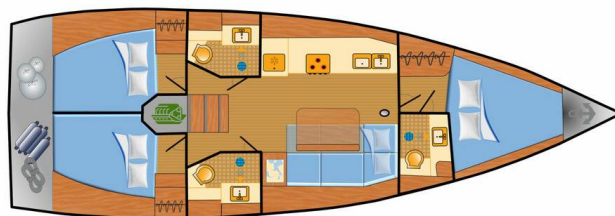

YACHT SPECIFICATIONS

Yacht Base

Marina Tehnomont Veruda, Pula, Croatia

Yacht ID

3790

Brands

Dufour

Yacht name

Elena

Production year

2022

Length

39 ft

Cabins

3

Berths

6 + 2

Max Persons

8

WC

3

Engine

1 x 50 HP

Fuel tank

200 l



WEBSITE

www.plujeme.cz



PHONE

+420 720 755 085



MOBILE

+420 777 170 276



E-MAIL

info@plujeme.cz



PLUJEME RÁDI S.R.O.

Dlouhá 730/35, 11000 Praha 1 – Staré Město, Czech Republic

STANDARD YACHT EQUIPMENT

Additional	Flag
Comfort	Cockpit cushions
Deck	Anchor light, Bathing platform, Bimini top, Boat hook, Bosun's chair (Safe seat) (boatswain's chair), Cockpit grill, Cockpit table, Cockpit/stern, outside shower, Deck brush, Electric anchor windlass, Fenders, Gangway, Impeller, Main anchor, Mooring ropes, Sailor's knife, Spare anchor (Reserve, Auxiliary anchor), Sprayhood, Swimming ladder, Teak cockpit
Entertainment	Outdoor speakers, Radio, TV, Wi-Fi Internet
Galley	Hot water, Kitchen utensils (Galley equipment, cutlery), Oven, Refrigerator, Sink, Stove, Wine glasses
Interior	Barometer, Clock, Lowerable salon table, Safe, Yacht keys
Navigation	AIS, Autopilot, Binoculars, Bow thruster, Compass, Composite steering wheels, CRO flag, Depthsounder, GPS chart plotter - cockpit, Nautical charts, Navigation/position Lights, Triangles, Windex
Safety	Distress signals, Emergency tiller, Fire extinguisher, First aid kit, Flashlight, Fog horn, Guard rail, Life belts (Safety harness), Life buoy + Flashing light, Lifelines, Liferaft, VHF radio, Wire (shroud) cutter
Sails	Electric winch, Gennaker-device, Halyard winches, Lazy jacks
Yacht electrics	220V socket, Bilge pump - Electric, Converter 220V/12V, Heating, Inverter, Shore connection 220 V, Shore power cable, Solar panels



WEBSITE
www.plujeme.cz



PHONE
+420 720 755 085



MOBILE
+420 777 170 276



E-MAIL
info@plujeme.cz



PLUJEME RÁDI S.R.O.
Dlouhá 730/35, 11000 Praha 1 – Staré Město, Czech Republic

SERVICES

SELECTED SERVICES	OBLIGATORY	PAYMENT TYPE	PRICE
Basic package for accommodation (Payable at the base) Season: 2026. Cash or with credit card (VISA, MASTER) Cleaning, made Bed linen, Permit, WiFi, Cooking gas, Rinsing set, Dinghy	Yes	per booking	250,00 €
Deposit insurance (Payable at the base) Season: 2026. Cash / The customers still have to deposit 100,00 €. If there is no damage, they get the 100,00 € back. We do not require any prior information. The customer can take out insurance at check-in.	No	per booking	200,00 €
Early Check in (Payable at the base) Season: 2026. On request; from 13:00; Payable in cash at the base	No	per booking	150,00 €
Hostess (Payable at the base) Season: 2026. + own cabin	No	per day + food	150,00 €
Pet on board (Payable at the base) Season: 2026. ONLY ON REQUEST!; Payable in cash at the base	No	per booking	140,00 €
Skipper (Payable at the base) Season: 2026. On request; Free food, own cabin; Payable in cash at the base	No	per day	200,00 €
Transfer (Payable at the base) Season: 2026. Transfer from Marina Veruda (Pula Airport): The ride for 1-4 people costs €40. Payable in cash directly to the taxi driver.	No	one-way	40,00 €
Transfer (Payable at the base) Season: 2026. Transfer from Marina Veruda (Pula Airport): The ride for 5-8 people costs €50. Payable in cash directly to the taxi driver.	No	one-way	50,00 €



WEBSITE
www.plujeme.cz



PHONE
+420 720 755 085



MOBILE
+420 777 170 276



E-MAIL
info@plujeme.cz



PLUJEME RÁDI S.R.O.
Dlouhá 730/35, 11000 Praha 1 – Staré Město, Czech Republic

ADDITIONAL EXTRAS

EXTRA	OBLIGATORY	PAYMENT TYPE	PRICE
Gennaker (Payable at the base) Season: 2026. on request, more weeks 50% Rabatt, Cash - Payable at the base	No	per week	250,00 €
Outboard engine (Payable at the base) Season: 2026. 50% second week; in Cash or with credit card (VISA, MASTER) - Payable at the base	No	per week	100,00 €
Stand up paddle (SUP) (Payable at the base) Season: 2026. 50% second week; Payable in cash at the base - Payable at the base	No	per week	100,00 €
Towels (Payable at the base) Season: 2026. 1x big one, 1x small one; Payable in cash at the base - Payable at the base	No	per set	10,00 €

**WEBSITE**www.plujeme.cz**E-MAIL**info@plujeme.cz**PHONE**

+420 720 755 085

**MOBILE**

+420 777 170 276

**PLUJEME RÁDI S.R.O.**

Dlouhá 730/35, 11000 Praha 1 – Staré Město, Czech Republic

PRICE AND AVAILABILITY

25.04. - 02.05.2026 NOT AVAILABLE	02.05. - 09.05.2026 1.155 € 1.650 €	09.05. - 16.05.2026 1.330 € 1.900 €	16.05. - 23.05.2026 1.330 € 1.900 €
23.05. - 06.06.2026 NOT AVAILABLE	06.06. - 13.06.2026 NOT AVAILABLE	13.06. - 20.06.2026 NOT AVAILABLE	20.06. - 11.07.2026 NOT AVAILABLE
11.07. - 18.07.2026 NOT AVAILABLE	18.07. - 25.07.2026 NOT AVAILABLE	25.07. - 08.08.2026 NOT AVAILABLE	08.08. - 15.08.2026 NOT AVAILABLE
15.08. - 22.08.2026 NOT AVAILABLE	22.08. - 29.08.2026 2.886 € 3.700 €	29.08. - 05.09.2026 2.886 € 3.700 €	05.09. - 12.09.2026 2.808 € 3.600 €
12.09. - 19.09.2026 2.808 € 3.600 €	19.09. - 26.09.2026 NOT AVAILABLE	26.09. - 03.10.2026 NOT AVAILABLE	03.10. - 10.10.2026 1.482 € 1.900 €
10.10. - 17.10.2026 1.287 € 1.650 €	17.10. - 24.10.2026 1.287 € 1.650 €	24.10. - 31.10.2026 1.287 € 1.650 €	31.10. - 07.11.2026 1.287 € 1.650 €
07.11. - 14.11.2026 1.287 € 1.650 €	14.11. - 21.11.2026 1.650 €	21.11. - 28.11.2026 1.650 €	28.11. - 05.12.2026 1.650 €



WEBSITE

www.plujeme.cz



E-MAIL

info@plujeme.cz



PHONE

+420 720 755 085



MOBILE

+420 777 170 276



PLUJEME RÁDI S.R.O.

Dlouhá 730/35, 11000 Praha 1 – Staré Město, Czech Republic

PRICE AND AVAILABILITY

05.12. - 12.12.2026 1.650 €	12.12. - 19.12.2026 1.650 €	19.12. - 26.12.2026 1.650 €	01.01. - 26.03.2027 NOT AVAILABLE
27.03. - 03.04.2027 1.238 € 1.650 €	03.04. - 10.04.2027 1.238 € 1.650 €	10.04. - 17.04.2027 1.238 € 1.650 €	17.04. - 24.04.2027 1.238 € 1.650 €
24.04. - 01.05.2027 1.238 € 1.650 €	01.05. - 08.05.2027 1.238 € 1.650 €	08.05. - 15.05.2027 1.425 € 1.900 €	15.05. - 22.05.2027 1.425 € 1.900 €
22.05. - 29.05.2027 2.025 € 2.700 €	29.05. - 05.06.2027 2.400 € 3.200 €	05.06. - 12.06.2027 2.400 € 3.200 €	12.06. - 19.06.2027 2.400 € 3.200 €
19.06. - 26.06.2027 2.400 € 3.200 €	26.06. - 03.07.2027 2.400 € 3.200 €	03.07. - 10.07.2027 2.775 € 3.700 €	10.07. - 17.07.2027 2.775 € 3.700 €
17.07. - 24.07.2027 2.775 € 3.700 €	24.07. - 31.07.2027 2.775 € 3.700 €	31.07. - 07.08.2027 2.775 € 3.700 €	



WEBSITE

www.plujeme.cz



E-MAIL

info@plujeme.cz



PHONE

+420 720 755 085



MOBILE

+420 777 170 276



PLUJEME RÁDI S.R.O.

Dlouhá 730/35, 11000 Praha 1 – Staré Město, Czech Republic

PRICE AND AVAILABILITY

07.08. - 14.08.2027 2.775 € 3.700 €	14.08. - 21.08.2027 2.775 € 3.700 €	21.08. - 28.08.2027 2.775 € 3.700 €	28.08. - 04.09.2027 2.775 € 3.700 €
04.09. - 11.09.2027 2.700 € 3.600 €	11.09. - 18.09.2027 2.700 € 3.600 €	18.09. - 25.09.2027 2.400 € 3.200 €	25.09. - 02.10.2027 2.025 € 2.700 €
02.10. - 09.10.2027 1.425 € 1.900 €	09.10. - 16.10.2027 1.238 € 1.650 €	16.10. - 23.10.2027 1.238 € 1.650 €	23.10. - 30.10.2027 1.238 € 1.650 €
30.10. - 06.11.2027 1.238 € 1.650 €	07.11. - 24.03.2028 NOT AVAILABLE		



WEBSITE

www.plujeme.cz



E-MAIL

info@plujeme.cz



PHONE

+420 720 755 085



MOBILE

+420 777 170 276



PLUJEME RÁDI S.R.O.

Dlouhá 730/35, 11000 Praha 1 – Staré Město, Czech Republic