

# HANSE 460

Jameson (2022)

Sailing yacht Hanse 460 Jameson, built in 2022 is anchored in the Marina Kornati, Biograd, Zadar region, Croatia. It has 5 cabins, can accommodate 10 people and has 3 toilets. Bed linen and kitchen equipment are included in the price.

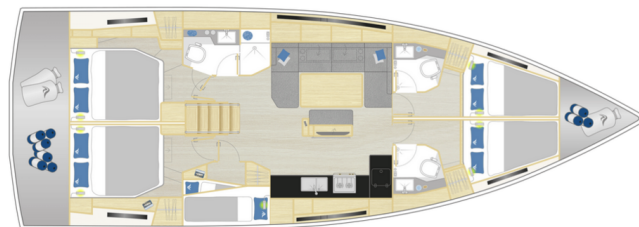

## YACHT SPECIFICATIONS

Yacht Base

**Marina Kornati, Biograd, Croatia**

Yacht ID

**3730**

Brands

**Hanse Yachts**

Yacht name

**Jameson**

Production year

**2022**

Length

**48 ft**

Cabins

**5**

Berths

**10**

WC

**3**

Engine

**1 x 57 HP**

Fuel tank

**210 l**



**WEBSITE**

[www.plujeme.cz](http://www.plujeme.cz)



**PHONE**

+420 720 755 085



**MOBILE**

+420 777 170 276



**E-MAIL**

[info@plujeme.cz](mailto:info@plujeme.cz)



**PLUJEME RÁDI S.R.O.**

Dlouhá 730/35, 11000 Praha 1 – Staré Město, Czech Republic

## STANDARD YACHT EQUIPMENT

Comfort	<b>Blankets, Cockpit cushions, Pillows</b>
Deck	<b>Bathing platform, Bimini top, Bosun's chair (Safe seat) (boatswain's chair), Cockpit table, Cockpit/stern, outside shower, Dinghy, Electric anchor windlass, Fenders, Main anchor, Main Deck Compass, Mooring Cleats, Mooring ropes, Sea/Storm drogue anchor, Spare anchor (Reserve, Auxiliary anchor), Sprayhood, Teak cockpit, Teak seats in cockpit</b>
Entertainment	<b>Bluetooth player, FUSION sound system, Outdoor speakers, Remote control for radio in cockpit, USB, Wet bar</b>
Galley	<b>Gas bottles, Hot water, Kitchen utensils (Galley equipment, cutlery), Oven, Refrigerator, Stove</b>
Interior	<b>LED interior lights</b>
Navigation	<b>Autopilot, Bow thruster, GPS chart plotter, GPS chart plotter - cockpit, Hand bearing compass, Harbour guides, Helm station, LED Navigation lights, Nautical charts, Wind instrument/Anemometer, Wind/speed/depth instruments, Windex</b>
Safety	<b>Emergency tiller, Fire extinguisher, First aid kit, Flashlight, Fog horn, Horseshoe lifebuoy, Life belts (Safety harness), Life jackets, Set of tools, Signal rockets and torches, VHF radio, Wire (shroud) cutter</b>
Sails	<b>Electric winch, Lazy bag</b>
Yacht electrics	<b>Air Conditioning, Battery charger, Heating, Inverter, Service batteries, Shore connection 220 V, Solar panels</b>



**WEBSITE**

[www.plujeme.cz](http://www.plujeme.cz)



**PHONE**

+420 720 755 085



**MOBILE**

+420 777 170 276



**E-MAIL**

[info@plujeme.cz](mailto:info@plujeme.cz)



**PLUJEME RÁDI S.R.O.**

Dlouhá 730/35, 11000 Praha 1 – Staré Město, Czech Republic

## SERVICES

SELECTED SERVICES	OBLIGATORY	PAYMENT TYPE	PRICE
<b>Base costs</b> (Payable at the base) <b>Season: 2026.</b> Check-in, check-out, Final cleaning, bed linen per person on crew list, Diver at the check-out, Gas	Yes	per booking	<b>300,00 €</b>
<b>Deposit insurance</b> (Payable at the base) <b>Season: 2026.</b> The non-refundable deposit can be purchased on-site at a cost of ca. 12% of the deposit for the first and second week. For charters lasting three or more weeks, a new deposit insurance policy must be purchased. Please note that the deposit insurance does not cover clogged toilets, waste tanks, or missing fuel. Therefore, a refundable part of the deposit is mandatory: 500 EUR (payable in cash or by credit card).	No	per booking	<b>300,00 €</b>
<b>Overnight on board</b> (Payable at the base) <b>Season: 2026.</b> depending on availability	No	per booking	<b>200,00 €</b>
<b>Pet on board</b> (Payable at the base) <b>Season: 2026.</b>	No	per booking	<b>150,00 €</b>
<b>Priority check in</b> (Payable now) <b>Season: 2026.</b> check in between 13:00 - 14:00h. Limited offer, max 5 boats per Saturday	No	per booking	<b>200,00 €</b>
<b>Regatta charge</b> (Payable now) <b>Season: 2026.</b> plus additional 20% on price	No	per booking	<b>0,00 €</b>



**WEBSITE**

[www.plujeme.cz](http://www.plujeme.cz)



**PHONE**

+420 720 755 085



**MOBILE**

+420 777 170 276



**E-MAIL**

[info@plujeme.cz](mailto:info@plujeme.cz)



**PLUJEME RÁDI S.R.O.**

Dlouhá 730/35, 11000 Praha 1 – Staré Město, Czech Republic

## ADDITIONAL EXTRAS

EXTRA	OBLIGATORY	PAYMENT TYPE	PRICE
<b>Automatic Inflatable Life Jacket</b> (Payable at the base) <i>Season: 2026. Payable at the base</i>	No	per week/ person	<b>15,00 €</b>
<b>Extra bedlinen</b> (Payable at the base) <i>Season: 2026. Payable at the base</i>	No	per cabin	<b>12,00 €</b>
<b>Outboard engine</b> (Payable at the base) <i>Season: 2026. +fuel (5L) - Payable at the base</i>	No	per week	<b>80,00 €</b>
<b>Railing net (Safety net)</b> (Payable at the base) <i>Season: 2026. Payable at the base</i>	No	per booking	<b>80,00 €</b>
<b>Stand up paddle (SUP)</b> (Payable at the base) <i>Season: 2026. Payable at the base</i>	No	per week	<b>80,00 €</b>
<b>Towels</b> (Payable at the base) <i>Season: 2026. (2 towels size 50 x 100, 1 towel size 70 x 140 / per person) - Payable at the base</i>	No	per set	<b>8,00 €</b>



**WEBSITE**  
www.plujeme.cz



**E-MAIL**  
info@plujeme.cz



**PHONE**  
+420 720 755 085



**MOBILE**  
+420 777 170 276



**PLUJEME RÁDI S.R.O.**  
Dlouhá 730/35, 11000 Praha 1 – Staré Město, Czech Republic

## PRICE AND AVAILABILITY

<b>13.06. - 20.06.2026</b> NOT AVAILABLE	<b>20.06. - 27.06.2026</b> ON OPTION	<b>27.06. - 04.07.2026</b> NOT AVAILABLE	<b>04.07. - 11.07.2026</b> NOT AVAILABLE
<b>11.07. - 18.07.2026</b> NOT AVAILABLE	<b>18.07. - 25.07.2026</b> NOT AVAILABLE	<b>25.07. - 01.08.2026</b> NOT AVAILABLE	<b>01.08. - 08.08.2026</b> NOT AVAILABLE
<b>08.08. - 15.08.2026</b> NOT AVAILABLE	<b>15.08. - 22.08.2026</b> NOT AVAILABLE	<b>22.08. - 29.08.2026</b> NOT AVAILABLE	<b>29.08. - 05.09.2026</b> NOT AVAILABLE
<b>05.09. - 12.09.2026</b> NOT AVAILABLE	<b>12.09. - 19.09.2026</b> NOT AVAILABLE	<b>19.09. - 26.09.2026</b> NOT AVAILABLE	<b>26.09. - 03.10.2026</b> NOT AVAILABLE
<b>03.10. - 10.10.2026</b> NOT AVAILABLE	<b>10.10. - 17.10.2026</b> <b>1.680 €</b> 2.400 €	<b>17.10. - 24.10.2026</b> <b>1.680 €</b> 2.400 €	<b>25.10. - 31.12.2026</b> NOT AVAILABLE



### WEBSITE

[www.plujeme.cz](http://www.plujeme.cz)



### E-MAIL

[info@plujeme.cz](mailto:info@plujeme.cz)



### PHONE

+420 720 755 085



### MOBILE

+420 777 170 276



### PLUJEME RÁDI S.R.O.

Dlouhá 730/35, 11000 Praha 1 – Staré Město, Czech Republic