

# FOUNTAIN PAJOT SABA 50

Soleil Rae (2019)

Catamaran Fountaine Pajot Saba 50 Soleil Rae, built in 2019 is anchored in the BVI, Tortola, Ritter House Marina, British Virgin Islands, British Virgin Islands. It has 5 + 2 cabins, can accommodate 9 + 2 people and has 5 toilets. Bed linen and kitchen equipment are included in the price.

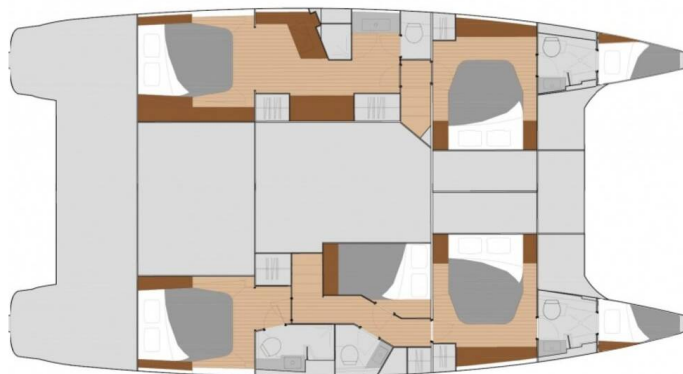

## YACHT SPECIFICATIONS

Yacht Base

**BVI, Tortola, Ritter House Marina,  
British Virgin Islands**

Yacht ID

**3703**

Brands

**Fountaine Pajot**

Yacht name

**Soleil Rae**

Production year

**2019**

Length

**49 ft**

Cabins

**5 + 2**

Berths

**9 + 2**

Max Persons

**11**

WC

**5**

Engine

**2 x 75 HP**

Fuel tank

**938 l**



**WEBSITE**

[www.plujeme.cz](http://www.plujeme.cz)



**PHONE**

+420 720 755 085



**MOBILE**

+420 777 170 276



**E-MAIL**

[info@plujeme.cz](mailto:info@plujeme.cz)



**PLUJEME RÁDI S.R.O.**

Dlouhá 730/35, 11000 Praha 1 – Staré Město, Czech Republic

## STANDARD YACHT EQUIPMENT

Comfort	<b>Cockpit cushions, Sundeck cushions</b>
Deck	<b>Bimini top, Cockpit fridge, Davit, Dinghy with outboard engine, Electric anchor windlass, Foredeck sunbathing area, Grill/Barbecue/Plancha, Teak cockpit</b>
Entertainment	<b>Bose Sound System, Fusion radio, TV + DVD, Underwater lights</b>
Galley	<b>Freezer, Microwave, Refrigerator, Stove</b>
Interior	<b>Electric toilet, Safe</b>
Navigation	<b>Autopilot, GPS chart plotter, Helm station</b>
Safety	<b>Black Water Tank</b>
Sails	<b>Electric winch</b>
Yacht electrics	<b>110V socket, Air Conditioning, Generator, Inverter, Solar panels</b>



**WEBSITE**

[www.plujeme.cz](http://www.plujeme.cz)



**E-MAIL**

[info@plujeme.cz](mailto:info@plujeme.cz)



**PHONE**

+420 720 755 085



**MOBILE**

+420 777 170 276



**PLUJEME RÁDI S.R.O.**

Dlouhá 730/35, 11000 Praha 1 – Staré Město, Czech Republic

## SERVICES

SELECTED SERVICES	OBLIGATORY	PAYMENT TYPE	PRICE
<b>Cruising tax</b> (Payable now) <b>Season: 2026.</b>	Yes	per guest/day	<b>4,00 €</b>
<b>National parks permit</b> (Payable now) <b>Season: 2026.</b> \$25 for 4 pax, \$35 for 6 pax, \$45 for 8 pax, \$55 for 10 pax	Yes	per booking	<b>25,00 €</b>
<b>Outboard fuel &amp; Gas</b> (Payable now) <b>Season: 2026.</b> For Dinghy	Yes	per booking	<b>20,00 €</b>
<b>Visar</b> (Payable now) <b>Season: 2026.</b>	Yes	per booking	<b>20,00 €</b>
<b>Yacht Insurance</b> (Payable now) <b>Season: 2026.</b> (Minimum \$250 / Maximum \$500)	Yes	per day	<b>50,00 €</b>
<b>Cancellation insurance</b> (Payable now) <b>Season: 2026.</b> Optional and due with deposit at the time of booking	No	per booking	<b>200,00 €</b>
<b>Captain</b> (Payable now) <b>Season: 2026.</b> + Gratuity	No	per day + food	<b>300,00 €</b>
<b>Cell phone</b> (Payable now) <b>Season: 2026.</b>	No	per booking	<b>10,00 €</b>
<b>Chef</b> (Payable now) <b>Season: 2026.</b> + Gratuity	No	per day + food	<b>300,00 €</b>
<b>Credit card payments 3% surcharge</b> (Payable now) <b>Season: 2026.</b> For both: Deposit and for Final Payment	No	per booking	<b>0,00 €</b>
<b>Day Checkout Captain</b> (Payable now) <b>Season: 2026.</b>	No	per booking	<b>250,00 €</b>
<b>Fishing licence</b> (Payable now) <b>Season: 2026.</b> flat fee, per person that wants one.	No	per person	<b>65,00 €</b>
<b>Fuel consumption</b> (Payable now) <b>Season: 2026.</b>	No	per service	<b>0,00 €</b>

<b>Ice</b> (Payable now) <b>Season: 2026.</b> (\$6 per bag)	No	per pack	<b>6,00 €</b>
<b>Sailing Instructor</b> (Payable now) <b>Season: 2026.</b> + Gratuity	No	per day + food	<b>350,00 €</b>
<b>Sleep over before check in</b> (Payable now) <b>Season: 2026.</b> From 5pm	No	per person	<b>75,00 €</b>
<b>Turn around</b> (Payable now) <b>Season: 2026.</b> an additional \$50 each night less than 7	No	per night	<b>50,00 €</b>
<b>WI-FI Internet connection on boat</b> (Payable now) <b>Season: 2026.</b>	No	per day	<b>30,00 €</b>



**WEBSITE**  
www.plujeme.cz



**E-MAIL**  
info@plujeme.cz



**PHONE**  
+420 720 755 085



**MOBILE**  
+420 777 170 276



**PLUJEME RÁDI S.R.O.**  
Dlouhá 730/35, 11000 Praha 1 – Staré Město, Czech Republic

## ADDITIONAL EXTRAS

EXTRA	OBLIGATORY	PAYMENT TYPE	PRICE
<b>Additional gas bottle</b> <i>(Payable now)</i> <b>Season: 2026.</b> propane gas tank for the BBQ grill - Payable now	No	per booking	<b>10,50 €</b>
<b>Aquapad</b> <i>(Payable now)</i> <b>Season: 2026.</b> 6ft x 12ft - Payable now	No	per piece	<b>100,00 €</b>
<b>Beach canopy</b> <i>(Payable now)</i> <b>Season: 2026.</b> Payable now	No	per booking	<b>35,00 €</b>
<b>Beach chair</b> <i>(Payable now)</i> <b>Season: 2026.</b> Payable now	No	per piece	<b>25,00 €</b>
<b>Beach umbrella</b> <i>(Payable now)</i> <b>Season: 2026.</b> Payable now	No	per booking	<b>25,00 €</b>
<b>Bean Bag Chair</b> <i>(Payable now)</i> <b>Season: 2026.</b> Payable now	No	per booking	<b>75,00 €</b>
<b>Caps</b> <i>(Payable now)</i> <b>Season: 2026.</b> Payable now	No	per booking	<b>20,00 €</b>
<b>Dinghy ladder</b> <i>(Payable now)</i> <b>Season: 2026.</b> Payable now	No	per piece	<b>50,00 €</b>
<b>Fishing casting package</b> <i>(Payable now)</i> <b>Season: 2026.</b> Payable now	No	per day	<b>12,00 €</b>
<b>Fishing Gaff</b> <i>(Payable now)</i> <b>Season: 2026.</b> Payable now	No	per booking	<b>25,00 €</b>
<b>Fishing trolling package</b> <i>(Payable now)</i> <b>Season: 2026.</b> Payable now	No	per day	<b>17,00 €</b>
<b>Floating mats</b> <i>(Payable now)</i> <b>Season: 2026.</b> Payable now	No	per piece	<b>22,00 €</b>
<b>Guitar</b> <i>(Payable now)</i> <b>Season: 2026.</b> Payable now	No	per piece	<b>100,00 €</b>

<b>Hammock</b> (Payable now) <b>Season: 2026.</b> Payable now	No	per booking	<b>25,00 €</b>
<b>Kayak</b> (Payable now) <b>Season: 2026.</b> Single Kayak - Payable now	No	per day	<b>25,00 €</b>
<b>Kayak tandem</b> (Payable now) <b>Season: 2026.</b> Double Kayak - Payable now	No	per day	<b>27,00 €</b>
<b>Lazybunz</b> (Payable now) <b>Season: 2026.</b> Payable now	No	per piece	<b>20,00 €</b>
<b>Modular Stack Matt</b> (Payable now) <b>Season: 2026.</b> 6ft x 12ft; Additional 'Stacks' + 25\$ per booking - Payable now	No	per booking	<b>150,00 €</b>
<b>Noodles</b> (Payable now) <b>Season: 2026.</b> Payable now	No	per piece	<b>4,00 €</b>
<b>Rash Guards</b> (Payable now) <b>Season: 2026.</b> Men, Women or Kid Rash guards - Payable now	No	per piece	<b>30,00 €</b>
<b>RIB</b> (Payable now) <b>Season: 2026.</b> Highfield CL 360 RIB (12' 18HP) - Payable now	No	per booking	<b>500,00 €</b>
<b>Snorkeling Vests</b> (Payable now) <b>Season: 2026.</b> Payable now	No	per week	<b>10,00 €</b>
<b>Stand up paddle (SUP)</b> (Payable now) <b>Season: 2026.</b> Epoxy or Inflatable - Payable now	No	per day	<b>27,00 €</b>
<b>Straw hat</b> (Payable now) <b>Season: 2026.</b> Payable now	No	per piece	<b>40,00 €</b>
<b>Sunchill floats</b> (Payable now) <b>Season: 2026.</b> Payable now	No	per booking	<b>135,00 €</b>
<b>Surf board</b> (Payable now) <b>Season: 2026.</b> Payable now	No	per booking	<b>22,00 €</b>
<b>T-shirts</b> (Payable now) <b>Season: 2026.</b> Men or Women T-Shirts - Payable now	No	per piece	<b>25,00 €</b>



 **WEBSITE**  
www.plujeme.cz

 **E-MAIL**  
info@plujeme.cz

 **PHONE** No  
+420 720 755 085

 **PLUJEME RÁDI S.R.O.**  
Dlouhá 730/35, 11000 Praha 1 – Staré Město, Czech Republic

 **MOBILE** per day  
+420 777 170 276

**45,00 €**

## PRICE AND AVAILABILITY

01.08. - 15.10.2027

NOT AVAILABLE



**WEBSITE**

[www.plujeme.cz](http://www.plujeme.cz)



**E-MAIL**

[info@plujeme.cz](mailto:info@plujeme.cz)



**PHONE**

+420 720 755 085



**MOBILE**

+420 777 170 276



**PLUJEME RÁDI S.R.O.**

Dlouhá 730/35, 11000 Praha 1 – Staré Město, Czech Republic