

OCEANIS 51.1

Panda II (2022)

Sailing yacht Oceanis 51.1 Panda II, built in 2022 is anchored in the Marina Tehnomont Veruda, Pula, Istra, Croatia. It has 5 cabins, can accommodate 10 + 2 people and has 3 toilets. Bed linen and kitchen equipment are included in the price.

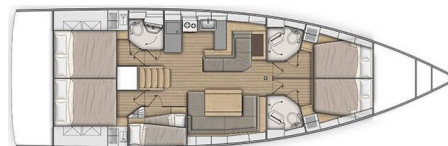

YACHT SPECIFICATIONS

Yacht Base

Marina Tehnomont Veruda, Pula, Croatia

Yacht ID

3664

Brands

Beneteau

Yacht name

Panda II

Production year

2022

Length

52 ft

Cabins

5

Berths

10 + 2

Max Persons

12

WC

3

Engine

1 x 110 HP

Fuel tank

200 l



WEBSITE

www.plujeme.cz



PHONE

+420 720 755 085



MOBILE

+420 777 170 276



E-MAIL

info@plujeme.cz



PLUJEME RÁDI S.R.O.

Dlouhá 730/35, 11000 Praha 1 – Staré Město, Czech Republic

STANDARD YACHT EQUIPMENT

Additional	Flag
Comfort	Bed linen, Blankets, Cockpit cushions, Pillows
Deck	Bathing platform, Bilge pump – Mechanic, Bimini top, Boat hook, Bosun's chair (Safe seat) (boatswain's chair), Cockpit table with light, Cockpit/stern, outside shower, Deck brush, Dinghy, Dinghy (byboat) pump, Electric anchor windlass, Fenders, Gangway, Ice box in cockpit, Impeller, V-belt, oilfilter, Jerry cans for diesel, Main anchor, Mooring ropes, Plastic bucket, Remote control for anchor winch with chain counter at helm, Round/globular fender, Sea/Storm drogue anchor, Side door for boarding, Spare anchor (Reserve, Auxiliary anchor), Sponge, Sprayhood, Spring line, Swimming ladder, Teak cockpit, Teak deck, Water hose, Winch handles
Entertainment	Bluetooth player, FUSION sound system, mp3 player, Outdoor speakers, Underwater lights, USB
Galley	Gas bottles, Gas cookers, Hot water, Kitchen utensils (Galley equipment, cutlery), Oven, Refrigerator, Sink, Water pump
Interior	Barometer, Clock, Clothes hangers, Electric fans, Inside shower, Upholstery, Walnut interior, Yacht documents, Yacht keys
Navigation	Autopilot, Binoculars, Bow thruster, Echosounder/Depthsounder, GPS chart plotter – cockpit, Hand bearing compass, Harbour guides, LED Navigation lights, Logge/Lot/Speed/Wind, Navigation (Nautical) charts and nautical guide, Navigation set, Radar reflector, Spyglass with bearing compass, Tridata, Wind instrument/Anemometer
Safety	Black Water Tank, Distress signals, Emergency tiller, Engine spare parts, Fire extinguisher, First aid kit, Flashlight, Fog horn, Life belts (Safety harness), Life buoy + Flashing light, Life jackets, Oars (Paddles), Set of tools, Thermal suit, VHF radio
Yacht electrics	Battery charger, Bilge pump – Electric, Heating, Plug 220V, 12 V, Service batteries, Shore connection 220 V, Solar panels, Start battery



WEBSITE
www.plujeme.cz



PHONE
+420 720 755 085



MOBILE
+420 777 170 276



E-MAIL
info@plujeme.cz



PLUJEME RÁDI S.R.O.
Dlouhá 730/35, 11000 Praha 1 – Staré Město, Czech Republic

SERVICES

SELECTED SERVICES	OBLIGATORY	PAYMENT TYPE	PRICE
Package for Accommodation (Payable now) Season: 2026. Accommodation Charter Package: Final cleaning, bed linen, towels (1x large, 1x small per person), 2x gas cylinder, dishwashing liquid, kitchen sponge, 2x kitchen towel, check-in and check-out service, diver on regular check-out	Yes	per booking	375,00 €
Cook (Payable at the base) Season: 2026.	No	per day + food	220,00 €
Deposit insurance (Payable at the base) Season: 2026. cash, not refundable + 400,00 EUR (cash or credit card, refundable)	No	per week	300,00 €
Diver (Payable at the base) Season: 2026. Non-standard check-out	No	per service	70,00 €
Early boarding/check-in (Payable at the base) Season: 2026. from 13h-14h, limited capacity	No	per booking	170,00 €
Hostess (Payable at the base) Season: 2026.	No	per day + food	170,00 €
One way fee (Payable at the base) Season: 2026. on request	No	per booking	0,00 €
Overnight on board (Payable at the base) Season: 2026. if possible	No	per booking	170,00 €
Permission for int. Waters (Payable at the base) Season: 2026. on request	No	per booking	0,00 €
Pet on board (Payable at the base) Season: 2026. small pets, on request only	No	per booking	150,00 €
Provisioning (Payable at the base) Season: 2026. + bill (buy and delivery service)	No	per booking	75,00 €
Skipper (Payable at the base) Season: 2026.	No	per day + food	200,00 €

Transfer (Payable at the base) Season: 2026. Airport Pula – Marina Veruda, 1 - 4 pax	No	one-way	45,00 €
Transfer (Payable at the base) Season: 2026. Airport Pula – Marina Veruda, 5 - 8 pax	No	one-way	55,00 €
VIP check-in (Payable at the base) Season: 2026. till 12:30h, limited capacity	No	per booking	230,00 €
WI-FI Internet connection on boat (Payable at the base) Season: 2026. Flat rate	No	per week	35,00 €



WEBSITE
www.plujeme.cz



E-MAIL
info@plujeme.cz



PHONE
+420 720 755 085



MOBILE
+420 777 170 276



PLUJEME RÁDI S.R.O.
Dlouhá 730/35, 11000 Praha 1 – Staré Město, Czech Republic

ADDITIONAL EXTRAS

EXTRA	OBLIGATORY	PAYMENT TYPE	PRICE
Additional gas bottle (Payable at the base) Season: 2026. Payable at the base	No	per piece	15,00 €
Automatic Inflatable Life Jacket (Payable at the base) Season: 2026. Payable at the base	No	per piece	30,00 €
Extra bedlinen (Payable at the base) Season: 2026. Payable at the base	No	per set	10,00 €
Inverter (Payable at the base) Season: 2026. 12V/220V - Payable at the base	No	per week	30,00 €
Outboard engine (Payable at the base) Season: 2026. 2,3 HP - Payable at the base	No	per week	90,00 €
Outboard engine (Payable at the base) Season: 2026. 6 HP - Payable at the base	No	per week	130,00 €
Railing net (Safety net) (Payable at the base) Season: 2026. Payable at the base	No	per booking	140,00 €
Stand up paddle (SUP) (Payable at the base) Season: 2026. Payable at the base	No	per week	120,00 €
Towels (Payable at the base) Season: 2026. set - Payable at the base	No	per set	7,00 €



WEBSITE
www.plujeme.cz



E-MAIL
info@plujeme.cz



PHONE
+420 720 755 085



MOBILE
+420 777 170 276



PLUJEME RÁDI S.R.O.
Dlouhá 730/35, 11000 Praha 1 - Staré Město, Czech Republic

PRICE AND AVAILABILITY

25.04. - 02.05.2026 2.190 € 3.650 €	02.05. - 09.05.2026 2.190 € 3.650 €	09.05. - 16.05.2026 NOT AVAILABLE	16.05. - 23.05.2026 2.730 € 4.550 €
23.05. - 26.05.2026 NOT AVAILABLE	30.05. - 06.06.2026 NOT AVAILABLE	06.06. - 13.06.2026 NOT AVAILABLE	13.06. - 20.06.2026 NOT AVAILABLE
20.06. - 27.06.2026 5.040 € 7.200 €	27.06. - 04.07.2026 5.040 € 7.200 €	04.07. - 11.07.2026 NOT AVAILABLE	11.07. - 18.07.2026 5.040 € 7.200 €
18.07. - 25.07.2026 NOT AVAILABLE	25.07. - 01.08.2026 NOT AVAILABLE	01.08. - 08.08.2026 5.390 € 7.700 €	08.08. - 15.08.2026 5.390 € 7.700 €
15.08. - 22.08.2026 5.040 € 7.200 €	22.08. - 29.08.2026 NOT AVAILABLE	29.08. - 05.09.2026 ON OPTION	05.09. - 12.09.2026 5.160 € 6.450 €
12.09. - 19.09.2026 NOT AVAILABLE	19.09. - 26.09.2026 NOT AVAILABLE	26.09. - 03.10.2026 3.640 € 4.550 €	03.10. - 10.10.2026 2.920 € 3.650 €
10.10. - 17.10.2026 2.440 € 3.050 €	17.10. - 24.10.2026 2.240 € 2.800 €	24.10. - 31.10.2026 2.240 € 2.800 €	31.10. - 07.11.2026 2.800 €
07.11. - 14.11.2026 2.800 €	14.11. - 21.11.2026 2.800 €	21.11. - 28.11.2026 2.800 €	28.11. - 05.12.2026 2.800 €



WEBSITE

www.plujeme.cz



E-MAIL

info@plujeme.cz



PHONE

+420 720 755 085



MOBILE

+420 777 170 276



PLUJEME RÁDI S.R.O.

Dlouhá 730/35, 11000 Praha 1 – Staré Město, Czech Republic

PRICE AND AVAILABILITY

05.12. - 12.12.2026

2.800 €

12.12. - 19.12.2026

2.800 €

19.12. - 26.12.2026

2.800 €



WEBSITE

www.plujeme.cz



E-MAIL

info@plujeme.cz



PHONE

+420 720 755 085



MOBILE

+420 777 170 276



PLUJEME RÁDI S.R.O.

Dlouhá 730/35, 11000 Praha 1 – Staré Město, Czech Republic