

# ELAN IMPRESSION 45.1

Ianira (2021)

Sailing yacht **Elan Impression 45.1 Ianira**, built in **2021** is anchored in the **Marina Kornati, Biograd, Zadar region, Croatia**. It has **3 cabins**, can accommodate **6 + 2 people** and has **2 toilets**. Bed linen and kitchen equipment are included in the price.

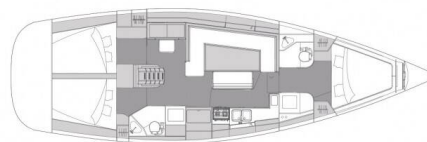

## YACHT SPECIFICATIONS

Yacht Base

**Marina Kornati, Biograd, Croatia**

Yacht ID

**3486**

Brands

**Elan Marine**

Yacht name

**Ianira**

Production year

**2021**

Length

**44 ft**

Cabins

**3**

Berths

**6 + 2**

WC

**2**

Engine

**1 x 75 HP**

Fuel tank

**215 l**



**WEBSITE**

[www.plujeme.cz](http://www.plujeme.cz)



**PHONE**

+420 720 755 085



**MOBILE**

+420 777 170 276



**E-MAIL**

[info@plujeme.cz](mailto:info@plujeme.cz)



**PLUJEME RÁDI S.R.O.**

Dlouhá 730/35, 11000 Praha 1 – Staré Město, Czech Republic

## STANDARD YACHT EQUIPMENT

Comfort	<b>Cockpit cushions</b>
Deck	<b>Anchor with chain, Bathing platform, Bimini top, Bosun's chair (Safe seat) (boatswain's chair), Cockpit fridge, Cockpit grill, Cockpit table, Cockpit/stern, outside shower, Dinghy, Electric anchor windlass, Fenders, Mooring ropes, Sea/Storm drogue anchor, Spare anchor (Reserve, Auxiliary anchor), Sprayhood, Teak cockpit</b>
Entertainment	<b>Outdoor speakers, Radio CD mp3 player + USB</b>
Galley	<b>Gas bottles, Hot water, Kitchen utensils (Galley equipment, cutlery), Refrigerator, Stove</b>
Interior	<b>Convertible table in salon</b>
Navigation	<b>AIS, Autopilot, Bow thruster, Compass, Depthsounder, Divider, nautic chart, GPS chart plotter, GPS chart plotter - cockpit, Hand bearing compass, Harbour guides, Log/speed instrument, Nautical charts, Radar reflector, Wind instrument/Anemometer, Windex</b>
Safety	<b>Black Water Tank, Emergency tiller, Fire extinguisher, First aid kit, Fog horn, Life belts (Safety harness), Life jackets, Signal rockets and torches, VHF radio, Wire (shroud) cutter</b>
Sails	<b>Lazy bag, Lazy jacks</b>
Yacht electrics	<b>Battery charger, DSC station, Heating, Inverter, Solar panels, USB sockets</b>



**WEBSITE**

[www.plujeme.cz](http://www.plujeme.cz)



**PHONE**

+420 720 755 085



**MOBILE**

+420 777 170 276



**E-MAIL**

[info@plujeme.cz](mailto:info@plujeme.cz)



**PLUJEME RÁDI S.R.O.**

Dlouhá 730/35, 11000 Praha 1 – Staré Město, Czech Republic

## SERVICES

SELECTED SERVICES	OBLIGATORY	PAYMENT TYPE	PRICE
<b>Base costs</b> (Payable at the base) <b>Season: 2026.</b> Check-in, check-out, Final cleaning, bed linen per person on crew list, Diver at the check-out, Gas	Yes	per booking	<b>300,00 €</b>
<b>Deposit insurance</b> (Payable at the base) <b>Season: 2026.</b> The non-refundable deposit can be purchased on-site at a cost of ca. 12% of the deposit for the first and second week. For charters lasting three or more weeks, a new deposit insurance policy must be purchased. Please note that the deposit insurance does not cover clogged toilets, waste tanks, or missing fuel. Therefore, a refundable part of the deposit is mandatory: 500 EUR (payable in cash or by credit card).	No	per booking	<b>270,00 €</b>
<b>Overnight on board</b> (Payable at the base) <b>Season: 2026.</b> depending on availability	No	per booking	<b>200,00 €</b>
<b>Pet on board</b> (Payable at the base) <b>Season: 2026.</b>	No	per booking	<b>150,00 €</b>
<b>Priority check in</b> (Payable now) <b>Season: 2026.</b> check in between 13:00 - 14:00h. Limited offer, max 5 boats per Saturday	No	per booking	<b>200,00 €</b>



**WEBSITE**

[www.plujeme.cz](http://www.plujeme.cz)



**PHONE**

+420 720 755 085



**MOBILE**

+420 777 170 276



**E-MAIL**

[info@plujeme.cz](mailto:info@plujeme.cz)



**PLUJEME RÁDI S.R.O.**

Dlouhá 730/35, 11000 Praha 1 – Staré Město, Czech Republic

## ADDITIONAL EXTRAS

EXTRA	OBLIGATORY	PAYMENT TYPE	PRICE
<b>Automatic Inflatable Life Jacket</b> (Payable at the base) <i>Season: 2026. Payable at the base</i>	No	per week/ person	<b>15,00 €</b>
<b>Extra bedlinen</b> (Payable at the base) <i>Season: 2026. Payable at the base</i>	No	per cabin	<b>12,00 €</b>
<b>Outboard engine</b> (Payable at the base) <i>Season: 2026. +fuel (5L) - Payable at the base</i>	No	per week	<b>80,00 €</b>
<b>Railing net (Safety net)</b> (Payable at the base) <i>Season: 2026. Payable at the base</i>	No	per booking	<b>80,00 €</b>
<b>Stand up paddle (SUP)</b> (Payable at the base) <i>Season: 2026. Payable at the base</i>	No	per week	<b>80,00 €</b>
<b>Towels</b> (Payable at the base) <i>Season: 2026. (2 towels size 50 x 100, 1 towel size 70 x 140 / per person) - Payable at the base</i>	No	per set	<b>8,00 €</b>



**WEBSITE**

[www.plujeme.cz](http://www.plujeme.cz)



**E-MAIL**

[info@plujeme.cz](mailto:info@plujeme.cz)



**PHONE**

+420 720 755 085



**MOBILE**

+420 777 170 276



**PLUJEME RÁDI S.R.O.**

Dlouhá 730/35, 11000 Praha 1 – Staré Město, Czech Republic

## PRICE AND AVAILABILITY

01.05. - 03.05.2026 NOT AVAILABLE	09.05. - 16.05.2026 NOT AVAILABLE	16.05. - 23.05.2026 1.650 € 2.750 €	23.05. - 30.05.2026 2.130 € 3.550 €
30.05. - 06.06.2026 ON OPTION	06.06. - 13.06.2026 NOT AVAILABLE	13.06. - 27.06.2026 NOT AVAILABLE	27.06. - 04.07.2026 2.958 € 4.550 €
04.07. - 11.07.2026 3.094 € 4.550 €	11.07. - 18.07.2026 NOT AVAILABLE	18.07. - 25.07.2026 3.185 € 4.550 €	25.07. - 15.08.2026 NOT AVAILABLE
15.08. - 22.08.2026 2.923 € 3.950 €	22.08. - 29.08.2026 NOT AVAILABLE	29.08. - 12.09.2026 NOT AVAILABLE	12.09. - 19.09.2026 NOT AVAILABLE
19.09. - 26.09.2026 1.938 € 2.550 €	26.09. - 03.10.2026 1.678 € 2.330 €	03.10. - 10.10.2026 1.568 € 2.240 €	10.10. - 17.10.2026 1.568 € 2.240 €
17.10. - 24.10.2026 1.568 € 2.240 €	25.10. - 31.12.2026 NOT AVAILABLE		



### WEBSITE

[www.plujeme.cz](http://www.plujeme.cz)



### E-MAIL

[info@plujeme.cz](mailto:info@plujeme.cz)



### PHONE

+420 720 755 085



### MOBILE

+420 777 170 276



### PLUJEME RÁDI S.R.O.

Dlouhá 730/35, 11000 Praha 1 – Staré Město, Czech Republic