

# HANSE 548

Mila Felice (2019)

Sailing yacht Hanse 548 Mila Felice, built in 2019 is anchored in the Trogir, Yachtclub Seget (Marina Baotić), Split region, Croatia. It has 4 + 1 cabins, can accommodate 8 + 1 people and has 4 + 1 toilets. Bed linen and kitchen equipment are included in the price.

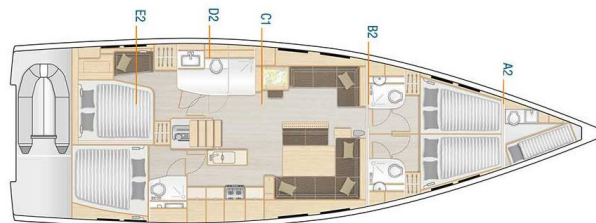

## YACHT SPECIFICATIONS

Yacht Base

**Trogir, Yachtclub Seget (Marina Baotić), Croatia**

Yacht ID

**3442**

Brands

**Hanse Yachts**

Yacht name

**Mila Felice**

Production year

**2019**

Length

**53 ft**

Cabins

**4 + 1**

Berths

**8 + 1**

WC

**4 + 1**

Engine

**1 x 110 HP**

Fuel tank

**520 l**



**WEBSITE**

[www.plujeme.cz](http://www.plujeme.cz)



**PHONE**

+420 720 755 085



**MOBILE**

+420 777 170 276



**E-MAIL**

[info@plujeme.cz](mailto:info@plujeme.cz)



**PLUJEME RÁDI S.R.O.**

Dlouhá 730/35, 11000 Praha 1 – Staré Město, Czech Republic

## STANDARD YACHT EQUIPMENT

Comfort	<b>Bed linen, Blankets, Cockpit cushions, Pillows, Towels</b>
Deck	<b>Anchor with chain, Bimini top, Cockpit table, Cockpit/stern, outside shower, Dinghy, Electric anchor windlass, Fenders, Gangway, Mooring ropes, Spare anchor (Reserve, Auxiliary anchor), Sprayhood</b>
Entertainment	<b>Indoor speakers, Outdoor speakers, Radio CD mp3 player + USB, TV, Wi-Fi Internet</b>
Galley	<b>Coffee machine, Kitchen utensils (Galley equipment, cutlery), Microwave, Refrigerator</b>
Interior	<b>Electric toilet</b>
Navigation	<b>Autopilot, Bow thruster, Compass, Divider, nautic chart, GPS chart plotter, Harbour guides, Nautical charts, Navigation set, Stern thruster, Wind instrument/Anemometer</b>
Safety	<b>Distress signals, Fire extinguisher, First aid kit, Horseshoe lifebuoy, Life belts (Safety harness), Life jackets, Liferaft, VHF radio</b>
Yacht electrics	<b>Air Conditioning, Battery charger, Generator, Heating, Inverter, Shore connection 220 V</b>



#### WEBSITE

[www.plujeme.cz](http://www.plujeme.cz)



#### E-MAIL

[info@plujeme.cz](mailto:info@plujeme.cz)



#### PHONE

+420 720 755 085



#### MOBILE

+420 777 170 276



#### PLUJEME RÁDI S.R.O.

Dlouhá 730/35, 11000 Praha 1 – Staré Město, Czech Republic

## SERVICES

SELECTED SERVICES	OBLIGATORY	PAYMENT TYPE	PRICE
<b>Comfort Pack</b> (Payable at the base) <b>Season: 2026.</b> payable in advance with reservation or upon check-in in cash or credit card; includes: VAT 25%, bed linen, towels, final cleaning, diver check upon check-out, Nespresso coffee machine, gas in the kitchen, small start up kit, 5l fuel for the outboard engine	Yes	per booking	<b>420,00 €</b>
<b>Marina ECO fee</b> (Payable at the base) <b>Season: 2026.</b> Electricity, water, recycling garbage disposal	Yes	per booking	<b>80,00 €</b>
<b>Skipper</b> (Payable at the base) <b>Season: 2026.</b>	Yes	per week + food	<b>2.200,00 €</b>
<b>45D Bareboat Assist</b> (Payable at the base) <b>Season: 2026.</b> (By Application Only - Limited Availability) Includes Itinerary Planning with the added support of the 45D team providing around-the-clock assistance with weather, port reservations, restaurant bookings and route adjustments, Bareboat Assist is the safety-net that you need to make your charter week stress-free! Must be booked at least 10 weeks in advance of your charter date.	No	per week	<b>1.090,00 €</b>
<b>45D Itinerary Plan</b> (Payable at the base) <b>Season: 2026.</b> (By Application Only) Following a personalized consultation call, you will receive a tailor made online mapped itinerary, and a comprehensive PDF itinerary guide, covering everything you need for your charter. Must be booked at least 10 weeks in advance of your charter date.	No	per week	<b>390,00 €</b>
<b>Active sailing experience/Sailing coaching</b> (Payable at the base) <b>Season: 2026.</b> *only if booking a skipper for a week It includes: -sailing tips -manoeuvre basics -anchoring -navigation basics	No	per booking	<b>400,00 €</b>
<b>Cook</b> (Payable at the base) <b>Season: 2026.</b> payable to cook	No	per day + food	<b>250,00 €</b>
<b>Deposit insurance</b> (Payable at the base) <b>Season: 2026.</b> + 400€ refundable	No	per booking	<b>400,00 €</b>
<b>Early boarding/check-in</b> (Payable at the base) <b>Season: 2026.</b> at 13:00h	No	per booking	<b>200,00 €</b>

<b>Extra cleaning</b> (Payable at the base) <b>Season: 2026.</b>	No	per booking	<b>250,00 €</b>
<b>Hostess</b> (Payable at the base) <b>Season: 2026.</b> payable to hostess	No	per day + food	<b>190,00 €</b>
<b>Parking</b> (Payable at the base) <b>Season: 2026.</b> Marina Baotic; Can be ordered in advanced with booking, payable in our office	No	per week	<b>80,00 €</b>
<b>Permit for Montenegro</b> (Payable at the base) <b>Season: 2026.</b>	No	per booking	<b>400,00 €</b>
<b>Pet on board</b> (Payable at the base) <b>Season: 2026.</b> (small or medium dog up to 25 kg)	No	per pet	<b>100,00 €</b>
<b>Provisioning</b> (Payable at the base) <b>Season: 2026.</b> Upon request + price of groceries, to be done online	No	per booking	<b>0,00 €</b>
<b>Sail refreshment</b> (Payable at the base) <b>Season: 2026.</b> Join us for a hands-on sailing refresher course designed for those looking to sharpen their skills. Led by a professional skipper, this 5-hour session takes place every Sunday from 10 AM to 3 PM, offering a perfect blend of practical sailing techniques and expert guidance. Whether you're preparing for a charter or simply want to enhance your knowledge, this course will get you confidently back on the water.	No	per booking	<b>390,00 €</b>
<b>Transfer</b> (Payable at the base) <b>Season: 2026.</b> Taxi transfer Split airport - Marina Baotic or vice versa; up to 4 pax	No	one-way	<b>50,00 €</b>
<b>Transfer</b> (Payable at the base) <b>Season: 2026.</b> Taxi transfer Split airport - Marina Baotic or vice versa; up to 8 pax	No	one-way	<b>65,00 €</b>



**WEBSITE**  
www.plujeme.cz



**PHONE**  
+420 720 755 085



**MOBILE**  
+420 777 170 276



**E-MAIL**  
info@plujeme.cz



**PLUJEME RÁDI S.R.O.**  
Dlouhá 730/35, 11000 Praha 1 - Staré Město, Czech Republic

## ADDITIONAL EXTRAS

EXTRA	OBLIGATORY	PAYMENT TYPE	PRICE
<b>Beach towel</b> (Payable at the base) <b>Season: 2026.</b> Payable at the base	No	per piece	<b>8,00 €</b>
<b>eFoil</b> (Payable at the base) <b>Season: 2026.</b> Payable at the base	No	per week	<b>2.000,00 €</b>
<b>Extra bedlinen</b> (Payable at the base) <b>Season: 2026.</b> Payable at the base	No	per person	<b>15,00 €</b>
<b>Floating Island</b> (Payable at the base) <b>Season: 2026.</b> Suitable for 6-8 person - Payable at the base	No	per week	<b>360,00 €</b>
<b>Gennaker</b> (Payable at the base) <b>Season: 2026.</b> + Security deposit 500 Euro available upon request and boat model, to confirmation with the charter company - Payable at the base	No	per week	<b>350,00 €</b>
<b>Grill/Barbecue/Plancha</b> (Payable at the base) <b>Season: 2026.</b> Payable at the base	No	per booking	<b>200,00 €</b>
<b>Ice maker</b> (Payable at the base) <b>Season: 2026.</b> Payable at the base	No	per week	<b>120,00 €</b>
<b>Kayak</b> (Payable at the base) <b>Season: 2026.</b> Inflatable, for 2 people - Payable at the base	No	per week	<b>200,00 €</b>
<b>Outboard engine 5 HP</b> (Payable at the base) <b>Season: 2026.</b> 5 HP; availability on request - Payable at the base	No	per booking	<b>200,00 €</b>
<b>Railing net (Safety net)</b> (Payable at the base) <b>Season: 2026.</b> Rental without mounting - Payable at the base	No	per booking	<b>30,00 €</b>
<b>Sea Scooter</b> (Payable at the base) <b>Season: 2026.</b> Payable at the base	No	per week	<b>360,00 €</b>
<b>Seabob</b> (Payable at the base) <b>Season: 2026.</b> Model F5 - Payable at the base	No	per week	<b>1.200,00 €</b>
<b>Seabob</b> (Payable at the base) <b>Season: 2026.</b> Model F5SR - Payable at the base	No	per week	<b>1.500,00 €</b>

<b>Self inflating life vest</b> (Payable at the base) <b>Season: 2026.</b> Payable at the base	No	per person	<b>15,00 €</b>
<b>Snorkeling equipment</b> (Payable at the base) <b>Season: 2026.</b> fin, mask, snorkel - Payable at the base	No	per set	<b>20,00 €</b>
<b>Stand up paddle (SUP)</b> (Payable at the base) <b>Season: 2026.</b> Payable at the base	No	per week	<b>150,00 €</b>
<b>Wakeboard</b> (Payable at the base) <b>Season: 2026.</b> Ravik 3 model - Payable at the base	No	per week	<b>2.500,00 €</b>



**WEBSITE**  
www.plujeme.cz



**E-MAIL**  
info@plujeme.cz



**PHONE**  
+420 720 755 085



**MOBILE**  
+420 777 170 276



**PLUJEME RÁDI S.R.O.**  
Dlouhá 730/35, 11000 Praha 1 – Staré Město, Czech Republic

## PRICE AND AVAILABILITY

25.04. - 02.05.2026 3.565 €	02.05. - 09.05.2026 4.590 €	09.05. - 16.05.2026 NOT AVAILABLE	16.05. - 23.05.2026 4.590 €
23.05. - 30.05.2026 NOT AVAILABLE	30.05. - 06.06.2026 NOT AVAILABLE	06.06. - 13.06.2026 NOT AVAILABLE	13.06. - 27.06.2026 NOT AVAILABLE
27.06. - 04.07.2026 7.795 €	04.07. - 11.07.2026 NOT AVAILABLE	11.07. - 18.07.2026 8.990 €	18.07. - 25.07.2026 NOT AVAILABLE
25.07. - 08.08.2026 NOT AVAILABLE	08.08. - 15.08.2026 NOT AVAILABLE	15.08. - 22.08.2026 8.990 €	22.08. - 29.08.2026 NOT AVAILABLE
29.08. - 05.09.2026 NOT AVAILABLE	05.09. - 19.09.2026 NOT AVAILABLE	19.09. - 26.09.2026 7.795 €	26.09. - 03.10.2026 7.795 €
03.10. - 10.10.2026 NOT AVAILABLE	14.10. - 31.10.2026 NOT AVAILABLE	01.11. - 14.11.2026 NOT AVAILABLE	15.11. - 31.12.2026 NOT AVAILABLE



### WEBSITE

[www.plujeme.cz](http://www.plujeme.cz)



### E-MAIL

[info@plujeme.cz](mailto:info@plujeme.cz)



### PHONE

+420 720 755 085



### MOBILE

+420 777 170 276



### PLUJEME RÁDI S.R.O.

Dlouhá 730/35, 11000 Praha 1 – Staré Město, Czech Republic