

ELAN IMPRESSION 45.1

Lan (2021)

Sailing yacht **Elan Impression 45.1 Lan**, built in **2021** is anchored in the **Marina Kastela, Split region, Croatia**. It has **4 cabins**, can accommodate **8 + 2 people** and has **2 toilets**. Bed linen and kitchen equipment are included in the price.

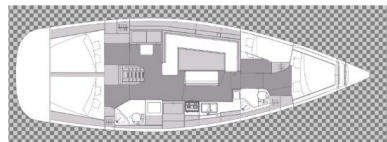

YACHT SPECIFICATIONS

Yacht Base

Marina Kastela, Croatia

Yacht ID

3434

Brands

Elan Marine

Yacht name

Lan

Production year

2021

Length

44 ft

Cabins

4

Berths

8 + 2

Max Persons

10

WC

2

Engine

1 x 50 HP

Fuel tank

215 l



WEBSITE

www.plujeme.cz



PHONE

+420 720 755 085



MOBILE

+420 777 170 276



E-MAIL

info@plujeme.cz



PLUJEME RÁDI S.R.O.

Dlouhá 730/35, 11000 Praha 1 – Staré Město, Czech Republic

STANDARD YACHT EQUIPMENT

Comfort	Cockpit cushions
Deck	Anchor with chain, Bathing platform, Bimini top, Cockpit fridge, Cockpit grill, Cockpit table, Cockpit/stern, outside shower, Dinghy, Electric anchor windlass, Grill/Barbecue/Plancha, Sprayhood, Teak cockpit
Entertainment	Radio CD mp3 player + USB
Galley	Freezer, Hot water, Kitchen utensils (Galley equipment, cutlery), Oven, Refrigerator
Interior	Convertible table
Navigation	Autopilot, Bow thruster, Compass, Echosounder/Depthsounder, GPS chart plotter - cockpit, Navigation (Nautical) charts and nautical guide, Navigation set, Wind instrument/Anemometer
Safety	Black Water Tank, First aid kit, Life jackets, Safety equipment, Set of tools, VHF radio
Yacht electrics	Air Conditioning, Inverter, Shore connection 220 V

**WEBSITE**

www.plujeme.cz

**E-MAIL**

info@plujeme.cz

**PHONE**

+420 720 755 085

**MOBILE**

+420 777 170 276

**PLUJEME RÁDI S.R.O.**

Dlouhá 730/35, 11000 Praha 1 – Staré Město, Czech Republic

SERVICES

SELECTED SERVICES	OBLIGATORY	PAYMENT TYPE	PRICE
Transit log (Payable now) Season: 2026. Cleaning, Bed linens (one per person), Towels (one per person 70*140), Wifi, Outboard engine, Fuel for outboard engine (2,5 l), Diver check, 2*bottles of gas, Eco welcome pack (biodegradable dishwashing liquid, sponge, 2*dishtowel, biodegradable garbage bags)	Yes	per booking	320,00 €
Damage waiver (Payable at the base) Season: 2026. +500EUR refundable deposit	No	per booking	400,00 €
Early Check in (Payable at the base) Season: 2026. at 13:00h (*confirmation at the base)	No	per booking	155,00 €
Extra cleaning (Payable at the base) Season: 2026.	No	per booking	210,00 €
Generator (Payable at the base) Season: 2026. portable generator Honda 22i, upon availability	No	per week	155,00 €
One way (Payable at the base) Season: 2026. Kastela - Dubrovnik / Dubrovnik - Kastela - on request only, one way fee, check in time in Dubrovnik - Sunday from 4 p.m., check out time in Dubrovnik Friday until 9 a.m., berth charges in Dubrovnik port of embarkation / disembarkation are not included in price	No	one-way	700,00 €
Pet on board (Payable at the base) Season: 2026. extra cleaning	No	per booking	120,00 €
Skipper (Payable at the base) Season: 2026. + own cabin	No	per day + food	180,00 €
Transfer (Payable at the base) Season: 2026. Airport / Port - Marina: 1- 4 pax.	No	one-way	35,00 €
Transfer (Payable at the base) Season: 2026. Airport / Port - Marina: one way, 5-8 pax.	No	one-way	45,00 €



WEBSITE

www.plujeme.cz



PHONE

+420 720 755 085



MOBILE

+420 777 170 276



E-MAIL

info@plujeme.cz



PLUJEME RÁDI S.R.O.

Dlouhá 730/35, 11000 Praha 1 - Staré Město, Czech Republic

ADDITIONAL EXTRAS

EXTRA	OBLIGATORY	PAYMENT TYPE	PRICE
Beach towel (Payable at the base) Season: 2026. Payable at the base	No	per piece	15,00 €
Extra bedlinen (Payable at the base) Season: 2026. Payable at the base	No	per set	5,00 €
Extra towels (Payable at the base) Season: 2026. 70*140 - Payable at the base	No	per piece	3,00 €
Fuel for an outboard engine - 5 lit. (Payable at the base) Season: 2026. Payable at the base	No	per piece	15,00 €
Gennaker (Payable at the base) Season: 2026. following equipment list - Payable at the base	No	per week	155,00 €
Inflatable lifejacket (Payable at the base) Season: 2026. Payable at the base	No	per week	8,00 €
Railing net (Safety net) (Payable at the base) Season: 2026. Payable at the base	No	per booking	70,00 €
Snorkeling equipment (Payable at the base) Season: 2026. set / week - Payable at the base	No	per week	15,00 €
Stand up paddle (SUP) (Payable at the base) Season: 2026. Payable at the base	No	per week	100,00 €



WEBSITE
www.plujeme.cz



E-MAIL
info@plujeme.cz



PHONE
+420 720 755 085



MOBILE
+420 777 170 276



PLUJEME RÁDI S.R.O.
Dlouhá 730/35, 11000 Praha 1 - Staré Město, Czech Republic

PRICE AND AVAILABILITY

25.04. - 02.05.2026 NOT AVAILABLE	06.05. - 09.05.2026 NOT AVAILABLE	09.05. - 16.05.2026 1.495 € 2.300 €	16.05. - 23.05.2026 NOT AVAILABLE
23.05. - 30.05.2026 NOT AVAILABLE	30.05. - 13.06.2026 NOT AVAILABLE	13.06. - 20.06.2026 NOT AVAILABLE	20.06. - 27.06.2026 NOT AVAILABLE
27.06. - 04.07.2026 2.686 € 4.350 €	04.07. - 11.07.2026 NOT AVAILABLE	11.07. - 18.07.2026 NOT AVAILABLE	18.07. - 25.07.2026 NOT AVAILABLE
25.07. - 01.08.2026 NOT AVAILABLE	01.08. - 08.08.2026 NOT AVAILABLE	08.08. - 15.08.2026 NOT AVAILABLE	15.08. - 22.08.2026 NOT AVAILABLE
22.08. - 29.08.2026 NOT AVAILABLE	29.08. - 05.09.2026 NOT AVAILABLE	05.09. - 12.09.2026 2.633 € 4.050 €	12.09. - 19.09.2026 NOT AVAILABLE
19.09. - 26.09.2026 NOT AVAILABLE	26.09. - 03.10.2026 1.800 € 3.000 €	03.10. - 10.10.2026 1.541 € 2.300 €	10.10. - 17.10.2026 1.470 € 2.100 €
17.10. - 24.10.2026 1.470 € 2.100 €	24.10. - 31.10.2026 1.470 € 2.100 €	31.10. - 07.11.2026 1.785 € 2.100 €	07.11. - 14.11.2026 2.100 €
14.11. - 21.11.2026 2.100 €	21.11. - 28.11.2026 2.100 €	28.11. - 05.12.2026 2.100 €	



WEBSITE

www.plujeme.cz



E-MAIL

info@plujeme.cz



PHONE

+420 720 755 085



MOBILE

+420 777 170 276



PLUJEME RÁDI S.R.O.

Dlouhá 730/35, 11000 Praha 1 – Staré Město, Czech Republic

PRICE AND AVAILABILITY

05.12. - 12.12.2026

2.100 €

12.12. - 19.12.2026

2.100 €

19.12. - 26.12.2026

2.100 €



WEBSITE

www.plujeme.cz



E-MAIL

info@plujeme.cz



PHONE

+420 720 755 085



MOBILE

+420 777 170 276



PLUJEME RÁDI S.R.O.

Dlouhá 730/35, 11000 Praha 1 – Staré Město, Czech Republic