

OCEANIS 38

Olli (2014)

Sailing yacht **Oceanis 38 Olli**, built in **2014** is anchored in the **Marina Tehnomont Veruda, Pula, Istra, Croatia**. It has **3 cabins**, can accommodate **6 + 2 people** and has **1 toilets**. Bed linen and kitchen equipment are included in the price.

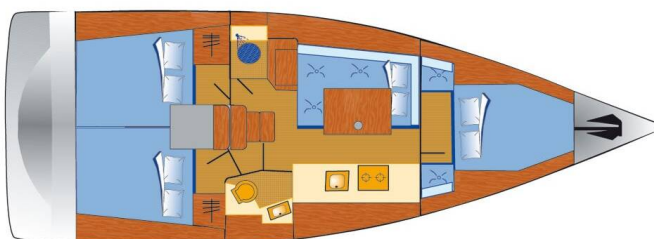

YACHT SPECIFICATIONS

Yacht Base

Marina Tehnomont Veruda, Pula, Croatia

Yacht ID

331

Brands

Beneteau

Yacht name

Olli

Production year

2014

Length

38 ft

Cabins

3

Berths

6 + 2

Max Persons

8

WC

1

Engine

1 x 30 HP

Fuel tank

130 l



WEBSITE

www.plujeme.cz



PHONE

+420 720 755 085



MOBILE

+420 777 170 276



E-MAIL

info@plujeme.cz



PLUJEME RÁDI S.R.O.

Dlouhá 730/35, 11000 Praha 1 – Staré Město, Czech Republic

STANDARD YACHT EQUIPMENT

Comfort	Blankets, Cockpit cushions, Pillows
Deck	Bathing platform, Bilge pump - Mechanic, Bimini top, Boat hook, Cockpit table, Cockpit/stern, outside shower, Electric anchor windlass, Fenders, Gangway, Main anchor, Mooring ropes, Round/globular fender, Spare anchor (Reserve, Auxiliary anchor), Sprayhood, Swimming ladder, Teak cockpit, Water hose, Winch handles
Entertainment	Outdoor speakers, Radio CD/MP3 player, AUX input, TV, Wi-Fi Internet
Galley	Gas bottles, Gas cookers, Hot water, Kitchen utensils (Galley equipment, cutlery), Oven, Refrigerator
Interior	Barometer, Clock, Electric toilet, Lowerable salon table, Safe
Navigation	AIS, Autopilot, Binoculars, Bow thruster, Compass, GPS chart plotter - cockpit, Hand bearing compass, Harbour guides, Navigation (Nautical) charts and nautical guide, Navigation set, Tridata, Wind instrument/Anemometer
Safety	Automatic Inflatable Life Jacket, Black Water Tank, Fire extinguisher, First aid kit, Flashlight, Fog horn, Life belts (Safety harness), Life buoy + Flashing light, Life jackets, Liferaft, Oars (Paddles), Repair kit, Signal rockets and torches, VHF radio
Yacht electrics	12V Socket, Batteries, Battery charger, Bilge pump - Electric, Converter 220V/12V, Heating, Inverter, Pump, Service batteries, Shore connection 220 V, Shore power cable



WEBSITE

www.plujeme.cz



PHONE

+420 720 755 085



MOBILE

+420 777 170 276



E-MAIL

info@plujeme.cz



PLUJEME RÁDI S.R.O.

Dlouhá 730/35, 11000 Praha 1 - Staré Město, Czech Republic

SERVICES

SELECTED SERVICES	OBLIGATORY	PAYMENT TYPE	PRICE
Basic package for accommodation (Payable at the base) Season: 2026. Cash or with credit card (VISA, MASTER) Cleaning, made Bed linen, Permit, WiFi, Cooking gas, Rinsing set, Dinghy	Yes	per booking	250,00 €
Deposit insurance (Payable at the base) Season: 2026. Cash / The customers still have to deposit 100,00 €. If there is no damage, they get the 100,00 € back. We do not require any prior information. The customer can take out insurance at check-in.	No	per booking	200,00 €
Early Check in (Payable at the base) Season: 2026. On request; from 13:00; Payable in cash at the base	No	per booking	150,00 €
Hostess (Payable at the base) Season: 2026. + own cabin	No	per day + food	150,00 €
Pet on board (Payable at the base) Season: 2026. ONLY ON REQUEST!; Payable in cash at the base	No	per booking	140,00 €
Skipper (Payable at the base) Season: 2026. On request; Free food, own cabin; Payable in cash at the base	No	per day	200,00 €
Transfer (Payable at the base) Season: 2026. Transfer from Marina Veruda (Pula Airport): The ride for 1-4 people costs €40. Payable in cash directly to the taxi driver.	No	one-way	40,00 €
Transfer (Payable at the base) Season: 2026. Transfer from Marina Veruda (Pula Airport): The ride for 5-8 people costs €50. Payable in cash directly to the taxi driver.	No	one-way	50,00 €



WEBSITE
www.plujeme.cz



PHONE
+420 720 755 085



MOBILE
+420 777 170 276



E-MAIL
info@plujeme.cz



PLUJEME RÁDI S.R.O.
Dlouhá 730/35, 11000 Praha 1 – Staré Město, Czech Republic

ADDITIONAL EXTRAS

EXTRA	OBLIGATORY	PAYMENT TYPE	PRICE
Grill/Barbecue/Plancha (Payable at the base) Season: 2026. Danish Cobb Gas Grill, 50% discount on 2nd week, Cash - Payable at the base	No	per week	100,00 €
Outboard engine (Payable at the base) Season: 2026. 50% second week; in Cash or with credit card (VISA, MASTER) - Payable at the base	No	per week	100,00 €
Stand up paddle (SUP) (Payable at the base) Season: 2026. 50% second week; Payable in cash at the base - Payable at the base	No	per week	100,00 €
Towels (Payable at the base) Season: 2026. 1x big one, 1x small one; Payable in cash at the base - Payable at the base	No	per set	10,00 €

**WEBSITE**www.plujeme.cz**E-MAIL**info@plujeme.cz**PHONE**

+420 720 755 085

**MOBILE**

+420 777 170 276

**PLUJEME RÁDI S.R.O.**

Dlouhá 730/35, 11000 Praha 1 – Staré Město, Czech Republic

PRICE AND AVAILABILITY

02.05. - 09.05.2026 980 € 1.400 €	09.05. - 16.05.2026 1.120 € 1.600 €	16.05. - 23.05.2026 NOT AVAILABLE	23.05. - 30.05.2026 NOT AVAILABLE
30.05. - 06.06.2026 1.750 € 2.500 €	06.06. - 13.06.2026 NOT AVAILABLE	13.06. - 27.06.2026 NOT AVAILABLE	27.06. - 04.07.2026 1.950 € 2.500 €
04.07. - 11.07.2026 2.262 € 2.900 €	11.07. - 18.07.2026 NOT AVAILABLE	18.07. - 25.07.2026 NOT AVAILABLE	25.07. - 01.08.2026 NOT AVAILABLE
01.08. - 08.08.2026 NOT AVAILABLE	08.08. - 15.08.2026 NOT AVAILABLE	15.08. - 22.08.2026 NOT AVAILABLE	22.08. - 29.08.2026 2.262 € 2.900 €
29.08. - 05.09.2026 2.262 € 2.900 €	05.09. - 12.09.2026 2.223 € 2.850 €	12.09. - 26.09.2026 NOT AVAILABLE	26.09. - 03.10.2026 NOT AVAILABLE
03.10. - 10.10.2026 1.248 € 1.600 €	10.10. - 17.10.2026 1.092 € 1.400 €	17.10. - 24.10.2026 1.092 € 1.400 €	24.10. - 31.10.2026 1.092 € 1.400 €
31.10. - 07.11.2026 1.092 € 1.400 €	07.11. - 14.11.2026 1.092 € 1.400 €	14.11. - 21.11.2026 1.400 €	21.11. - 28.11.2026 1.400 €
28.11. - 05.12.2026 1.400 €	05.12. - 12.12.2026 1.400 €	12.12. - 19.12.2026 1.400 €	19.12. - 26.12.2026 1.400 €



WEBSITE

www.plujeme.cz



E-MAIL

info@plujeme.cz



PHONE

+420 720 755 085



MOBILE

+420 777 170 276



PLUJEME RÁDI S.R.O.

Dlouhá 730/35, 11000 Praha 1 – Staré Město, Czech Republic

PRICE AND AVAILABILITY

01.01. - 26.03.2027 NOT AVAILABLE	27.03. - 03.04.2027 1.050 € 1.400 €	03.04. - 10.04.2027 1.050 € 1.400 €	10.04. - 17.04.2027 1.050 € 1.400 €
17.04. - 24.04.2027 1.050 € 1.400 €	24.04. - 01.05.2027 1.050 € 1.400 €	01.05. - 08.05.2027 1.050 € 1.400 €	08.05. - 15.05.2027 1.200 € 1.600 €
15.05. - 22.05.2027 1.200 € 1.600 €	22.05. - 29.05.2027 1.575 € 2.100 €	29.05. - 05.06.2027 1.875 € 2.500 €	05.06. - 12.06.2027 1.875 € 2.500 €
12.06. - 19.06.2027 1.875 € 2.500 €	19.06. - 26.06.2027 1.875 € 2.500 €	26.06. - 03.07.2027 1.875 € 2.500 €	03.07. - 10.07.2027 2.175 € 2.900 €
10.07. - 17.07.2027 2.175 € 2.900 €	17.07. - 24.07.2027 2.175 € 2.900 €	24.07. - 31.07.2027 2.175 € 2.900 €	31.07. - 07.08.2027 2.175 € 2.900 €
07.08. - 14.08.2027 2.175 € 2.900 €	14.08. - 21.08.2027 2.175 € 2.900 €	21.08. - 28.08.2027 2.175 € 2.900 €	28.08. - 04.09.2027 2.175 € 2.900 €



WEBSITE
www.plujeme.cz



E-MAIL
info@plujeme.cz



PHONE
+420 720 755 085



PLUJEME RÁDI S.R.O.
Dlouhá 730/35, 11000 Praha 1 – Staré Město, Czech Republic



MOBILE
+420 777 170 276

PRICE AND AVAILABILITY

04.09. - 11.09.2027 2.138 € 2.850 €	11.09. - 18.09.2027 2.138 € 2.850 €	18.09. - 25.09.2027 1.875 € 2.500 €	25.09. - 02.10.2027 1.575 € 2.100 €
02.10. - 09.10.2027 1.200 € 1.600 €	09.10. - 16.10.2027 1.050 € 1.400 €	16.10. - 23.10.2027 1.050 € 1.400 €	23.10. - 30.10.2027 1.050 € 1.400 €
30.10. - 06.11.2027 1.050 € 1.400 €	07.11. - 24.03.2028 NOT AVAILABLE		



WEBSITE

www.plujeme.cz



E-MAIL

info@plujeme.cz



PHONE

+420 720 755 085



MOBILE

+420 777 170 276



PLUJEME RÁDI S.R.O.

Dlouhá 730/35, 11000 Praha 1 – Staré Město, Czech Republic