

# LAGOON 450 F

Mantra (2016)

Catamaran Lagoon 450 F Mantra, built in 2016 is anchored in the Marina Pirovac, Šibenik region, Croatia. It has 4 + 2 cabins, can accommodate 8 + 2 + 2 people and has 4 toilets. Bed linen and kitchen equipment are included in the price.

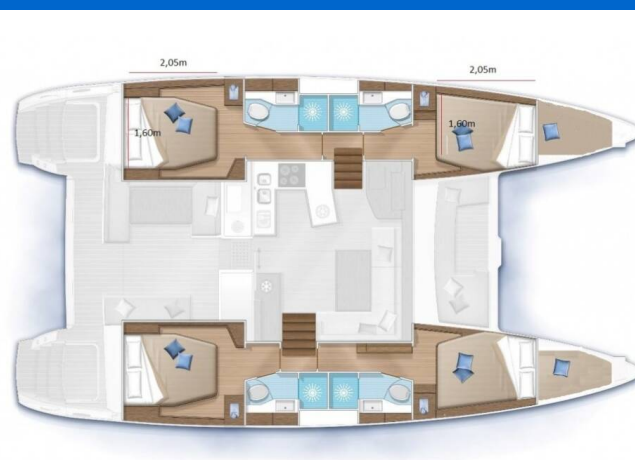

## YACHT SPECIFICATIONS

Yacht Base

**Marina Pirovac, Croatia**

Yacht ID

**3290**

Brands

**Lagoon**

Yacht name

**Mantra**

Production year

**2016**

Length

**46 ft**

Cabins

**4 + 2**

Berths

**8 + 2 + 2**

Max Persons

**12**

WC

**4**

Engine

**2 x 57 HP**

Fuel tank

**650 l**



**WEBSITE**

[www.plujeme.cz](http://www.plujeme.cz)



**PHONE**

+420 720 755 085



**MOBILE**

+420 777 170 276



**E-MAIL**

[info@plujeme.cz](mailto:info@plujeme.cz)



**PLUJEME RÁDI S.R.O.**

Dlouhá 730/35, 11000 Praha 1 – Staré Město, Czech Republic

## STANDARD YACHT EQUIPMENT

Deck	<b>Bimini top, Cockpit/stern, outside shower, Dinghy, Electric anchor windlass, Main anchor, Main Deck Compass, Spare anchor (Reserve, Auxiliary anchor), Teak deck</b>
Entertainment	<b>Fusion radio, Outdoor speakers, Radio</b>
Galley	<b>Hot water, Microwave, Oven, Refrigerator</b>
Interior	<b>LED lights</b>
Navigation	<b>Autopilot, Depthsounder, GPS, GPS chart plotter, GPS chart plotter - cockpit, Speedometer (Speed log)</b>
Safety	<b>Distress signals, Life belts (Safety harness), Liferaft</b>
Sails	<b>Lazy jacks</b>
Yacht electrics	<b>Generator, Inverter</b>



#### WEBSITE

[www.plujeme.cz](http://www.plujeme.cz)



#### E-MAIL

[info@plujeme.cz](mailto:info@plujeme.cz)



#### PHONE

+420 720 755 085



#### MOBILE

+420 777 170 276



#### PLUJEME RÁDI S.R.O.

Dlouhá 730/35, 11000 Praha 1 – Staré Město, Czech Republic

## SERVICES

SELECTED SERVICES	OBLIGATORY	PAYMENT TYPE	PRICE
<b>Outboard engine</b> (Payable at the base) <b>Season: 2026.</b> Honda 15PS	Yes	per booking	<b>0,00 €</b>
<b>Transit log</b> (Payable now) <b>Season: 2026.</b> Gas, bed linen, final cleaning, Wi-Fi, diver, first & last night in Marina Pirovac, towels	Yes	per booking	<b>430,00 €</b>
<b>Divers inspection</b> (Payable at the base) <b>Season: 2026.</b>	No	per service	<b>150,00 €</b>
<b>Extra cleaning</b> (Payable at the base) <b>Season: 2026.</b>	No	per booking	<b>150,00 €</b>
<b>Hostess</b> (Payable at the base) <b>Season: 2026.</b>	No	per day	<b>200,00 €</b>
<b>Non-standard check-in/check-out</b> (Payable at the base) <b>Season: 2026.</b>	No	per booking	<b>150,00 €</b>
<b>Pet on board</b> (Payable at the base) <b>Season: 2026.</b>	No	per booking	<b>150,00 €</b>
<b>Priority check in</b> (Payable at the base) <b>Season: 2026.</b> check in from 13h to 15h	No	per booking	<b>150,00 €</b>
<b>Provisioning</b> (Payable at the base) <b>Season: 2026.</b> with local products, olive oil, vegetables etc. - at request	No	per booking	<b>0,00 €</b>
<b>Security Deposit Reduction</b> (Payable at the base) <b>Season: 2026.</b> + 600EUR refundable deposit	No	per booking	<b>500,00 €</b>
<b>Skipper</b> (Payable at the base) <b>Season: 2026.</b>	No	per day	<b>250,00 €</b>



**WEBSITE**  
www.plujeme.cz



**PHONE**  
+420 720 755 085



**MOBILE**  
+420 777 170 276



**E-MAIL**  
info@plujeme.cz



**PLUJEME RÁDI S.R.O.**  
Dlouhá 730/35, 11000 Praha 1 – Staré Město, Czech Republic

## ADDITIONAL EXTRAS

EXTRA	OBLIGATORY	PAYMENT TYPE	PRICE
<b>Coffee machine</b> (Payable at the base) <b>Season: 2026.</b> Nespresso, 16 capsules - Payable at the base	No	per booking	<b>40,00 €</b>
<b>Extra bedlinen and towels</b> (Payable at the base) <b>Season: 2026.</b> Payable at the base	No	per set	<b>10,00 €</b>
<b>Extra towels</b> (Payable at the base) <b>Season: 2026.</b> Set - Payable at the base	No	per week	<b>50,00 €</b>
<b>Outboard engine</b> (Payable at the base) <b>Season: 2026.</b> Payable at the base	No	per week	<b>0,00 €</b>
<b>Railing net (Safety net)</b> (Payable at the base) <b>Season: 2026.</b> Payable at the base	No	per booking	<b>120,00 €</b>
<b>Seabob</b> (Payable at the base) <b>Season: 2026.</b> price on request / per order, it needs to be ordered before charter - limited availability - Payable at the base	No	per week	<b>0,00 €</b>
<b>Stand up paddle (SUP)</b> (Payable at the base) <b>Season: 2026.</b> Payable at the base	No	per booking	<b>120,00 €</b>



**WEBSITE**

[www.plujeme.cz](http://www.plujeme.cz)



**E-MAIL**

[info@plujeme.cz](mailto:info@plujeme.cz)



**PHONE**

+420 720 755 085



**MOBILE**

+420 777 170 276



**PLUJEME RÁDI S.R.O.**

Dlouhá 730/35, 11000 Praha 1 – Staré Město, Czech Republic

## PRICE AND AVAILABILITY

25.04. - 02.05.2026 2.015 € 3.100 €	02.05. - 09.05.2026 2.145 € 3.300 €	09.05. - 16.05.2026 2.145 € 3.300 €	16.05. - 23.05.2026 NOT AVAILABLE
23.05. - 30.05.2026 3.445 € 5.300 €	30.05. - 06.06.2026 3.835 € 5.900 €	06.06. - 13.06.2026 4.030 € 6.200 €	13.06. - 20.06.2026 4.225 € 6.500 €
20.06. - 27.06.2026 4.550 € 7.000 €	27.06. - 04.07.2026 4.875 € 7.500 €	04.07. - 11.07.2026 NOT AVAILABLE	11.07. - 18.07.2026 NOT AVAILABLE
18.07. - 25.07.2026 5.070 € 7.800 €	25.07. - 01.08.2026 NOT AVAILABLE	01.08. - 08.08.2026 NOT AVAILABLE	08.08. - 15.08.2026 NOT AVAILABLE
15.08. - 22.08.2026 NOT AVAILABLE	22.08. - 29.08.2026 4.810 € 7.400 €	29.08. - 05.09.2026 4.225 € 6.500 €	05.09. - 12.09.2026 NOT AVAILABLE
12.09. - 19.09.2026 NOT AVAILABLE	19.09. - 26.09.2026 NOT AVAILABLE	26.09. - 03.10.2026 2.275 € 3.500 €	03.10. - 10.10.2026 NOT AVAILABLE
10.10. - 17.10.2026 1.625 € 2.500 €	17.10. - 24.10.2026 1.625 € 2.500 €	25.10. - 31.12.2026 NOT AVAILABLE	



WEBSITE

[www.plujeme.cz](http://www.plujeme.cz)



E-MAIL

[info@plujeme.cz](mailto:info@plujeme.cz)



PHONE

+420 720 755 085



MOBILE

+420 777 170 276



PLUJEME RÁDI S.R.O.

Dlouhá 730/35, 11000 Praha 1 – Staré Město, Czech Republic