

NAUTITECH 47 POWER

SEATTLE (2020)

Power catamaran Nautitech 47 Power SEATTLE, built in 2020 is anchored in the Trogir, Yachtclub Seget (Marina Baotić), Split region, Croatia. It has 4 + 2 cabins, can accommodate 8 + 2 + 2 people and has 4 toilets. Bed linen and kitchen equipment are included in the price.

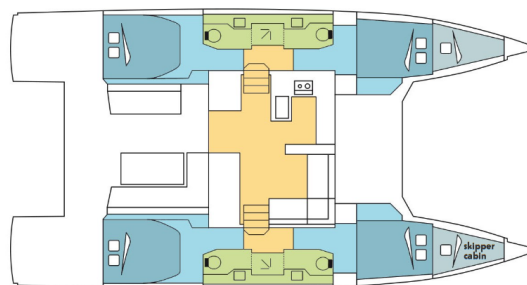

YACHT SPECIFICATIONS

Yacht Base

Trogir, Yachtclub Seget (Marina Baotić), Croatia

Yacht ID

3070

Brands

Bavaria

Yacht name

SEATTLE

Production year

2020

Length

47 ft

Cabins

4 + 2

Berths

8 + 2 + 2

Max Persons

12

WC

4

Engine

2 x 300 HP

Fuel tank

1000 l



WEBSITE

www.plujeme.cz



PHONE

+420 720 755 085



MOBILE

+420 777 170 276



E-MAIL

info@plujeme.cz



PLUJEME RÁDI S.R.O.

Dlouhá 730/35, 11000 Praha 1 – Staré Město, Czech Republic

STANDARD YACHT EQUIPMENT

Comfort	Cockpit cushions
Deck	Bimini top, Cockpit fridge, Cockpit table, Cockpit/stern, outside shower, Electric anchor windlass, Flybridge, Swimming ladder
Entertainment	Radio
Galley	Oven, Refrigerator, Stove
Interior	Convertible table in salon, Electric fans in cabins, Electric toilet
Navigation	GPS chart plotter, No autopilot
Safety	VHF radio
Yacht electrics	Air Conditioning, Generator, Inverter, USB sockets, Watermaker - desalinator



WEBSITE

www.plujeme.cz



E-MAIL

info@plujeme.cz



PHONE

+420 720 755 085



MOBILE

+420 777 170 276



PLUJEME RÁDI S.R.O.

Dlouhá 730/35, 11000 Praha 1 – Staré Město, Czech Republic

SERVICES

SELECTED SERVICES	OBLIGATORY	PAYMENT TYPE	PRICE
Handling fees (Payable now) Season: 2026.	Yes	per booking	20,00 €
Preparation fee (Payable now) Season: 2026. INCLUDED: starter pack – (1 gallon water or 4 bottles of 1.5L, 1 bottle of disinfectant, 1 small bottle of washing up liquid, 1 dish cloth, 1 sponge, garbage bags, 1 roll of paper towels, 1 box of matches, 1 roll of toilet paper in each head) // final cleaning // 1 set of bed sheets / cabin & 1 set of towels / pax, dinghy, outboard engine & initial supply of fuel, gas and water tanks // DYC assistance guarantee // 1st & last night in the marina // NOT INCLUDED: refuelling, gas & water consumption at end of charter, taxes if any, handling fees & additional equipment deposit.	Yes	per booking	390,00 €
Tourist tax (Payable at the base) Season: 2026. Payment by credit card only, no cash	Yes	per guest/day	1,33 €
Additional fee for Skipper in forepeak & shared bathroom (Payable now) Season: 2026. To be added with Skipper only ; Can be added for new bookings only confirmed after 21/05/2026 ; replaces skipper requirement to have their own toilet/shower. Guests must be aware that they'll need to give access to toilet/shower.	No	per night	50,00 €
Crew change (Payable now) Season: 2026. Any crew change during the charter is subject to € 250.- additional cost. The charge includes administration cost, change of bed linen and towels and one night at DYC ponton (marina fee included only if the same base than start base). It doesn't include cleaning, nor new transit log where applicable.	No	per booking	250,00 €
Early boarding/check-in (Payable now) Season: 2026. EB (boat only) - 13:00h, starting time of boat's delivery // limited number of early boardings on same departure day	No	per booking	400,00 €
Early boarding/check-in (Payable now) Season: 2026. EB + extra fee skipper - 13:00h, starting time of boat's delivery // limited number of early boardings on same departure day	No	per booking	530,00 €
Early boarding/check-in (Payable now) Season: 2026. EB + extra fee Skipper & Hostess - 13:00h, starting time of boat's delivery // limited number of early boardings on same departure day	No	per booking	630,00 €

Electric & Water consumption in the Marinas (Payable at the base)	No	per booking	36,00 €
Season: 2026. Electric & Water consumption based on 2 nights on our dock (base will confirm the amount to pay locally depending on nights spent on dock)			
Extra cleaning (Payable now)	No	per booking	340,00 €
Season: 2026. Optional Additional cleaning			
Extra set of linen (choose how many) (Payable now)	No	per booking	15,00 €
Season: 2026. Extra set of linen : 15 € 1 extra set of linen (2 sheets & 2 pillow case) - to be updated manually			
Extra set of towels (choose how many) (Payable now)	No	per booking	10,00 €
Season: 2026. Extra set of towels: 10 € 1 extra set of towels (1 face & 1 bath towel) - to be updated manually			
Full board 1-3 pax (number of guests to update manually) (Payable now)	No	per guest/day	75,00 €
Season: 2026. only available if cook is booked on board as the cook will do the provisioning based on client's preference. Includes breakfast, lunch & dinner + the crew's food. Does not included alcoholic drinks			
Full board 4-6 pax (number of guests to update manually) (Payable now)	No	per guest/day	60,00 €
Season: 2026. only available if cook is booked on board as the cook will do the provisioning based on client's preference. Includes breakfast, lunch & dinner + the crew's food. Does not included alcoholic drinks			
Full board 7-12 pax (number of guests to update manually) (Payable now)	No	per guest/day	55,00 €
Season: 2026. only available if cook is booked on board as the cook will do the provisioning based on client's preference. Includes breakfast, lunch & dinner + the crew's food. Does not included alcoholic drinks			
Half board 1-3 pax (number of guests to update manually) (Payable now)	No	per guest/day	60,00 €
Season: 2026. only available if cook is booked on board as the cook will do the provisioning based on client's preference. Includes breakfast & lunch OR dinner + the crew's food. Does not included alcoholic drinks			
Half board 4-6 pax (number of guests to update manually) (Payable now)	No	per guest/day	50,00 €
Season: 2026. only available if cook is booked on board as the cook will do the provisioning based on client's preference. Includes breakfast & lunch OR dinner + the crew's food. Does not included alcoholic drinks			
Half board 7-12 pax (number of guests to update manually) (Payable now)	No	per guest/day	45,00 €
Season: 2026. only available if cook is booked on board as the cook will do the provisioning based on client's preference. Includes breakfast & lunch OR dinner + the crew's food. Does not included alcoholic drinks			

<p>Hostess/Cook (Payable now)</p> <p>Season: 2026. + provisioning, Crew on board must have their own toilets/showers. If either a skipper or a hostess/cook is on board, 1 double cabin will be required for him/her. If both a skipper and a hostess/cook are on board, 1 double cabin and 1 forepeak cabin will be required for them. Exceptions exists for specific layouts, Sales Agents will provide more details about the different boat models</p>	No	per night	180,00 €
<p>Hostess/Cook (Payable now)</p> <p>Season: 2026. + provisioning, Crew on board must have their own toilets/showers. If either a skipper or a hostess/cook is on board, 1 double cabin will be required for him/her. If both a skipper and a hostess/cook are on board, 1 double cabin and 1 forepeak cabin will be required for them. Exceptions exists for specific layouts, Sales Agents will provide more details about the different boat models</p>	No	per night	180,00 €
<p>Hostess/Cook (Payable now)</p> <p>Season: 2026. + provisioning, Crew on board must have their own toilets/showers. If either a skipper or a hostess/cook is on board, 1 double cabin will be required for him/her. If both a skipper and a hostess/cook are on board, 1 double cabin and 1 forepeak cabin will be required for them. Exceptions exists for specific layouts, Sales Agents will provide more details about the different boat models</p>	No	per night	200,00 €
<p>Regatta surcharge (Payable now)</p> <p>Season: 2026. A special race deposit need to be doubled manually once the regatta surcharge is added.</p>	No	per booking	0,00 €
<p>Skipper (Payable now)</p> <p>Season: 2026. + provisioning, Crew on board must have their own toilets/showers. If either a skipper or a hostess/cook is on board, 1 double cabin will be required for him/her. If both a skipper and a hostess/cook are on board, 1 double cabin and 1 forepeak cabin will be required for them. Exceptions exists for specific layouts, Sales Agents will provide more details about the different boat models</p>	No	per night	250,00 €
<p>Skipper (Payable now)</p> <p>Season: 2026. + provisioning, Crew on board must have their own toilets/showers. If either a skipper or a hostess/cook is on board, 1 double cabin will be required for him/her. If both a skipper and a hostess/cook are on board, 1 double cabin and 1 forepeak cabin will be required for them. Exceptions exists for specific layouts, Sales Agents will provide more details about the different boat models</p>	No	per night	250,00 €

Skipper (Payable now)	No	per night	275,00 €
Season: 2026. + provisioning, Crew on board must have their own toilets/showers. If either a skipper or a hostess/cook is on board, 1 double cabin will be required for him/her. If both a skipper and a hostess/cook are on board, 1 double cabin and 1 forepeak cabin will be required for them. Exceptions exists for specific layouts, Sales Agents will provide more details about the different boat models			
Transfer (Payable now)	No	round trip	82,00 €
Season: 2026. RT - Split Airport / Base 1 - 4 pax			
Transfer (Payable now)	No	round trip	96,00 €
Season: 2026. RT - Split Airport / Base 5 - 8 pax			
WI-FI Internet connection on boat (Payable now)	No	per week	32,00 €
Season: 2026. Unlimited - included in price			



WEBSITE

www.plujeme.cz



E-MAIL

info@plujeme.cz



PHONE

+420 720 755 085



MOBILE

+420 777 170 276



PLUJEME RÁDI S.R.O.

Dlouhá 730/35, 11000 Praha 1 – Staré Město, Czech Republic

ADDITIONAL EXTRAS

EXTRA	OBLIGATORY	PAYMENT TYPE	PRICE
Kayak single (Payable now) Season: 2026. Price per day - Payable now	No	per night	15,00 €
Kayak single (Payable now) Season: 2026. Price per day - Payable now	No	per night	15,00 €
Outboard engine 8 & 9,8 HP (Payable now) Season: 2026. Subject to Availability ; 8/9hp. Dinghy not suitable in any case for waterski or wakeboard. - Payable now	No	per day	35,00 €
Stand up paddle (SUP) (Payable now) Season: 2026. Price per day - Payable now	No	per night	15,00 €

**WEBSITE**www.plujeme.cz**E-MAIL**info@plujeme.cz**PHONE**

+420 720 755 085

**MOBILE**

+420 777 170 276

**PLUJEME RÁDI S.R.O.**

Dlouhá 730/35, 11000 Praha 1 – Staré Město, Czech Republic

PRICE AND AVAILABILITY

13.06. - 20.06.2026 NOT AVAILABLE	20.06. - 27.06.2026 8.530 €	27.06. - 04.07.2026 12.025 €	04.07. - 11.07.2026 10.710 €
11.07. - 18.07.2026 11.725 €	18.07. - 25.07.2026 NOT AVAILABLE	25.07. - 01.08.2026 NOT AVAILABLE	01.08. - 08.08.2026 12.060 €
08.08. - 15.08.2026 NOT AVAILABLE	15.08. - 22.08.2026 10.975 €	22.08. - 29.08.2026 8.870 €	29.08. - 05.09.2026 NOT AVAILABLE
05.09. - 19.09.2026 NOT AVAILABLE	19.09. - 26.09.2026 5.420 €	26.09. - 03.10.2026 4.295 €	03.10. - 10.10.2026 NOT AVAILABLE
10.10. - 17.10.2026 NOT AVAILABLE	17.10. - 24.10.2026 1.908 € 2.120 €	24.10. - 07.11.2026 NOT AVAILABLE	07.11. - 14.11.2026 2.120 € 2.355 €
20.11. - 12.03.2027 NOT AVAILABLE			



WEBSITE

www.plujeme.cz



E-MAIL

info@plujeme.cz



PHONE

+420 720 755 085



MOBILE

+420 777 170 276



PLUJEME RÁDI S.R.O.

Dlouhá 730/35, 11000 Praha 1 – Staré Město, Czech Republic

PRICE AND AVAILABILITY

13.03. - 20.03.2027 1.868 € 2.075 €	20.03. - 27.03.2027 1.868 € 2.075 €	27.03. - 03.04.2027 2.142 € 2.380 €	03.04. - 10.04.2027 2.142 € 2.380 €
10.04. - 17.04.2027 2.534 € 2.815 €	17.04. - 24.04.2027 2.534 € 2.815 €	24.04. - 01.05.2027 3.105 € 3.450 €	01.05. - 08.05.2027 3.105 € 3.450 €
08.05. - 15.05.2027 3.794 € 4.215 €	15.05. - 22.05.2027 4.514 € 5.015 €	22.05. - 29.05.2027 6.363 € 7.070 €	29.05. - 05.06.2027 8.100 € 9.000 €
05.06. - 12.06.2027 8.114 € 9.015 €	12.06. - 19.06.2027 9.072 € 10.080 €	19.06. - 26.06.2027 NOT AVAILABLE	26.06. - 03.07.2027 12.515 € 13.905 €
03.07. - 10.07.2027 12.569 € 13.965 €	10.07. - 17.07.2027 13.001 € 14.445 €	17.07. - 24.07.2027 13.001 € 14.445 €	24.07. - 31.07.2027 13.001 € 14.445 €
31.07. - 07.08.2027 13.649 € 15.165 €	07.08. - 14.08.2027 13.649 € 15.165 €	14.08. - 21.08.2027 13.001 € 14.445 €	21.08. - 28.08.2027 8.892 € 9.880 €
28.08. - 04.09.2027 8.447 € 9.385 €	04.09. - 11.09.2027 8.870 € 9.855 €	11.09. - 18.09.2027 8.465 € 9.405 €	18.09. - 25.09.2027 6.017 € 6.685 €
25.09. - 02.10.2027 NOT AVAILABLE			



WEBSITE
www.plujeme.cz



E-MAIL
info@plujeme.cz



PHONE
+420 720 755 085



PLUJEME RÁDI S.R.O.
Dlouhá 730/35, 11000 Praha 1 – Staré Město, Czech Republic



MOBILE
+420 777 170 276

PRICE AND AVAILABILITY

02.10. - 09.10.2027 3.483 € 3.870 €	09.10. - 16.10.2027 2.696 € 2.995 €	16.10. - 23.10.2027 2.331 € 2.590 €	23.10. - 30.10.2027 2.120 € 2.355 €
30.10. - 06.11.2027 2.120 € 2.355 €	06.11. - 13.11.2027 2.120 € 2.355 €	13.11. - 20.11.2027 2.120 € 2.355 €	20.11. - 27.11.2027 2.120 € 2.355 €
27.11. - 04.12.2027 2.120 € 2.355 €	04.12. - 11.12.2027 2.120 € 2.355 €	11.12. - 18.12.2027 2.120 € 2.355 €	18.12. - 25.12.2027 2.120 € 2.355 €



WEBSITE

www.plujeme.cz



E-MAIL

info@plujeme.cz



PHONE

+420 720 755 085



MOBILE

+420 777 170 276



PLUJEME RÁDI S.R.O.

Dlouhá 730/35, 11000 Praha 1 – Staré Město, Czech Republic