

# BAVARIA 46 CRUISER

Cristina (2008)

Sailing yacht **Bavaria 46 Cruiser Cristina**, built in **2008** is anchored in the **Tenerife, San Miguel Marina, Canary Islands, Spain**. It has **4 cabins**, can accommodate **8 people** and has **2 toilets**. Bed linen and kitchen equipment are included in the price.

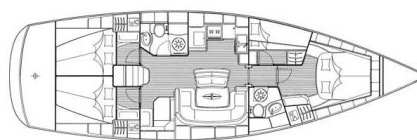

## YACHT SPECIFICATIONS

Yacht Base

**Tenerife, San Miguel Marina, Spain**

Yacht ID

**3030**

Brands

**Bavaria**

Yacht name

**Cristina**

Production year

**2008**

Length

**47 ft**

Cabins

**4**

Berths

**8**

Max Persons

**8**

WC

**2**

Engine

**1 x 55 HP**

Fuel tank

**210 l**



**WEBSITE**

[www.plujeme.cz](http://www.plujeme.cz)



**PHONE**

+420 720 755 085



**MOBILE**

+420 777 170 276



**E-MAIL**

[info@plujeme.cz](mailto:info@plujeme.cz)



**PLUJEME RÁDI S.R.O.**

Dlouhá 730/35, 11000 Praha 1 – Staré Město, Czech Republic

## STANDARD YACHT EQUIPMENT

Deck	<b>Anchor, Bimini top, Bosun's chair (Safe seat) (boatswain's chair), Cockpit table, Cockpit/stern, outside shower, Dinghy, Electric anchor windlass, Fenders, Main Deck Compass, Ropes, Sprayhood, Swimming ladder, Teak cockpit, Water hose</b>
Entertainment	<b>Outdoor speakers, TV</b>
Galley	<b>Gas bottles, Hot water, Kitchen utensils (Galley equipment, cutlery), Stove</b>
Interior	<b>Barometer, Clock</b>
Navigation	<b>AIS, Autopilot, Binoculars, Cockpit control panel, Electronic sea charts, GPS, GPS chart plotter, GPS chart plotter - cockpit, Hand bearing compass, Harbour guides, List of lights, Log, Speed, Depth- echo sounder, Navigation (Nautical) charts and nautical guide, Navigation/position Lights, Pilot book, Radar reflector, Wind/speed/depth instruments, Windex</b>
Safety	<b>Automatic Inflatable Life Jacket, Distress flare box, Distress signals, Emergency tiller, EPIRB-Distress radio beacons, Fire extinguisher, First aid kit, Floating light, Fog horn, GMDSS - Global Maritime Distress and Safety System, Horseshoe lifebuoy, Life belts (Safety harness), Sos Dan Buoy, Torch, VHF radio</b>
Yacht electrics	<b>Heating, Solar panels</b>



**WEBSITE**  
[www.plujeme.cz](http://www.plujeme.cz)



**PHONE**  
+420 720 755 085



**MOBILE**  
+420 777 170 276



**E-MAIL**  
[info@plujeme.cz](mailto:info@plujeme.cz)



**PLUJEME RÁDI S.R.O.**  
Dlouhá 730/35, 11000 Praha 1 – Staré Město, Czech Republic

## SERVICES

SELECTED SERVICES	OBLIGATORY	PAYMENT TYPE	PRICE
<b>Bedlinen and towels</b> (Payable at the base) <b>Season: 2026.</b>	Yes	per person	<b>20,00 €</b>
<b>Final cleaning</b> (Payable at the base) <b>Season: 2026.</b>	Yes	per booking	<b>200,00 €</b>
<b>Crew change</b> (Payable at the base) <b>Season: 2026.</b>	No	per booking	<b>100,00 €</b>
<b>Damage waiver</b> (Payable at the base) <b>Season: 2026.</b> Reduces the security deposit to 800 EUR	No	per booking	<b>400,00 €</b>
<b>Early Check in</b> (Payable at the base) <b>Season: 2026.</b> 14:00h	No	per booking	<b>150,00 €</b>
<b>Extra cleaning - pets</b> (Payable at the base) <b>Season: 2026.</b>	No	per booking	<b>100,00 €</b>
<b>Skipper</b> (Payable at the base) <b>Season: 2026.</b> external service under request, price can vary	No	per day + food	<b>200,00 €</b>
<b>Transfer</b> (Payable at the base) <b>Season: 2026.</b> up to 8 pax - external service under request, price can vary	No	one-way	<b>50,50 €</b>

**WEBSITE**[www.plujeme.cz](http://www.plujeme.cz)**E-MAIL**[info@plujeme.cz](mailto:info@plujeme.cz)**PHONE**

+420 720 755 085

**MOBILE**

+420 777 170 276

**PLUJEME RÁDI S.R.O.**

Dlouhá 730/35, 11000 Praha 1 – Staré Město, Czech Republic

## ADDITIONAL EXTRAS

EXTRA	OBLIGATORY	PAYMENT TYPE	PRICE
<b>Extra bedlinen</b> (Payable at the base) <b>Season: 2026.</b> Payable at the base	No	per set	<b>10,00 €</b>
<b>Extra towels</b> (Payable at the base) <b>Season: 2026.</b> Payable at the base	No	per set	<b>10,00 €</b>
<b>Inverter</b> (Payable at the base) <b>Season: 2026.</b> 20 EUR per week from second week - Payable at the base	No	per week	<b>25,00 €</b>
<b>Outboard engine 2,3 HP</b> (Payable at the base) <b>Season: 2026.</b> 80 EUR per week from second week - Payable at the base	No	per booking	<b>100,00 €</b>
<b>Snorkeling equipment</b> (Payable at the base) <b>Season: 2026.</b> Payable at the base	No	per week	<b>20,00 €</b>
<b>Stand up paddle (SUP)</b> (Payable at the base) <b>Season: 2026.</b> 80 EUR per week from second week - Payable at the base	No	per booking	<b>120,00 €</b>



**WEBSITE**

[www.plujeme.cz](http://www.plujeme.cz)



**E-MAIL**

[info@plujeme.cz](mailto:info@plujeme.cz)



**PHONE**

+420 720 755 085



**MOBILE**

+420 777 170 276



**PLUJEME RÁDI S.R.O.**

Dlouhá 730/35, 11000 Praha 1 – Staré Město, Czech Republic

## PRICE AND AVAILABILITY

25.04. - 02.05.2026 NOT AVAILABLE	02.05. - 09.05.2026 NOT AVAILABLE	09.05. - 16.05.2026 NOT AVAILABLE	16.05. - 23.05.2026 NOT AVAILABLE
23.05. - 30.05.2026 1.993 € 2.460 €	30.05. - 06.06.2026 1.993 € 2.460 €	06.06. - 13.06.2026 1.993 € 2.460 €	13.06. - 20.06.2026 NOT AVAILABLE
20.06. - 27.06.2026 1.993 € 2.460 €	27.06. - 04.07.2026 2.292 € 2.830 €	04.07. - 11.07.2026 NOT AVAILABLE	11.07. - 18.07.2026 2.390 € 2.950 €
18.07. - 25.07.2026 2.390 € 2.950 €	25.07. - 01.08.2026 2.390 € 2.950 €	01.08. - 08.08.2026 2.390 € 2.950 €	08.08. - 15.08.2026 2.390 € 2.950 €
15.08. - 22.08.2026 2.390 € 2.950 €	22.08. - 29.08.2026 2.390 € 2.950 €	29.08. - 12.09.2026 NOT AVAILABLE	12.09. - 19.09.2026 NOT AVAILABLE
19.09. - 26.09.2026 NOT AVAILABLE	26.09. - 03.10.2026 NOT AVAILABLE	03.10. - 10.10.2026 NOT AVAILABLE	10.10. - 17.10.2026 NOT AVAILABLE
17.10. - 24.10.2026 2.390 € 2.950 €	24.10. - 31.10.2026 2.292 € 2.830 €	31.10. - 14.11.2026 NOT AVAILABLE	14.11. - 21.11.2026 2.292 € 2.830 €
21.11. - 28.11.2026 2.292 € 2.830 €	28.11. - 05.12.2026 2.292 € 2.830 €		



WEBSITE

[www.plujeme.cz](http://www.plujeme.cz)



E-MAIL

[info@plujeme.cz](mailto:info@plujeme.cz)



PHONE

+420 720 755 085



MOBILE

+420 777 170 276



PLUJEME RÁDI S.R.O.

Dlouhá 730/35, 11000 Praha 1 – Staré Město, Czech Republic

## PRICE AND AVAILABILITY

05.12. - 12.12.2026 2.187 € 2.700 €	12.12. - 19.12.2026 2.187 € 2.700 €	19.12. - 26.12.2026 2.689 € 3.320 €	02.01. - 09.01.2027 2.376 € 2.700 €
09.01. - 16.01.2027 2.376 € 2.700 €	16.01. - 23.01.2027 2.376 € 2.700 €	23.01. - 30.01.2027 2.376 € 2.700 €	30.01. - 06.02.2027 2.376 € 2.700 €
06.02. - 13.02.2027 2.376 € 2.700 €	13.02. - 20.02.2027 2.376 € 2.700 €	20.02. - 27.02.2027 2.376 € 2.700 €	27.02. - 06.03.2027 2.024 € 2.300 €
06.03. - 13.03.2027 1.862 € 2.300 €	13.03. - 20.03.2027 1.862 € 2.300 €	20.03. - 27.03.2027 1.862 € 2.300 €	27.03. - 03.04.2027 1.862 € 2.300 €
03.04. - 10.04.2027 1.862 € 2.300 €	10.04. - 17.04.2027 1.862 € 2.300 €	17.04. - 24.04.2027 1.425 € 1.760 €	24.04. - 01.05.2027 1.425 € 1.760 €
01.05. - 08.05.2027 1.584 € 1.760 €	08.05. - 15.05.2027 1.584 € 1.760 €	15.05. - 22.05.2027 1.584 € 1.760 €	22.05. - 29.05.2027 1.584 € 1.760 €
29.05. - 05.06.2027 1.584 € 1.760 €	05.06. - 12.06.2027 1.584 € 1.760 €	12.06. - 19.06.2027 1.584 € 1.760 €	19.06. - 26.06.2027 1.584 € 1.760 €
26.06. - 03.07.2027 1.584 € 1.760 €	03.07. - 10.07.2027 1.584 € 1.760 €	10.07. - 17.07.2027 1.584 € 1.760 €	17.07. - 24.07.2027 1.584 € 1.760 €
24.07. - 31.07.2027 1.584 € 1.760 €	31.07. - 07.08.2027 2.430 € 2.700 €		



WEBSITE

[www.plujeme.cz](http://www.plujeme.cz)



E-MAIL

[info@plujeme.cz](mailto:info@plujeme.cz)



PHONE

+420 720 755 085



MOBILE

+420 777 170 276



PLUJEME RÁDI S.R.O.

Dlouhá 730/35, 11000 Praha 1 – Staré Město, Czech Republic

## PRICE AND AVAILABILITY

07.08. - 14.08.2027 <b>1.584 €</b> 1.760 €	14.08. - 21.08.2027 <b>1.584 €</b> 1.760 €	21.08. - 28.08.2027 <b>1.584 €</b> 1.760 €	28.08. - 04.09.2027 <b>1.584 €</b> 1.760 €
04.09. - 11.09.2027 <b>1.584 €</b> 1.760 €	11.09. - 18.09.2027 <b>2.070 €</b> 2.300 €	18.09. - 25.09.2027 <b>2.070 €</b> 2.300 €	25.09. - 02.10.2027 <b>2.070 €</b> 2.300 €
02.10. - 09.10.2027 <b>2.070 €</b> 2.300 €	09.10. - 16.10.2027 <b>2.070 €</b> 2.300 €	16.10. - 23.10.2027 <b>2.070 €</b> 2.300 €	23.10. - 30.10.2027 <b>2.070 €</b> 2.300 €
30.10. - 06.11.2027 <b>2.070 €</b> 2.300 €	06.11. - 13.11.2027 <b>2.700 €</b>	13.11. - 20.11.2027 <b>2.700 €</b>	20.11. - 27.11.2027 <b>2.700 €</b>
27.11. - 04.12.2027 <b>2.700 €</b>	04.12. - 11.12.2027 <b>2.700 €</b>	11.12. - 18.12.2027 <b>2.700 €</b>	18.12. - 25.12.2027 <b>3.240 €</b>



WEBSITE

[www.plujeme.cz](http://www.plujeme.cz)



E-MAIL

[info@plujeme.cz](mailto:info@plujeme.cz)



PHONE

+420 720 755 085



MOBILE

+420 777 170 276



PLUJEME RÁDI S.R.O.

Dlouhá 730/35, 11000 Praha 1 – Staré Město, Czech Republic