

# HANSE 588

Jasmine (2017)

Sailing yacht **Hanse 588 Jasmine**, built in **2017** is anchored in the **Trogir, Marina Trogir (ex.SCT), Split region, Croatia**. It has **5 + 1 cabins**, can accommodate **10 + 2 + 1 people** and has **3 toilets**. Bed linen and kitchen equipment are included in the price.

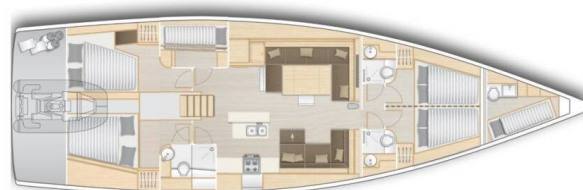

## YACHT SPECIFICATIONS

Yacht Base

**Trogir, Marina Trogir (ex.SCT),  
Croatia**

Yacht ID

**2935**

Brands

**Hanse Yachts**

Yacht name

**Jasmine**

Production year

**2017**

Length

**56 ft**

Cabins

**5 + 1**

Berths

**10 + 2 + 1**

Max Persons

**12**

WC

**3**

Engine

**1 x 150 HP**

Fuel tank

**500 l**



**WEBSITE**

[www.plujeme.cz](http://www.plujeme.cz)



**PHONE**

+420 720 755 085



**MOBILE**

+420 777 170 276



**E-MAIL**

[info@plujeme.cz](mailto:info@plujeme.cz)



**PLUJEME RÁDI S.R.O.**

Dlouhá 730/35, 11000 Praha 1 – Staré Město, Czech Republic

## STANDARD YACHT EQUIPMENT

Comfort	<b>Bed linen, Cockpit cushions, Deck cushions, Pillows</b>
Deck	<b>Anchor Jambo, Bathing platform, Bilge pump - Mechanic, Boat hook, Cockpit fridge, Cockpit table, Cockpit/stern, outside shower, Dinghy, Electric anchor windlass, Fenders, Gangway, Hard Top Bimini, Lowerable cockpit table, Mooring ropes, Spare anchor (Reserve, Auxiliary anchor), Sprayhood, Teak deck, Ultra Anchor, Water hose, Winch handles</b>
Entertainment	<b>Outdoor speakers, Radio CD mp3 player + USB, Bluetooth, TV + DVD, Underwater lights, W-LAN GRATIS</b>
Galley	<b>Dishwasher, Electrical kettle, Freezer, Gas bottles, Gas cookers, Kitchen utensils (Galley equipment, cutlery), Microwave, Moka pot, Oven, Refrigerator, Sink</b>
Interior	<b>Barometer, Bunk bed, Clock, Duvet cover, Electric toilet</b>
Navigation	<b>Autopilot, Binoculars, Bow thruster, Compass, Divider, nautic chart, GPS chart plotter - cockpit, Hand bearing compass, Navigation (Nautical) charts and nautical guide, Navigation set, Radar, Radar reflector, Stern thruster, Tridata, Wind instrument/Anemometer</b>
Safety	<b>Black Water Tank, Distress flare box, Emergency tiller, Fire extinguisher, First aid kit, Flashlight, Fog horn, Horseshoe lifebuoy, Life belts (Safety harness), Life buoy + Flashing light, Life jackets, Liferaft, Repair kit, Set of tools, VHF radio</b>
Sails	<b>Electric winch</b>
Yacht electrics	<b>220V socket, Air Conditioning, Battery charger, Bilge pump - Electric, Generator, Heating, Inverter, Pump, Service batteries, Shore connection 220 V, Shore power cable, Solar panels</b>



**WEBSITE**

[www.plujeme.cz](http://www.plujeme.cz)



**PHONE**

+420 720 755 085



**MOBILE**

+420 777 170 276



**E-MAIL**

[info@plujeme.cz](mailto:info@plujeme.cz)



**PLUJEME RÁDI S.R.O.**

Dlouhá 730/35, 11000 Praha 1 – Staré Město, Czech Republic

## SERVICES

SELECTED SERVICES	OBLIGATORY	PAYMENT TYPE	PRICE
<b>Charter package</b> (Payable at the base) <b>Season: 2026 - Angelina Yachtcharter.</b> Charter package includes final cleaning, gas, check-in and out services, package for toilets (toilet paper and soap /per each toilet) and kitchen (1 kitchen paper towels, a sponge and a cleaning cloth, a small package of dish detergent, 1 waste bag, 2 kitchen towels, 2x 1l bottle of water), bed linen/bath towels (2 sets per cabin - do not include saloon and skipper cabin).	Yes	per booking	<b>460,00 €</b>
<b>WiFi GRATIS ON BOAT</b> (Payable now) <b>Season: 2026 - Angelina Yachtcharter.</b> GRATIS	Yes	per booking	<b>0,00 €</b>
<b>Assisted Sailing</b> (Payable at the base) <b>Season: 2026 - Angelina Yachtcharter.</b> Valovie - remote sailing assistance; Our skipper will help and assist you remotely during your charter, and provide you advices when it comes to berths, restaurant recommendations, weather forecasts etc.	No	per booking	<b>270,00 €</b>
<b>Deposit insurance</b> (Payable at the base) <b>Season: 2026 - Angelina Yachtcharter.</b> + refundable deposit 300,00 EUR	No	per booking	<b>360,00 €</b>
<b>Pet on board</b> (Payable at the base) <b>Season: 2026 - Angelina Yachtcharter.</b> maximum 2 pets allowed	No	per booking	<b>200,00 €</b>



**WEBSITE**

[www.plujeme.cz](http://www.plujeme.cz)



**PHONE**

+420 720 755 085



**MOBILE**

+420 777 170 276



**E-MAIL**

[info@plujeme.cz](mailto:info@plujeme.cz)



**PLUJEME RÁDI S.R.O.**

Dlouhá 730/35, 11000 Praha 1 – Staré Město, Czech Republic

## ADDITIONAL EXTRAS

EXTRA	OBLIGATORY	PAYMENT TYPE	PRICE
<b>Beach towel</b> (Payable at the base) <b>Season: 2026 - Angelina Yachtcharter.</b> Payable at the base	No	per piece	<b>10,00 €</b>
<b>Outboard engine 2,3 HP</b> (Payable at the base) <b>Season: 2026 - Angelina Yachtcharter.</b> Special promotion, free of charge for charter periods until 29.08.2026. and from 03.10.2026. - Payable at the base	No	per booking	<b>0,00 €</b>
<b>Outboard engine 2,3 HP</b> (Payable at the base) <b>Season: 2026 - Angelina Yachtcharter.</b> Special promotion, free of charge for charter periods until 29.08.2026. and from 03.10.2026. - Payable at the base	No	per booking	<b>0,00 €</b>
<b>Outboard engine 2,3 HP</b> (Payable at the base) <b>Season: 2026 - Angelina Yachtcharter.</b> Payable at the base	No	per week	<b>110,00 €</b>
<b>Stand up paddle (SUP)</b> (Payable at the base) <b>Season: 2026 - Angelina Yachtcharter.</b> *additional deposit 200 EUR with deposit insurance, order in advance due to limited quantity of equipment - Payable at the base	No	per week	<b>100,00 €</b>
<b>Towels</b> (Payable at the base) <b>Season: 2026 - Angelina Yachtcharter.</b> Payable at the base	No	per set	<b>10,00 €</b>



**WEBSITE**  
www.plujeme.cz



**PHONE**  
+420 720 755 085



**MOBILE**  
+420 777 170 276



**E-MAIL**  
info@plujeme.cz



**PLUJEME RÁDI S.R.O.**  
Dlouhá 730/35, 11000 Praha 1 - Staré Město, Czech Republic

## PRICE AND AVAILABILITY

25.04. - 02.05.2026 NOT AVAILABLE	02.05. - 09.05.2026 NOT AVAILABLE	09.05. - 16.05.2026 2.820 € 4.700 €	16.05. - 23.05.2026 3.120 € 5.200 €
23.05. - 30.05.2026 NOT AVAILABLE	30.05. - 06.06.2026 NOT AVAILABLE	06.06. - 13.06.2026 4.320 € 7.200 €	13.06. - 20.06.2026 NOT AVAILABLE
20.06. - 27.06.2026 ON OPTION	27.06. - 04.07.2026 NOT AVAILABLE	04.07. - 11.07.2026 NOT AVAILABLE	11.07. - 18.07.2026 NOT AVAILABLE
18.07. - 25.07.2026 6.300 € 8.400 €	25.07. - 01.08.2026 6.480 € 8.100 €	01.08. - 08.08.2026 5.190 € 8.650 €	08.08. - 15.08.2026 NOT AVAILABLE
15.08. - 22.08.2026 NOT AVAILABLE	22.08. - 29.08.2026 NOT AVAILABLE	29.08. - 05.09.2026 NOT AVAILABLE	05.09. - 12.09.2026 5.475 € 7.300 €
12.09. - 19.09.2026 5.400 € 6.000 €	19.09. - 26.09.2026 NOT AVAILABLE	26.09. - 03.10.2026 NOT AVAILABLE	03.10. - 10.10.2026 NOT AVAILABLE
10.10. - 17.10.2026 NOT AVAILABLE	17.10. - 24.10.2026 2.308 € 3.550 €	24.10. - 31.10.2026 2.308 € 3.550 €	31.10. - 07.11.2026 2.308 € 3.550 €
07.11. - 14.11.2026 2.485 € 3.550 €	15.11. - 31.12.2026 NOT AVAILABLE		



WEBSITE

[www.plujeme.cz](http://www.plujeme.cz)



E-MAIL

[info@plujeme.cz](mailto:info@plujeme.cz)



PHONE

+420 720 755 085



MOBILE

+420 777 170 276



PLUJEME RÁDI S.R.O.

Dlouhá 730/35, 11000 Praha 1 – Staré Město, Czech Republic

## PRICE AND AVAILABILITY

01.01. - 05.03.2027

NOT AVAILABLE



**WEBSITE**

[www.plujeme.cz](http://www.plujeme.cz)



**E-MAIL**

[info@plujeme.cz](mailto:info@plujeme.cz)



**PHONE**

+420 720 755 085



**MOBILE**

+420 777 170 276



**PLUJEME RÁDI S.R.O.**

Dlouhá 730/35, 11000 Praha 1 – Staré Město, Czech Republic

## PRICE AND AVAILABILITY

07.11. - 31.12.2027

NOT AVAILABLE



### WEBSITE

[www.plujeme.cz](http://www.plujeme.cz)



### E-MAIL

[info@plujeme.cz](mailto:info@plujeme.cz)



### PHONE

+420 720 755 085



### MOBILE

+420 777 170 276



### PLUJEME RÁDI S.R.O.

Dlouhá 730/35, 11000 Praha 1 – Staré Město, Czech Republic