

# LAGOON 40

Monarch (2020)

Catamaran **Lagoon 40 Monarch**, built in **2020** is anchored in the **Marina Kremik, Primosten, Šibenik region, Croatia**. It has **4 + 2 cabins**, can accommodate **8 + 2 + 2 people** and has **4 toilets**. Bed linen and kitchen equipment are included in the price.

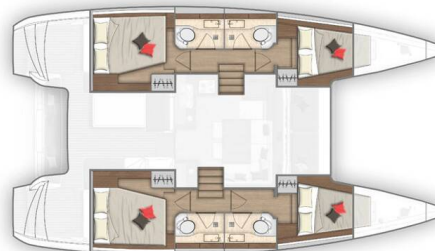

4 cabins 4 Salles de bain / 4 cabins 4 bathrooms

## YACHT SPECIFICATIONS

Yacht Base

**Marina Kremik, Primosten, Croatia**

Yacht ID

**2814**

Brands

**Lagoon**

Yacht name

**Monarch**

Production year

**2020**

Length

**39 ft**

Cabins

**4 + 2**

Berths

**8 + 2 + 2**

Max Persons

**12**

WC

**4**

Engine

**2 x 45 HP**

Fuel tank

**400 l**



**WEBSITE**

[www.plujeme.cz](http://www.plujeme.cz)



**PHONE**

+420 720 755 085



**MOBILE**

+420 777 170 276



**E-MAIL**

[info@plujeme.cz](mailto:info@plujeme.cz)



**PLUJEME RÁDI S.R.O.**

Dlouhá 730/35, 11000 Praha 1 – Staré Město, Czech Republic

## STANDARD YACHT EQUIPMENT

Comfort	<b>Cockpit cushions, Sundeck cushions</b>
Deck	<b>Anchor with chain, Bimini top, Cockpit table, Cockpit/stern, outside shower, Dinghy, Flybridge, Main anchor, Outboard engine, Spare anchor (Reserve, Auxiliary anchor), Swimming ladder, Teak cockpit</b>
Entertainment	<b>Indoor speakers, Outdoor speakers</b>
Galley	<b>Additional fridge, Hot water, Kitchen utensils (Galley equipment, cutlery), Oven, Refrigerator, Stove</b>
Interior	<b>Electric toilet, LED interior lights</b>
Navigation	<b>Autopilot, Complete navigation equipment, Echosounder/Depthsounder, LED Navigation lights, Pilot book, Radar reflector, Wind instrument/Anemometer</b>
Safety	<b>Distress flare box, Fire extinguisher, First aid kit, Horseshoe lifebuoy, Life belts (Safety harness), Life jackets, Liferaft, Smoke detector, VHF radio</b>
Sails	<b>Lazy bag</b>
Yacht electrics	<b>12V Socket, 220V socket, Air Conditioning, Battery charger, Generator, Service batteries, Shore connection 220 V, USB sockets</b>



**WEBSITE**

[www.plujeme.cz](http://www.plujeme.cz)



**PHONE**

+420 720 755 085



**MOBILE**

+420 777 170 276



**E-MAIL**

[info@plujeme.cz](mailto:info@plujeme.cz)



**PLUJEME RÁDI S.R.O.**

Dlouhá 730/35, 11000 Praha 1 – Staré Město, Czech Republic

## SERVICES

SELECTED SERVICES	OBLIGATORY	PAYMENT TYPE	PRICE
<b>Transit log</b> (Payable now) <b>Season: 2026.</b> includes: final cleaning, WiFi, dinghy, outboard engine and fuel, linen ready made beds, towels 2 per pax, cooking gas, kitchen toiletry, toilet paper, welcome surprise	Yes	per booking	<b>480,00 €</b>
<b>Chef</b> (Payable at the base) <b>Season: 2026.</b>	No	per day + food	<b>250,00 €</b>
<b>Early Check in</b> (Payable at the base) <b>Season: 2026.</b> until 13:00	No	per booking	<b>150,00 €</b>
<b>Hostess</b> (Payable at the base) <b>Season: 2026.</b>	No	per day + food	<b>190,00 €</b>
<b>Non refundable deposit/ insurance</b> (Payable at the base) <b>Season: 2026.</b> +1000 EUR refundable	No	per booking	<b>625,00 €</b>
<b>One way</b> (Payable at the base) <b>Season: 2026.</b> upon request	No	one-way	<b>0,00 €</b>
<b>Pet on board</b> (Payable at the base) <b>Season: 2026.</b> price upon request	No	per booking	<b>0,00 €</b>
<b>Skipper</b> (Payable at the base) <b>Season: 2026.</b>	No	per day + food	<b>220,00 €</b>
<b>Transfer</b> (Payable at the base) <b>Season: 2026.</b> Split Air port one way, min 4 pax	No	one-way	<b>75,00 €</b>
<b>Transfer</b> (Payable at the base) <b>Season: 2026.</b> Zadar Air port one way, min 4 pax	No	one-way	<b>150,00 €</b>



**WEBSITE**  
www.plujeme.cz



**PHONE**  
+420 720 755 085



**MOBILE**  
+420 777 170 276



**E-MAIL**  
info@plujeme.cz



**PLUJEME RÁDI S.R.O.**  
Dlouhá 730/35, 11000 Praha 1 – Staré Město, Czech Republic

## ADDITIONAL EXTRAS

EXTRA	OBLIGATORY	PAYMENT TYPE	PRICE
<b>Beach towel</b> (Payable at the base) <b>Season: 2026.</b> Payable at the base	No	per booking	<b>10,00 €</b>
<b>Extra towels</b> (Payable at the base) <b>Season: 2026.</b> Payable at the base	No	per booking	<b>5,00 €</b>
<b>Railing net (Safety net)</b> (Payable at the base) <b>Season: 2026.</b> Payable at the base	No	per week	<b>100,00 €</b>
<b>Stand up paddle (SUP)</b> (Payable at the base) <b>Season: 2026.</b> Payable at the base	No	per week	<b>100,00 €</b>



#### WEBSITE

[www.plujeme.cz](http://www.plujeme.cz)



#### E-MAIL

[info@plujeme.cz](mailto:info@plujeme.cz)



#### PHONE

+420 720 755 085



#### MOBILE

+420 777 170 276



#### PLUJEME RÁDI S.R.O.

Dlouhá 730/35, 11000 Praha 1 – Staré Město, Czech Republic

## PRICE AND AVAILABILITY

02.05. - 09.05.2026 ON OPTION	09.05. - 16.05.2026 1.710 € 2.850 €	16.05. - 23.05.2026 2.430 € 4.050 €	23.05. - 30.05.2026 4.050 €
30.05. - 06.06.2026 NOT AVAILABLE	06.06. - 13.06.2026 NOT AVAILABLE	13.06. - 20.06.2026 6.450 €	20.06. - 27.06.2026 NOT AVAILABLE
27.06. - 04.07.2026 7.250 €	04.07. - 11.07.2026 7.250 €	11.07. - 18.07.2026 7.250 €	18.07. - 25.07.2026 7.450 €
25.07. - 01.08.2026 7.450 €	01.08. - 08.08.2026 NOT AVAILABLE	08.08. - 15.08.2026 NOT AVAILABLE	15.08. - 22.08.2026 NOT AVAILABLE
22.08. - 29.08.2026 6.850 €	29.08. - 05.09.2026 6.450 €	05.09. - 12.09.2026 6.450 €	12.09. - 19.09.2026 4.950 €
19.09. - 26.09.2026 4.350 €	26.09. - 03.10.2026 NOT AVAILABLE	03.10. - 10.10.2026 2.750 €	10.10. - 17.10.2026 2.750 €
17.10. - 24.10.2026 2.750 €	24.10. - 31.10.2026 2.750 €	31.10. - 07.11.2026 2.750 €	07.11. - 14.11.2026 2.750 €
14.11. - 21.11.2026 2.750 €	21.11. - 28.11.2026 2.750 €	28.11. - 05.12.2026 2.750 €	05.12. - 12.12.2026 2.750 €
12.12. - 19.12.2026 2.750 €	19.12. - 26.12.2026 2.750 €		



WEBSITE  
[www.plujeme.cz](http://www.plujeme.cz)



E-MAIL  
[info@plujeme.cz](mailto:info@plujeme.cz)



PHONE  
+420 720 755 085



MOBILE  
+420 777 170 276



PLUJEME RÁDI S.R.O.  
Dlouhá 730/35, 11000 Praha 1 – Staré Město, Czech Republic