

BAVARIA CRUISER 46

Sirius (2020)

Sailing yacht **Bavaria Cruiser 46 Sirius**, built in **2020** is anchored in the **Pula, Marina Polesana, Istra, Croatia**. It has **4 cabins**, can accommodate **8 + 1 people** and has **3 toilets**. Bed linen and kitchen equipment are included in the price.

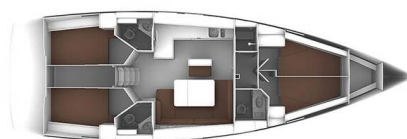

YACHT SPECIFICATIONS

Yacht Base

Pula, Marina Polesana, Croatia

Yacht ID

2811

Brands

Bavaria

Yacht name

Sirius

Production year

2020

Length

47 ft

Cabins

4

Berths

8 + 1

Max Persons

9

WC

3

Engine

1 x 55 HP

Fuel tank

210 l



WEBSITE

www.plujeme.cz



PHONE

+420 720 755 085



MOBILE

+420 777 170 276



E-MAIL

info@plujeme.cz



PLUJEME RÁDI S.R.O.

Dlouhá 730/35, 11000 Praha 1 – Staré Město, Czech Republic

STANDARD YACHT EQUIPMENT

| | |
|-----------------|--|
| Comfort | Cockpit cushions |
| Deck | Anchor line, Anchor swivel, Bimini top, Black ball, Black conus, Boat hook, Bosun's chair (Safe seat) (boatswain's chair), Canister for water, Cockpit table, Cockpit/stern, outside shower, Dinghy, Dinghy (byboat) pump, Electric anchor windlass, Fenders, Gangway, Hawser, Impeller, V-belt, oilfilter, Jerry cans for diesel, Main anchor, Mooring ropes, Plastic bucket, Repair box for dinghy, Round/globular fender, Spare anchor (Reserve, Auxiliary anchor), Spotlight / Headlights, Sprayhood, Spring line, Teak cockpit, Water hose |
| Entertainment | Outdoor speakers, Radio |
| Galley | Gas bottles, Hot water, Kitchen utensils (Galley equipment, cutlery), Refrigerator |
| Interior | Barometer, Clock |
| Navigation | Autopilot, Bow thruster, GPS chart plotter - cockpit, Harbour guides, Logge/Lot/Speed/Wind, Navigation (Nautical) charts and nautical guide, Navigation set, Radar reflector, Spyglass with bearing compass |
| Safety | Distress signals, Fire extinguisher, First aid kit, Flashlight, Fog horn, Life belts (Safety harness), Life buoy + Flashing light, Life jackets, Liferaft, Set of tools, VHF radio, Wire (shroud) cutter |
| Sails | Gennaker-device |
| Yacht electrics | Batteries, Battery charger, Heating, Inverter, Shore connection 220 V, Solar panels |



WEBSITE

www.plujeme.cz



PHONE

+420 720 755 085



MOBILE

+420 777 170 276



E-MAIL

info@plujeme.cz



PLUJEME RÁDI S.R.O.

Dlouhá 730/35, 11000 Praha 1 – Staré Město, Czech Republic

SERVICES

| SELECTED SERVICES | OBLIGATORY | PAYMENT TYPE | PRICE |
|--|------------|----------------|-----------------|
| Charter package (Payable at the base) Season: 2026. incl. Permit, outboard engine, Wi-Fi Internet (5 GB), bed linen (1 set/ person) | Yes | per booking | 375,00 € |
| Early afternoon boarding/check-in (Payable at the base) Season: 2026. -> 2.00 pm – 4.00 pm, max. 4 yachts | No | per booking | 75,00 € |
| Early boarding/check-in (Payable at the base) Season: 2026. -> 12.30 pm – 2.00 pm, max 5 yachts | No | per booking | 200,00 € |
| Extra cleaning (Payable at the base) Season: 2026. | No | per booking | 200,00 € |
| Hostess (Payable at the base) Season: 2026. + own cabin; external service provider, direct billing | No | per day + food | 200,00 € |
| Pet on board (Payable at the base) Season: 2026. | No | per pet | 200,00 € |
| Regatta charge (Payable at the base) Season: 2026. ON REQUEST | No | per booking | 0,00 € |
| Skipper (Payable at the base) Season: 2026. + own cabin; external service provider | No | per day + food | 200,00 € |
| WI-FI Internet connection on boat (Payable at the base) Season: 2026. unlimited / depending on the network reception (5 GB are included in the Charter package) | No | per week | 30,00 € |



WEBSITE

www.plujeme.cz



PHONE

+420 720 755 085



MOBILE

+420 777 170 276



E-MAIL

info@plujeme.cz







PLUJEME RÁDI S.R.O.

Dlouhá 730/35, 11000 Praha 1 – Staré Město, Czech Republic

ADDITIONAL EXTRAS

| EXTRA | OBLIGATORY | PAYMENT TYPE | PRICE |
|--|------------|--------------|-----------------|
| Extra bedlinen (Payable at the base) Season: 2026. 1 set/ person is included in the charter package - Payable at the base | No | per set | 10,00 € |
| Flexible bulkhead system (Payable at the base) Season: 2026. Payable at the base | No | per booking | 180,00 € |
| Gennaker (Payable at the base) Season: 2026. Payable at the base | No | per booking | 350,00 € |
| Glass bottom dinghy (Payable at the base) Season: 2026. Formentera 270 PC + approx. 3 HP ePropulsion engine, max. 3 persons, in 8,5 h fully loaded with 12 V - Payable at the base | No | per week | 220,00 € |
| Grill/Barbecue/Plancha (Payable at the base) Season: 2026. Payable at the base | No | per booking | 65,00 € |
| Ice box (Payable at the base) Season: 2026. Mobile Cooler Box (no power connection): approx. 52L, filled with approx. 6kg ice cubes - limited availability, subject to on-site ice availability For drinks and ice only. Box must be returned clean and undamaged. Max. 2 yachts. - Payable at the base | No | per booking | 35,00 € |
| Ice maker (Payable at the base) Season: 2026. operating with - shorepower or - Inverter min. 2.000 W or - Generator - Payable at the base | No | per booking | 45,00 € |
| NESPRESSO coffee machine (Payable at the base) Season: 2026. operating with - shorepower or - Inverter min. 2000 W or - Generator - Payable at the base | No | per booking | 45,00 € |
| Railing net (Safety net) (Payable at the base) Season: 2026. incl. mounting and unmounting - Payable at the base | No | per booking | 180,00 € |
| Stand up paddle (SUP) (Payable at the base) Season: 2026. Payable at the base | No | per week | 100,00 € |

| | | | | |
|---|---|--|---|----------------|
| Toys (Payable at the base) Season: 2026. Payable at the base |  WEBSITE www.plujeme.cz |  PHONE +420 720 755 080 |  MOBILE +420 720 170 276 | 10,00 € |
| |  E-MAIL info@plujeme.cz |  PLUJEME RÁDI S.R.O. Dlouhá 730/35, 11000 Praha 1 - Staré Město, Czech Republic | | |



PRICE AND AVAILABILITY

| | | | |
|--|--|--|--|
| 25.04. - 02.05.2026 NOT AVAILABLE | 02.05. - 09.05.2026 1.456 € 2.080 € | 09.05. - 16.05.2026 1.610 € 2.300 € | 16.05. - 30.05.2026 NOT AVAILABLE |
| 30.05. - 06.06.2026 NOT AVAILABLE | 06.06. - 13.06.2026 NOT AVAILABLE | 13.06. - 20.06.2026 NOT AVAILABLE | 20.06. - 24.06.2026 NOT AVAILABLE |
| 24.06. - 01.07.2026 NOT AVAILABLE | 04.07. - 11.07.2026 3.000 € 3.750 € | 11.07. - 18.07.2026 NOT AVAILABLE | 18.07. - 25.07.2026 NOT AVAILABLE |
| 25.07. - 08.08.2026 NOT AVAILABLE | 08.08. - 15.08.2026 NOT AVAILABLE | 19.08. - 26.08.2026 NOT AVAILABLE | 29.08. - 05.09.2026 NOT AVAILABLE |
| 05.09. - 12.09.2026 NOT AVAILABLE | 12.09. - 19.09.2026 2.712 € 3.390 € | 19.09. - 26.09.2026 NOT AVAILABLE | 26.09. - 03.10.2026 NOT AVAILABLE |
| 03.10. - 10.10.2026 1.672 € 2.090 € | 10.10. - 17.10.2026 1.560 € 1.950 € | 17.10. - 24.10.2026 1.512 € 1.890 € | 24.10. - 31.10.2026 1.480 € 1.850 € |
| 31.10. - 07.11.2026 1.480 € 1.850 € | 07.11. - 14.11.2026 1.480 € 1.850 € | 14.11. - 21.11.2026 1.480 € 1.850 € | 22.11. - 31.12.2026 NOT AVAILABLE |



WEBSITE

www.plujeme.cz



E-MAIL

info@plujeme.cz



PHONE

+420 720 755 085



MOBILE

+420 777 170 276



PLUJEME RÁDI S.R.O.

Dlouhá 730/35, 11000 Praha 1 – Staré Město, Czech Republic