

BAVARIA 46 CRUISER

Galera (2007)

Sailing yacht **Bavaria 46 Cruiser Galera**, built in **2007** is anchored in the **ACI Marina Trogir, Split region, Croatia**. It has **4 cabins**, can accommodate **8 people** and has **2 toilets**. Bed linen and kitchen equipment are included in the price.

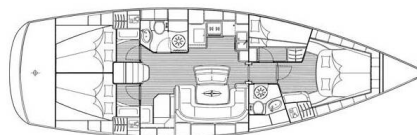

YACHT SPECIFICATIONS

Yacht Base

ACI Marina Trogir, Croatia

Yacht ID

28

Brands

Bavaria

Yacht name

Galera

Production year

2007

Length

47 ft

Cabins

4

Berths

8

Max Persons

8

WC

2

Engine

1 x 56 HP

Fuel tank

150 l



WEBSITE

www.plujeme.cz



PHONE

+420 720 755 085



MOBILE

+420 777 170 276



E-MAIL

info@plujeme.cz



PLUJEME RÁDI S.R.O.

Dlouhá 730/35, 11000 Praha 1 – Staré Město, Czech Republic

STANDARD YACHT EQUIPMENT

| | |
|-----------------|---|
| Comfort | Bed linen, Blankets, Cockpit cushions, Pillows |
| Deck | Bilge pump - Mechanic, Bimini top, Boat hook, Cockpit table, Cockpit/stern, outside shower, Diesel filter, Dinghy, Dinghy (byboat) pump, Electric anchor windlass, Fenders, Gangway, Jerry cans for diesel, Mooring ropes, Plastic bucket, Spare anchor (Reserve, Auxiliary anchor), Sprayhood, Water hose |
| Entertainment | Diving mask, iPad, Outdoor speakers, Radio CD mp3 player |
| Galley | Gas bottles, Gas cookers, Hot water, Kitchen utensils (Galley equipment, cutlery), Oven, Refrigerator |
| Interior | Barometer, Clock, Electric toilet, Hair dryer |
| Navigation | Autopilot, Binoculars, Bow thruster, Echosounder/Depthsounder, GPS iPad with Navionics, Hand bearing compass, Navigation (Nautical) charts and nautical guide, Windex |
| Safety | Automatic Inflatable Life Jacket, Black Water Tank, Distress flare box, Fire extinguisher, First aid kit, Flashlight, Fog horn, Life belts (Safety harness), Life buoy + Flashing light, Life jackets, Liferaft, Oars (Paddles), Set of tools, VHF radio |
| Sails | Self tailing (manual) winch |
| Yacht electrics | 12V Socket, Battery charger, Bilge pump - Electric, Converter 220V/12V, Inverter, Shore connection 220 V, Solar panels |



WEBSITE

www.plujeme.cz



E-MAIL

info@plujeme.cz



PHONE

+420 720 755 085



MOBILE

+420 777 170 276



PLUJEME RÁDI S.R.O.

Dlouhá 730/35, 11000 Praha 1 – Staré Město, Czech Republic

SERVICES

| SELECTED SERVICES | OBLIGATORY | PAYMENT TYPE | PRICE |
|---|------------|----------------|-----------------|
| Final cleaning (Payable at the base) Season: 2026. | Yes | per booking | 240,00 € |
| TIP for employees (Payable at the base) Season: 2026. | Yes | per week | 27,00 € |
| Early boarding/check-in (Payable at the base) Season: 2026. Early Check from 12:00 | No | per booking | 160,00 € |
| Non refundable deposit/ insurance (Payable at the base) Season: 2026. + 200 EUR refundable, insurance does not cover damages to the dinghy, iPads, and outboard motors | No | per booking | 150,00 € |
| Parking (Payable at the base) Season: 2026. van 75€/week, camper 110€/week | No | per week | 60,00 € |
| Pet on board (Payable at the base) Season: 2026. | No | per booking | 70,00 € |
| Skipper (Payable at the base) Season: 2026. price on request | No | per day + food | 0,00 € |
| WI-FI Internet connection on boat (Payable at the base) Season: 2026. 25 Gb | No | per booking | 15,00 € |



WEBSITE

www.plujeme.cz



E-MAIL

info@plujeme.cz



PHONE

+420 720 755 085



MOBILE

+420 777 170 276



PLUJEME RÁDI S.R.O.

Dlouhá 730/35, 11000 Praha 1 – Staré Město, Czech Republic

ADDITIONAL EXTRAS

| EXTRA | OBLIGATORY | PAYMENT TYPE | PRICE |
|--|------------|--------------|-----------------|
| Automatic Inflatable Life Jacket (Payable at the base) Season: 2026. Additional life jacket (2 are included on yacht as standard) - Payable at the base | No | per booking | 10,00 € |
| Blister (Payable at the base) Season: 2026. + 500€ deposit - Payable at the base | No | per week | 350,00 € |
| Coffee machine (Payable at the base) Season: 2026. Payable at the base | No | per week | 50,00 € |
| Grill/Barbecue/Plancha (Payable at the base) Season: 2026. Payable at the base | No | per booking | 100,00 € |
| Ice maker (Payable at the base) Season: 2026. Payable at the base | No | per week | 50,00 € |
| Kayak (Payable at the base) Season: 2026. Payable at the base | No | per week | 120,00 € |
| Outboard engine (Payable at the base) Season: 2026. Payable at the base | No | per week | 100,00 € |
| Railing net (Safety net) (Payable at the base) Season: 2026. Payable at the base | No | per booking | 60,00 € |
| Stand up paddle (SUP) (Payable at the base) Season: 2026. Payable at the base | No | per week | 100,00 € |
| Towels (Payable at the base) Season: 2026. Payable at the base | No | per person | 5,00 € |
| Underwater scooter (Payable at the base) Season: 2026. Payable at the base | No | per week | 150,00 € |



WEBSITE
www.plujeme.cz



PHONE
+420 720 755 085



MOBILE
+420 777 170 276



E-MAIL
info@plujeme.cz



PLUJEME RÁDI S.R.O.
Dlouhá 730/35, 11000 Praha 1 – Staré Město, Czech Republic

PRICE AND AVAILABILITY

| | | | |
|--|--|--|--|
| 25.04. - 02.05.2026 1.260 € 1.400 € | 02.05. - 09.05.2026 NOT AVAILABLE | 09.05. - 16.05.2026 NOT AVAILABLE | 16.05. - 23.05.2026 1.404 € 1.560 € |
| 23.05. - 30.05.2026 NOT AVAILABLE | 30.05. - 06.06.2026 NOT AVAILABLE | 06.06. - 20.06.2026 NOT AVAILABLE | 20.06. - 27.06.2026 NOT AVAILABLE |
| 27.06. - 04.07.2026 NOT AVAILABLE | 04.07. - 11.07.2026 2.610 € 2.900 € | 11.07. - 18.07.2026 2.700 € 3.000 € | 18.07. - 25.07.2026 NOT AVAILABLE |
| 25.07. - 01.08.2026 NOT AVAILABLE | 01.08. - 08.08.2026 2.880 € 3.200 € | 08.08. - 22.08.2026 NOT AVAILABLE | 22.08. - 29.08.2026 NOT AVAILABLE |
| 29.08. - 05.09.2026 2.205 € 2.450 € | 05.09. - 12.09.2026 NOT AVAILABLE | 12.09. - 19.09.2026 NOT AVAILABLE | 19.09. - 26.09.2026 NOT AVAILABLE |
| 26.09. - 03.10.2026 1.530 € 1.700 € | 03.10. - 10.10.2026 1.368 € 1.600 € | 10.10. - 17.10.2026 1.296 € 1.600 € | 18.10. - 26.03.2027 NOT AVAILABLE |



WEBSITE

www.plujeme.cz



E-MAIL

info@plujeme.cz



PHONE

+420 720 755 085



MOBILE

+420 777 170 276



PLUJEME RÁDI S.R.O.

Dlouhá 730/35, 11000 Praha 1 – Staré Město, Czech Republic

PRICE AND AVAILABILITY

| | | | |
|--------------------------------|--------------------------------|--------------------------------|--------------------------------|
| 27.03. - 03.04.2027 1.400 € | 03.04. - 10.04.2027 1.400 € | 10.04. - 17.04.2027 1.400 € | 17.04. - 24.04.2027 1.400 € |
| 24.04. - 01.05.2027 1.400 € | 01.05. - 08.05.2027 1.400 € | 08.05. - 15.05.2027 1.400 € | 15.05. - 22.05.2027 1.560 € |
| 22.05. - 29.05.2027 1.890 € | 29.05. - 05.06.2027 1.800 € | 05.06. - 12.06.2027 2.400 € | 12.06. - 19.06.2027 2.200 € |
| 19.06. - 26.06.2027 2.800 € | 26.06. - 03.07.2027 2.800 € | 03.07. - 10.07.2027 3.900 € | 10.07. - 17.07.2027 3.200 € |
| 17.07. - 24.07.2027 3.200 € | 24.07. - 31.07.2027 3.200 € | 31.07. - 07.08.2027 3.200 € | |



WEBSITE

www.plujeme.cz



E-MAIL

info@plujeme.cz



PHONE

+420 720 755 085



MOBILE

+420 777 170 276



PLUJEME RÁDI S.R.O.

Dlouhá 730/35, 11000 Praha 1 – Staré Město, Czech Republic

PRICE AND AVAILABILITY

| | | | |
|--------------------------------|--------------------------------|--------------------------------|--------------------------------|
| 07.08. - 14.08.2027 2.950 € | 14.08. - 21.08.2027 2.950 € | 21.08. - 28.08.2027 2.750 € | 28.08. - 04.09.2027 2.450 € |
| 04.09. - 11.09.2027 2.300 € | 11.09. - 18.09.2027 2.300 € | 18.09. - 25.09.2027 1.900 € | 25.09. - 02.10.2027 1.600 € |
| 02.10. - 09.10.2027 1.400 € | 09.10. - 16.10.2027 1.400 € | 16.10. - 23.10.2027 1.400 € | 23.10. - 30.10.2027 1.400 € |
| 30.10. - 06.11.2027 1.400 € | 06.11. - 13.11.2027 1.400 € | 13.11. - 20.11.2027 1.400 € | 20.11. - 27.11.2027 1.400 € |
| 27.11. - 04.12.2027 1.400 € | 04.12. - 11.12.2027 1.400 € | 11.12. - 18.12.2027 1.400 € | 18.12. - 25.12.2027 1.400 € |



WEBSITE

www.plujeme.cz



E-MAIL

info@plujeme.cz



PHONE

+420 720 755 085



MOBILE

+420 777 170 276



PLUJEME RÁDI S.R.O.

Dlouhá 730/35, 11000 Praha 1 – Staré Město, Czech Republic